

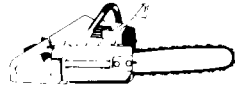

<b>SERVICE</b> 		<b>14</b>
		X 80.018

Replaces X 78.013

# HAND TOOLS OF THE CHAIN SAW WORKSHOP

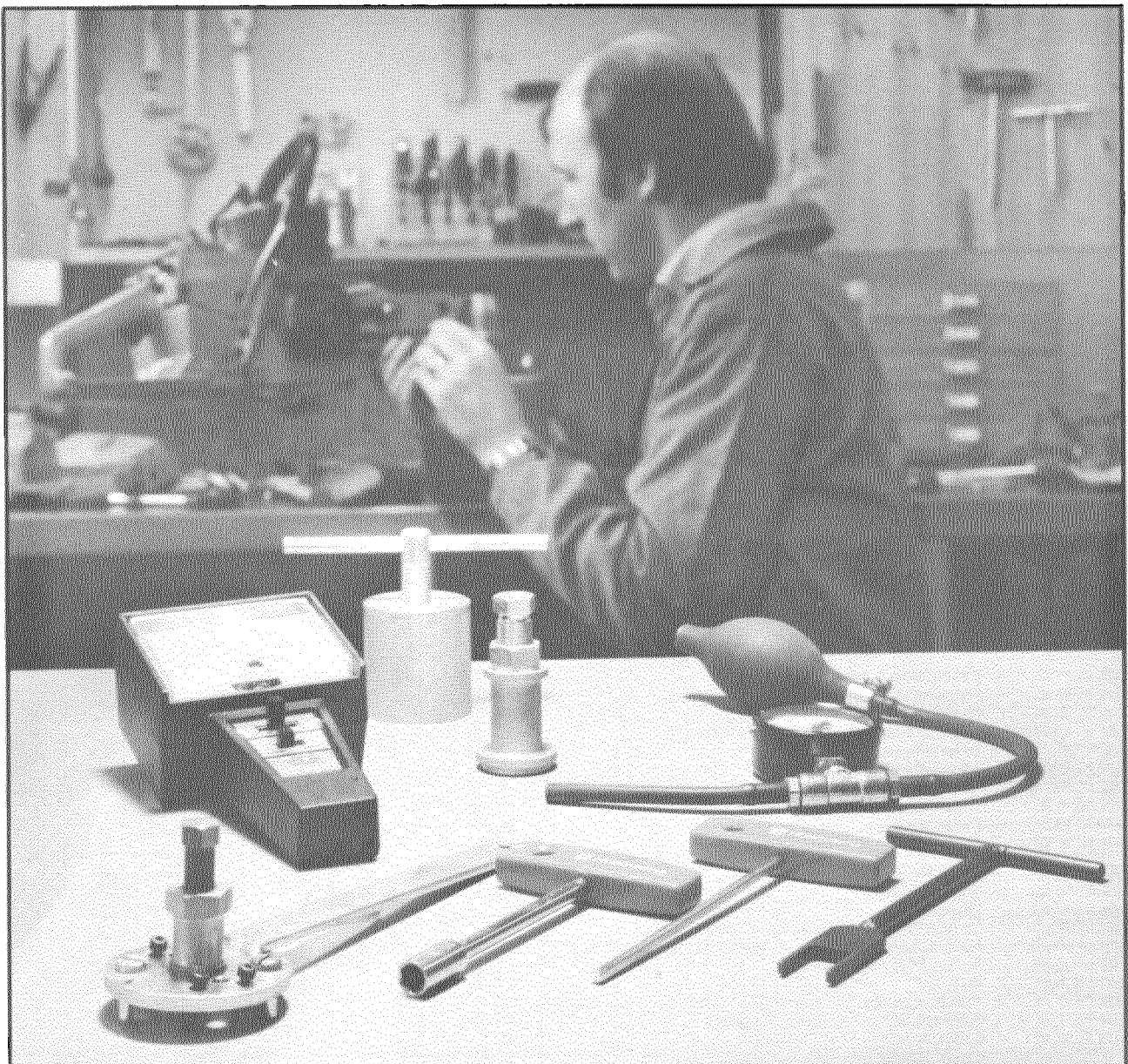

Reference No.	Denomination	140	160/ 160	162	185	1100	65/77	165R	140R	380
502 50 06-01	Assembling pliers, spark plug prot.	x	x	x	x	x	x	x	x	x
502 50 09-01	Puller, seal ring carrier								x	
502 50 16-01	Allen key, NV 6 mm (hexagon)						x			
502 50 16-01	Allen key, NV 4 mm (hexagon)	x	x	x	x	x	x	x	x	x
502 50 19-01	Allen key, NV 3 mm (hexagon)	x	x	x	x	x	x	x	x	x
502 50 20-01	Stud fitting tool M5	x	x	x	x	x	x	x	x	x
50 25 022-01	Socket spanner NV 8 mm	x	x	x	x	x	x	x	x	x
502 50 23-01	Socket spanner NV 10 mm		x		x	x	x	x		x
502 50 24-01	Spanner, clutch centre				x	x				
502 50 25-01	Holding bar assembly	x	x	x	x	x	x	x	x	x
502 50 26-01	Puller with screw	x	x	x	x	x	x	x	x	x
502 50 28-01	Timing device	x								
502 50 30-01	Fitting tool, crankshaft				x	x				
502 50 30-02	Fitting tool, crankshaft		x							x
502 50 30-03	Fitting tool, crankshaft, Mod. 140—240	x								
502 50 30-04	Fitting tool, crankshaft			x						
50 25 030-05	Fitting tool, crankshaft, Mod. 340	x								
502 50 30-06	Fitting tool, crankshaft, Mod. 444	x								
502 50 31-01	Ball bearing puller, compl.	x		x						
502 50 33-01	Piston stop	x	x	x	x	x	x <sup>1</sup>		x	x
502 50 35-01	Drill template for stud, exhaust	x							x	
502 50 36-01	Revolution counter	x	x	x	x	x	x	x		
502 50 37-01	Vacuum gauge	x	x	x	x	x	x	x	x	x
502 50 38-01	Pressure gauge	x	x	x	x	x	x	x	x	x
502 50 43-01	Drill template for stud, exhaust			x						
502 50 44-01	Drill template for stud, intake	x							x	
502 50 45-01	Distance sleeve (35 mm)		x		x	x	x	x		x
502 50 46-01	Distance sleeve (57 mm)	x		x					x	
502 50 47-01	Grommet, intake		x	x	x	x	x	x		x
502 50 46-01	Grommet, exhaust		x	x			x	x		x
502 50 49-01	Assembling pliers, clutch		x	x	x	x		x		
502 50 50-01	Repair kit for cables	x	x	x	x	x	x	x	x	x
502 50 51-01	Cable clip pliers	x	x	x	x	x	x	x	x	x
502 50 52-01	Fitting sleeve, seal ring				x	x				
502 50 53-01	Fitting sleeve, seal ring		x	x				x		
502 50 56-01	Fitting-drift, capacitor		x				x			
502 50 57-01	Allen key 3/16"			x	x	x				
502 50 59-01	Timing device		x				x			
502 50 62-01	Fitting tool, manual pump					x				
502 50 63-01	Extractor, bevel-gear							x		
502 50 64-01	Allen key, NV 5 mm (hexagon)						x	x	x	
502 50 65-01	Puller, gear wheel shaft (M12)							x		
502 50 66-01	U-spanner, vibr.element, NV 22 mm		x	x	x	x			x	x
502 50 67-01	U-spanner, vibr.element, NV 15 mm	x		x						
502 50 68-01	Pressure gauge, crankcase			x						
502 50 70-01	Piston assembling kit	x	x	x	x	x	x	x	x	x
502 50 71-01	Escutcheon plate, exhaust	x							x	
502 50 72-01	Escutcheon plate, intake	x							x	
502 50 78-01	Extractor, seal ring		x				x	x	x	x
502 50 79-01	Fitting-drift, seal ring	x	x				x	x	x	x
502 50 81-01	Escutcheon plate, exhaust				x	x				
502 50 82-01	Fitting-drift, seal ring				x	x				
502 50 83-01	Hook, tank plumb	x	x	x	x	x	x	x	x	x
502 50 66-01	Allen screwdriver with bail, NV 3 mm	x	x	x	x	x	x	x	x	x
502 50 67-01	Allen screwdriver with ball, NV 4 mm	x	x	x	x	x	x	x	x	x
502 50 88-01	Allen Screwdriver with ball, NV 5 mm						x	x	x	
502 50 89-01	Puller, driver, compl.	x								
502 50 91-01	Touch. up, paint, orange, 1/8 litre	x	x	x	x	x	x	x	x	x
502 50 99-01	Puller, driver	x								
502 51 00-01	U-spanner vibr.element NV 18 mm	x								
502 51 01-01	Extractor, seal ring	x			x	x				
502 51 06-01	Glue, adhesive	x	x	x	x	x	x	x	x	x
502 51 07-01	Epoxy glue	x	x	x	x	x	x	x	x	x
502 51 08-01	Loctite, AA (normal locking power)	x	x	x	x	x	x	x	x	x
502 51 09-01	Loctite, AAV (superior locking power)	x	x	x	x	x	x	x	x	x
502 51 11-01	Spanner for stop sleeve								x	
502 51 16-01	Drift	x <sup>2</sup>		x <sup>2</sup>						
502 51 17-01	Pressure gauge	x <sup>2</sup>		x <sup>2</sup>						
502 51 18-01	Spanner	x <sup>2</sup>		x <sup>2</sup>						
502 70 02-01	Screw	x							x	
502 70 03-01	Pull rod for 50 25 031-01	x		x						
502 70 04-02	Screw (M10) for puller							x		
502 70 05-03	Screw for puller	x	x	x	x	x	x	x	x	x
502 70 09-01	Ball pump	x	x	x	x	x	x	x	x	x
202 42 94-45	Screw M4 x 18 (hexagon)		x		x		x	x		
202 42 97-55	Screw M4 x 25 (hexagon)					x				x
202 43 32-55	Screw M5 x 22 (hexagon)					x	x			
202 43 33-55	Screw M5 x 25 (hexagon)								x	
202 43 41-55	Screw M5 x 50 (hexagon)								x	
206 23 72-11	Screw M6 x 25 (slotted screw)			x						
250 93 14-41	Nut M5								x	

1) Does not suit model 65

2) For Nordfeller

# BASIC MODEL 140

40, 44, 140, 240, 340, 444

# BASIC MODEL 162

162, 61

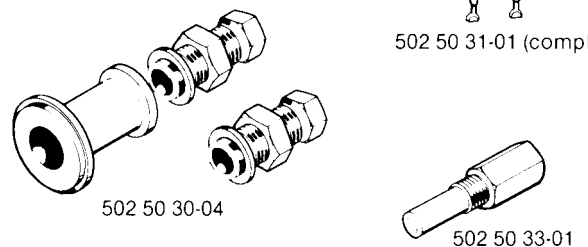
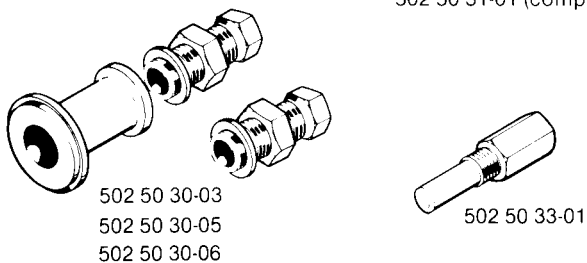
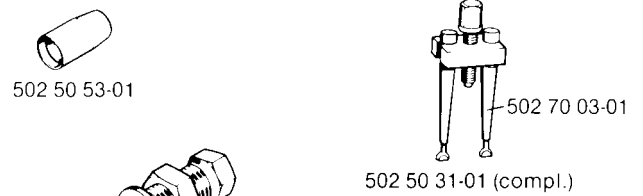
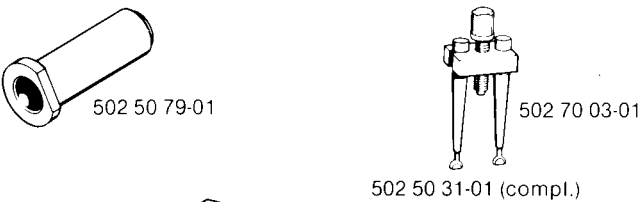
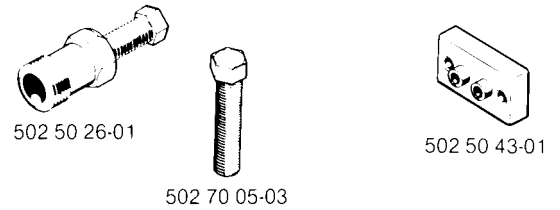
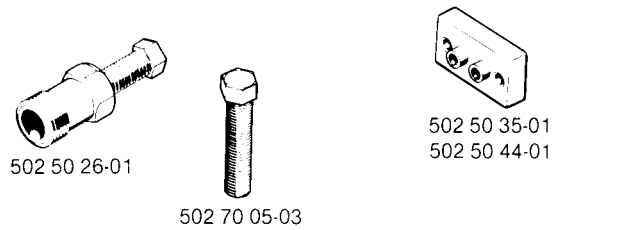
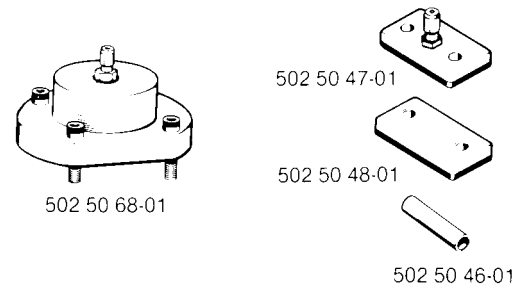
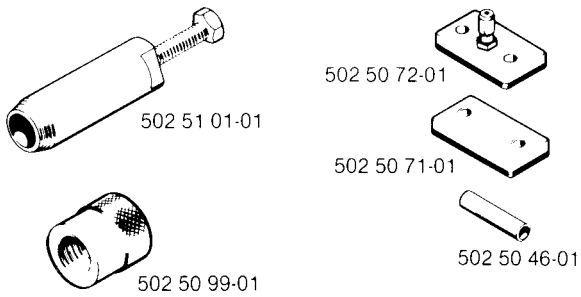
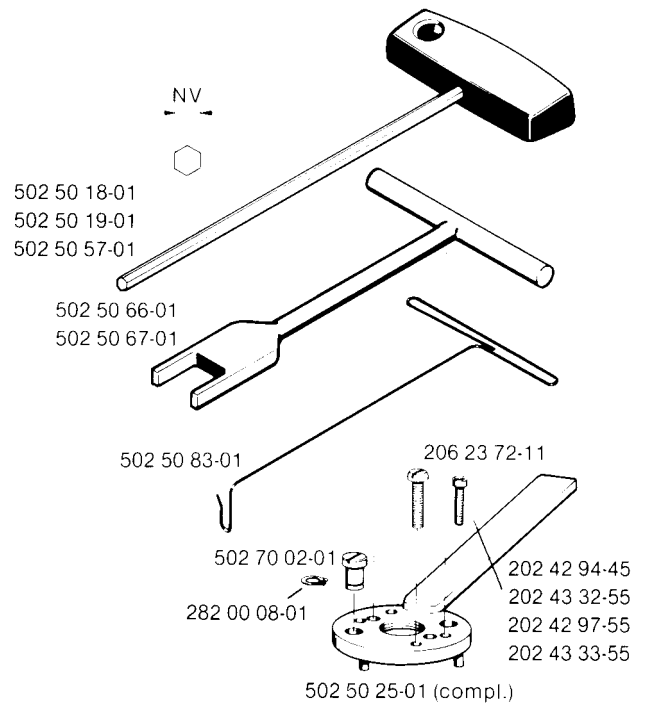
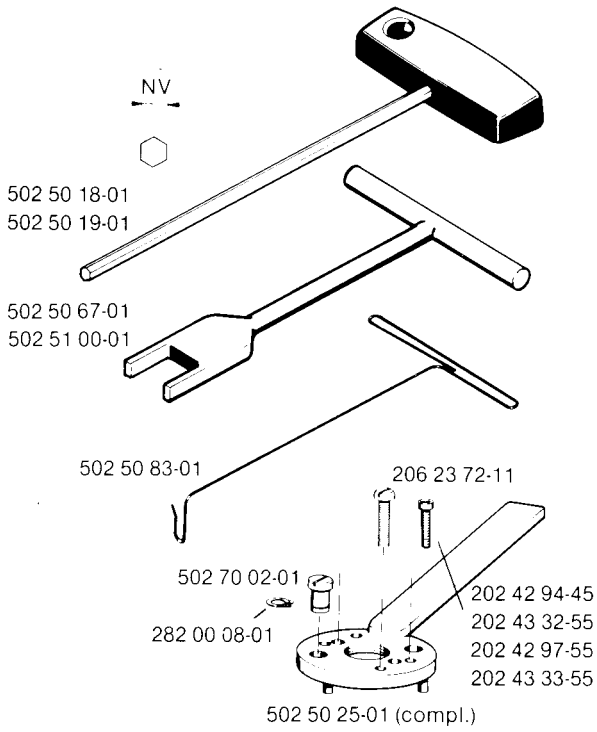

# BASIC MODEL 160/180

160, 163, 180, 280, 380, 480, 380 K, 480 K

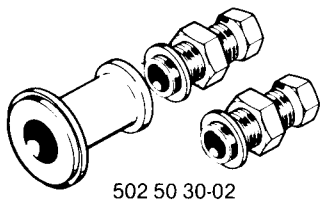
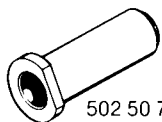
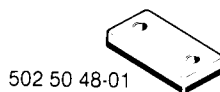
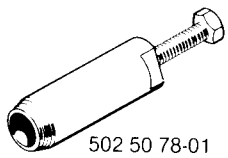
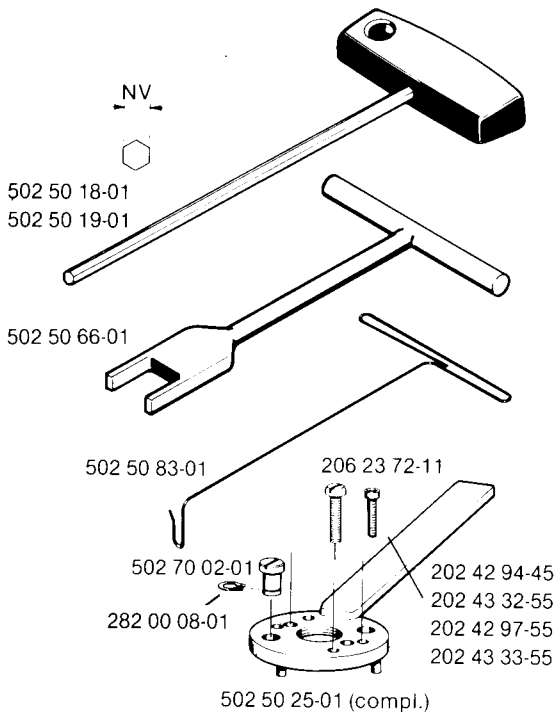

# BASIC MODEL 185/1100

185, 285, 1100, 2100

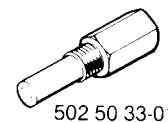
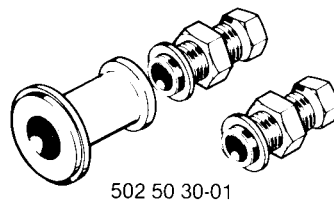
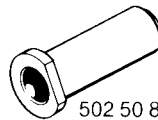
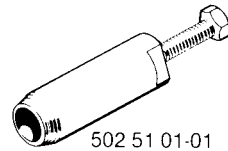
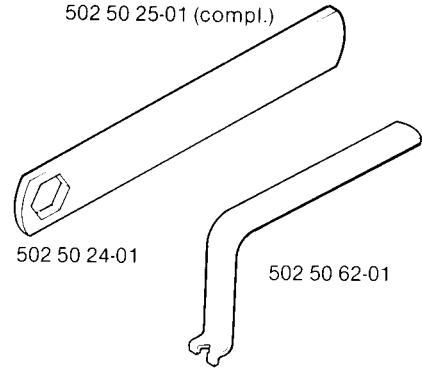
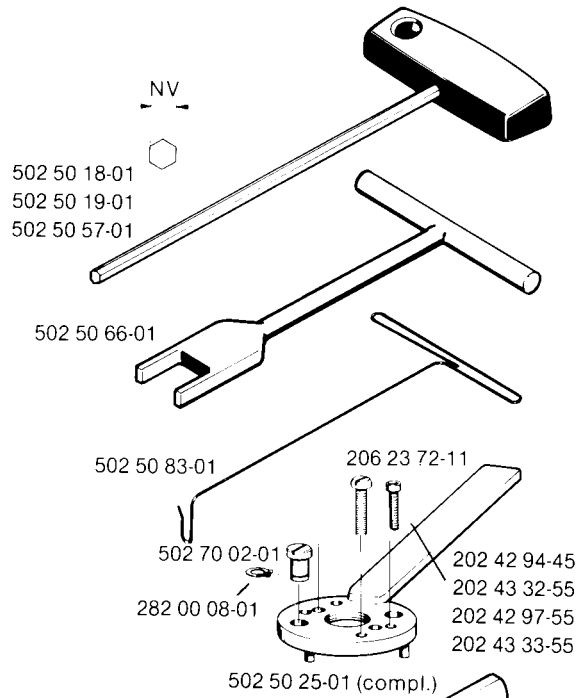

# BASIC MODEL 65/77

# CLEARING SAWS

36 R, 140 R, 165 R

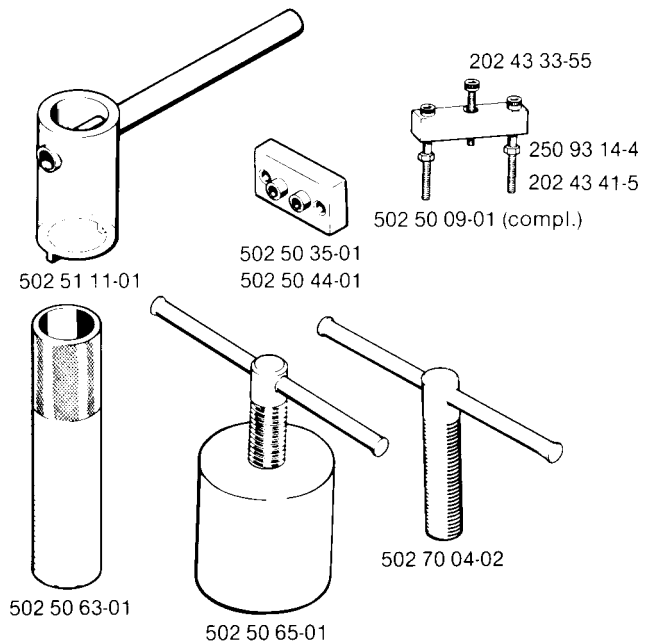
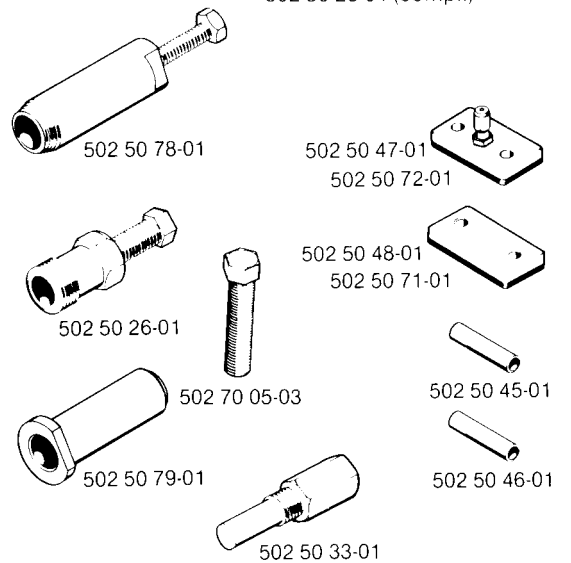
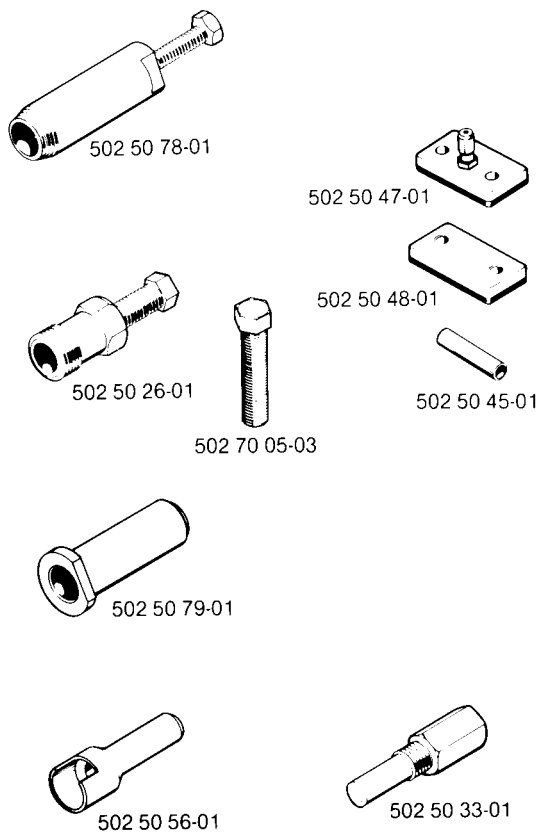
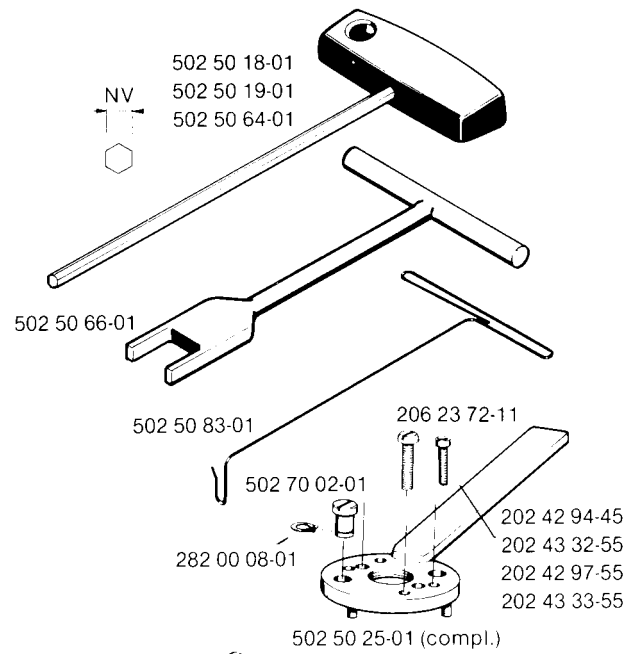
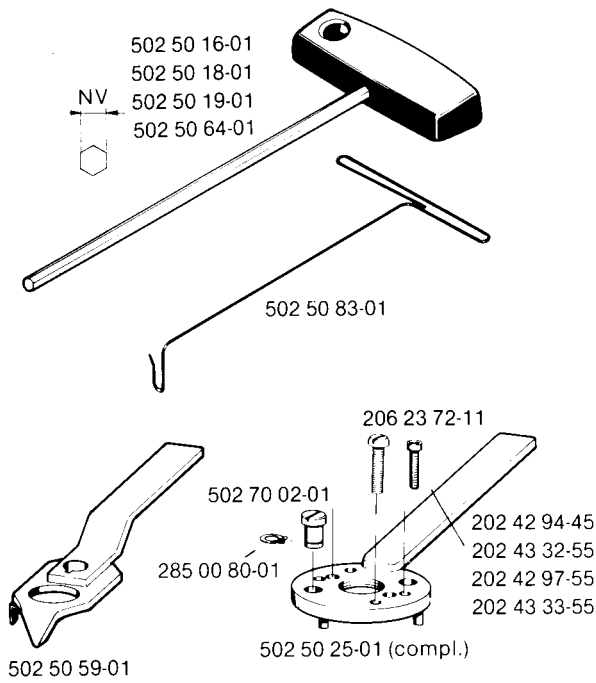

# COMMON TOOLS

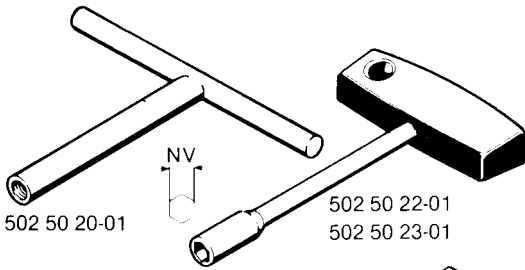

502 50 20-01

502 50 22-01  
502 50 23-01

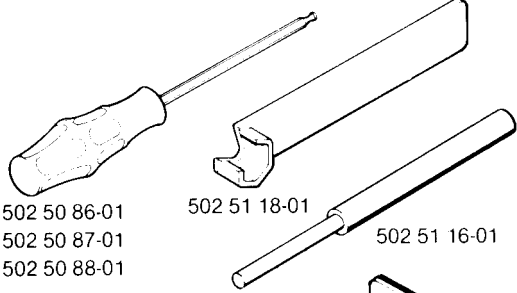

502 50 86-01  
502 50 87-01  
502 50 88-01

502 51 18-01

502 51 16-01

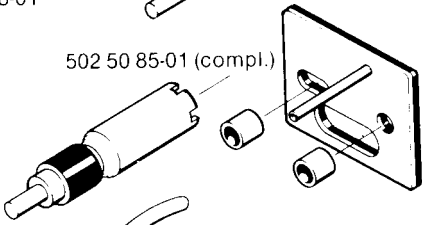

502 50 85-01 (compl.)

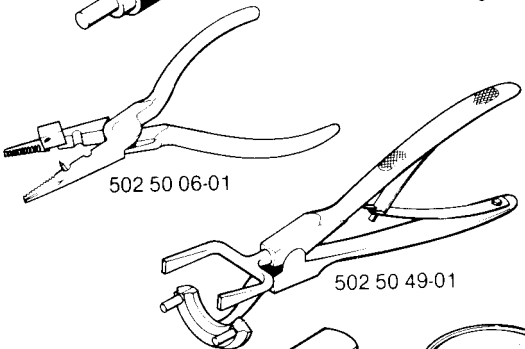

502 50 06-01

502 50 49-01

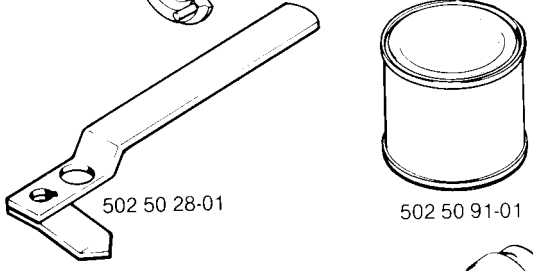

502 50 28-01

502 50 91-01

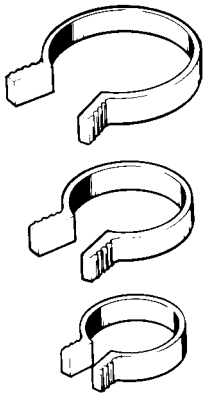

502 50 70-01 (compl.)



502 50 89-01 (compl.)

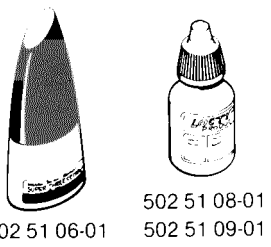

502 51 06-01

502 51 08-01  
502 51 09-01

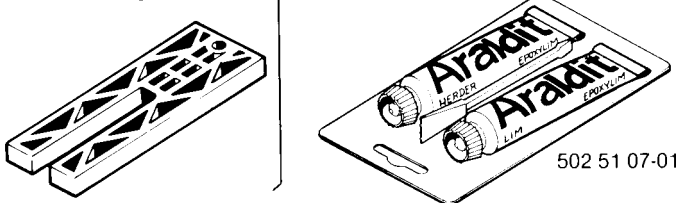

502 51 07-01

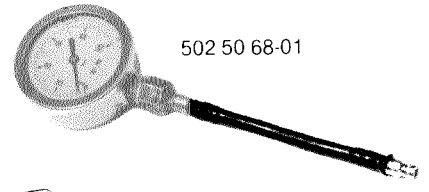

502 50 68-01

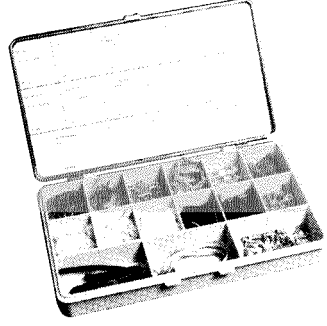

502 50 50-01



502 50 51-01

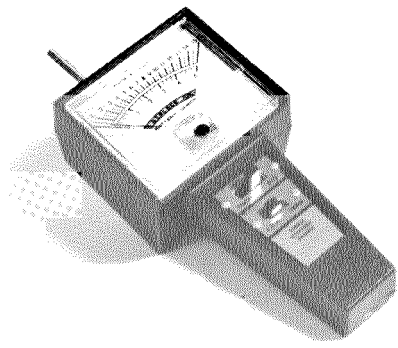

502 50 36-01

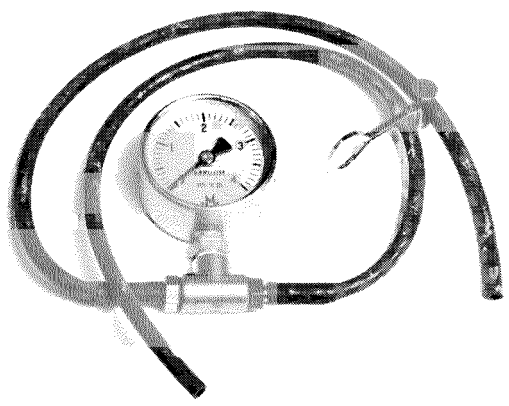

502 50 37-01

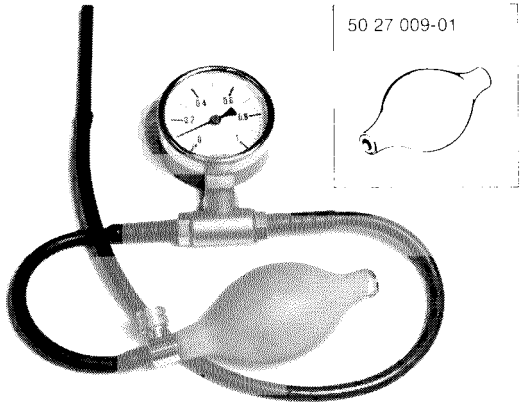

502 50 38-01 (compl.)

50 27 009-01