

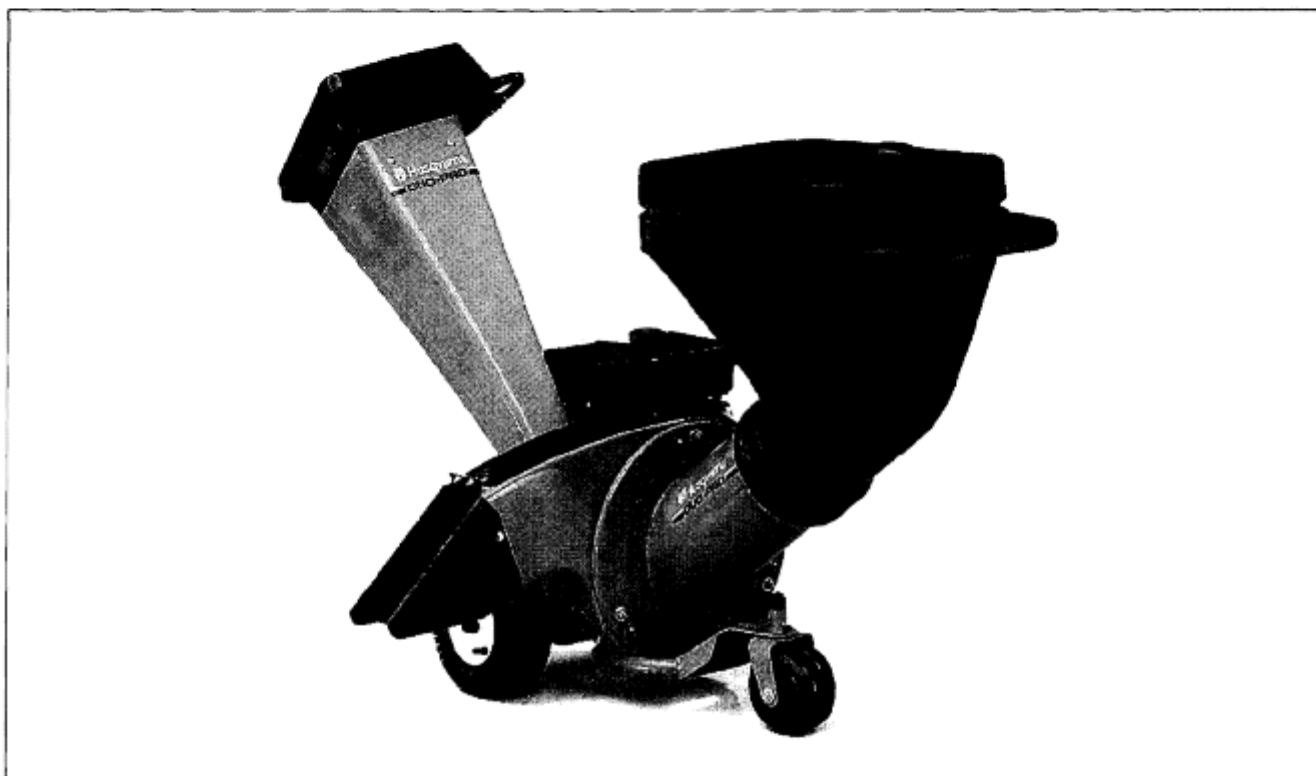

DuoPro



1.1994

Spare parts

Ersatzteile

Pièces détachées

Reserve onderdelen

Repuestos

Reservdelar

A

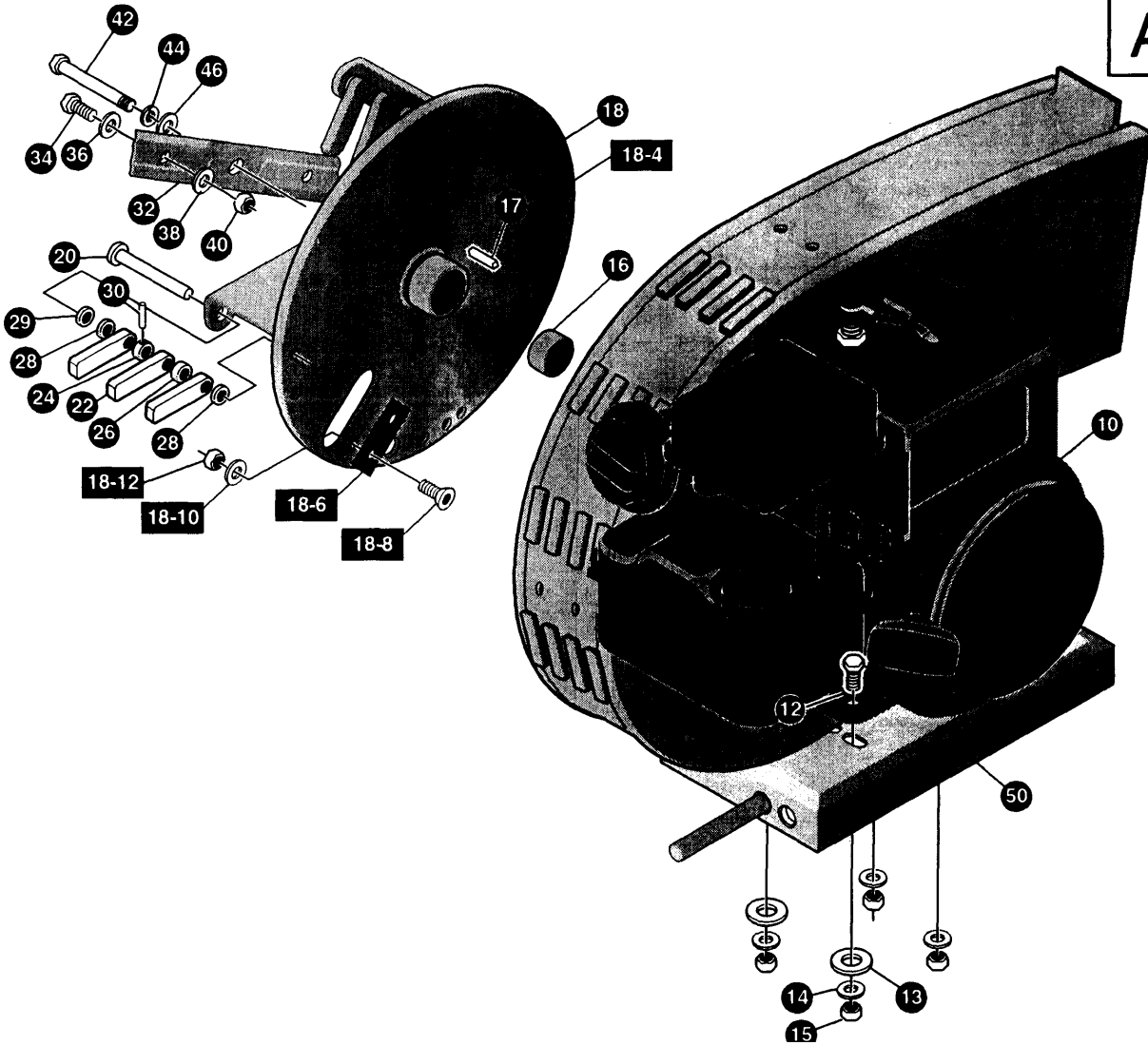

KEY#	PART#	DESCRIPTION	KEY#	PART#	DESCRIPTION
10		ENGINE, 8 HP B&S (SEE ENGINE MANUAL)	28	533 33 05-16	WASHER, FLAT .515 X 1.00 X 0.60
12	874 76 05-28	SCREW, 5/16 -18X 1.75 IN.	29	533 33 05-17	FLATWASHER, 515 X 1.00 X .030
14	533 12 03-93	WASHER, FLAT .344 X .69 X .065	30	533 32 94-16	RIVET, OVSET .188 X1.094
15	533 00 14-98	NUT, 5/16-18 REGHCTRLK	32	533 31 97-10	BLADE, ROTARY SHREDDER
17	533 30 55-62	KEY, SQUARE .250SQX2.12LG	34	874 76 05-28	SCREW, 5/16-18 X 1.75
18	533 32 72-25	ASSEMBLY, FLAIL BALANCING	36	533 12 03-93	WASHER, FLAT .344 X .69 X .065
18-4		NON-SERVICEABLE	38	734 11 72-01	WASHER, FLAT .375 X .88 X .125
18-6	533 31 96 61	BLADE, CHIPPER	40	533 00 14-98	NUT, 5/16-18 REGHCTRLK
18-8	533 32 33 28	SCREW, 5/16-24 X 1.00	42	533 32 69-86	SCREW, 3/8-20 X 2.25 IN.
18-10	533 12 06-38	WASHER, HVSPTLK .328 X .60 X .09	44	533 12 03-82	WASHER, REGSPTLK .393 X .68 X .10
18-12	873 61 05-00	NUT 5/16-24 REGHCTRLK	46	533 00 24-83	WASHER .39IDX1.25DX.07 BELLVIL
20	533 32 38-39	PIN FLAIL .50 X 2.81	50	533 32 74-26	ENGINE MOUNT/AXLE ASSEMBLY
22	533 31 96-60	FLAIL			
24	533 31 96 59	SPACER, SPEC .515 X 1.00 X .700			
26	533 32 54-63	SPACER, SLEEVE .515 X 1.00 X .700			

B

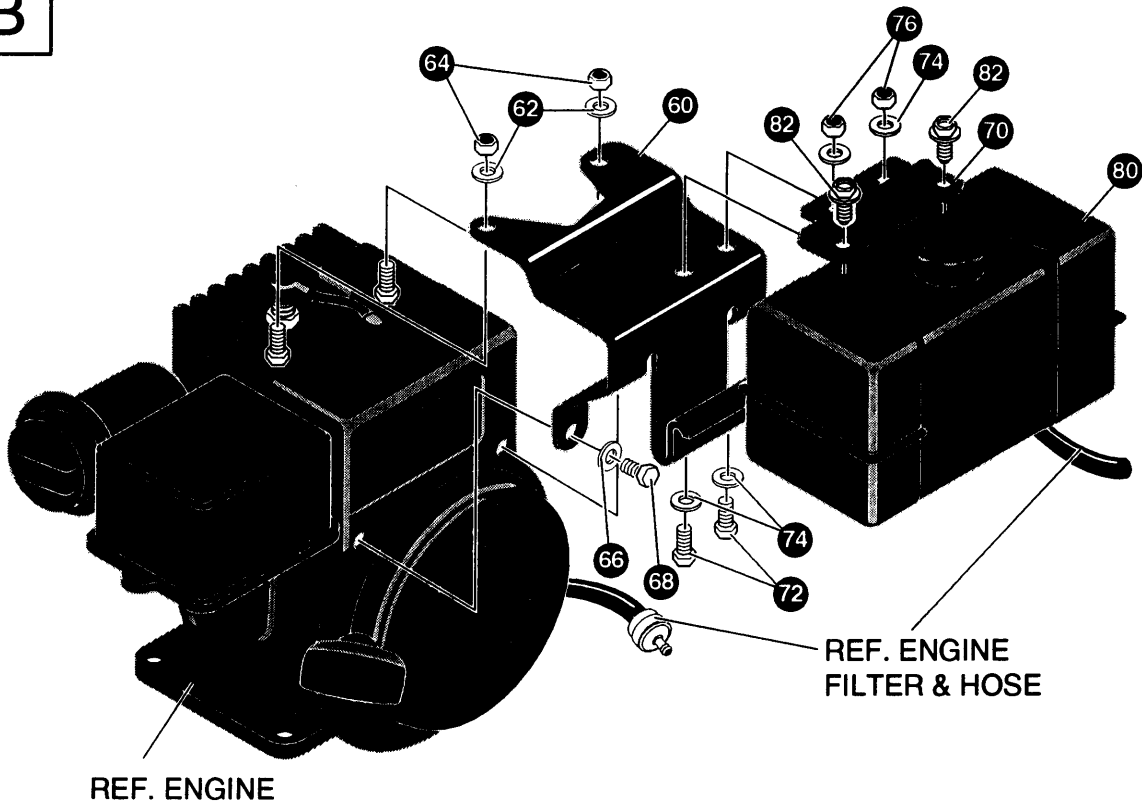

KEY#	PART#	DESCRIPTION
60	533 33 00-88	PLATE, TANK BRACKET
62	734 11 63-01	WASHER, FLAT .312X .73X.065
64	533 00 14-98	NUT, 5/16-18 REGHEXCTRLK
66	533 00 15-01	WASHER, FLAT .203X .56X.040
68	533 05 72-20	SCREW, #12 X .50
70	533 33 07-80	BRACKET, GAS TANK
72	533 18 00-77	SCREW, 5/16-18X .75IN
74	734 11 63-01	WASHER, FLAT .312X .73X .065
76	533 00 14-98	NUT, 5/16-18 REGHEXCTRLK
80	533 33 07-81	GAS TANK ASSY
82	533 33 07-82	SCREW, GAS TANK

CC

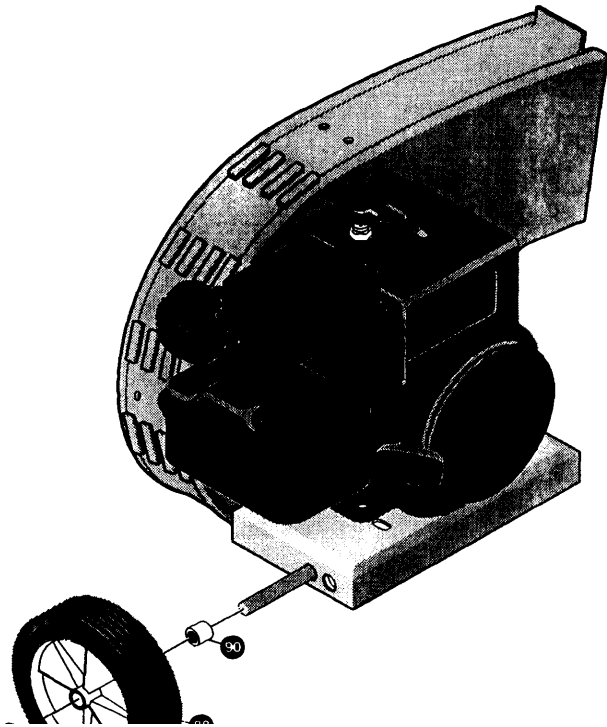

KEY #	PART #	DESCRIPTION
88	533 30 55-08	TIRE & RIM SEPU 12X3
90	533 32 68-63	SPACER,SLEV
92	533 32 33-26	.640X1.00X.688
	-----	NUT, PUSH ON 5/8"

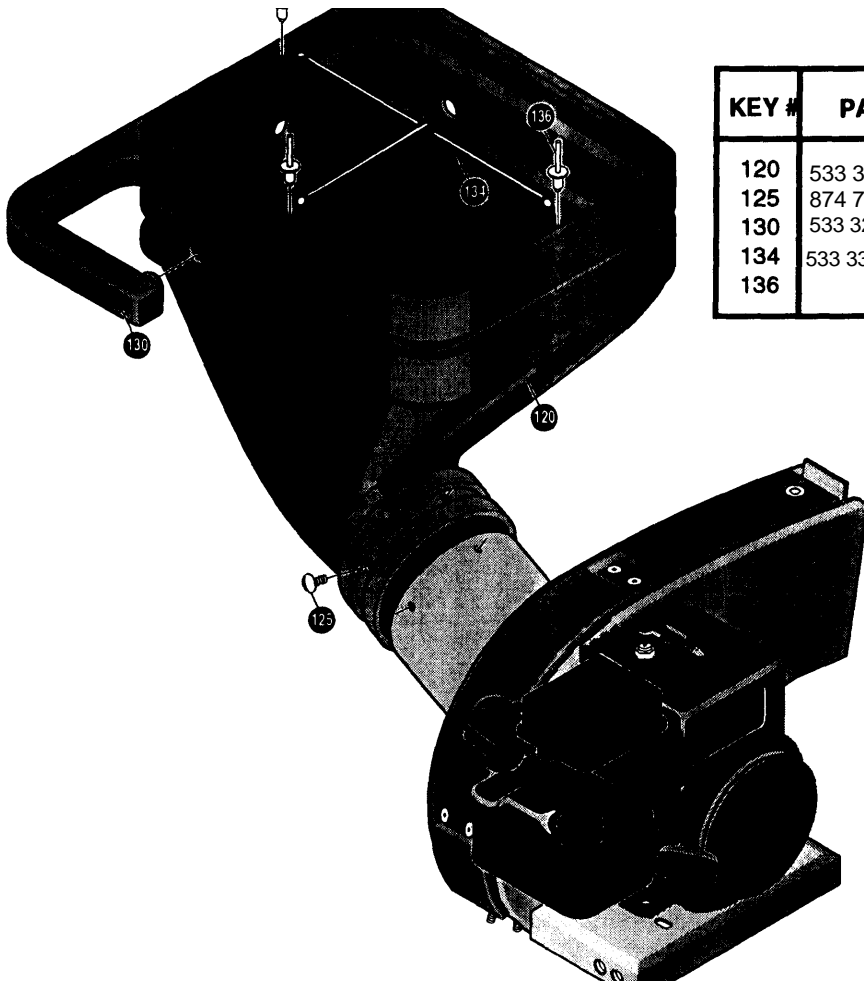

KEY #	PART #	DESCRIPTION
120	533 33 11-41	HOPPER, W/GRD HOLES
125	874 78 04-08	SCREW, 1/4-20 X .50
130	533 32 83-39	HANDLE, HOPPER
134	533 33 01-66	GUARD, WIRE HOPPER
136		RIVET (NON SERVICEABLE)

DD
D

E

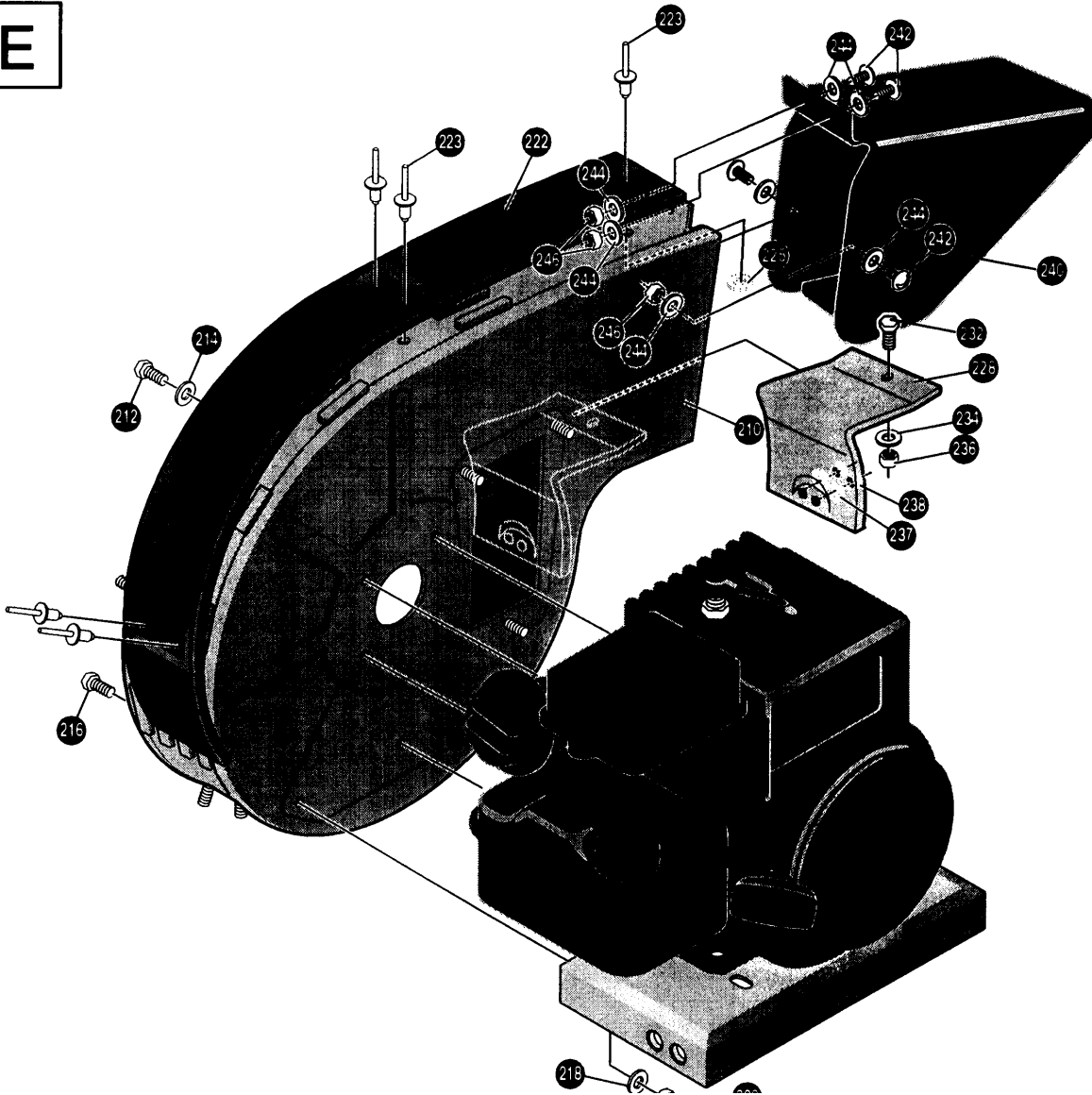

KEY #	PART #	DESCRIPTION
210	533 33 01-08	FLAIL HOUSING, ASSEMBLY
212	533 18 15-95	SCREW, 5/16-24 X .75
214	533 12 06-38	WASHER, HVSP TLK .328 X .60 X .09
216	533 18 00-77	SCREW, 5/16-18 X .75
218	533 12 03-93	FLATWASHER, .344 X .69 X .065
220	533 00 14-98	NUT, 5/16-18 REGHEXCTRLK
222	533 33 08-79	SHROUD COVER, FLAIL
223		RIVET (NON SERVICEABLE)
225	533 00 15-01	FLATWASHER, .203x.56x.040
228	533 33 02-13	BAFFLE & STUDS ASSY.
232	533 18 00-16	SCREW, 1/4-20X .50
234	533 12 03-92	WASHER, FLAT.281X .63X .065
236	533 00 15-02	NUT, 1/4-20 REGHEXCTRLK
237	533 12 03-93	FLATWASHER .344 X .69 X .065
238	533 00 14-98	NUT, 5/16-18 REGHEXCTRLK
240	533 33 00-49	DEFLECTOR, ASSY (EXPORT)
242	533 18 00-16	SCREW, 1/4-20X.50
244	533 12 03-92	WASH ER, FLAT .281 X .63X .065
246	533 00 15-02	NUT, 1/4-20 REGHEXCTRLK

F

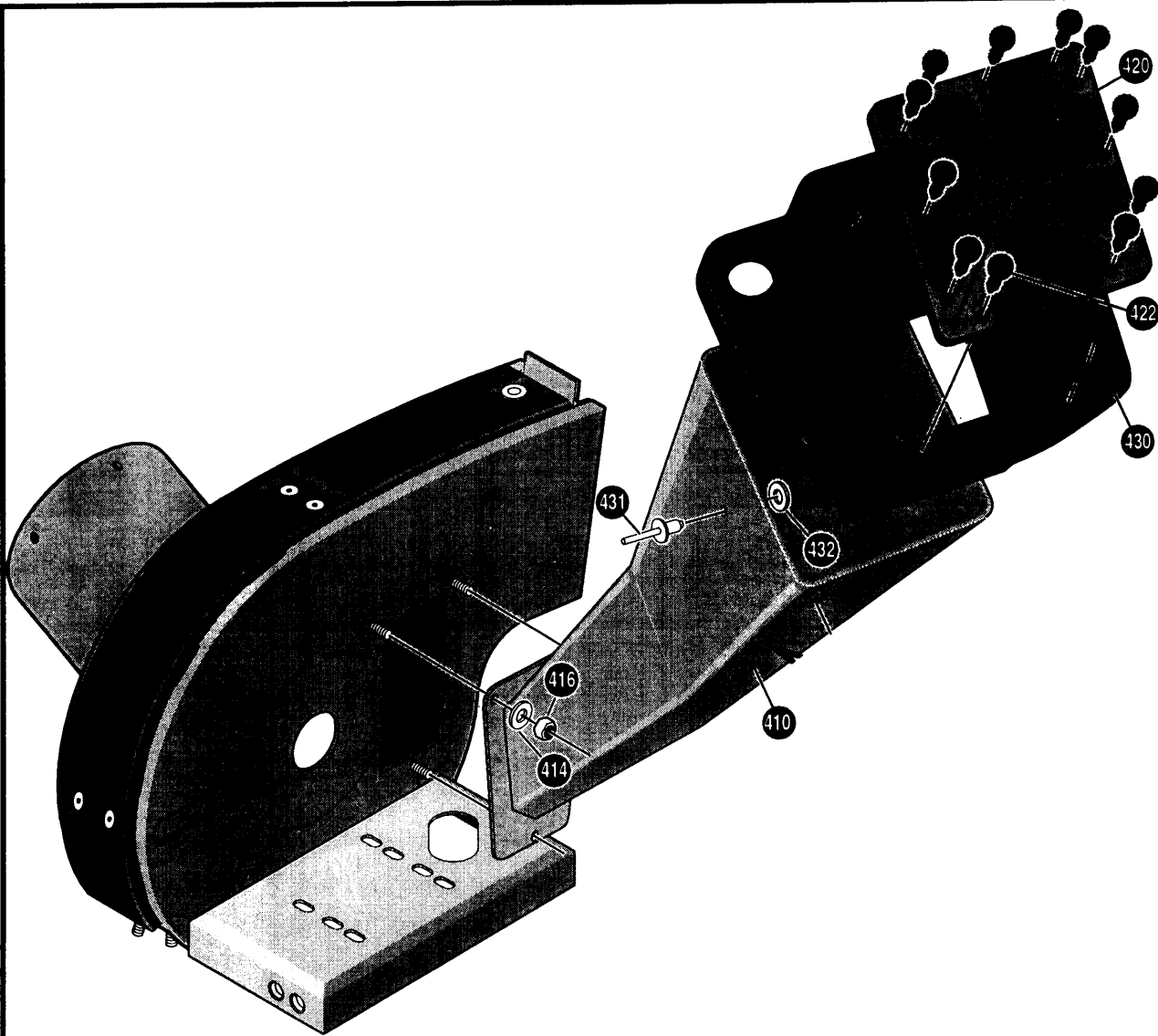

KEY #	PART #	DESCRIPTION
410	533 31 98-63	CHUTE, ASSEMBLY CHIPPER
414	734 11 63-01	WASHER, FLAT .349 X .69 X .066
416	873 22 05-00	NUT, 5/16-18 REGHEXCTRLK
420	533 32 33-33	GUARD, CHIPPER CHUTE
422	533 30 92-35	FASTENER, RATCHET
430	533 32 72-41	HOOD, CHIP CHUTE
431		RIVET,POP (NONSERVICEABLE)
432	533 00 15-01	WASHER, FLAT .203 X .56 X .040

G

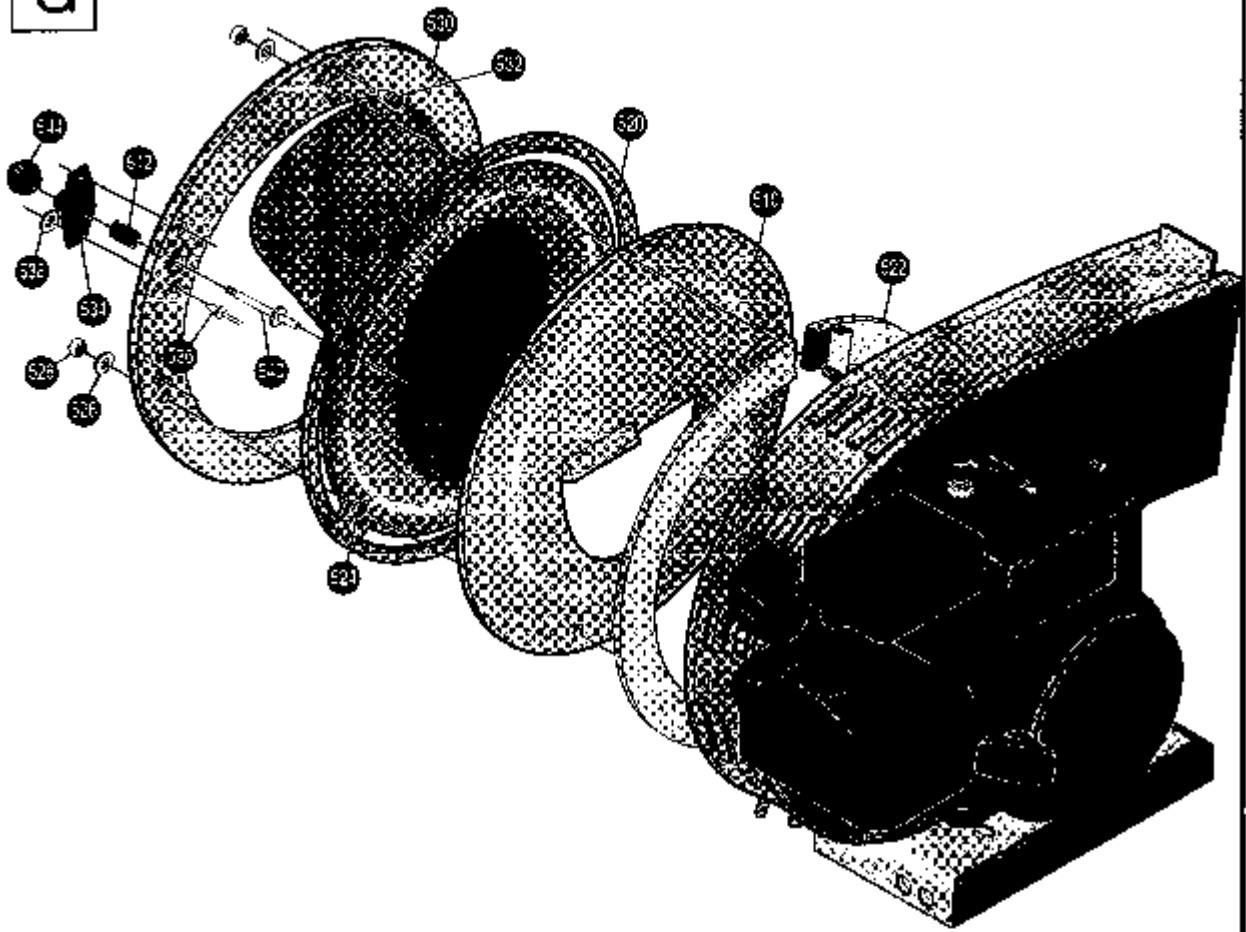

KEY #	PART #	DESCRIPTION
510	533 32 28-64	PLATE, STATION ROTATE CHUTE
520	533 32 27-77	TUBE & PLATE, ASSEMBLY CHUTE
522	533 32 33-38	SEAL, SHREDDER CHUTE
524	533 32 27-38	BUSHING, ROTATE CHUTE
526	533 99 64-16	WASHER, FLAT .391 X 1.00 X .125
528	533 00 14-99	NUT, 3/8-16 REGHCTRLK
530	533 32 27-76	RETAINER COVER
532	533 32 41-97	FITTING, LUB-PRESS FIT
534	533 32 39-32	RETAINER, SPRING
536	533 04 67-63	RIVET, POP .107DIA X .450LG
538	533 41 41-06	FLATWASHER, .188X.38X.040
540	533 32 27-41	RELEASE, HANDLE
542	533 32 27-39	SPRING, COMPRESSION
544	533 32 50-83	KNOB, .75 DIA.

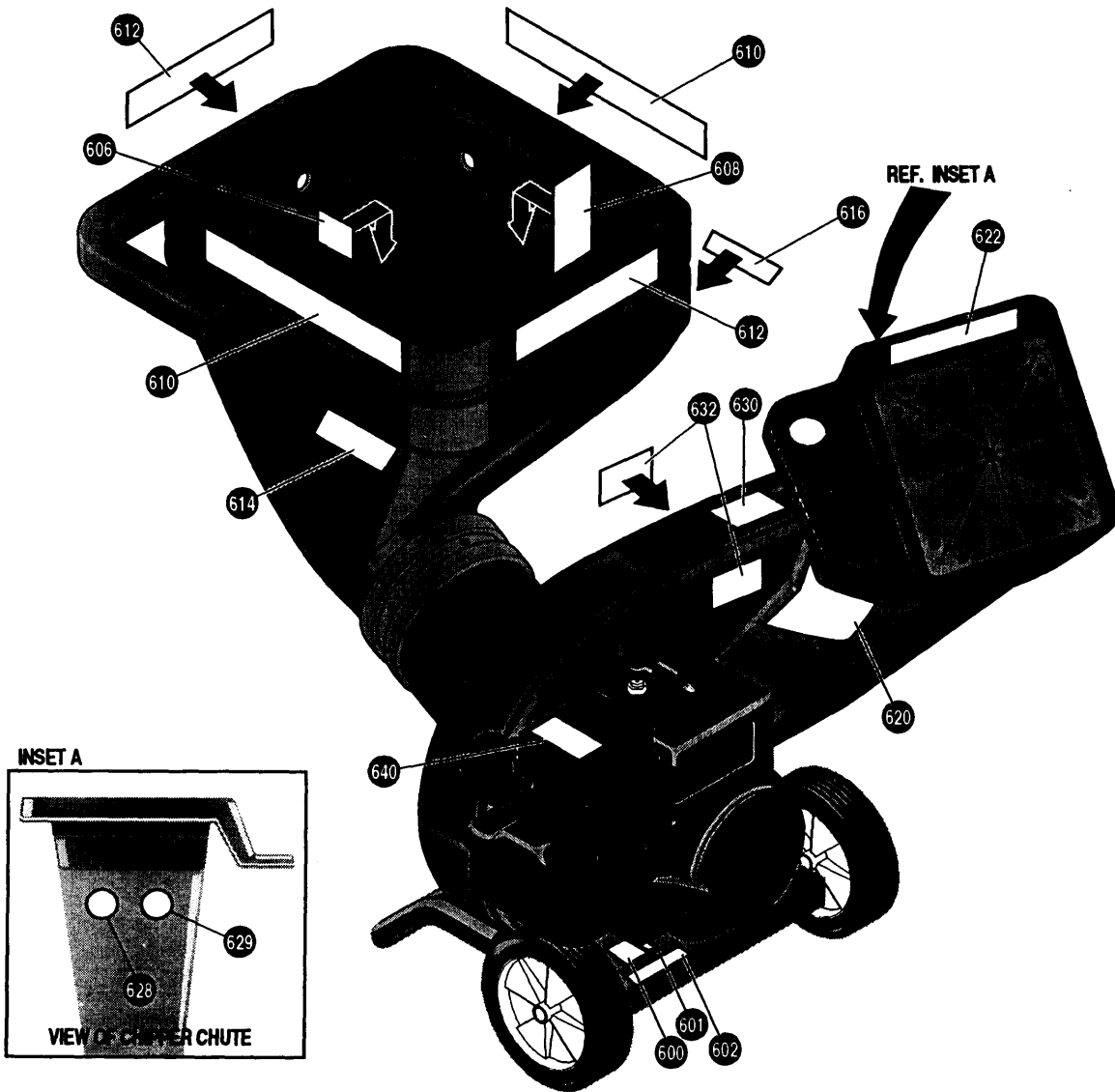

KEY#	PART#	DESCRIPTION
600		REFERENCE ONLY
601		REFERENCE ONLY
602		REFERENCE ONLY
608	533 33 01-76	DECAL, EXPORT, CAUTION GER
608	533 33 04-50	DECAL, EXPORT, CAUTION ENG/FR
620	533 33 04-51	DECAL, OPERATOR ENG/FR
620	533 33 01-77	DECAL, OPERATOR GER
620	533 40 22-64	DECAL, DUAL PRO
622	533 32 68-78	DECAL, CHIPPER CAP DANGER
628	533 40 22-61	DECAL, HEARING PROTECTION
629	533 40 22-60	DECAL, EYE PROTECTION
630	533 33 01-78	DECAL, EXPORT, DANGER GER
630	533 33 04-52	DECAL, EXPORT, DANGER ENG/FR
630	533 40 22-64	DECAL, DUAL PRO
632	533 32 87-43	DECAL, DANGER, FASTEN HOPPER
640	533 30 27-78	DECAL, DANGER MUFFLER

I

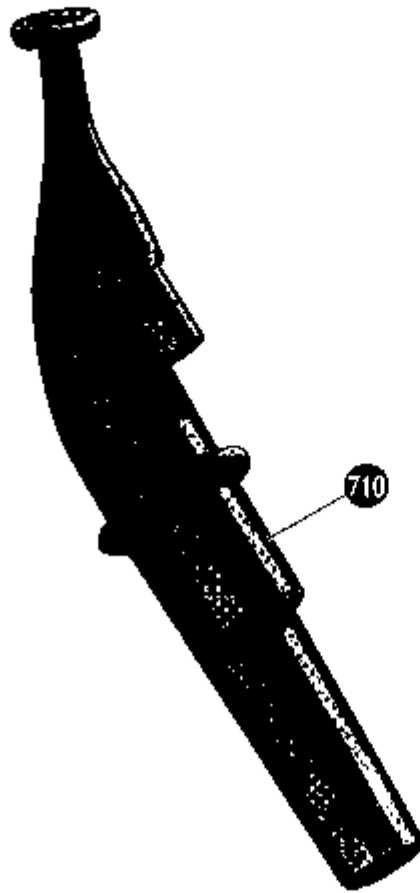

KEY #	PART #	DESCRIPTION
710	533 32 72-43	TAMPER, CHIP/SHRED

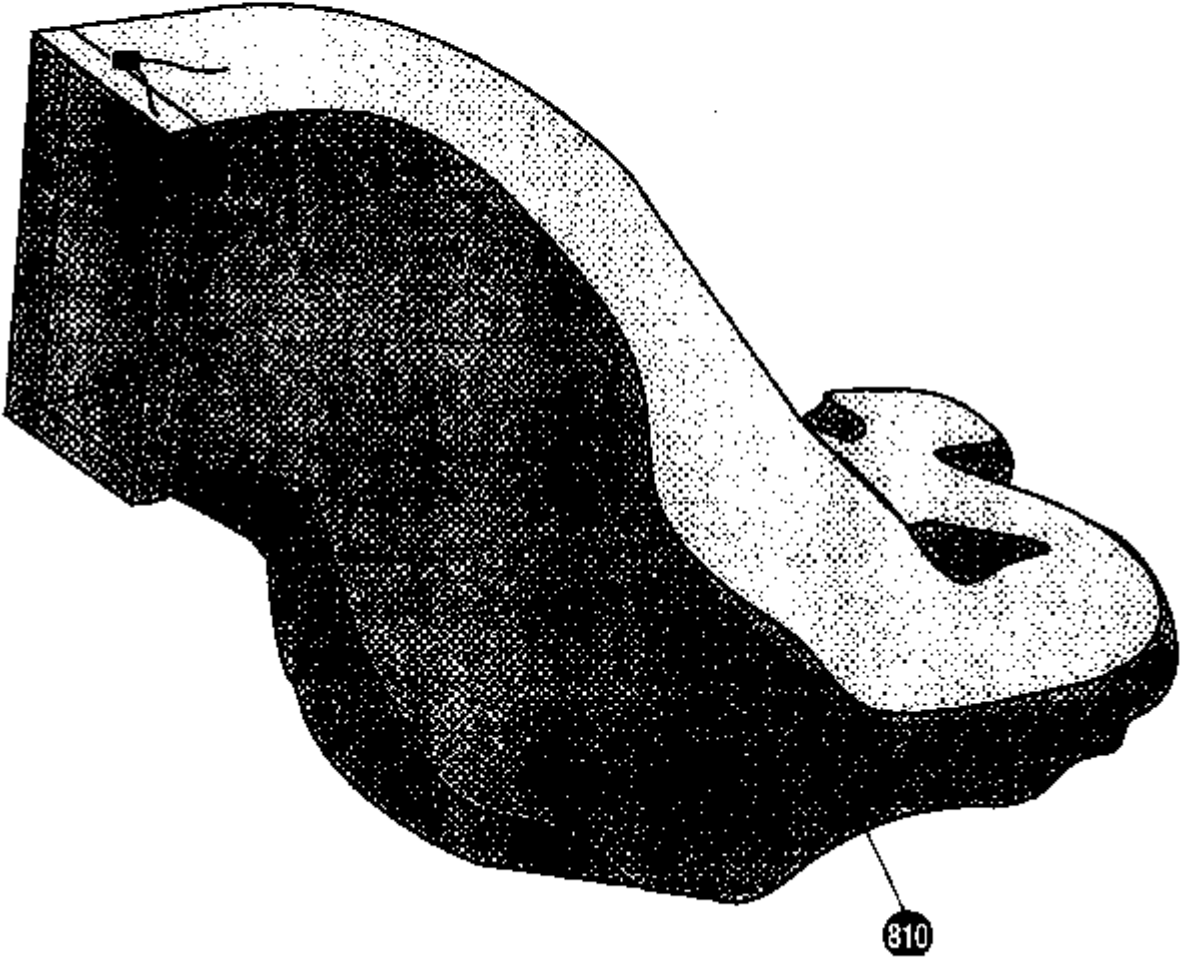

KEY#	PART#	DESCRIPTION
810	533 32 03-76	BAG, COLLECTOR, DRAWSTRING

