

INSTALLATION INSTRUCTIONS FOR HEADLIGHT KIT PART NO. 539110440

1. Remove existing colored lens plates and trim rings (rim) from each fender.
2. Remove accessory wiring harness from parts box and place it between the rear side of the battery, in front of the rear cross member, with the plug in connector to right rear corner of the battery.
3. Connect the male end of the plastic plug on the accessory harness into the female end of the main wiring harness, located near the right rear corner of the battery
4. Route the short, right hand light socket through the rubber grommet where the other harness and cable pass through.
5. Route the longer, left side of accessory harness just over the top of the vertical chassis side, between the inside edge of left fender, just behind the front inner most fender mounting screw. See Figure 1.
6. Install the new trim ring (rim) with the third snap facing inward into the appropriate fenders. Makes sure entire ring is fully seated against the fender.
7. Next, slide the appropriate reflector into the opening in the trim ring (rim). Install the light socket, with light bulb in place, into the backside hole of each reflector. Rotate light socket approximately $\frac{1}{4}$ turn clockwise to secure. See Figure 2.

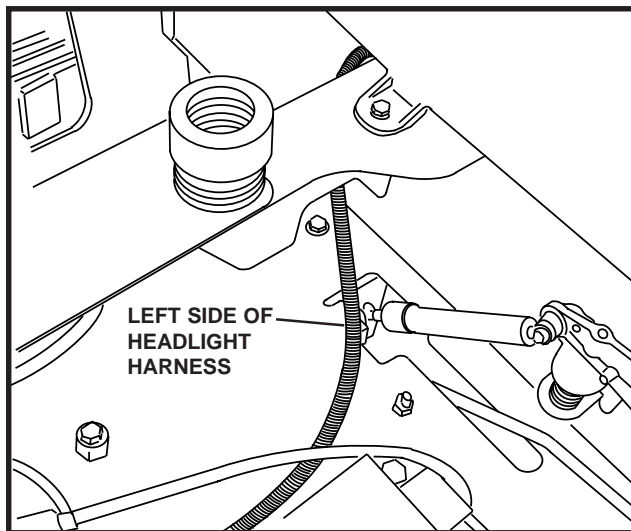

FIGURE 1

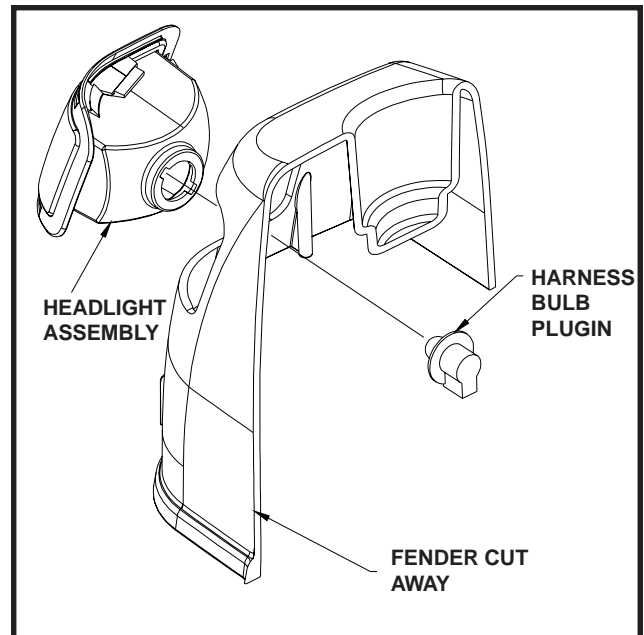
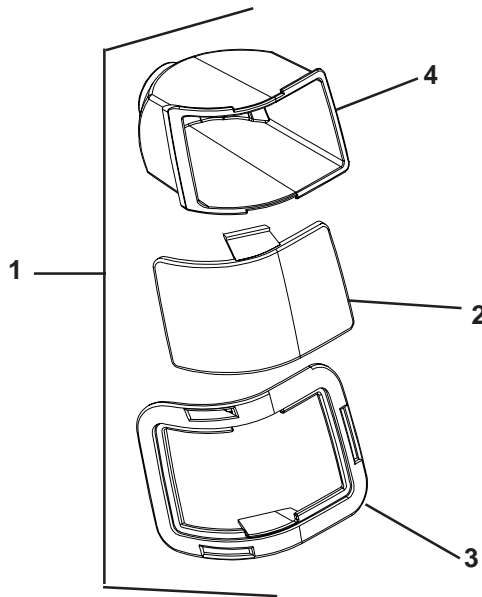

FIGURE 2

8. Snap the clear lens in place to secure the reflector on each side.
9. Turn ignition key to the first position to verify lights work. If they do not, make sure connector in accessory harness is properly installed, light bulb(s) are correctly install in light socket. Turn key off when completed.



ITEM	PART NO.	QTY	DESCRIPTION
1	539110458	1	HEADLIGHT ASSEMBLY, RIGHT
	539110459	1	HEADLIGHT ASSEMBLY, LEFT
2	539110457	1	HEADLIGHT LENS, LEFT
	539110453	1	HEADLIGHT LENS, RIGHT
3	539110451	1	RIM, HEADLIGHT, RIGHT
	539110455	1	RIM, HEADLIGHT, LEFT
4	539110456	1	HEADLIGHT REFLECTOR, LEFT
	539110452	1	HEADLIGHT REFLECTOR, RIGHT
	539110471	1	HARNESS, HEADLIGHT (NOT SHOWN)