

TS 510G

Spare Parts
Pieces de rechange
Piezas de repuestro

TS 510G

PART NO.	POS.	DESCRIPTION	PART NO.	POS.	DESCRIPTION
014 02 48-58	B	Switch Plate	542 03 23-66*	B	Nut, Keps .313
539 30 00-74	K	Collar, Set - 1/2" ID	542 03 23-72*	A	Curtain, Splash - TS510
539 30 05-00	G2	Engine, 13HP Honda	542 03 25-01*	C	Shim, Brass .005 Thick
539 30 14-34	G2	Engine, 9HP Honda W/Cyclone	542 03 25-02*	C	Shim, Brass .015 Thick
542 02 00-10*	B	Key, Woodruff #405	542 03 25-03*	C	Shim, Brass .020 Thick
542 02 00-22*	A	CB, .375-16 x 2.50	542 03 25-70*	B	Screw, Adjustment
542 02 00-24*	A	CB, .625-11 x 2.50	542 03 25-80*	B	Stop Sleeve
542 02 00-41*	C	Key, .25 Sq X 1.5 Lg	542 03 40-02*	K	Wheel, 10" x 2.375 x .625 Bore
542 02 00-49*	F	Hose Clamp, Worm Drive SAE004	542 04 01-39*	B	Fitting, Grease 1/8 NPT
542 02 00-68*	G2	Key, Sq .25 X 2.75	542 04 01-84*	B	Boot, Rubber, 4" Lg
542 02 00-71*	G2	Key, .25 Sq X 2.25	542 04 53-98*	C	V-Belt: 3VX475
542 02 01-36*	A	Nut, Std Hex .375-16	542 04 61-28*	J	Decal: Warning (Blade Guard Size)
542 02 01-71*	C	Nut, Hex Jam Thin .375-24	542 04 87-40*	B	HHCS, .375-16 X 1.25 Gr 5
542 02 01-75*	B	Nut, Hex Jam Thin .625-11	542 04 87-40*	K	HHCS, .375-16 x 1.25 Gr5
542 02 01-77*	C	Nut, Hex Jam Thin .5-13	542 05 21-20*	B	Switch, Toggle
542 02 01-94*	J	Locknut, Fiber 10-24	542 06 04-60*	J	Yoke End
542 02 01-95*	B	Locknut, Fiber .25-20	542 06 04-65*	J	Pin, Clevis .375 Dia
542 02 01-96*	A	Locknut, Fiber Thin .375-16	542 09 05-78*	J	Water Valve, 1/4NPT M x 1/4NPT F
542 02 01-97*	A	Locknut, Fiber .3125-18	542 0A 78-73*	NS	Inst Sht: Bld Shift & Hsg - TS 510
542 02 01-99*	B	Locknut, Fiber .375-16	542 13 92-73	C	Brg w/seal, 20ID x 47OD x 14mm
542 02 02-01*	B,K	Locknut, Fiber .5-13	542 13 95-68	B	Grip, Handle
542 02 02-11*	B	Nut, Acorn .5-13	542 13 95-81*	B	Spring, Foot Pedal
542 02 02-61*	B	Clamp, Hose A22	542 13 96-82*	C	Pulley 3G3V2.65 - 1.0 w/SS
542 02 03-01*	E	HHCS, .25-20 X .625 Gr 5	542 16 77-42*	K	Spacer, 3/8 ID x 11/16ly, Plastic
542 02 03-06*	AA31	HHCS, .25-20 X 1 Gr 5	542 16 00-80*	B	Pin, Clevis .50 Dia x 1.13 Lg
542 02 03-13*	C	HHCS, .3125-18 X .75 Gr 5	542 16 01-64*	B	Pin, Yoke
542 02 03-16*	C	HHCS, .3125-24 X 1 Gr 5	542 16 07-45*	B	Connector, Snap Plug
542 02 03-19*	A	HHCS, .3125-18 X 3.75 Gr 5	542 16 11-58*	F	Bulb, Primer
542 02 03-23*	G1	HHCS, .375-16 X 1 Gr 5	542 16 11-59*	F	Strainer, Suction
542 02 03-29*	G2	HHCS, .375-16 X 2.75 Gr 5	542 16 11-76*	J	Fitting, 1/4 NPT X 3/8 Barb
542 02 03-31*	A	HHCS, .375-16 X 3.25 Gr 5	542 16 11-81*	F	Barb, Elbow
542 02 03-52*	K	HHCS, .5-13 x 5	542 16 11-96	G2	Isolator, Engine 30-35 Duro (1 Dot)
542 02 03-53*	B	HHCS, .5-13 X 5.5 Gr 5	542 16 11-97*	G2	Isolator, Engine 40-45 Duro (2 Dots)
542 02 03-61*	K	HHCS, .625-11 x 3.75	542 16 26-85*	K	FLHCS, 1/4-20 x 1.5
542 02 03-67*	A	HHCS, .3125-18 X 3.5 Gr 5	542 16 31-87*	G2	Washer, SP .0625 X.375x1.5
542 02 03-74*	A	HHCS, .3125-18 X 3 Gr 5	542 16 70-35*	B	Pin, Cotter Hair Spring.5-.625
542 02 03-76*	G1	HHCS, .3125-18 X 4.5 Gr 5	542 16 71-33	G2	Adapter, M12 X 10mm Hose Bard
542 02 03-78*	C	HHCS, .5-20 X 1 Gr 5	542 16 73-05*	G2	Hose Assy-Oil Drain (M16 x 6.5"Lg)
542 02 03-80*	B	HHCS, .375-16 X 1.75 Gr 5	542 16 73-06	G2	Cap, Blanking (Oil Drain)
542 02 04-24*	J	RHMS, #10-32 X .375 Brass	542 16 76-22	G2	Nut, Tube-M16 (Oil Drain)
542 02 04-25*	J	RHMS, #10-32 X .5 Brass	542 16 81-33*	C	HHCS, .375-24 X 1 Gr 5
542 02 05-09*	B	HHCS, .375-16 X 2.00 Gr 5	542 16 90-65	G1	Decal: Muffler
542 02 05-41*	C	SHSS, .25-20 X .375 CUP HK	542 16 93-65*	J	Guard, Splash
542 02 05-48*	B	SHSS, 10-24 X .375 CUP HK	542 17 00-38*	E	Vinyl Tubing, 3/8 ID
542 02 05-50*	G2	SHSS, Cup .313-18 x .375	542 17 01-50*	C	CB, .375-16 X 1"
542 02 06-11*	J	Pin, Cotter .094 x .625	542 17 21-41*	F	T-Knob, 1/4-20 X 1
542 02 07-01*	J	Pop Rivet, USM #D88BS	542 17 47-40*	G2	Hose Clamp, Worm Drive SAE006
542 02 07-39*	J	Washer, Flat #10	542 17 49-99*	B	Assy, Cord
542 02 07-41*	F	Washer, Flat .25	542 17 73-17*	F	Water Pump, Mechanical
542 02 07-42*	A	Washer, Flat .313 Dia	542 17 73-54*	F	Pulley 1G3V2.65-.625 w/SS
542 02 07-43*	G2	Washer, Flat .375 Dia	542 17 73-83*	A	Wrench: .75 X .50 Box End
542 02 07-44*	G2	Washer, Flat .4375	542 17 75-88*	J	Decal, Warning, Large
542 02 07-45*	B	Washer, Flat .5	542 17 78-94*	E	Insert, Wood, 15-7/8" Lg
542 02 07-62*	B	Washer, Flat .250 SAE	542 17 79-04*	E	RHWS, #8 X 1.25" Std
542 02 07-63*	E	Washer, Flat .312 SAE	542 17 79-73*	C	Collar, Inner, Black Oxide
542 02 07-64*	J,K	Washer, Flat SAE .375	542 17 79-76*	E	Decal, Ruler Set, TS 510
542 02 07-66*	B	Washer, Flat .500 SAE	542 18 09-87*	E	Knob, Tee 5/16-18 x 1.00
542 02 07-67*	K	Washer, Flat .625 SAE	542 18 11-43*	G2	HHCS: .375-24 X 1.50
542 02 07-85*	C	Lockwasher, Split .3125	542 18 13-61*	G1	Grommet
542 02 07-86*	G2	Lockwasher, Split .375	542 18 33-75*	G2	Hole, Plug: 3/4"
542 02 07-87*	G2	Lockwasher, Split .4375	542 18 38-84*	B	Spherical Washer Set
542 02 14-16*	B	HHCS, .3125-18 X 1 Gr 5	542 18 60-00*	E	Cart, Conveyor w/ Rubber Top
542 03 00-04	C	Washer, Spring Finger Load	542 18 60-28*	C	Snap Ring, External (2.25 Dia)
542 03 03-51*	E	Guide, Measuring Assy	542 18 60-57*	E	Backstop, Conveyor Cart, TS510
542 03 03-86*	A	Drain Plug Assembly	542 18 60-73*	J	HHMS, #10-24 X .50"
542 03 08-22*	B	Wheel, Cart	542 18 60-97*	F	Hose Barb Elbow, 3/8"H X 3/8N
542 03 08-40*	J	Link	542 18 61-29*	C	Bearing, 1" ID x 52mm OD
542 03 08-60*	J	Track Bright Zinc Plt G/M	542 18 61-67*	G2	HHCS, .438-20 x 1.50"
542 03 08-70*	J	Manifold, Water	542 18 62-24*	C	SHSS, .312-18 x .75"
542 03 08-75*	J	Gasket, Water Manifold	542 18 62-54*	A	Bearing, Lower Pivot
542 03 08-84*	A	Skid, 2 x 4 x 47.5 Lg	542 18 62-56*	A	Bearing, Upper Pivot
542 03 08-91*	J	Tube, Water Assy - 20"	542 18 62-60*	B	HHCS, .500-13 X 12" FT
542 03 09-51*	C	Flange, Outer	542 19 04-10	F	Tubing, Vinyl, .375 ID X 36"
542 03 10-37*	J	Quick Disconnect Body	542 19 04-11	F	Tubing, Vinyl, .375 ID X 12"
542 03 10-39*	J	Stud, QD Ball	542 19 04-12	F	Tubing, Vinyl, .375 ID X 48"
542 03 22-40*	B	Crank Handle Assembly	542 19 04-15	G1	Decal, Lifting+Pump+Depth Stop
542 03 23-42*	A	Drain Hose, 1-7/8 ID x 14"	542 19 04-16	G2	V-Belt, 3 Band, 3G3VX425

NOTE: Part No's. that have an ASTERISK (*) suffix may not be active 9-digit numbers. The '542' prefix has been added to current 6-digit part numbers and '0' to 7 and 8-digit numbers.

TS 510G

PART NO.	POS.	DESCRIPTION	PART NO.	POS.	DESCRIPTION
542 19 04-18	E	Cart, Conveyor Assy - TS 510G			
542 19 04-34	B	Bearing, 2-Bolt Flange .500 ID			
542 19 07-25	C	Decal: Husqvarna Target GM TS510G			
542 19 07-33	C	Decal: Husqvarna, 9.5"			
542 19 07-34	A,C	Decal: Husqvarna, 5"			
542 19 50-18*	A	Blade Shaft, TS 510G			
542 19 50-39	C	HHCS, .500-13 x 5.00 FT			
542 19 52-32	C	Guard, Inner, Blade Belts, Galv			
542 19 52-36	A	Pulley, 3G3V3.35 - .75 w/SS			
542 19 52-37	A	Counter Drive Shaft, 1.00 OD			
542 19 52-55	G2	Clutch, 3G3V3.48OD - 1.0"			
542 19 52-81	G2	Pulley, 3G3V3.48OD - 1.0" w/SS			
542 19 53-24	D	Decal, Stop Switch, TS 510G			
542 19 54-04	G1	Shield Wldmt, Water Pump, Galv			
542 19 54-07	A	Pulley, 3G3V4.50OD - 1.0" w/SS			
542 19 71-01*	B	Cable Tie, Plastic 8" X .094			
542 20 53-42	A	Arbor, Housing, PC H. Grey			
542 20 53-43	A	Depth Stop, PC Grey			
542 20 53-44	C	Frame Wldmt, TS510G, PC H Orange			
542 20 53-45	C	Spacer, Head Platfrm, PC H Grey			
542 20 53-46	A	Belt Guard, TS510G, PC H Orange			
542 20 53-47	G2	Bracket Wldmt, Tension, PC H Grey			
542 20 53-48	G1	Front Pulley Guard, PC H Grey			
542 20 53-49	G1	Support Tilt Arm, PC H Grey			
542 20 53-50	B	Tilt Frame Wldmt, TS510G, PC H. Grey			
542 20 53-51	B	Brkt, Spring, Foot Pedal, PC H Grey			
542 20 53-52	B	Foot Pedal Wldmt, PC H. Grey			
542 20 53-53	A	Head Platform Wldmt, PC H. Grey			
542 20 53-54	A	Hd Pivot Pltfrm Wldmt, PC H. Grey			
542 20 53-55	G2	Mount, Isolatr, 9H & 13H, PC H Grey			
542 20 53-56	G2	Base, Engine, 9H & 13H, PC H Grey			
542 20 53-57	G1	Platform Brkt, Eng, PC H Orange			
542 20 53-58	G1	Guard, Eng Belt, PC H Orange			
542 20 53-59	F	Brkt, W/P, TS510G, PC H Grey			
542 20 53-64	B	Tilt Adjust Yoke, PC H. Grey			
542 20 53-67	G1	Eye Nut, Saw Tiedown - PC H Grey			
542 20 53-77	A	Nut Plate Weldment, PC H. Grey			
542 20 53-78	A	Front Anchor, PC H. Grey			
542 20 53-82	B	Adj. Nut Weld Assy. PC H. Grey			
542 20 53-84	B	Handle, Tubing, PC H. Grey			
542 20 54-31	K	Lever Weldment, PC H. Orange			
542 20 54-32	K	Handle Lever, H. Orange			
542 20 54-33	K	Stop Plat, PC H. Orange			
542 20 54-42	J	Blade Guard Assy- Compl 20"			
MISC ITEMS & SPECIAL KITS			LEGEND		
542 20 11-06	N/S	OM Op Instr: TS 510G – 9H & 13H	BHMS		Button Head Machine Screw
542 20 11-07	N/S	IPL Parts List: TS 510G – 9H & 13H	FLHMS		FLat Head Machine Screw
			HHCS		Hex Head Cap Screw
			HWHSTS		Hex Washer Head Self-Tapping Screw
542 17 74-24	F	Kit, Water Pump Repair	RHMS		Round Head Machine Screw
542 20 54-41	B	Kit, Bladeshaft Assy, TS 510G	SBHMS		Socket Button Head Machine Screw
542 03 40-00	K	Kit, Wheel Around - TS 310	SHCS		Socket Head Cap Screw
000 A0 30-00	K	Instr Sheet: Wheel-Around Kit	SHSS		Socket Head Set Screw
			STS		Self-Tapping Screw
			PHCS		Pan Head Cap Screw
			PHMS		Pan Head Machine Screw
			PHSTS		Pan Head Self-Tapping Screw
			FT		Full Thread
			Gr		Grade

NOTE: Part No's. that have an ASTERISK (*) suffix may not be active 9-digit numbers. The '542' prefix has been added to current 6-digit part numbers and '0' to 7 and 8-digit numbers.

A Frame Assembly

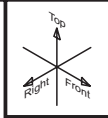

09.06.06

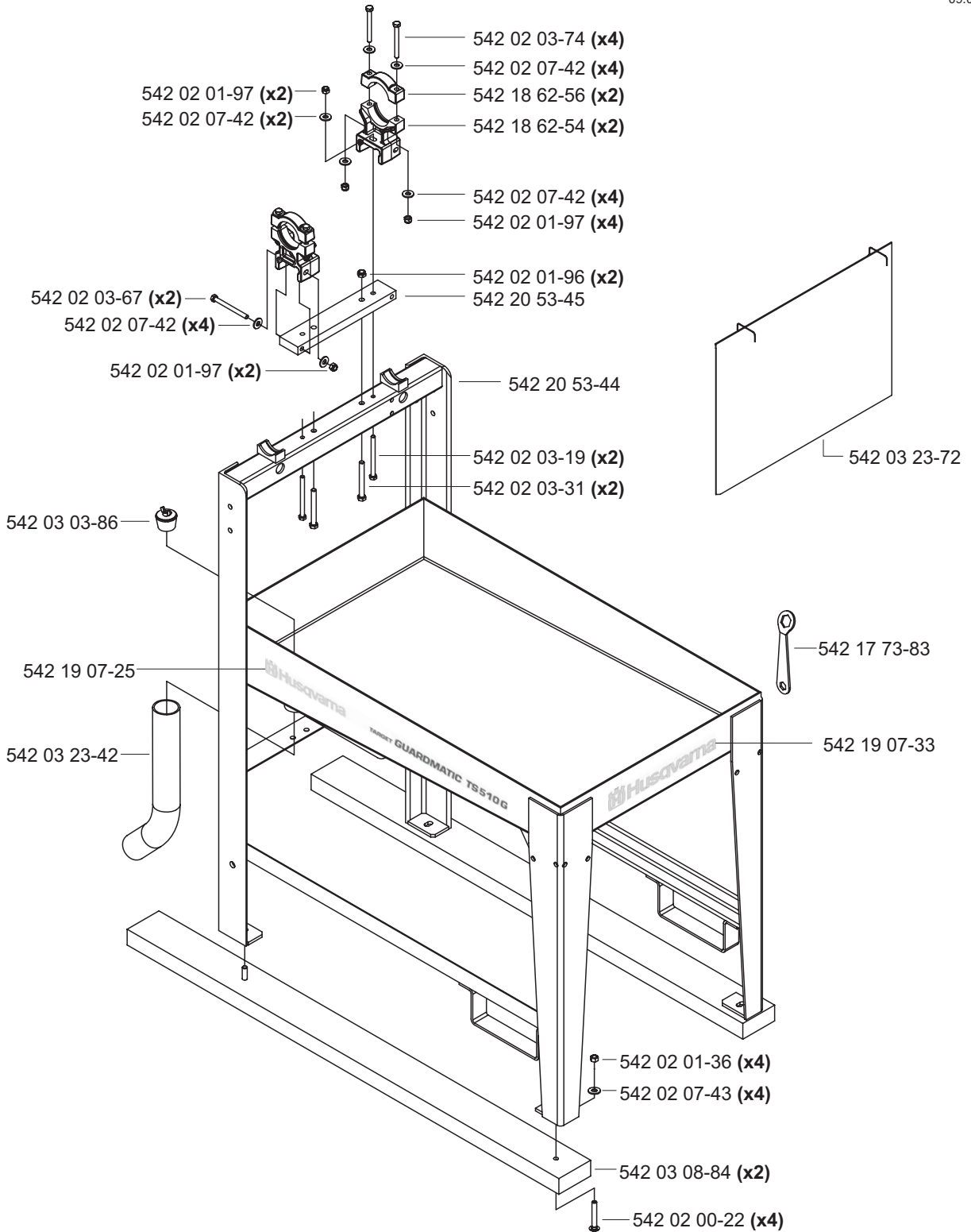

 Husqvarna — 542 19 07-33

 Husqvarna

TARGET GUARDMATIC TS510G — 542 19 07-25

B Foot Pedal Assembly

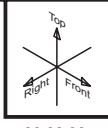

09.06.06

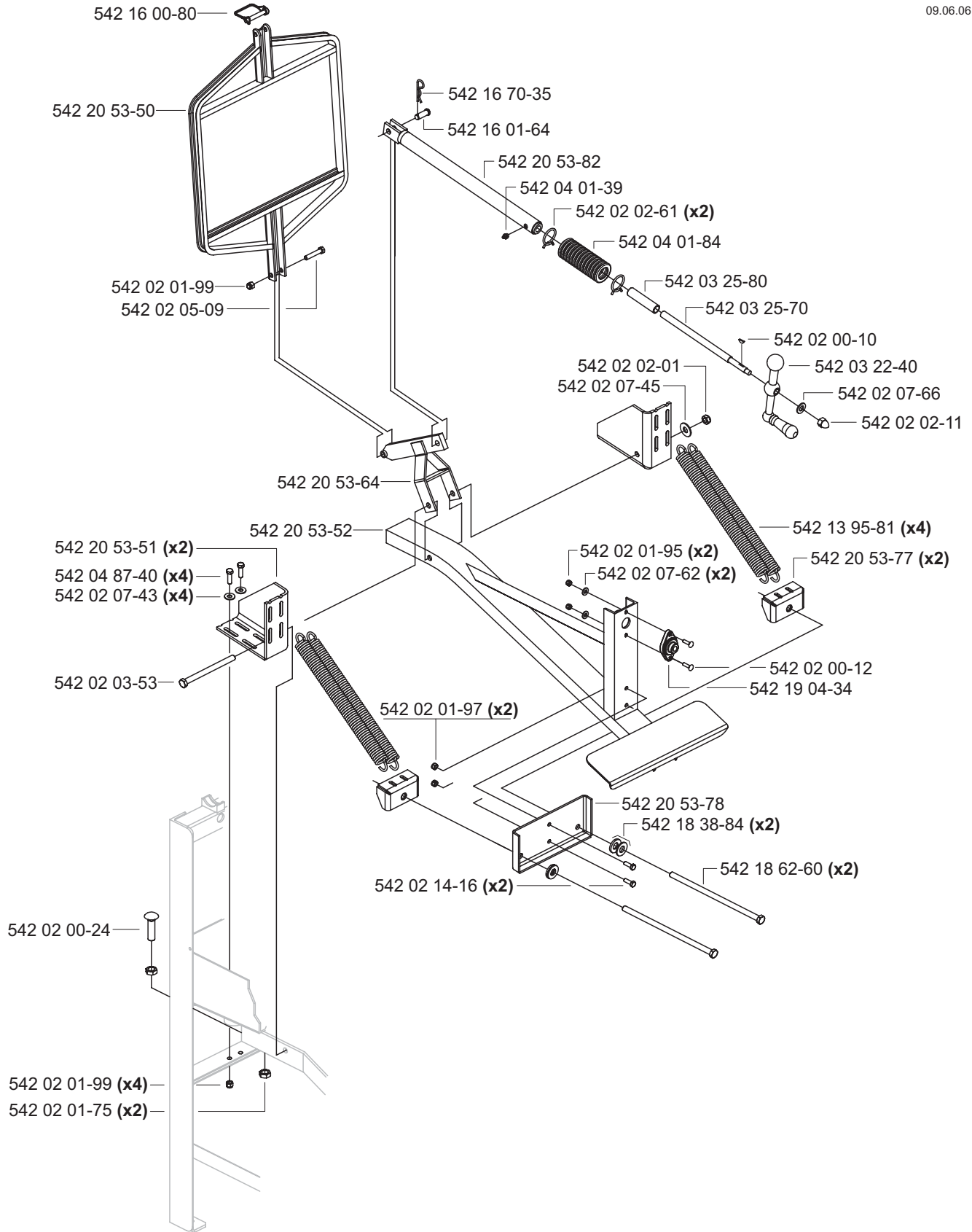

C Head Platform Assembly

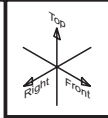

09.08.06

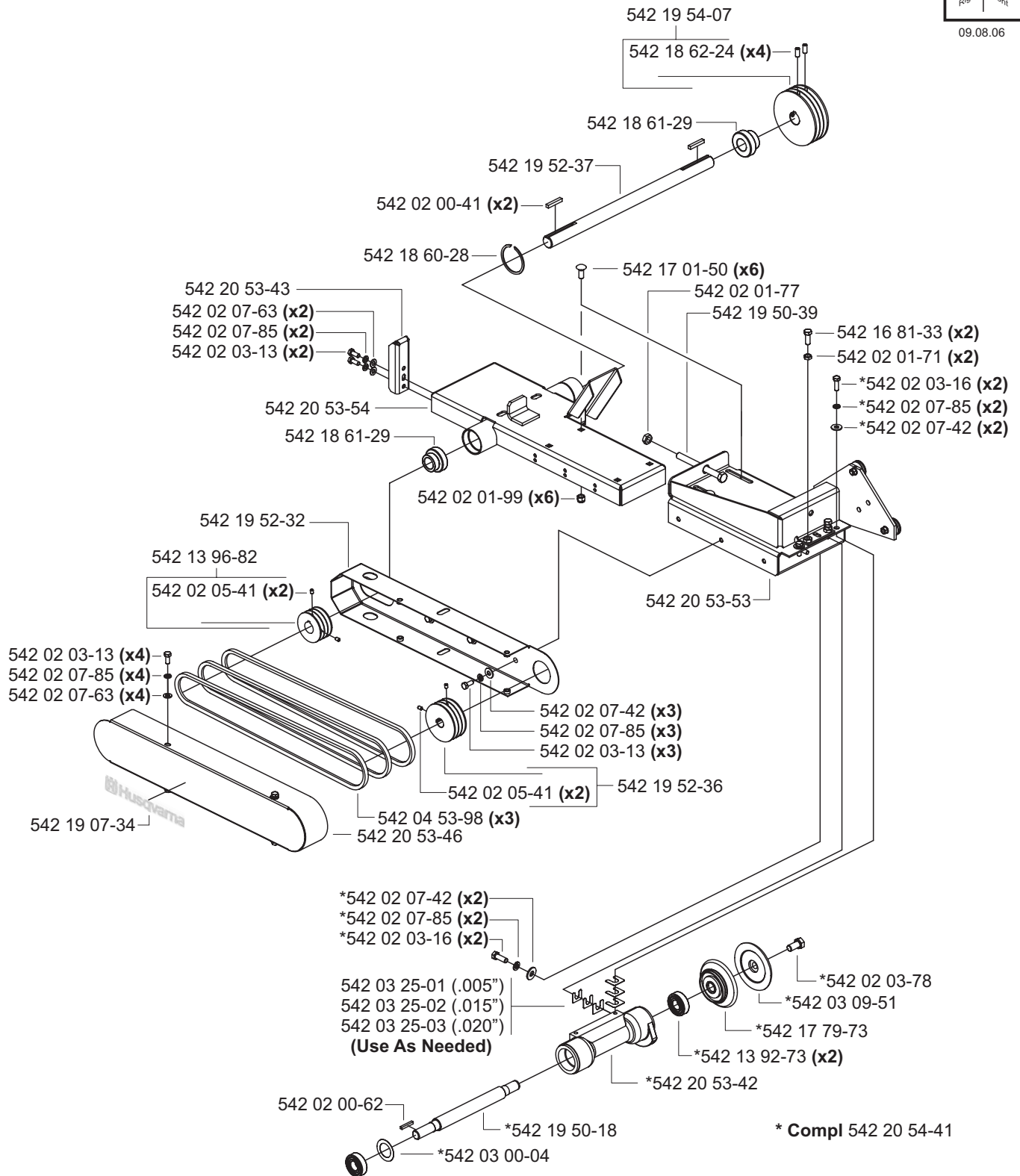

542 19 07-34

D Handle & Switch Assy

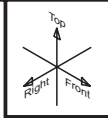

10.31.06

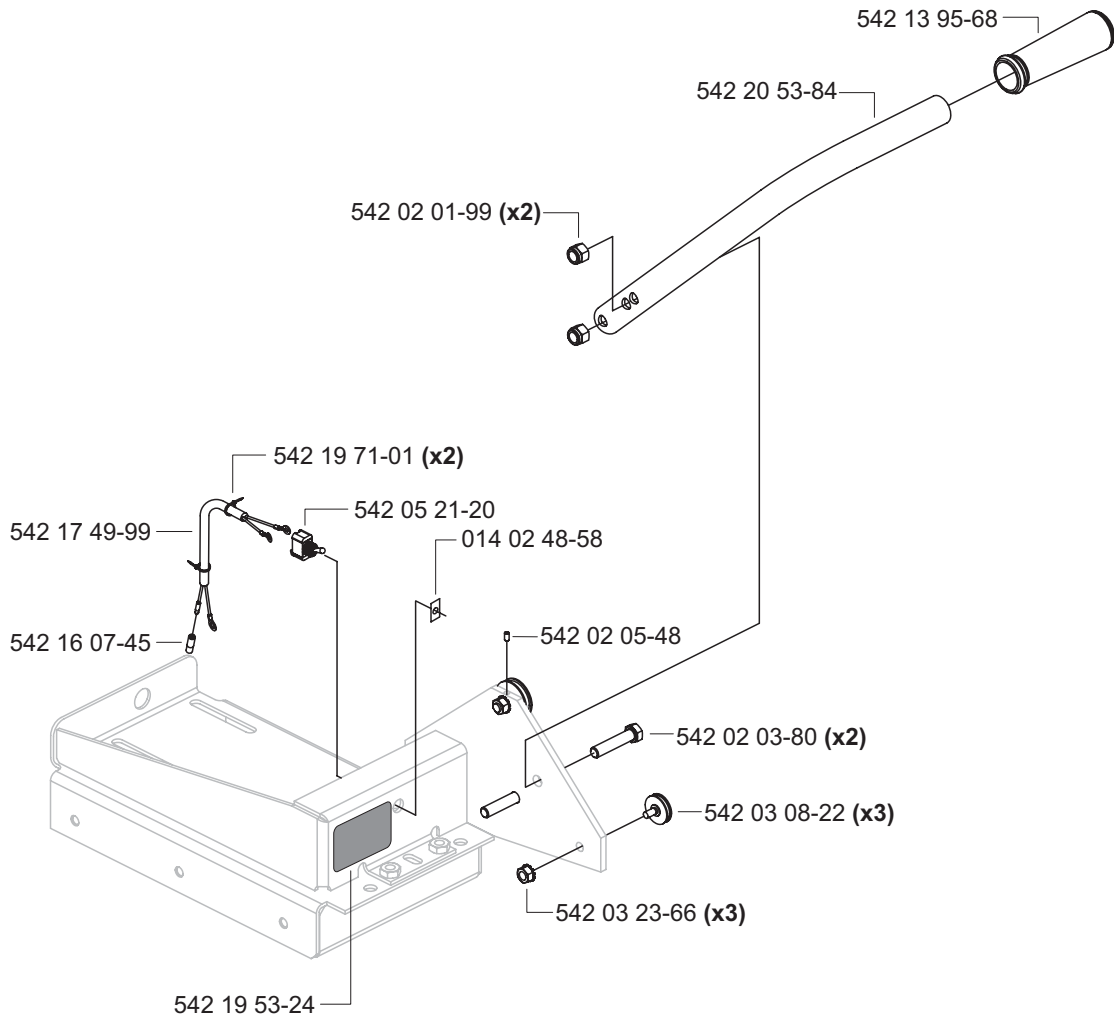



542 19 53-24

Switch Must Be In "Start" (ON) Position Before Starting Engine.

START
ARRANQUE 

STOP ENGINE
PARADA MOTOR





E Conveyor Cart Assembly

*542 19 04-18 Compl

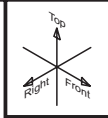

09.06.06

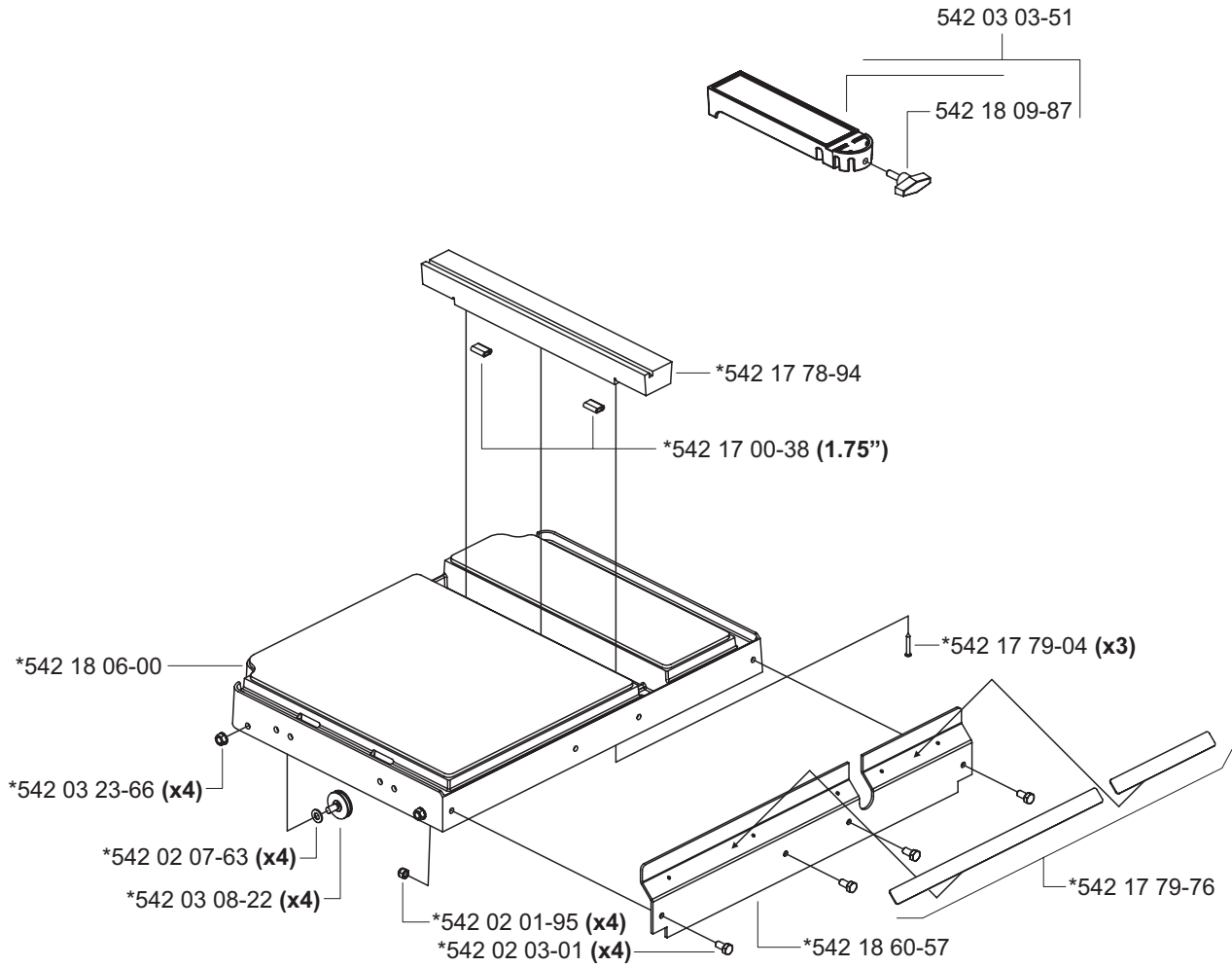

F Water Pump Assembly

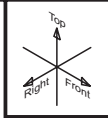

10.31.06

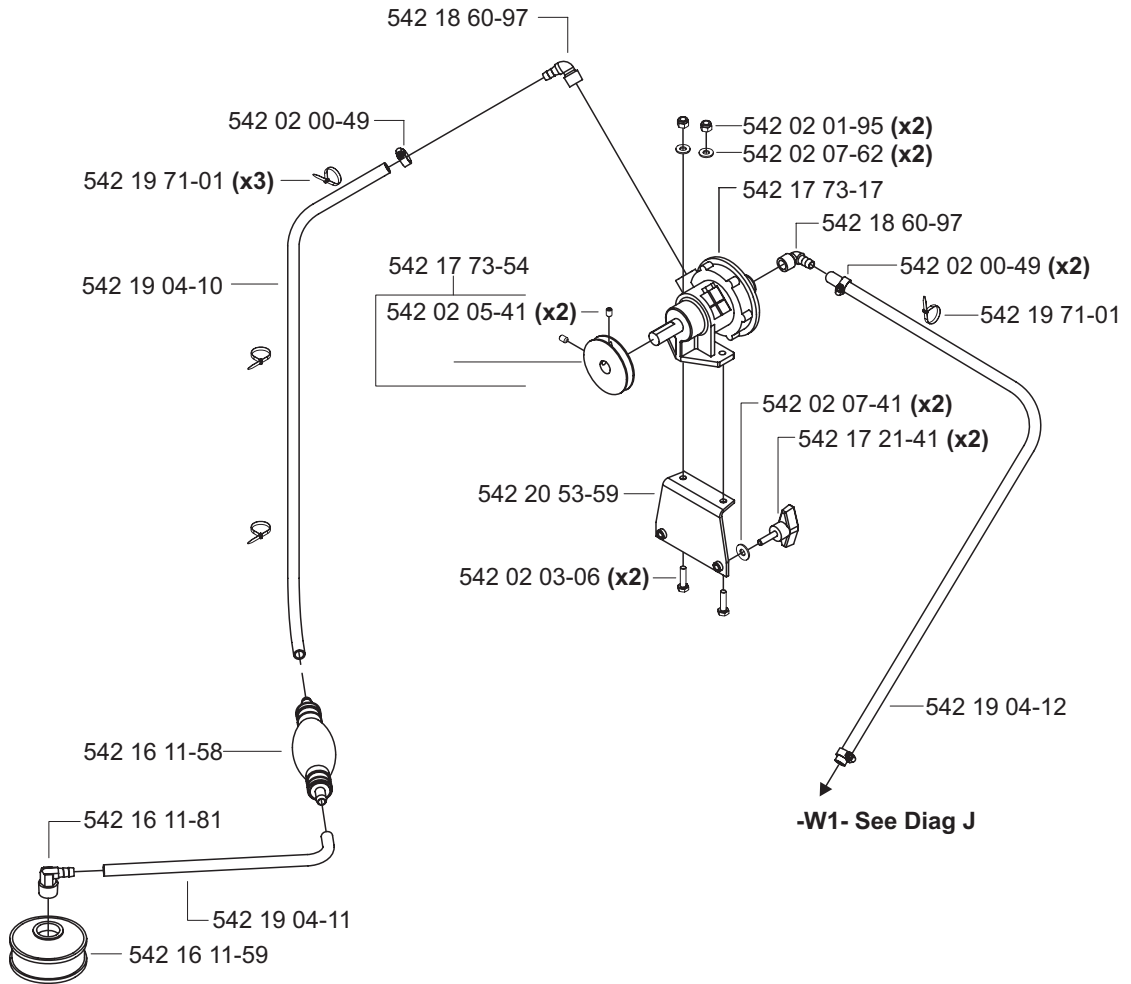

542 17 73-17 Pump Compl

*542 17 74-24 Kit, Repair

(Includes 2 shims not shown)

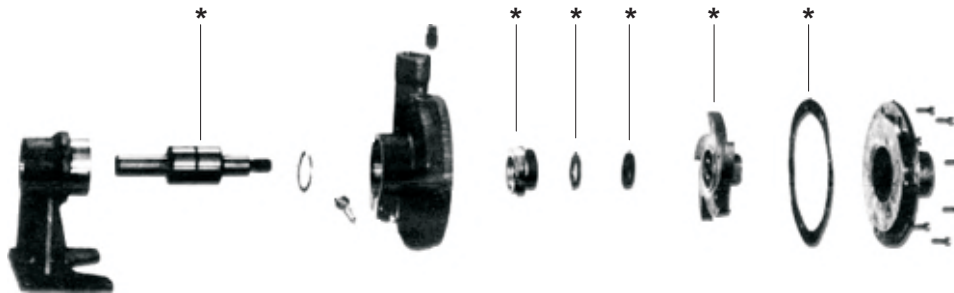

G1 Engine Mounting Assembly

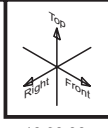

10.30.06

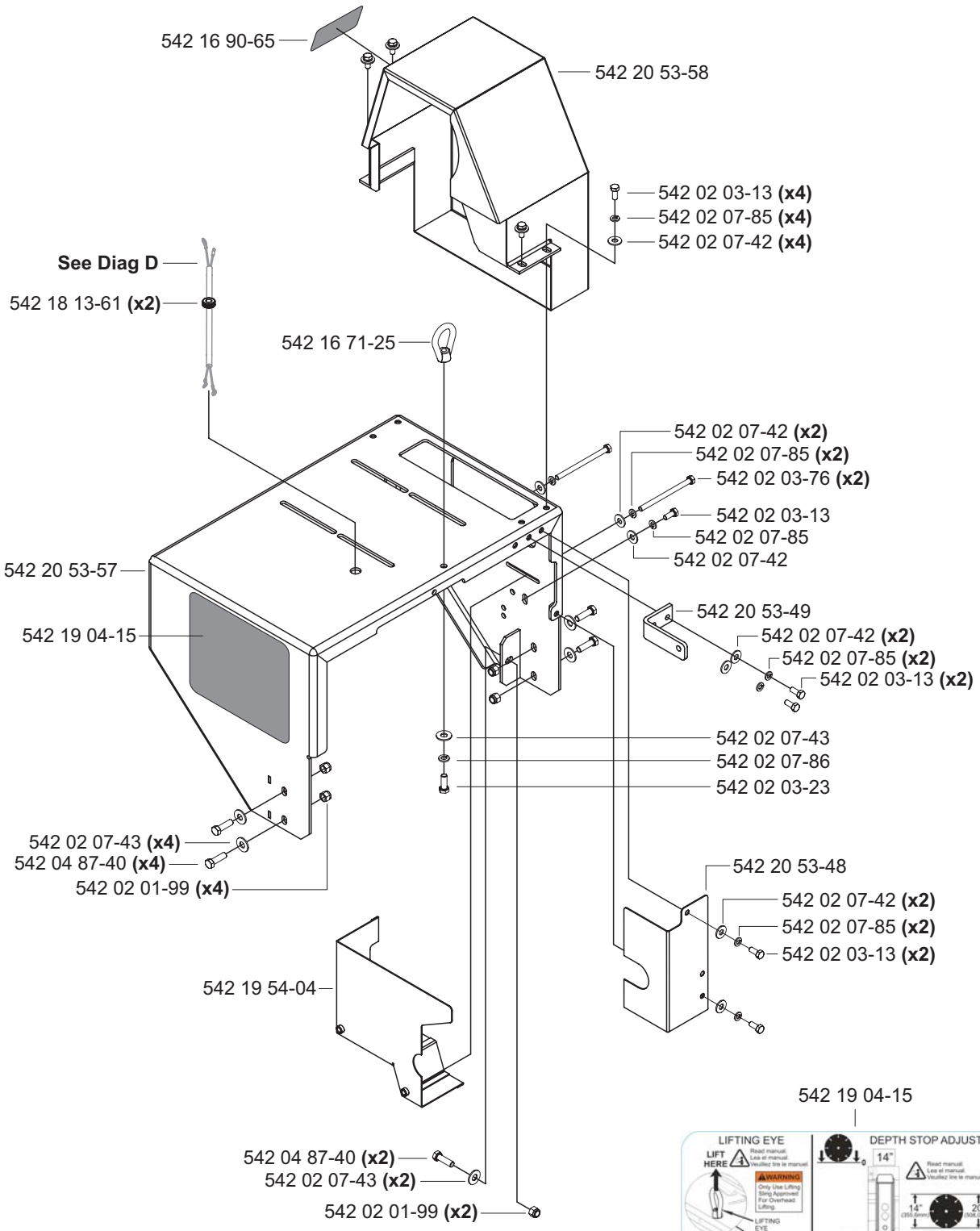

WARNING

Muffler Is HOT!
May Cause Burns And / Or
Ignition Of Material.
Avoid Contact!

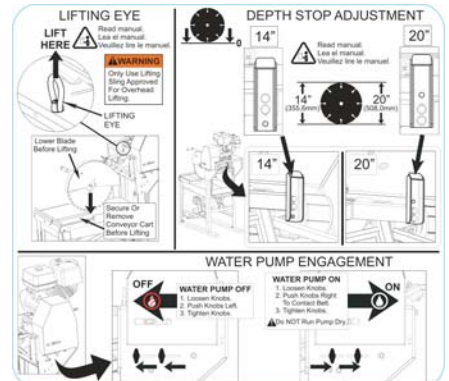

G2 Engine Mounting Assembly

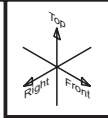

10.30.06

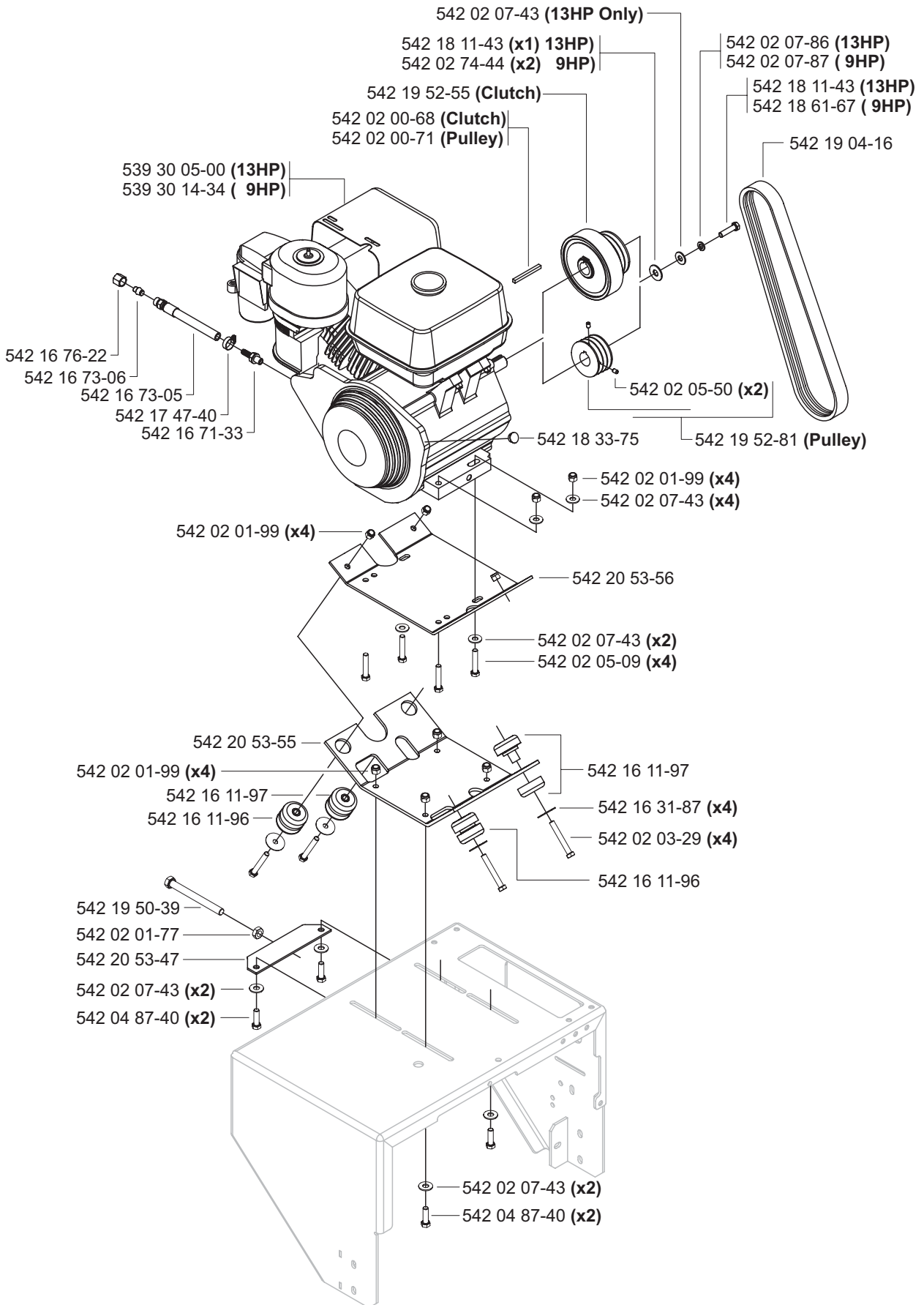

J Blade Guard Assembly

*542 20 54-42 Compl - 20"

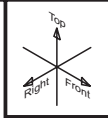

10.30.06

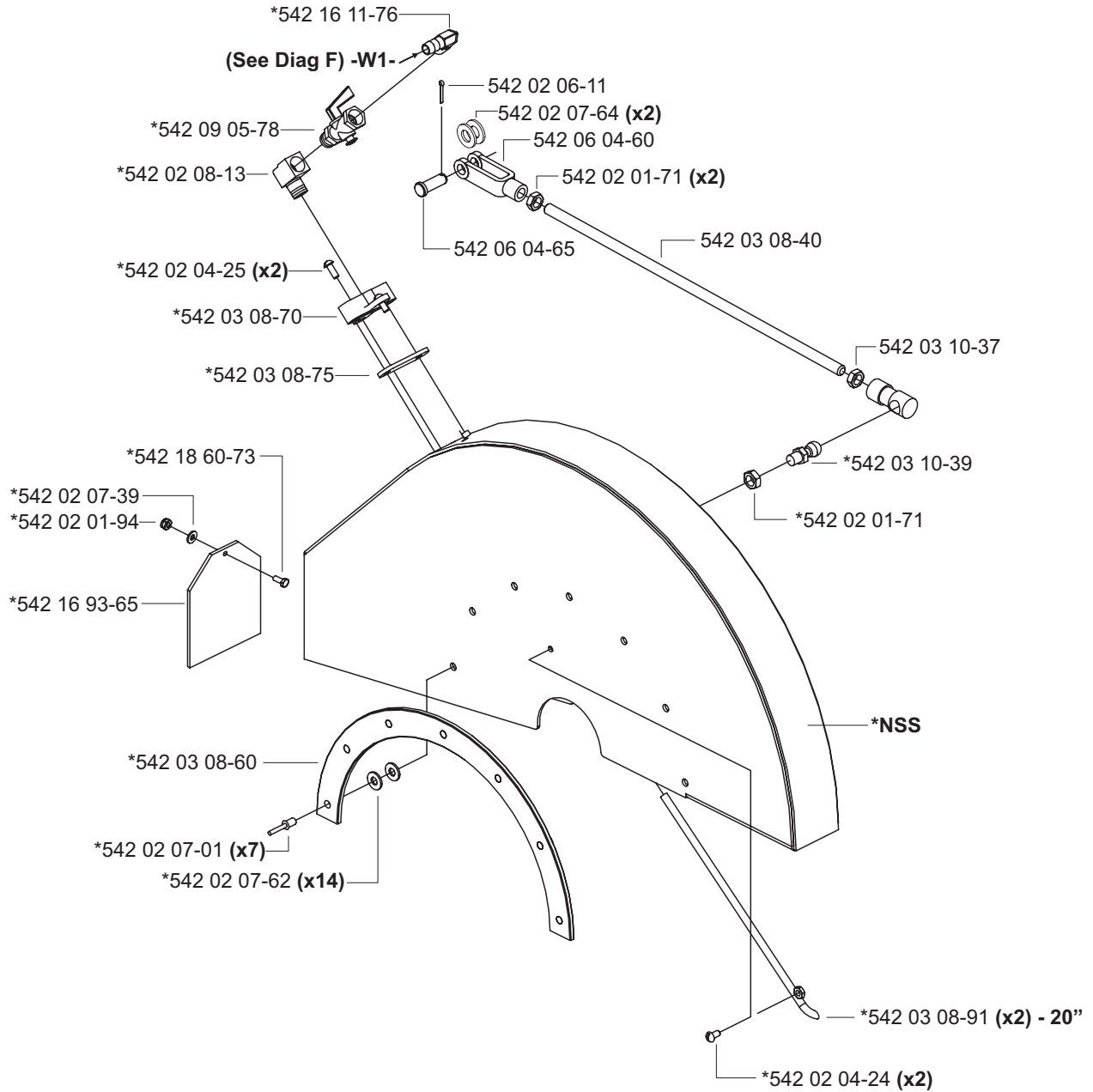

WARNING

Read and understand the entire operators manual before using this machine.

If you DO NOT have an Operators Manual, Call Toll Free 1-800-288-5040

Machinery Hazard

- Always keep all guards in place.
- Always keep all parts of your body away from all moving parts.

Always use only in well ventilated areas.

DO NOT operate near combustible material.

Always wear approved equipment

542 17 75-88

542 04 61-28

WARNING

EQUIPMENT IS FURNISHED WITH A 3 WIRE GROUNDING PLUG. BE CERTAIN EQUIPMENT IS CONNECTED TO A GROUNDING CIRCUIT. FAILURE TO COMPLY COULD RESULT IN DEATH OR SERIOUS BODILY INJURY. SEE OPERATOR'S MANUAL FOR INSTRUCTIONS. IF YOU DO NOT HAVE AN OPERATOR'S MANUAL, CALL TOLL FREE 1-800-288-5040

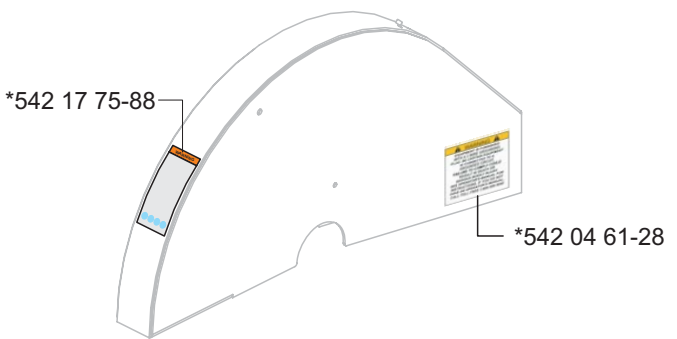

NSS - Not Sold Separately

K Wheel-Around Kit (Optional)

542 03 40-00 Compl

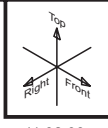

11.02.06

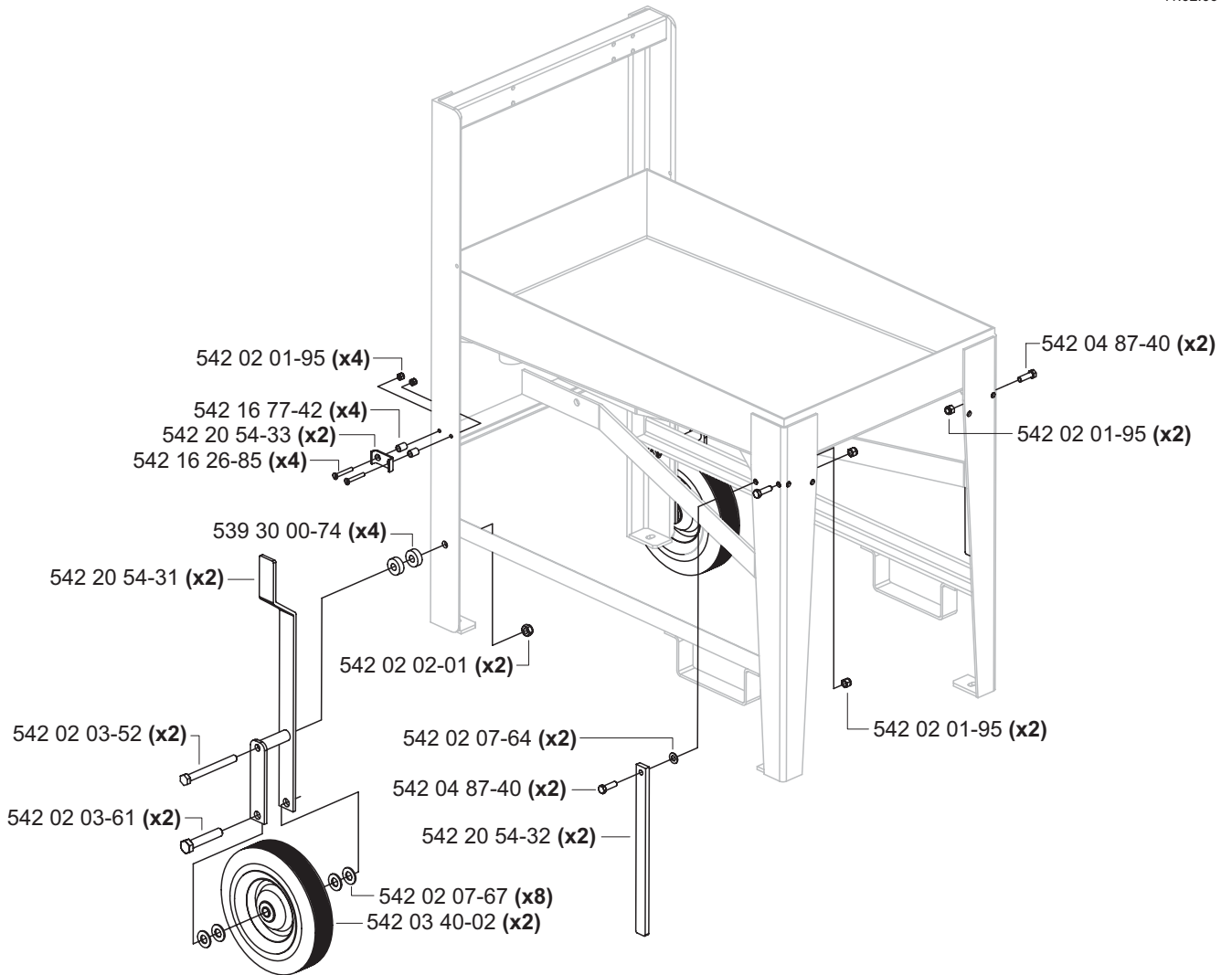

000 A0 30-00

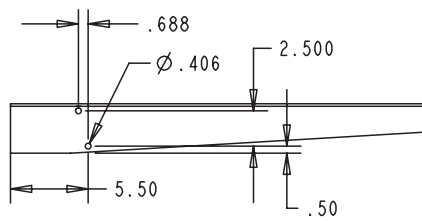
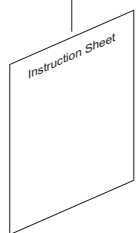

FRONT LEGS MODIFICATION

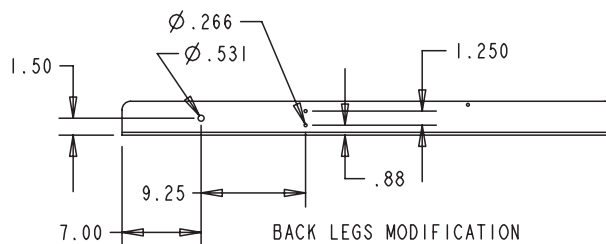

BACK LEGS MODIFICATION

Husqvarna Construction Products N. A.
Corporate Office
17400 West 119th Street
Olathe, Kansas 66061
Tel. 913-928-1000
Fax 913-438-7951

Customer Service: 800-288-5040
Customer Serv. Fax: 800-825-0028



DUST WARNING



Cutting, especially when DRY cutting, generates dust that comes from the material being cut, which frequently contains silica. Silica is a basic component of sand, quartz, brick clay, granite and numerous other minerals and rocks. Exposure to excessive amount of such dust can cause:

- Respiratory diseases (affecting your ability to breath), including chronic bronchitis, silicosis and pulmonary fibrosis from exposure to silica. These diseases may be fatal;
- Skin irritation and rash; and
- Cancer according to NTP* and IARC*
* National Toxicology Program / International Agency for Research on Cancer

Take precautionary steps

- Avoid inhalation of and skin contact with dust, mist and fumes;
- Wet cut when feasible, to minimize dust;
- Wear and ensure that all bystanders wear appropriate respiratory protection such as dust masks designed to filter out microscopic particles. (See OSHA 29 CFR Part 1910.1200)

California Prop 65 Warning:

Use of this product can cause exposure to materials known to the State of California to cause cancer and/or birth defects or other reproductive harm.



Printed in the USA