

IPL, Hydrogear, 2007-01, 504 05 42-01

347-0510

# Hydrogear

# 347-0510

Spare parts

Ersatzteile

Pièces détachées

Reserve onderdelen

Repuestos

Reservdelar

# REPAIR PARTS

## HYDRO GEAR TRANSAXLE - MODEL NUMBER 347-0510

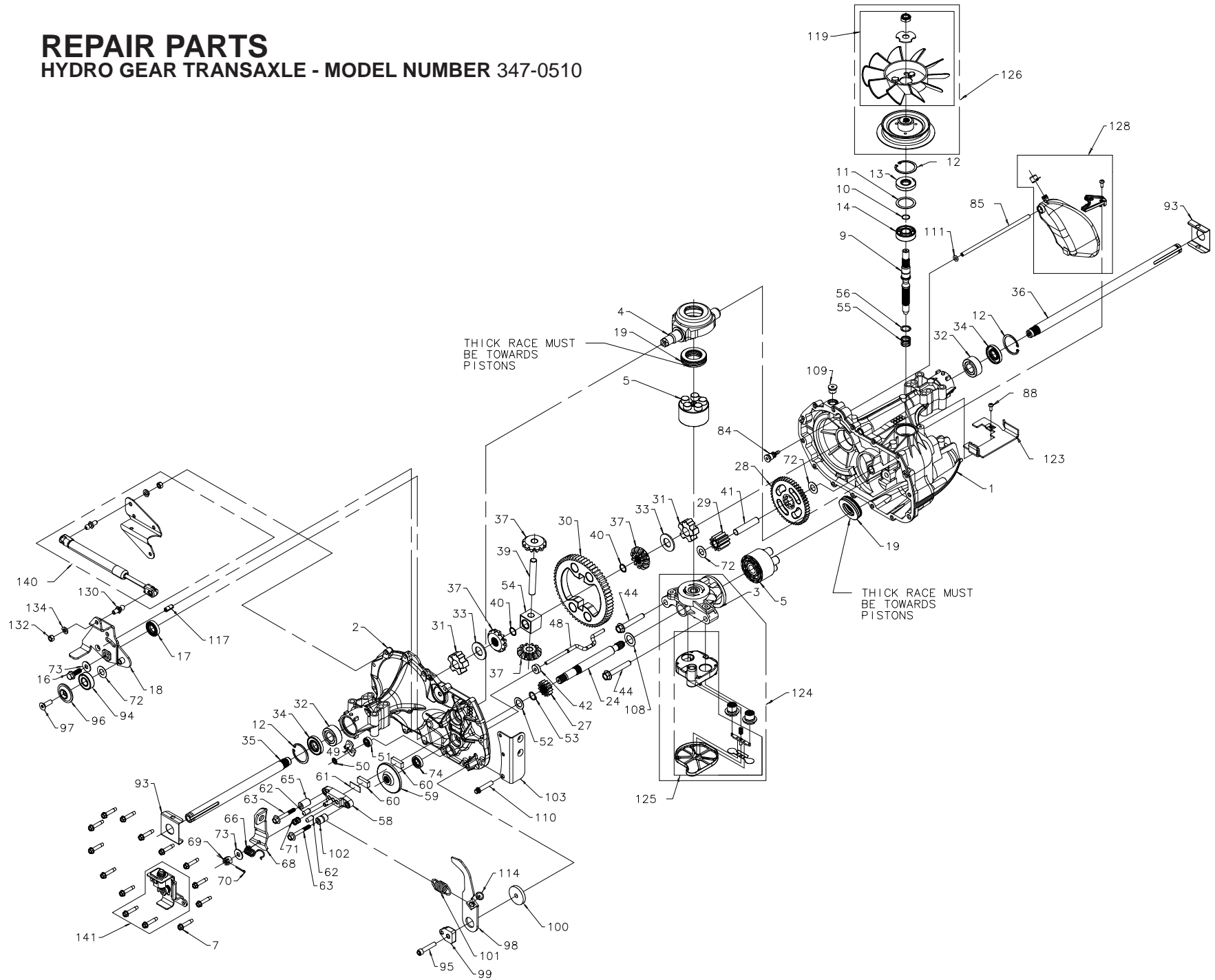

# REPAIR PARTS

## HYDRO GEAR TRANSAXLE - MODEL NUMBER 347-0510

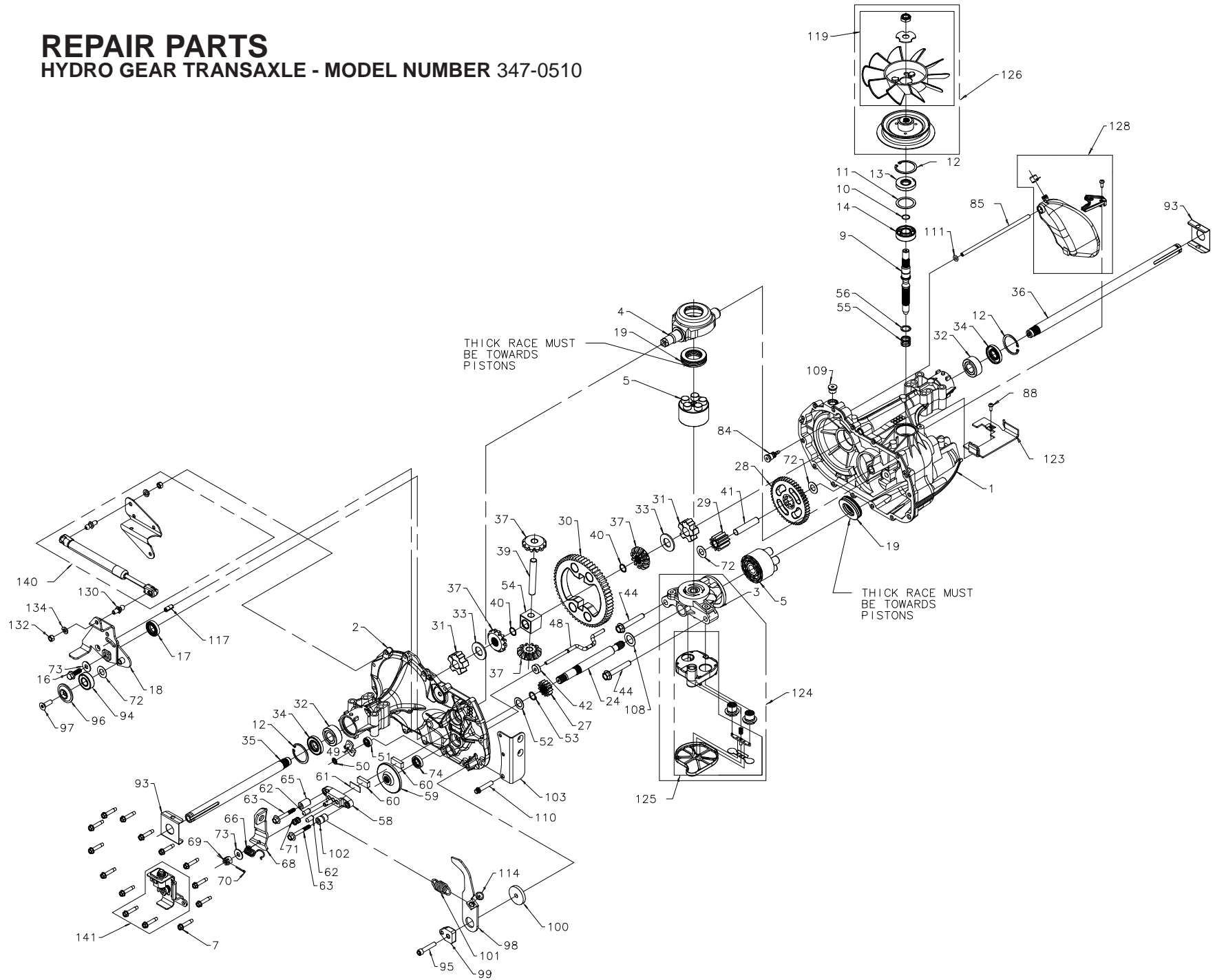

KEY NO.	PART NO.	DESCRIPTION
1	532 17 03-51	Main Housing Assembly
2	532 17 03-52	Side Housing, Assembly
3	532 17 03-53	Center section Assy
4	532 17 03-54	Swash Plate
5	532 16 98-98	Assembly, Cylinder Block 10cc
6	Not exist	Sealant Tube
7	532 17 03-56	Hex Flange Screw 1/4-20X1.25
9	532 17 03-58	Shaft, Input
10	532 17 03-59	Ring - Retaining
11	532 17 03-60	Spacer
12	532 16 98-70	Ring Retaining
13	532 17 03-61	Seal, Lip .67 X1.58X.276
14	532 17 31-58	Ball Bearing 17mm id X 40mm od X 12mm
16	532 17 03-62	Hex Flange Head Screw 5/16-24 X0.75
17	532 17 03-63	Lip Seal 18X32X7
18	504 03 96-01	Arm Control
19	532 17 31-59	Bearing 30 x 52 x 13 thrust
24	532 17 03-66	Shaft, Motor
27	532 17 03-67	Gear-Pinion, 13T
28	532 17 03-68	10t/48t Gear
29	532 17 03-69	Gear, 10t Jackshaft
30	532 17 03-70	60t Bull Gear
31	532 17 03-71	Sleeve Bearing .75X1.575X.625
32	532 17 03-89	Sleeve Bearing (Outboard) .75 X 1.75 X.625
33	532 17 03-90	Washer-3/4 X 1.5 X .13
34	532 17 03-91	Lip Seal Axle
35	532 17 03-92	Shaft, Axle .75 X 11.39 (Key, RH)
36	532 14 29-91	Shaft, Axle .75 X 16.99 (Key, LH)
37	532 15 07-93	Kit Miter GearKIT, MITER GEAR
39	532 15 08-09	Shaft
40	532 17 03-93	Ring, Spiral Retaining
41	532 17 03-94	Pin, Jackshaft
42	532 17 03-95	Magnet, Ring
44	532 15 07-97	Bolt 3/8-24 x 2-1/2
48	532 17 04-00	Rod, Bypass Actuator
49	532 17 04-01	Arm, Bypass
50	532 17 04-02	Retaining Ring .250 External
51	532 17 04-03	Seal, Lip .741 X .250 X .250 Tc
52	532 17 04-04	Flat Washer, 5/8 Id X 1.0 od X .05 Thk
53	532 17 04-05	Retaining Ring
54	532 17 04-06	Bearing, Center Block
55	532 14 29-77	Block spring
56	532 14 29-78	Block thrust washer
57	Not exist	Oil, 20W50, 78.8OZ
58	532 17 04-07	Brake Yoke
59	532 17 04-08	Rotor, Brake
60	532 14 28-82	Plate Puck

KEY NO.	PART NO.	DESCRIPTION
61	532 14 28-83	Puck, brake
62	532 14 28-87	Pins, brake
63	532 17 04-10	Hfhcs 1/4 020X2 W/Patch, Special Flange
65	532 17 04-11	Spacer
66	532 18 82-97	Spring, Brake Arm Bias (Green)
68	532 17 87-82	Arm Brake
68	532 17 87-82	Arm Brake
69	532 14 28-85	NUT-CASTLE 5/16-24
70	532 17 04-16	Cotter Pin 3/32X3/4
71	532 16 11-81	Comp. spring, brake anti-drag
72	532 17 04-18	Washer, Ht .5 I.D. X O.D. X.032
73	532 14 28-84	WASHER-7/16 X 7/8 X .060
74	532 17 04-19	Oil Seal /625 X 1.0 X.25
84	532 17 04-25	Fitting, 5/16 Sae 5/32 Tube
85	532 17 04-26	Hose, Expansion Tank
88	532 16 11-75	Screw
93	532 17 04-31	Spring Clip-Housing Thrust
94	532 17 83-25	Bearing
95	532 17 83-24	Screw indentd hex washer head
96	532 17 87-86	Spacer, Locating
97	532 17 87-87	Scarew, SFHCS 5/16-18X1
98	532 17 87-89	Arm Return
99	532 17 87-92	Puck Adjusting
100	532 17 87-93	Washer .24 id X 1.60 OD X .239
101	532 17 87-94	Spring Extension
102	532 17 87-95	Spacer .260 id x .560 od x .870
103	532 17 87-96	Bracket Torque
108	532 17 04-33	Washer, Motor Shaft .71 Id X 1.15 Od X .030 thk
109	532 17 04-34	Plug, Sae #6
110	532 16 11-59	Torx head screw, 5/16-18
111	532 17 04-35	O-Ring .07 X .301 I.D.
114	532 17 87-97	Spring Guide
117	532 17 87-99	Pin Spring
119	532 19 10-31	51230 Fan
123	532 17 88-00	Bracket, Belt Keeper
124	532 17 04-44	Center Section-Filter-Bypass Assembly
125	532 17 04-45	Filter assembly
126	532 19 10-28	51879 Pulley and 51230 Fan
127	532 17 04-47	Seal -O-Ring Kit
128	532 17 31-65	Kit Expansion Tank
130	532 17 88-02	Stud Ball
132	532 17 88-04	Hex Nut 5/16-18 UNC
134	532 17 88-08	Washer Helixcal Spring Lock 5/16
140	532 19 10-30	Kit damper
141	532 19 38-01	Bracket
Not in picture.	532 19 07-33	Transaxle complete

KEY NO.	PART NO.	DESCRIPTION
1	532 17 03-51	Main Housing Assembly
2	532 17 03-52	Side Housing, Assembly
3	532 17 03-53	Center section Assy
4	532 17 03-54	Swash Plate
5	532 16 98-98	Assembly, Cylinder Block 10cc
6	Not exist	Sealant Tube
7	532 17 03-56	Hex Flange Screw 1/4-20X1.25
9	532 17 03-58	Shaft, Input
10	532 17 03-59	Ring - Retaining
11	532 17 03-60	Spacer
12	532 16 98-70	Ring Retaining
13	532 17 03-61	Seal, Lip .67 X1.58X.276
14	532 17 31-58	Ball Bearing 17mm id X 40mm od X 12mm
16	532 17 03-62	Hex Flange Head Screw 5/16-24 X0.75
17	532 17 03-63	Lip Seal 18X32X7
18	504 03 96-01	Arm Control
19	532 17 31-59	Bearing 30 x 52 x 13 thrust
24	532 17 03-66	Shaft, Motor
27	532 17 03-67	Gear-Pinion, 13T
28	532 17 03-68	10t/48t Gear
29	532 17 03-69	Gear, 10t Jackshaft
30	532 17 03-70	60t Bull Gear
31	532 17 03-71	Sleeve Bearing .75X1.575X.625
32	532 17 03-89	Sleeve Bearing (Outboard) .75 X 1.75 X.625
33	532 17 03-90	Washer-3/4 X 1.5 X .13
34	532 17 03-91	Lip Seal Axle
35	532 17 03-92	Shaft, Axle .75 X 11.39 (Key, RH)
36	532 14 29-91	Shaft, Axle .75 X 16.99 (Key, LH)
37	532 15 07-93	Kit Miter GearKIT, MITER GEAR
39	532 15 08-09	Shaft
40	532 17 03-93	Ring, Spiral Retaining
41	532 17 03-94	Pin, Jackshaft
42	532 17 03-95	Magnet, Ring
44	532 15 07-97	Bolt 3/8-24 x 2-1/2
48	532 17 04-00	Rod, Bypass Actuator
49	532 17 04-01	Arm, Bypass
50	532 17 04-02	Retaining Ring .250 External
51	532 17 04-03	Seal, Lip .741 X .250 X .250 Tc
52	532 17 04-04	Flat Washer, 5/8 Id X 1.0 od X .05 Thk
53	532 17 04-05	Retaining Ring
54	532 17 04-06	Bearing, Center Block
55	532 14 29-77	Block spring
56	532 14 29-78	Block thrust washer
57	Not exist	Oil, 20W50, 78.8OZ
58	532 17 04-07	Brake Yoke
59	532 17 04-08	Rotor, Brake
60	532 14 28-82	Plate Puck

KEY NO.	PART NO.	DESCRIPTION
61	532 14 28-83	Puck, brake
62	532 14 28-87	Pins, brake
63	532 17 04-10	Hfhcs 1/4 020X2 W/Patch, Special Flange
65	532 17 04-11	Spacer
66	532 18 82-97	Spring, Brake Arm Bias (Green)
68	532 17 87-82	Arm Brake
68	532 17 87-82	Arm Brake
69	532 14 28-85	NUT-CASTLE 5/16-24
70	532 17 04-16	Cotter Pin 3/32X3/4
71	532 16 11-81	Comp. spring, brake anti-drag
72	532 17 04-18	Washer, Ht .5 I.D. X O.D. X.032
73	532 14 28-84	WASHER-7/16 X 7/8 X .060
74	532 17 04-19	Oil Seal /625 X 1.0 X.25
84	532 17 04-25	Fitting, 5/16 Sae 5/32 Tube
85	532 17 04-26	Hose, Expansion Tank
88	532 16 11-75	Screw
93	532 17 04-31	Spring Clip-Housing Thrust
94	532 17 83-25	Bearing
95	532 17 83-24	Screw indentd hex washer head
96	532 17 87-86	Spacer, Locating
97	532 17 87-87	Scarew, SFHCS 5/16-18X1
98	532 17 87-89	Arm Return
99	532 17 87-92	Puck Adjusting
100	532 17 87-93	Washer .24 id X 1.60 OD X .239
101	532 17 87-94	Spring Extension
102	532 17 87-95	Spacer .260 id x .560 od x .870
103	532 17 87-96	Bracket Torque
108	532 17 04-33	Washer, Motor Shaft .71 Id X 1.15 Od X .030 thk
109	532 17 04-34	Plug, Sae #6
110	532 16 11-59	Torx head screw, 5/16-18
111	532 17 04-35	O-Ring .07 X .301 I.D.
114	532 17 87-97	Spring Guide
117	532 17 87-99	Pin Spring
119	532 19 10-31	51230 Fan
123	532 17 88-00	Bracket, Belt Keeper
124	532 17 04-44	Center Section-Filter-Bypass Assembly
125	532 17 04-45	Filter assembly
126	532 19 10-28	51879 Pulley and 51230 Fan
127	532 17 04-47	Seal -O-Ring Kit
128	532 17 31-65	Kit Expansion Tank
130	532 17 88-02	Stud Ball
132	532 17 88-04	Hex Nut 5/16-18 UNC
134	532 17 88-08	Washer Helixcal Spring Lock 5/16
140	532 19 10-30	Kit damper
141	532 19 38-01	Bracket
Not in picture.	532 19 07-33	Transaxle complete