

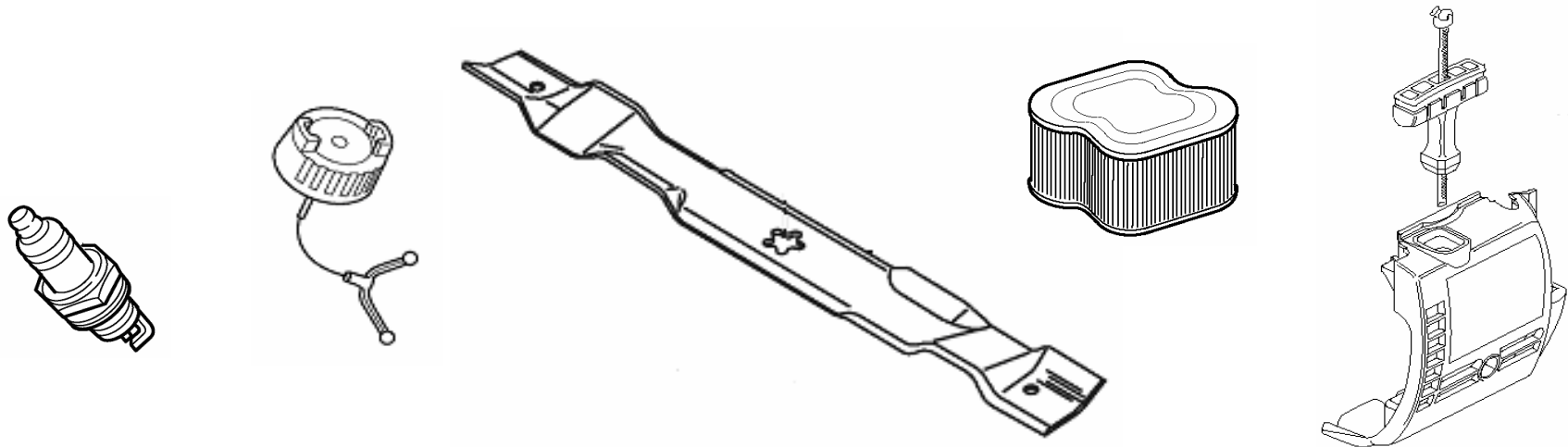

# 175 of Our Fast Moving Parts

**The most important parts for you to stock!**

150 fast moving parts including price and where-used by model number and model years



Don't forget to buy the 2007 Parts and Accessory Guide with the new where-used feature!!!

PN: 531 30 05-74

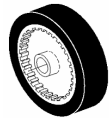

	Part #	Description	Where used
21" Consumer walk Mowers	532 40 67-12	21" Standard Blade	2006 - 2007: 21" Consumer walks
	532 19 37-07	Adapter, Blade	2005 - 2007: CM 21" walk mowers
	532 19 26-19	Drive Wheel, Rear	2005 - 2006: Rear self propelled 21" walks
	532 18 07-67	Drive Wheel, Front	2004 - 2006: Front self propelled 21" walks
	532 18 01-83	Wheel, 10" x 2" Rear	2003 - 2005: Push 21" walks
	531 30 10-12	Air Filter	Briggs & Stratton 6.5 HP & Honda 5.5 HP
	531 30 73-89	Oil Filter, Kohler OEM #25-050-01 Briggs & Stratton OEM #492932 Tecumseh OEM #36262, #36536, #36961	5 - 14 HP 21" walk and tractor engines 21" walk and tractor usage - listed twice
	531 30 73-90	Oil Filter, (OEM #69251)	Briggs & Stratton 6.5 HP
	531 30 73-91	Oil Filter, (OEM #491056)	Briggs & Stratton 6.5 HP
	531 30 81-29	Spark Plug, Champion RN9YC	5521CM, 5521CHV, 5521HV, 5521RS & 5521BBC
531 30 81-28	Spark Plug, Champion RC12YC 21" walk and tractor usage - listed on page two	7021HV, 7021RS, 7021RES	
532 19 68-57	Belt, Transmission Drive Belt	2005 - 2007: 21" Walk mowers	
Lawn and Garden Tractors	532 13 84-97	38" Hi-lift Deck Blade	2000 - 2004: 38" 2- bladed decks
	532 13 41-48	38" Standard Mulching Blade	2000 - 2004: 38" 2- bladed decks
	532 13 41-49	42" Standard Mulching Blade	2000 - 2006: 42" 2 - bladed decks
	532 13 89-71	42" Hi-lift Deck Blade	2000 - 2006: 42" 2 - bladed decks
	532 13 97-75	42" Premium Mulching Blade	2000 - 2006: 42" 2 - bladed decks
	532 17 60-84	46" Hi-lift Blade	2000 - 2005: 46" 3 - bladed decks
	532 15 24-43	46" Standard Mulching Blade	2000 - 2005: 46" 3 - bladed decks
	532 40 31-07	46" Standard Mulching Blade	2006 - 2007: 46" 2 - bladed decks
	532 40 53-80	46" Hi-lift Blade	2006 - 2007: 46" 2 - bladed decks
	532 17 39-21	48" Standard Mulching Blade	2000 - 2007: 48" decks
	532 18 72-54	48" Hi-lift Blade	2000 - 2007: 48" decks
	532 18 72-55	48" Mulching Blade	2000 - 2007: 48" decks
	532 18 72-56	54" Blade Bagging	2005 - 2007: 54" decks
	532 18 72-54	54" Hi-lift Blade	2005 - 2007: 54" decks
	532 18 72-55	54" Standard Mulching Blade	2005 - 2007: 54" decks
	532 85 08-57	Blade Bolt	All Tractors 38" or 42" decks
	532 17 43-65	Blade Bolt	All Tractors 48" or 54" decks
	531 30 09-36	Air Filter	Briggs & Stratton 7HP
	531 30 81-57	Air Filter (OEM # 11013-70172) 2-pieces, packaged	Kawasaki 15 HP
	531 30 81-55	Air Filter 2-pieces - packaged	Briggs & Stratton 18-26 HP
	531 30 73-88	Oil Filter, (OEM #49065-2078, #49065-2037, #49065-2070, #49065-207) packaged	Kawasaki 4 - 17 HP
	531 30 73-89	Oil Filter, Kohler OEM #25-050-01 Briggs & Stratton OEM #492932 Tecumseh OEM #36262, #36536, #36961	5 - 14 HP 21" walk and tractor engines 21" walk and tractor usage - listed twice
	531 30 73-92	Oil Filter Kohler, (OEM #52-050-02-S)	KT & Magnum engines
531 30 73-93	Oil Filter Kohler, (OEM #12-050-01)	Command CV 11 - 16 HP, CV & CH 17 - 26 HP & TH 16 - 18 HP	
531 30 73-94	Hydraulic oil filter	All Husqvarna Zero-Turns	

Part #	Description	Where used
532 14 42-00	Belt, 38" Deck Drive	1997 - 2004: 38" Tractor decks
532 17 43-75	Belt, 48" Primary Deck Drive	2001 - 2005: 48" Tractors
532 19 61-03	Belt, 54" Deck Drive	2006 - 2007: 54" Tractor deck
532 19 72-42	Belt, 48" Deck Drive	2006 - 2007: 48" Tractor deck
532 14 02-18	Belt, Transmission Drive Belt	2006 - 2007: 48" & 54" Tractors
532 13 95-73	Belt, 50" Primary Deck Drive	50" Tractor decks
532 17 43-68	Belt, Transmission Drive Belt	2001 - 2007: 48" Tractors
532 00 90-40	Bearing/Bushing Plastic, Wheel Hub	1994 - 2007: Front Hub of tractors
532 40 02-34	Nut, Toplock	2002 - 2007: Blade bolts most tractors
532 10 47-57	Cap, Hub	2000 - 2007: Cap for front hub of tractors
532 18 06-55	Deflector Shield	2006 - 2007: 48" Res. Z Stamped decks
532 13 09-68	Deflector Shield	1997- 2002: 130, 145, 150, 160 1342 & 1542
532 11 04-85	Bearing, Mandrel	1996 - 2007: All decks tractor mandrels
532 18 72-81	Mandrel housing	2006 - 2007: 42", 46" 48" & 54" Tractor decks
532 19 28-72	Mandrel Shaft w/lower sealed Bearing	2006 - 2007: 38", 42" & 46" Tractor decks
532 18 72-92	Mandrel Assembly, Housing, Bearings, Hardware & Shaft	2005 - 2007: 48" & 54" Tractor decks
532 17 43-60	Mandrel Shaft w/lower Bearing	2002 - 2005: 48" Tractor decks
532 17 43-58	Mandrel housing	2002 - 2005: 48" Tractor decks
532 17 43-56	Mandrel Assembly, Housing, Bearings, Hardware & Shaft	2002 - 2005: 48" Tractor decks
532 17 51-47	Mandrel Shaft w/lower sealed Bearing	2004 - 2005: 48" Tractor decks
532 17 43-57	Mandrel Assembly, Housing, Bearings, Hardware & Shaft	2005 - 2005: 48" Tractor decks
532 12 87-74	Mandrel housing	2002 - 2005: 42" Tractor decks
532 13 07-94	Mandrel Assembly, Housing, Bearings, Hardware & Shaft	2003 - 2005: 42" Tractor decks
532 17 39-84	Bolt/Screw, Self tapping mandrel mounting	2002 - 2007: Most tractors
532 17 34-38	Idler Pulley, Deck Drive	2002 - 2006: 42" Tractor decks
532 13 92-45	Idler Pulley, Deck Drive	1994 - 2002: 50" Tractor decks
532 17 34-36	Pulley Mandrel	2002 - 2007: 42", 48" & 54" Tractor decks
532 18 76-90	Washer, (Mounting above Pulley mandrel)	2002 - 2007: 42", 48" & 54" Tractor decks
532 17 58-20	Idler Pulley, Deck Drive	2002 - 2006: 48" Tractor decks
873 68 06-00	Locknut, Crownlock	2000 - 2007: Cutter deck Idler
532 19 34-06	Shoulder Bolt	Gauge Wheel mounting bolt most decks
532 15 59-86	Gauge Wheel Mounting Bar	2002 - 2006: 42", 48" & 48" Tractor decks
532 13 39-57	Gauge Wheel	2001 - 2005: 42", 48" & 54" Tractor decks
532 17 48-73	Gauge Wheel	2005 - 2007: 42", 48" & 54" Tractor decks
532 13 22-64	Anti-Scalp Roller, Deck Nose	1997 - 2006: 42" & 46" Tractor decks
532 17 60-66	Anti-Scalp Roller, Deck Nose	2002 - 2006: 48" Tractor decks
532 17 55-66	Ignition Switch	2002 - 2005: Most tractors
532 14 04-01	Ignition Key	2002 - 2007: Most tractors
532 17 46-51	PTO switch	2002 - 2007: Most tractors
532 10 97-48	Relay Assembly	2002 - 2005: 38", 42", 48" & 54" Tractors
532 17 88-61	Solenoid Kit	2002 - 2006: Most tractors
531 30 81-28	Spark Plug, Champion RC12YC <i>21" walk and tractor usage - listed twice</i>	YTH1942T, YTH20B42T, YTH20F42T, YTH2242T, GTH26K54T, Z3815, Z4217, & Z4818
531 30 81-30	Spark Plug, Champion RJ19LM	Briggs & Stratton L Head



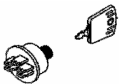
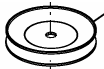
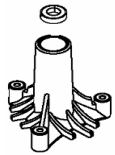

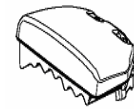
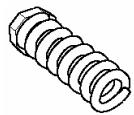
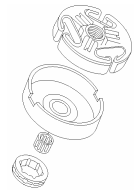



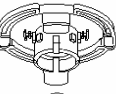

Lawn and Garden Tractors (cont'd)



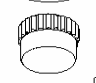

Part #	Description	Where used
503 49 81-03	Hand guard/chain brake handle assembly	1999 - 2004: 51, 55 & 55 Rancher
503 85 09-01	Hand guard/chain brake handle	1999 - 2007: 340, 340e, 345, 345e, 350
501 28 59-02	Fuel hose	1982 - 1992: 61, 266, 268, 268K, 272K
503 44 32-01	Fuel filter	1987 - 2007: Saws 334 series and up, Trimmers 223 series
503 62 67-71	Front handle	1997 - 2007: 362, 362XP, 365S, 365, 371 & 372
537 23 05-01	Front handle	2005 - 2007: 455 Rancher, 455e Rancher & 460
537 35 91-01	Clutch spring	2005 -2007: 340, 345, 350, 353 & 346 XP
503 87 30-72	Clutch drum/sprocket	2001 - 2007: 340, 340e, 345, 345e, 350, 351& 353
537 29 16-02	Clutch drum/sprocket, (3/8"x7 Spur)	2005 - 2007: 455 Rancher, 455e Rancher & 460
503 43 20-01	Clutch drum bearing	1999 - 2007: 362, 365S, 371, 372, 385, 390, 575XP & 570
503 27 21-01	Retaining ring, clutch & sprocket	1997 - 2007: 362, 362XP, 365S, 371, 372, 385, 571 & 575XP
503 60 84-01	Choke control	1998 - 2007: 51, 55 & 55 Rancher
503 46 77-01	Screw, Chain tensioner	1992 - 2007: 394 & 395
501 45 27-02	Nut, Chain tensioner	1994 - 2007: 42, 51, 55, 242, 254, 257, 261, 262 344T, 335XPT, 336, 338XPT, 339XP, 371 & 362
501 53 71-01	Chain tensioner assembly	1980 -1997: 61, 66, 162,181, 266, 268, 272, 281 & 288
537 07 12-01	Chain tensioner assembly	2001 - 2007: 345e, 346XP, 350, 351 & 353 Serial #<054701101
530 05 48-02	Chain tensioner assembly	2001 - 2005: 136, 137, 137e, 141, 142 & 142e
506 37 27-20	Belt, Cutting wheel drive	2005 - 2007: 371k & 375K
501 76 39-02	Antivibration element	1984 - 2007: 50, 51, 55 & 55 Rancher
501 62 87-01	Antivibration element (hard), Rear	1980 - 1997: 133, 136, 234, 238, 242, 266, 268, 268K, 272, 36, 41, 42, 61 & 66
503 63 75-02	Antivibration element (Std.), Front upper handle	1997 - 2007: 362, 362XP, 365, 365S, 372, 570, 575XP, 371K & 375K
503 63 75-03	Antivibration element (Hard), Front upper handle	1999 - 2007: 362, 362XP, 365, 365S, 372, 570 & 575XP
503 89 47-01	Buckle, Air filter cover	2001 - 2007: 346XP, 351, 353, 357XP, 359, 570 & 575XP
506 26 91-01	Air oiled pre-filter, Foam	2000 - 2007: 371K & 375K
506 26 86-01	Air oiled pre-filter, Foam	1999 - 2006: 3120K
537 00 93-01	Air filter, HD Felt	2001 - 2007: 385 & 390
506 26 34-02	Air filter, HD Felt	2000 - 2007: 3120K, 371K & 375K
503 89 81-01	Air filter, Felt	1998 - 2007: 51, 55 & 55 Rancher
506 24 98-02	Air filter, Felt	2000 - 2006: 3120K
537 02 40-03	Air filter, Felt	2001 - 2007: 340, 340e, 345, 345e, 350, 346XP, 351 & 353
503 81 80-01	Air filter, Felt	1995 - 2007: 362, 362S, 365, 371, 372 & 372XPW
503 60 83-01	Air filter, Felt	1990 - 1995: 51 & 55 Serial # >7151551
503 22 00-01	Bar Nut	1981 - 2007: Most Saws
503 71 76-01	Wire, Throttle Interlock	1997 - 2007: 362, 362XP, 365, 365S, 371, 372, 385, 390, 371K & 375K
503 55 66-01	Throttle Interlock	1997 - 2007: 336, 339XP, 362, 362XP, 365, 371, 372, 372XPW, 385, 390, 371K & 375K
503 89 22-02	Pinion Gear (.325x7)	1998 - 2007: 350
503 23 51-11	Spark Plug, BPMR7A	2005 - 2007: 334, 336, 338, 339, 340, 345, 350, 353, 455 & 575
501 48 54-02	Spark plug connection kit	1998 - 2007: Most Swedish made Saws, Trimmers, & Blowers

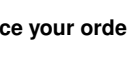
Chain Saws and Cut Off Saws

	Part #	Description	Where used
	537 21 52-02	Tank cap, Bar oil	2005 - 2007: 334T, 338XPT, 336, 339XP, 340, 345, 350, 353, 346XP, 55, 55 Rancher, 357XP, 359, 365 SP, 372XP, 385XP, 395XP, 3120XP, 371K, 375K & 3120K
	501 76 56-02	Tank cap, Bar oil	1990 -1998: 33, 38, 36, 41,50, 51, 55, 136, 141, 254, 257, 261 & 262
	537 28 15-02	Tank cap grey, Bar oil	2005 - 2007: 334T, 338XPT, 336, 339XP, 340, 345, 350, 353 346XP, 55, 55R, 357XP, 359, 365SP, 372XP, 385XP, 395XP, 3120XP, 371K, 375K & 3120K
	503 54 39-01	Starter handle	1991 - 2007: 40, 42, 45, 49, 50, 51, 55, 55 Rancher, 254, 257, 261, 262, 268, 268S, 272, 272S, 272XP, 281, 288, 333, 336, 338XPT, 339XP, 340, 340e, 345XP, 350, 351, 346XP, 353, 357XP, 371, 372, 385, 394, 395, 3120, 268K & 3120K Plus Most Trimmers, Clearing Saws and Blowers
	505 30 37-35	Starter pulley	1984 - 2007: 50, 51, 55 Rancher, 490 & 590
	501 45 41-01	Starter pawl	1980 - 2007: 40, 42, 44, 50, 50Rancher, 51, 55, 55 Rancher, 133, 154, 234, 238, 240, 240S, 240SE, 242, 254, 257, 261, 262, 334T, 335XPT, 336, 338XPT, 339XP, 340, 345, 350, 362, 371, 372 & 444
	501 76 31-01	Starter spring	1984 - 2007: 136, 141, 50, 55, 334, 335, 336, 338, 339, 40 & 45
	503 78 72-01	Starter spring	1996 - 2007: 362, 362XP, 365, 365S, 371, 372, 372XPW, 385, 390 & 371K
	503 20 34-19	Starter cover screw	Starter Cover Mounting 346XP, 351, 357XP, 359, 361, 362, 371,372, 385 & 395
	725 53 70-55	Muffler screw	1993 - 2007: 268, 272XP, 272, 362, 362XP, 365S, 385, 570, 575XP, 3120, 371K, 375K & 3120K
	503 71 79-01	Switch, On/Off	1994 - 2007 42, 55, 55 Rancher, 61, 131, 141, 136, 141, 142, 242, 246, 254, 257, 261, 262, 268, 272, 272XP, 281, 288, 385, 394, 395, 3120, 268K, 272K, 371K, 375K & 3120K
503 71 82-01	Start/Stop switch	1997 - 2007: 336, 339XP, 362, 362XP, 365, 371, 372, 372XPW, 385 & 390	
          	502 20 40-01	Knob, For tightening air filter covers	1993 - 2007: 225, 225, 223, 227, 232L, 232, 322, 325 & 326
	503 71 82-01	Start/Stop switch	1996 - 2007: 123, 225, 232, 235, 322, 325 & 326
	501 48 54-02	Spark plug connection kit	1998 - 2007: Most Swedish made Saws, Trimmers, & Blowers
	537 18 59-02	Eyelet, Trimmer line	2003 - 2006: T 35 Trimmer Head
	537 18 58-01	Bump knob	2003 - 2006: T 35 Trimmer Head
	537 18 60-01	Spring	2003 - 2006: T 35 Trimmer Head
	544 04 44-01	Cover, Outer	2003 - 2006: T 35 Trimmer Head
	503 44 32-01	Fuel filter	1987 - 2007: Saws 334 series and up, Trimmers 223 series
	530 09 56-46	Fuel filter	2004 - 2007: 124C, 124L, 125C, 125L, 125LD & 125E. 136 & 141 Saws
	537 18 63-01	Air filter, Oiled	2002 - 2007: 123, 223, 322, 323 & 325
	503 91 18-02	Fuel cap	2000 - 2007: 123, 223, 322, 323, 325, 326, 333 & 335
	503 96 49-01	Starter pulley	2000 - 2007: 123, 223, 322, 325, 323, 325 & 326
	503 85 63-01	Gearhead nut, Brushcutter blade	2002 - 2007: 123, 223, 232, 235, 232, 324 & 326
	502 19 86-02	Air filter	1997 - 2006: 225, 232 & 235
	537 14 31-01	Air filter	2000 - 2007: 323, 325 & 326
	503 87 33-02	Starter cup assembly, Cup & pawls	2000 - 2007: 123, 223, 322, 323, 325, 326,
	503 93 66-01	Air purge bubble	1999 - 2007: 123, 223, 225, 232, 235, 240, 322, 325, 326, 333 & Saws
695 00 08-38	Fuel cap, Blowers only	1997 - 2002: 140, 145, 155 & 165	
531 00 44-30	Air filter , Blowers only	1997 - 2006: 145 & 155	

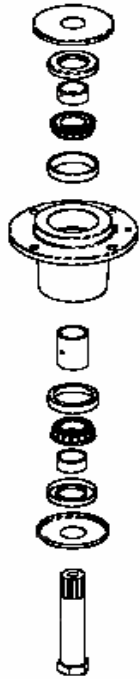

Part #	Description	Where used
539 10 26-98	Gauge wheel bushing	2005 - 2007: BZ, iZ, LZ, with 48", 52", 61" & 72" decks
539 10 26-43	Gauge wheel/anti-scalp roller	2005 - 2007: BZ, iZ, LZ, with 48", 52", 61" & 72" decks
539 10 27-54	Bolt for above gauge wheel and bushing	2005 - 2007: BZ, iZ, LZ, with 48", 52", 61" & 72" decks
539 10 25-35	Caster bearings grease cap, Front	2005 - 2007: BZ, iZ, LZ, with 48", 52", 61" & 72" decks
539 10 10-80	Switch, Interlock	2004 - 2007: EZ, iZ, LZ & Z parking brake and neutral
539 10 17-70	Switch, Ignition	2000 - 2007: BZ, iZ, WH, WHF, ZTH, ZTHKH & ZTHKHW all decks
539 10 17-68	Switch, Blade engagement	2004 - 2007: BZ, EZ, iZ, LZ & Z all decks
539 11 48-20	Spindle assembly, Deck ribbed	2005 - 2007: All Tunnel Ram decks
539 10 74-08	Spindle assembly, Sealed bearing	2002 - 2005: WHF & ZTH with 42", 48", 52", 61" decks
539 10 74-06	Bearing kit, Spindle (keyed shaft)	2000 - 2006: iZ, ZTH with 42", 48", 52", 61" & 72" decks
539 10 44-11	Knob w/stud, Foot pan/plate	2005 - 2007: BZ, iZ, LZ & Z all decks
539 10 32-57	Idler pulley, Deck	2004 - 2007: BZ, iZ, LZ, Z with 42", 48", 52", 61" & 72" decks
539 10 26-06	Hydraulic oil filter	2005 - 2007: iZ & LZ all decks
539 10 27-20	Dampener, Steering controls	2004 - 2007: EZ & Z all decks
539 11 20-79	Blade, 18"	2006 - 2007: EZ with 48" deck
539 10 32-99	Blade bolt	2005 - 2007: BZ, iZ, LZ, with 42", 48", 52", 61" & 72" decks
539 10 43-34	Belt, Hydraulic pump	2006 - 2007: Z & LZ all decks
539 10 68-87	Belt, Hydraulic pump	2005 - 2007: iZ
539 10 43-36	Belt, Deck	2005 - 2007: LZ with 61" deck
539 11 19-49	Belt, Deck	2005 - 2007: iZ with 48" deck
539 10 77-09	Belt, Deck	2004 - 2005: Z with 48"
539 10 43-35	Belt, Deck	2005 - 2007: BZ with 52" deck 72" & LZ with 52" deck
539 10 68-84	Belt, Deck	2005 - 2007: iZ with 52" deck
539 10 32-40	Belt, Deck	2002 - 2005: iZ & ZTH with 42" decks
539 10 24-84	Bearing, Flanged caster wheel	2005 - 2007: iZ & EZ
540 09 10-10	Tine, Detaching spring	2000 - 2007: DT18c
539 10 05-27	Finger, Detaching metal	2000 - 2007: DT18

Commercial Turf Products

Don't forget to buy the 2007 Parts and Accessory Guide with the new where-used feature!!! PN: 531 30 05-74

Or download it at [www.husqvarnaretailer.com](http://www.husqvarnaretailer.com)

