

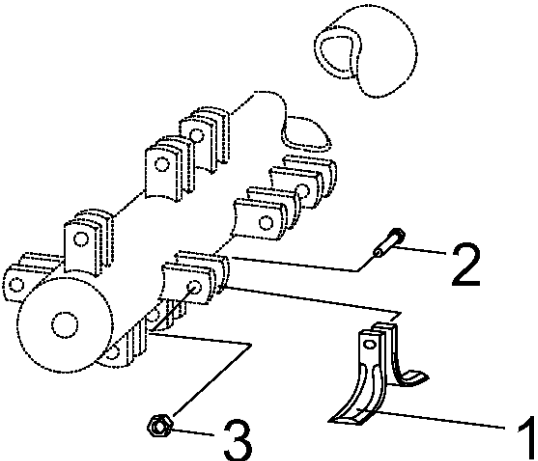

SPARE PARTS LIST

ACCESSORIES AND TOOLS

FLAIL MOWER T-60362, 966 83 32-01,
2008-10



535 41 50-96
T-60344

FLAIL BLADE

FLAIL MOWER T-60362, 966 83 32-01, 2008-10

Ref	Part No	Description	Remark	QTY KIT
1	535 41 50-63	BLADE		112
2	531 02 11-99	SCREW		56
3	531 02 12-19	NUT		56

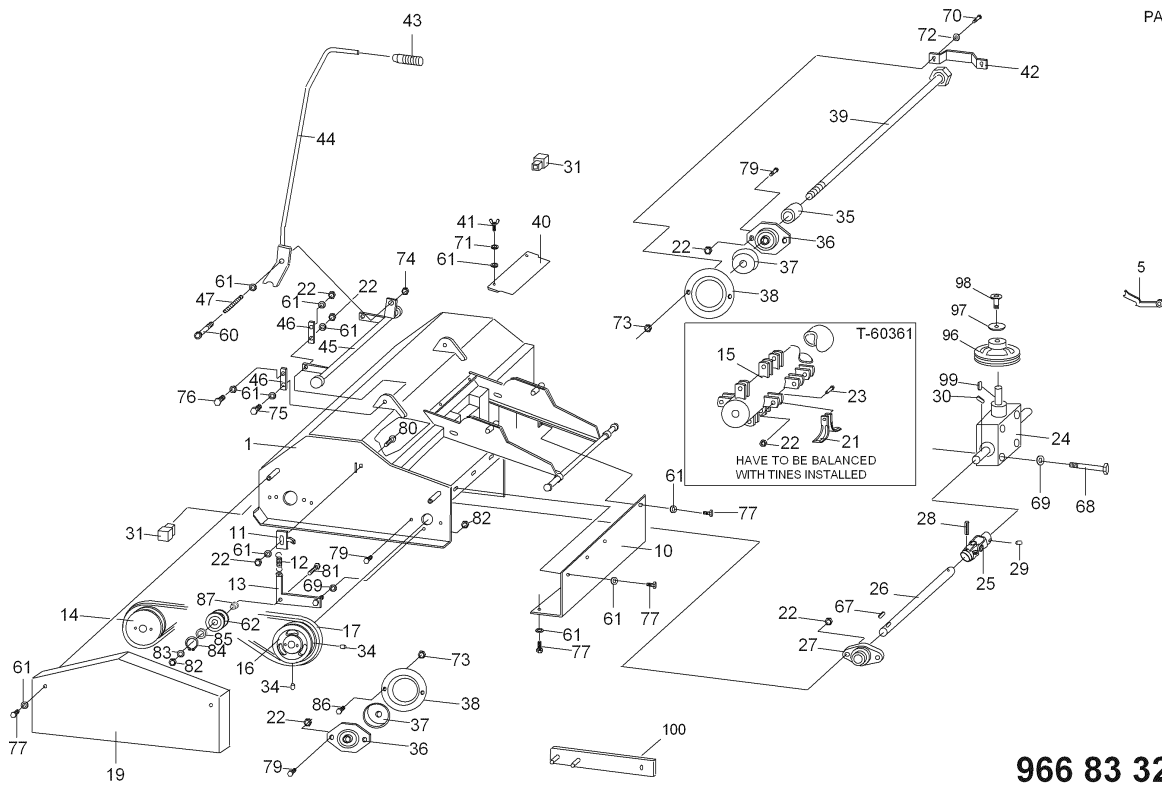

966 83 32-01
T-60362

PRODUCT COMPLETE

FLAIL MOWER T-60362, 966 83 32-01, 2008-10

Ref	Part No	Description	Remark	QTY KIT
43	506 54 20-01	HANDLE		1
44	535 41 50-73	LEVER		1
61	531 02 11-84	WASHER		31
47	535 41 50-76	SPRING		1
60	535 41 50-84	SCREW		1
76	535 41 50-91	SCREW		2
31	531 00 53-15	PROTECTOR		2
14	535 41 50-59	PULLEY		1
61	531 02 11-84	WASHER		31
77	531 02 11-44	SCREW		9
19	535 41 50-62	COVER		1
83	535 41 50-94	WASHER		1
87	535 41 50-95	SPACER		1
13	535 41 50-58	LEVER		1
22	531 02 12-19	NUT		82
61	531 02 11-84	WASHER		31
11	535 41 50-56	HOLDER		1
1	535 46 66-74	FRAME		1
75	531 02 12-59	BOLT		2
61	531 02 11-84	WASHER		31
46	535 41 50-75	ROD		4
46	535 41 50-75	ROD		4
61	531 02 11-84	WASHER		31
22	531 02 12-19	NUT		82
31	531 00 53-15	PROTECTOR		2
40	535 46 66-77	GUARD		1
41	535 41 50-71	SCREW		4
71	535 41 50-90	WASHER		4
61	531 02 11-84	WASHER		31
74	531 02 11-32	NUT		1
22	531 02 12-19	NUT		82
61	531 02 11-84	WASHER		31
45	535 41 50-74	LEVER		1
80	531 00 52-66	SCREW		1
79	531 02 11-46	SCREW		6
81	535 41 50-93	SCREW		1
69	531 02 11-37	WASHER		5
12	535 41 50-57	SPRING		1
62	535 41 50-85	PULLEY		1
85	531 02 11-38	BEARING		1
84	531 00 51-98	SPACER		1
82	531 02 11-30	NUT		2
16	535 41 50-61	PULLEY		1
17	535 41 50-48	BELT		1
86	531 02 11-96	SCREW		2
22	531 02 12-19	NUT		82
79	531 02 11-46	SCREW		6
36	535 41 50-66	BALL BEARING		2
37	535 41 50-67	PROTECTOR		2
38	535 41 50-68	PLATE		2
73	531 02 11-98	NUT		12
82	531 02 11-30	NUT		2
61	531 02 11-84	WASHER		31
77	531 02 11-44	SCREW		9
10	535 41 50-55	PLATE		1
77	531 02 11-44	SCREW		9
61	531 02 11-84	WASHER		31
61	531 02 11-84	WASHER		31
77	531 02 11-44	SCREW		9
27	531 00 51-81	BEARING		1
22	531 02 12-19	NUT		82
67	531 00 52-20	KEY		1
26	535 41 50-64	SHAFT		1
25	535 41 50-25	LINK		1

PRODUCT COMPLETE

FLAIL MOWER T-60362, 966 83 32-01, 2008-10

Ref	Part No	Description	Remark	QTY KIT
29	535 41 50-29	SCREW		1
28	531 02 11-70	PIN RETAINING SCREW		1
69	531 02 11-37	WASHER		5
68	535 41 50-89	SCREW		4
24	535 46 66-10	GEAR BOX		1
30	535 41 50-28	KEY		1
99	535 46 66-27	KEY		1
96	535 46 66-78	PULLEY		1
97	535 46 66-26	WASHER		1
98	725 64 53-01	SCREW IHCSFM		1
5	535 46 66-73	PLATE		1
70	535 41 50-36	SCREW		8
72	535 41 50-11	WASHER		2
39	535 41 50-69	SCREW		1
79	531 02 11-46	SCREW		6
22	531 02 12-19	NUT		82
73	531 02 11-98	NUT		12
38	535 41 50-68	PLATE		2
37	535 41 50-67	PROTECTOR		2
36	535 41 50-66	BALL BEARING		2
35	535 41 50-65	SPACER		1
42	535 41 50-72	HAND GUARD		1
15	535 46 66-76	SHAFT		1
22	531 02 12-19	NUT		82
21	535 41 50-63	BLADE		112
23	531 02 11-99	SCREW		1

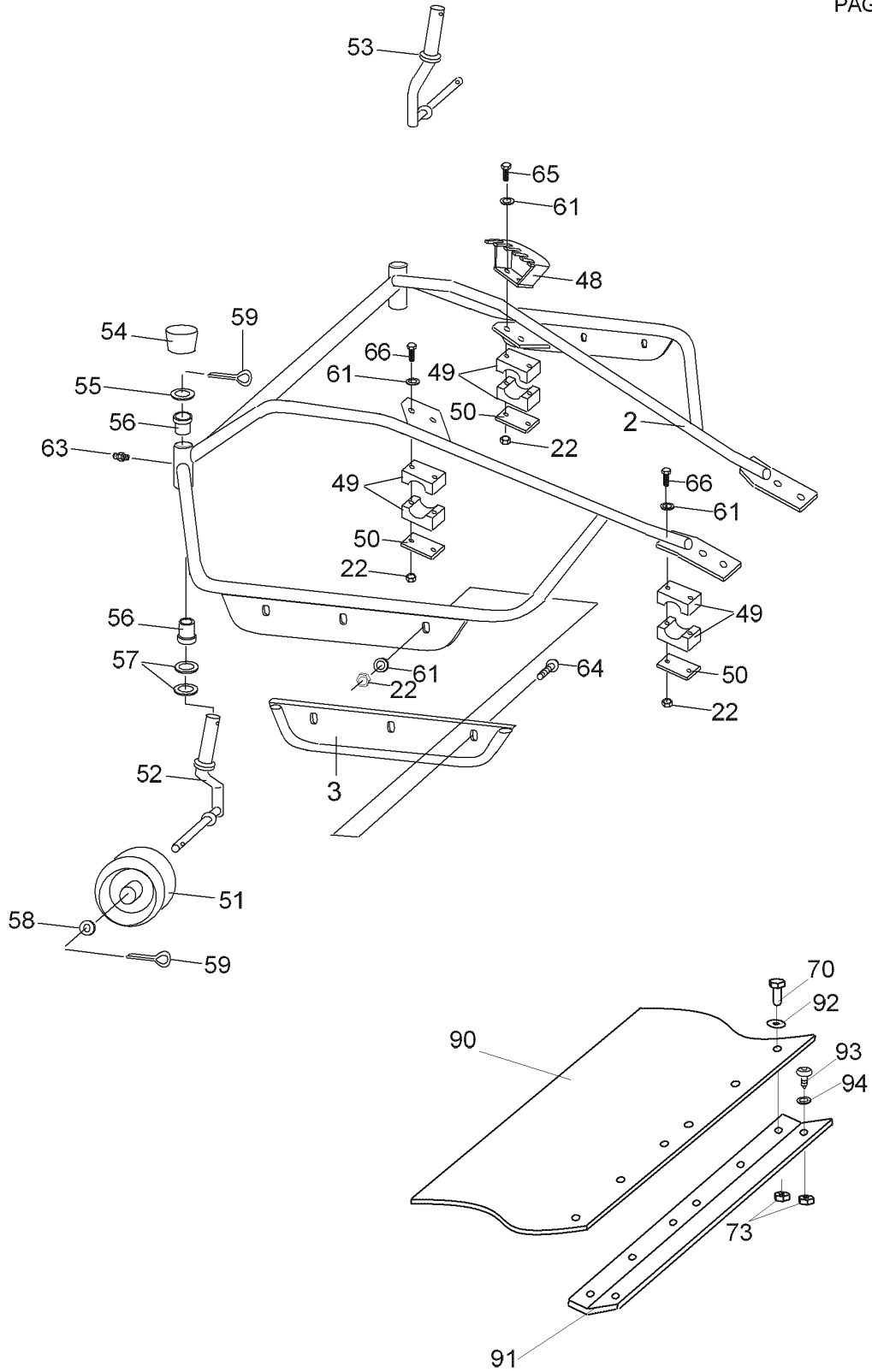

966 83 32-01
T-60362

PRODUCT COMPLETE

FLAIL MOWER T-60362, 966 83 32-01, 2008-10

Ref	Part No	Description	Remark	QTY KIT
53	535 41 50-79	SHAFT		1
59	535 41 50-83	SPLIT PIN		4
54	535 41 50-80	PROTECTOR		2
55	535 41 50-81	WASHER		2
56	535 41 50-82	BUSHING		4
63	535 41 50-86	NIPPLE		2
56	535 41 50-82	BUSHING		4
57	531 00 52-25	WASHER		4
52	535 41 50-78	SHAFT		1
58	531 02 12-24	WASHER		2
59	535 41 50-83	SPLIT PIN		4
51	506 96 30-01	WHEEL ASSY		2
3	535 41 50-53	RAIL		2
22	531 02 12-19	NUT		82
61	531 02 11-84	WASHER		31
22	531 02 12-19	NUT		82
50	506 81 38-01	REINFORCING PLATE		4
49	506 86 96-01	BEARING		8
61	531 02 11-84	WASHER		31
66	535 41 50-88	SCREW		6
65	535 41 50-87	SCREW		2
61	531 02 11-84	WASHER		31
48	535 41 50-77	SEGMENT		1
49	506 86 96-01	BEARING		8
50	506 81 38-01	REINFORCING PLATE		4
22	531 02 12-19	NUT		82
64	535 41 50-43	SCREW		6
22	531 02 12-19	NUT		82
50	506 81 38-01	REINFORCING PLATE		4
49	506 86 96-01	BEARING		8
61	531 02 11-84	WASHER		31
66	535 41 50-88	SCREW		6
2	535 46 66-75	FRAME		1
90	535 46 66-04	SPLASH GUARD		1
91	535 46 66-05	BRACKET		1
73	531 02 11-98	NUT		12
94	506 55 97-01	WASHER		2
93	506 98 26-01	SCREW		2
92	531 02 11-97	WASHER		1
70	535 41 50-36	SCREW		8