

Bumper Installation Instructions

Old Style Bumper

(530 30 70-07)

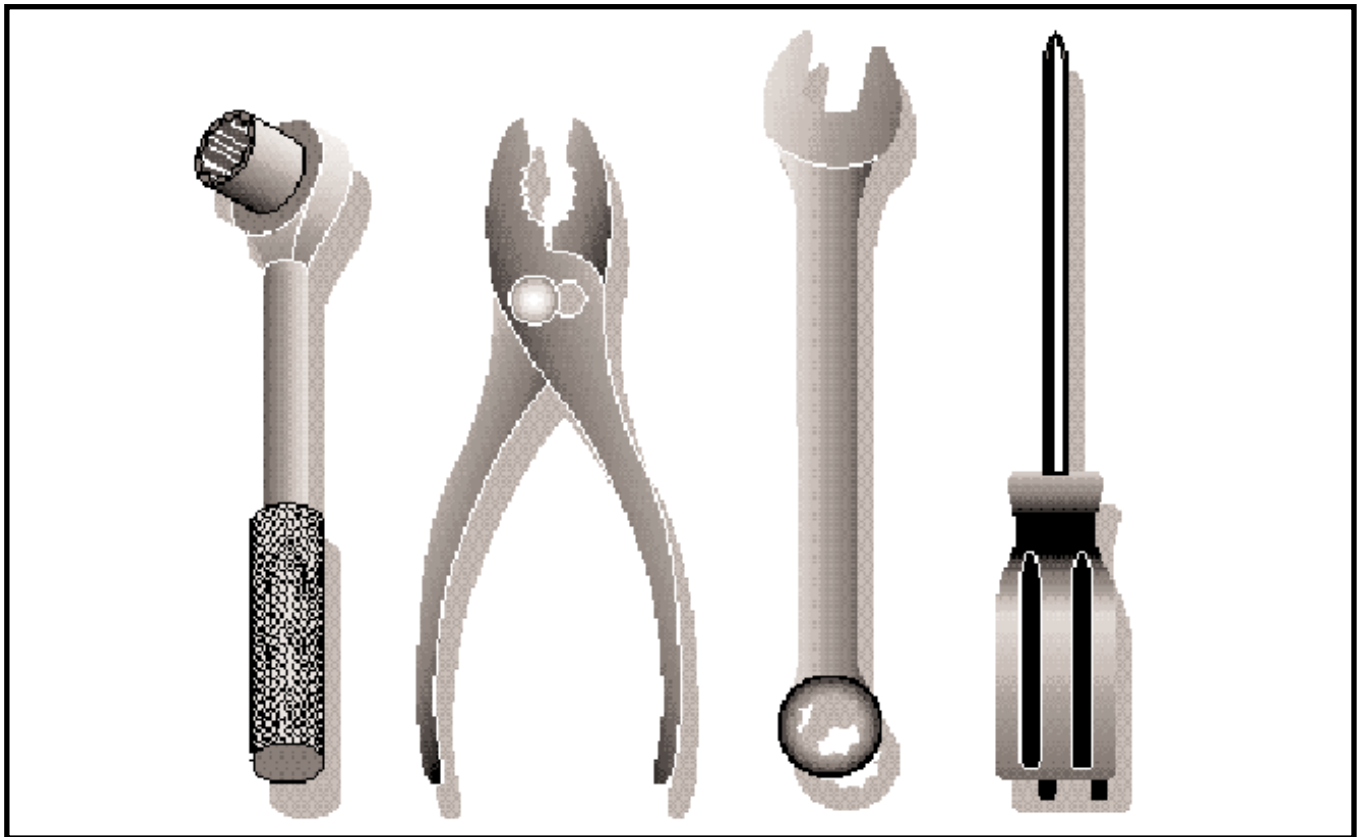

#400944 BUMPER INSTALLATION INSTRUCTIONS

For GT's/LT's/YT's
Model Year 2006 and Newer

1. Disconnect the lights and remove hood.
2. Remove Front Chassis Cover, if one is present. Do not reuse Front Chassis Cover or screws.
3. Remove Browning Shield, if one is present that is like one shown.
4. Remove Top Muffler Shield.
5. Remove Muffler.
6. Position bumper and loosely assemble to top chassis hole with supplied 3/8-16 hex bolts, 3/8 lockwashers and 3/8 nuts. Do not tighten yet. Allow it to hang from chassis.
7. Pivot upwards to align bumper with front holes in chassis.
8. With holes aligned, install 3/8-16 hex bolts, 3/8 lockwashers and 3/8 nuts in front holes.
9. Tighten all four (4) bolts securely.
10. Reattach Muffler and Top Muffler Shield
11. Reattach Browning Shield after installing bumper.

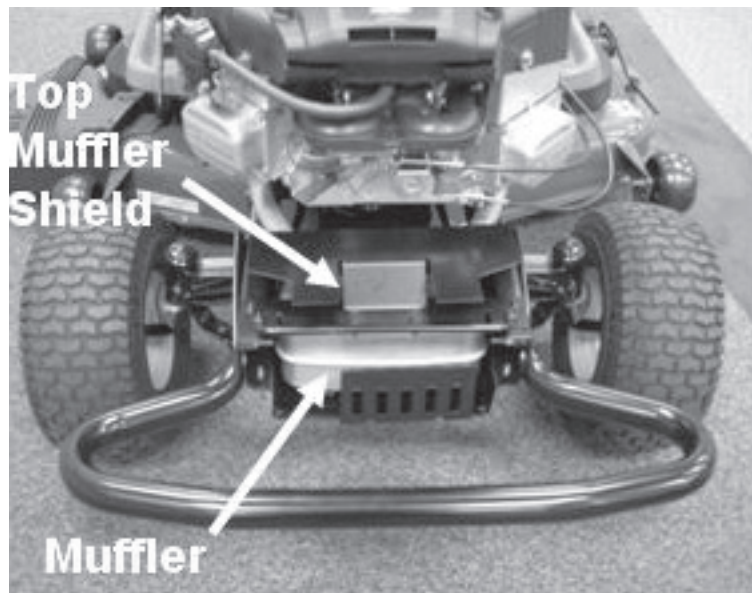
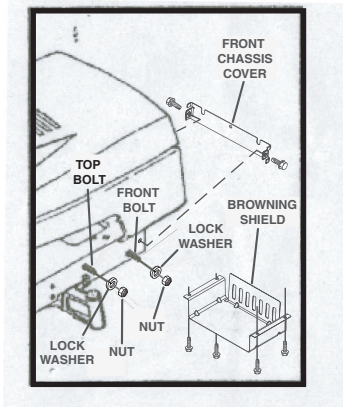

See Other Side For Models Before 2006

#400944 BUMPER INSTALLATION INSTRUCTIONS

For GT's/LT's/YT's
Model Year 2006 and Newer

1. Disconnect the lights and remove hood.
2. Remove Front Chassis Cover, if one is present. Do not reuse Front Chassis Cover or screws.
3. Remove Browning Shield, if one is present that is like one shown.
4. Remove Top Muffler Shield.
5. Remove Muffler.
6. Position bumper and loosely assemble to top chassis hole with supplied 3/8-16 hex bolts, 3/8 lockwashers and 3/8 nuts. Do not tighten yet. Allow it to hang from chassis.
7. Pivot upwards to align bumper with front holes in chassis.
8. With holes aligned, install 3/8-16 hex bolts, 3/8 lockwashers and 3/8 nuts in front holes.
9. Tighten all four (4) bolts securely.
10. Reattach Muffler and Top Muffler Shield
11. Reattach Browning Shield after installing bumper.

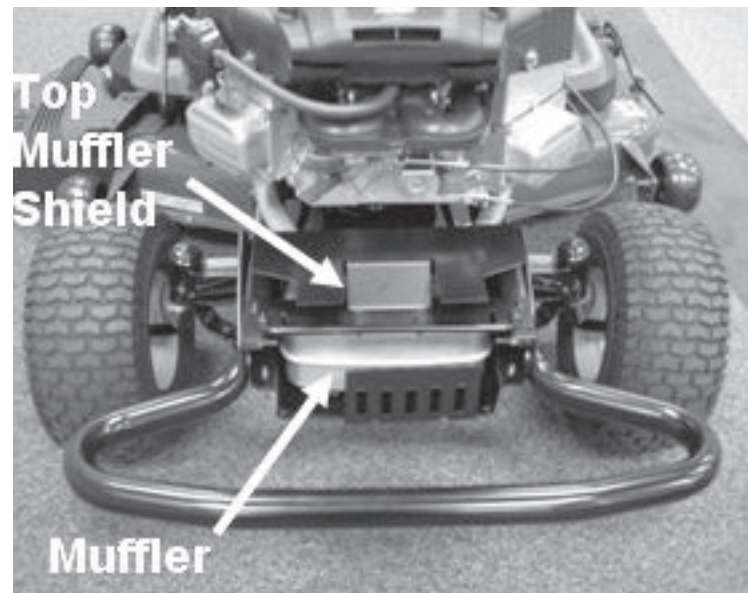
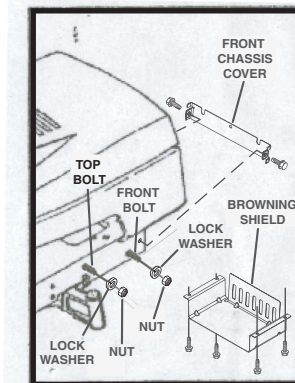

See Other Side For Models Before 2006

#400944 BUMPER INSTALLATION INSTRUCTIONS

For LT's/YT's
Model Year 2000 and Newer

Remove and discard the existing top and front bolts from both sides of chassis.

Position bumper and loosely assemble to top chassis hole with supplied 3/8-16 hex bolts. Do not tighten the bumper at this time. Allow it to hang from the chassis.

Pivot upwards to align bumper with holes in chassis.

With holes aligned, install 3/8-16 hex bolts. Self threading bolts are also supplied for these holes if required.

Tighten all four (4) bolts securely.

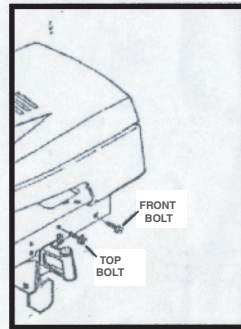

#400944 BUMPER INSTALLATION INSTRUCTIONS

For LT's/YT's
Model Year 2000 and Newer

Remove and discard the existing top and front bolts from both sides of chassis.

Position bumper and loosely assemble to top chassis hole with supplied 3/8-16 hex bolts. Do not tighten the bumper at this time. Allow it to hang from the chassis.

Pivot upwards to align bumper with holes in chassis.

With holes aligned, install 3/8-16 hex bolts. Self threading bolts are also supplied for these holes if required.

Tighten all four (4) bolts securely.

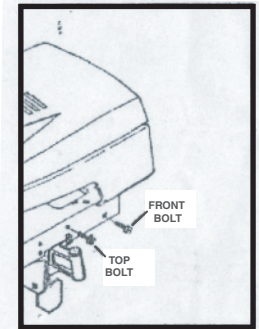

For GT's before 2006
For LT's/YT's before 1997

Temporarily remove the four (4) sets of carriage bolts, washers, and locknuts securing both front suspension brackets to chassis.

Position bumper and loosely assemble to rear chassis hole with hardware previously removed. Do not tighten the bumper at this time. Allow it to hang from the chassis. Pivot upwards to align hole in bumper with hole in tractor chassis.

With all holes aligned, assemble carriage bolt, washer, and locknut to both sides of tractor chassis.

Tighten all four (4) locknuts securely.

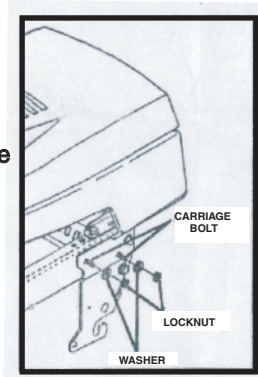

For GT's before 2006
For LT's/YT's before 1997

Temporarily remove the four (4) sets of carriage bolts, washers, and locknuts securing both front suspension brackets to chassis.

Position bumper and loosely assemble to rear chassis hole with hardware previously removed. Do not tighten the bumper at this time. Allow it to hang from the chassis. Pivot upwards to align hole in bumper with hole in tractor chassis.

With all holes aligned, assemble carriage bolt, washer, and locknut to both sides of tractor chassis.

Tighten all four (4) locknuts securely.

