

531 03 10-07

## HDC 1000 (45-01714-669)

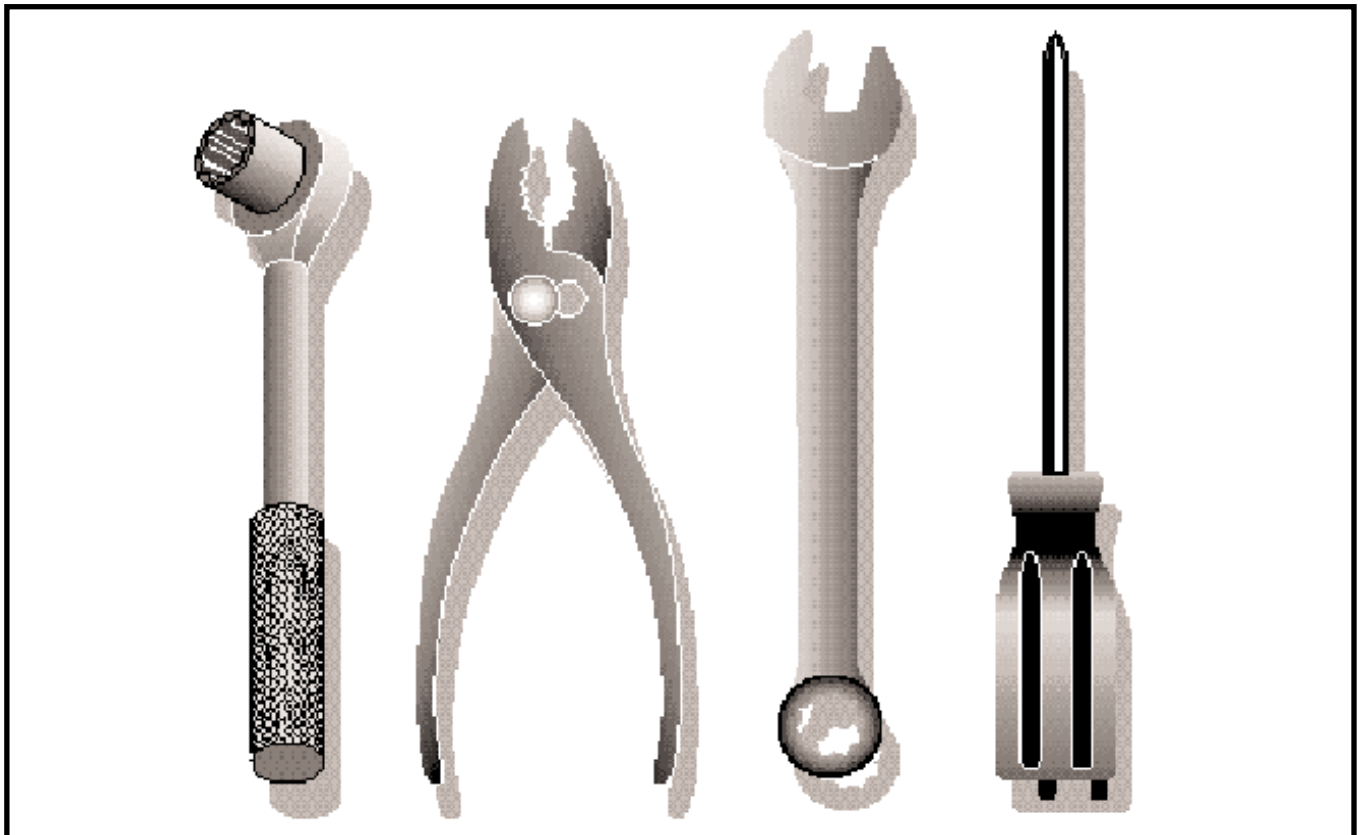

# OWNERS MANUAL

**Model No.  
45-01714-669**

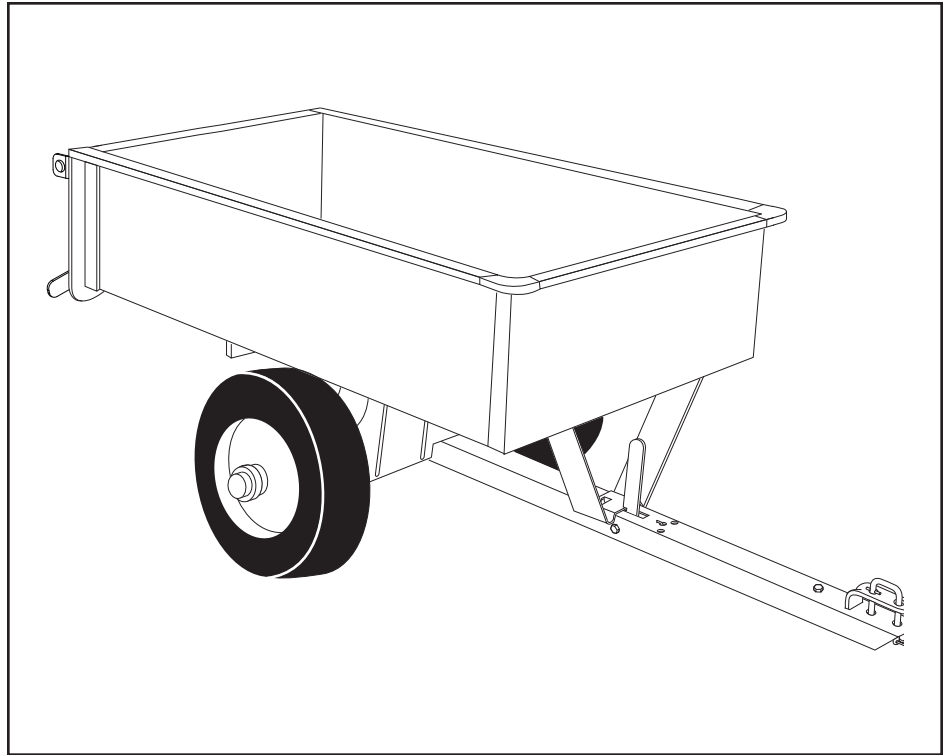

## 10 CU. FT. CART

**CAUTION:**  
Read Rules for  
Safe Operation  
and Instructions  
Carefully

- Assembly
- Operation
- Maintenance
- Repair Parts

***SpeedEPart*** *the fastest way to purchase parts* [www.speedepart.com](http://www.speedepart.com)

# SAFETY RULES

Remember, any power equipment can cause injury if operated improperly or if the user does not understand how to operate the equipment. Exercise caution at all times when using power equipment.



**LOOK FOR THIS SYMBOL TO POINT OUT IMPORTANT SAFETY PRECAUTIONS. IT MEANS — ATTENTION! BECOME ALERT! YOUR SAFETY IS INVOLVED.**



**CAUTION: VEHICLE BRAKING AND STABILITY MAY BE AFFECTED WITH THE ADDITION OF AN ACCESSORY OR AN ATTACHMENT. BE AWARE OF CHANGING CONDITIONS ON SLOPES.**

Exercise caution at all times when using power equipment.

- Read this owners manual before attempting to assemble or operate the cart.
- Read the vehicle owners manual and know how to operate your tractor, before using the cart attachment.
- Do not at any time carry passengers in this cart. It has not been designed to carry passengers.
- Never allow children to operate the tractor or the cart attachment.
- Do not allow adults to operate the tractor or cart attachment without proper instructions.
- Always begin with the transmission in first (low) and gradually increase speed as conditions permit.
- Tow the cart at reduced speed over rough terrain and hillsides or near creeks and ditches to prevent tipping over and loss of control. Do not drive too close to a creek or ditch.
- Vehicle braking and stability may be affected with the attachment of this cart. Do not fill cart to maximum weight capacity without checking the capability of the towing vehicle to safely pull and stop with the cart attached.
- Before operating vehicle on any grade (hill) refer to the safety rules in the vehicle owner's manual concerning safe operation on slopes. Refer also to the slope guide on page 7 of this manual. **Stay off steep slopes!**
- Do not tow this cart on highways or on public thoroughfares.
- Maximum towing speed is 10 m.p.h.
- Follow maintenance and lubrication instructions as outlined in this manual.

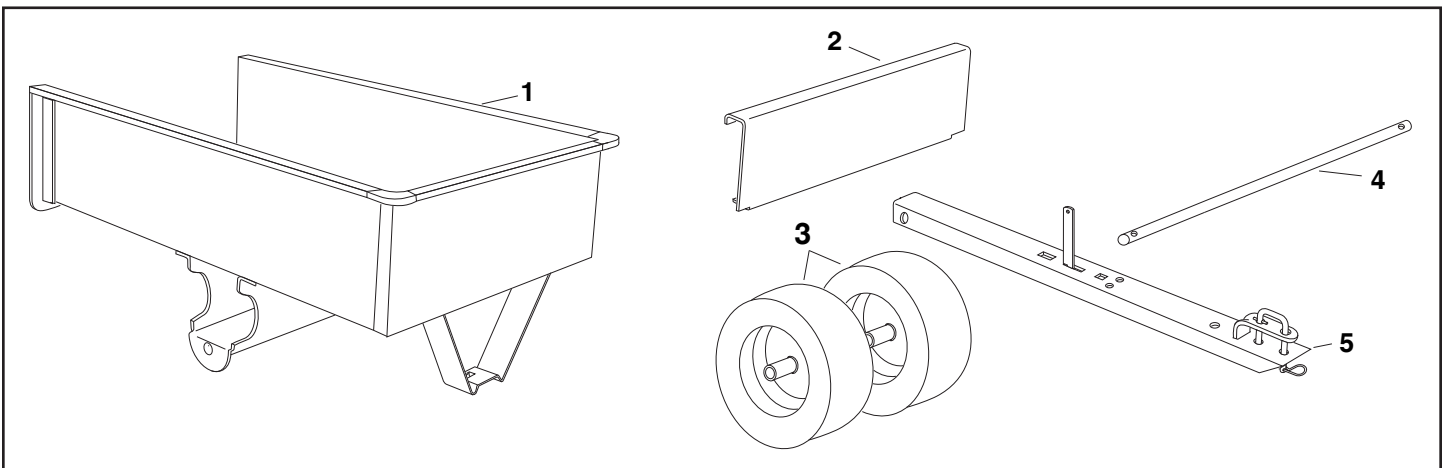

**CARTON CONTENTS** (Loose Parts)

| REF | QTY | DESCRIPTION | REF | QTY | DESCRIPTION     |
|-----|-----|-------------|-----|-----|-----------------|
| 1   | 1   | Cart Body   | 4   | 1   | Axle            |
| 2   | 1   | Tailgate    | 5   | 1   | Draw Bar Tongue |
| 3   | 2   | Wheels      |     |     |                 |

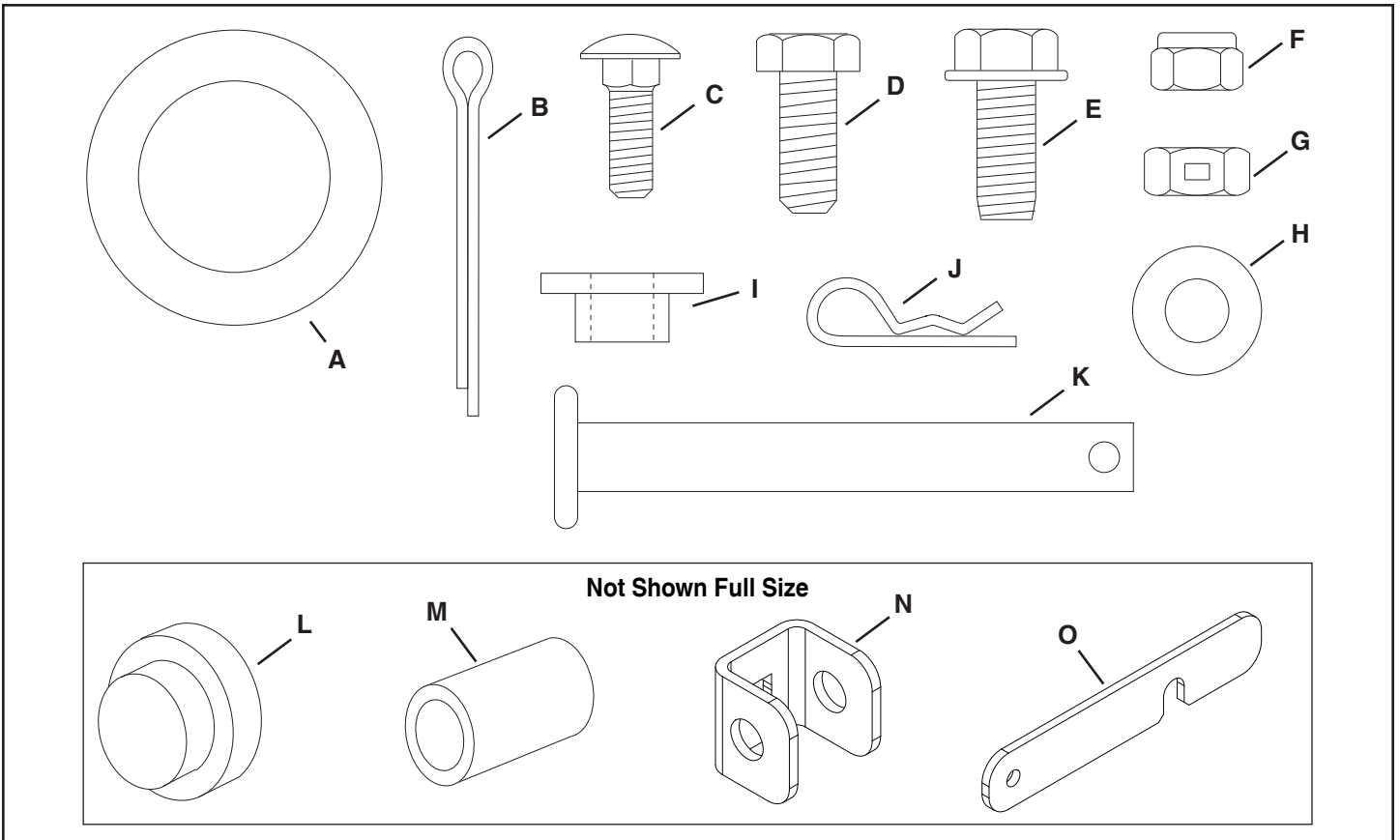

**HARDWARE PACK (SHOWN FULL SIZE EXCEPT WHERE NOTED)**

| REF | QTY | DESCRIPTION                         | REF | QTY | DESCRIPTION    |
|-----|-----|-------------------------------------|-----|-----|----------------|
| A   | 4   | Large Washer                        | I   | 2   | Step Bushing   |
| B   | 2   | Cotter Pin                          | J   | 2   | Hairpin Cotter |
| C   | 4   | Carriage Bolt, 1/4-20 x 3/4"        | K   | 2   | Clevis Pin     |
| D   | 2   | Hex Bolt, 5/16-18 x 3/4"            | L   | 2   | Hub Cap        |
| E   | 2   | Self Threading Bolt, 5/16-18 x 3/4" | M   | 2   | Spacer Tube    |
| F   | 4   | Nylock Nut, 1/4"                    | N   | 4   | Tailgate Hinge |
| G   | 2   | Lock Nut, 5/16"                     | O   | 2   | Tailgate Latch |
| H   | 2   | Nylon Washer                        |     |     |                |

# ASSEMBLY INSTRUCTIONS

## TOOLS REQUIRED FOR ASSEMBLY

- (1) Pliers
- (2) 7/16" Wrenches
- (2) 1/2" Wrenches

## Additional Items Required

Grease or lightweight oil or a grease gun

1. Remove the hardware pack and all loose parts from the carton. Be sure the carton is empty before discarding.
2. Lay out all parts as shown in the carton contents.
3. Lower the cart to rest upside down on its top flanges, so that the wheel support is facing up. See figure 1.
4. Lay the drawbar tongue (open side facing up) onto the wheel support and the latch stand bracket. Assemble the axle through the wheel support and the tongue. See figure 1.
5. Lock the drawbar tongue to the latch stand bracket using the latch lock lever. See figure 1.

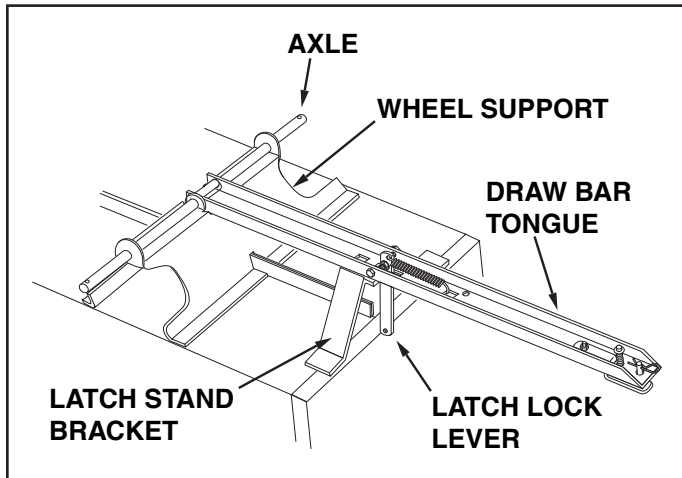

FIGURE 1

6. Place a spacer tube and a washer onto each end of the axle. See figure 2.
7. Apply a light coating of grease or oil to the ends of the axle now or wait until the wheels are assembled and use a grease gun.
8. Assemble a wheel (valve stem facing out) and a flat washer onto the axle. Secure the wheel on the axle with a cotter pin, spreading the ends of the pin around the axle. Press a hub cap onto the flat washer. Repeat on other end of axle. See figure 2.

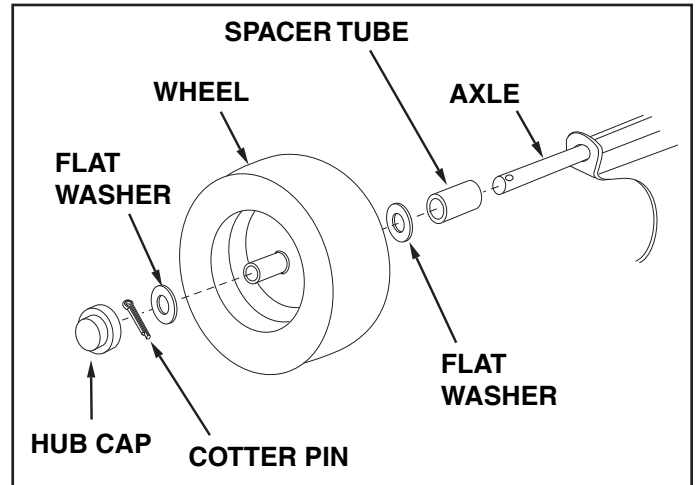

FIGURE 2

**IMPORTANT:** Make sure the drawbar tongue is securely locked to the latch stand bracket by the latch lock lever.

8. Turn the cart over so it rests on its wheels.
9. Attach two tailgate hinges to the top holes in the rear of the cart using two 1/4" x 3/4" carriage bolts and 1/4" nylock nuts. See figure 3.
10. Attach two step bushings to the holes shown in the rear of the cart using two 5/16" x 3/4" self threading bolts. See figure 3.

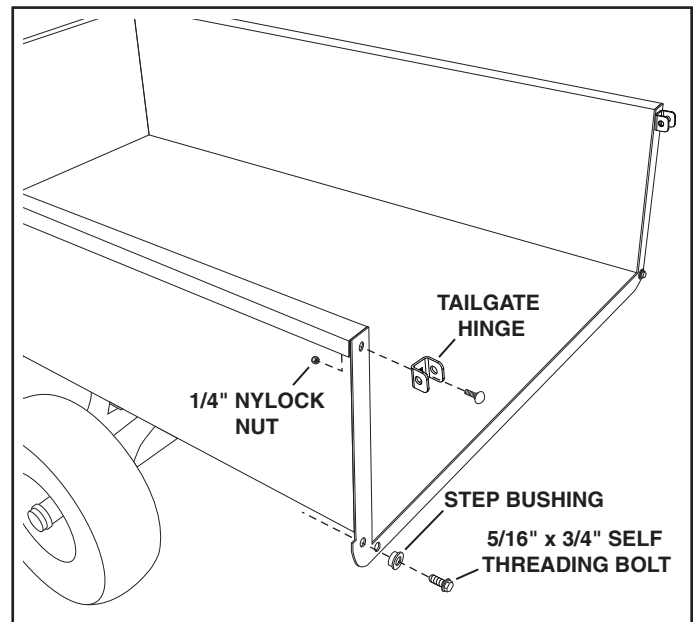

FIGURE 3

- Attach two tailgate hinges to the top holes in the tailgate using two 1/4" x 3/4" carriage bolts and 1/4" nylock nuts. See figure 4.
- Attach the two tailgate latches to the bottom holes in the tailgate using two 5/16" x 3/4" hex bolts, nylon washers and 5/16" lock nuts. See figure 4.

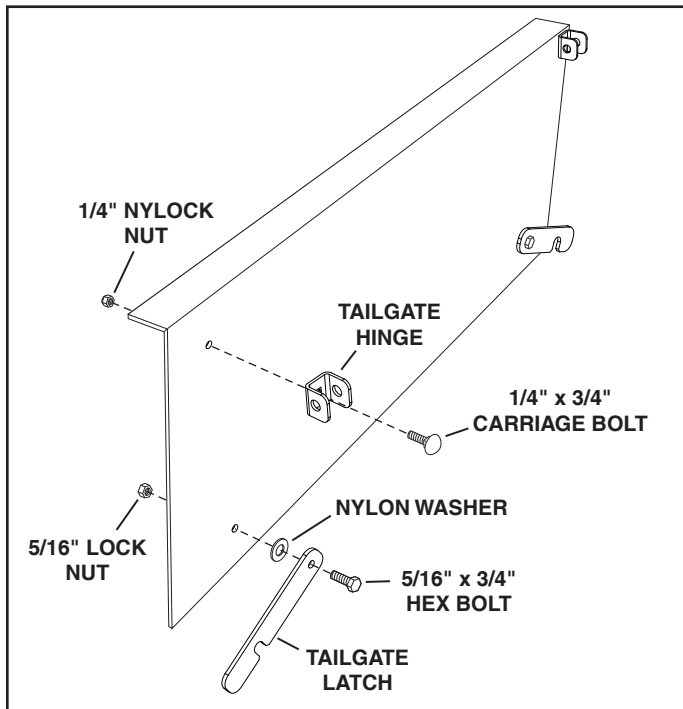

FIGURE 4

- Secure the top of the tailgate to the cart by sliding a clevis pin through the tailgate hinges and securing it in place with a hairpin cotter. See figure 5.
- Slide the tailgate latches over the step bushings assembled in step 10 to lock the tailgate in place. See figure 5.

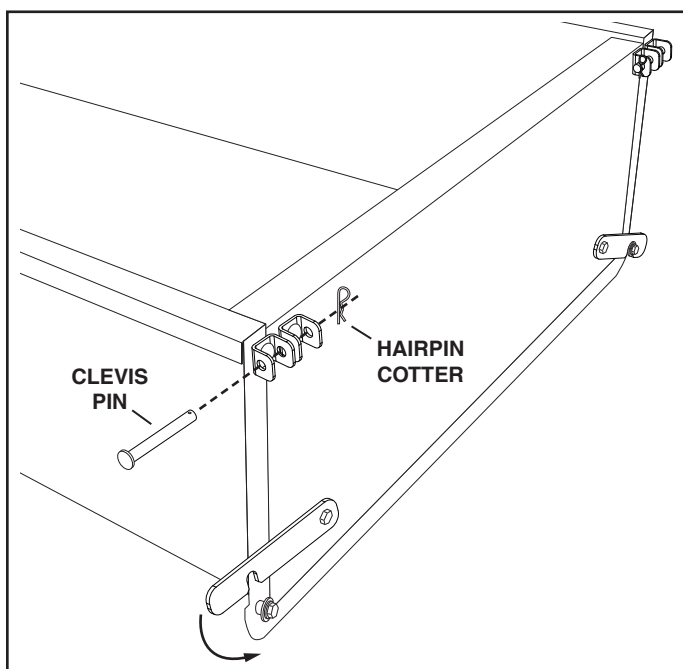

FIGURE 5

## OPERATION



**CAUTION: VEHICLE BRAKING AND STABILITY MAY BE AFFECTED WITH THE ADDITION OF AN ACCESSORY OR AN ATTACHMENT. BE AWARE OF CHANGING CONDITIONS ON SLOPES.**

- Refer to the vehicle owners manual for instructions about safe operation on slopes.
- Use the slope guide provided on page 7 of this manual to determine if slope angle is too steep for safe operation.
- For best handling and traction, distribute the weight of the load evenly in the cart.
- Always test to make sure your tractor has adequate towing and braking capabilities whenever hauling a substantial amount of weight in your cart. Use extra caution when operating on slopes.



**IMPORTANT!**

**DO NOT EXCEED 1,000 LB. WEIGHT CAPACITY OF CART**

*One cubic foot of dirt weighs approximately 80 lbs.*

- To dump material from the cart, remove the tailgate by lifting it straight up and out from between the guides. Release the spring latch on the tongue by pulling the latch lock lever forward, away from the cart. The cart bed will then tilt backwards to empty its contents. After emptying, pull the front of the bed down toward the cart tongue until the latch snaps into place. Replace the tailgate if desired.
- The maximum towing speed for this cart is 10 m.p.h.



**CAUTION: TO AVOID POSSIBLE INJURY, BEFORE RELEASING THE LATCH BE SURE THAT NO ONE IS NEAR THE CART.**

## MAINTENANCE

- At the beginning of each season, lubricate, with a light machine oil, the latch, the latch pivot bolt, and the area of the axle where the draw bar tongue pivots.
- Grease or oil the wheel bearings periodically. Use automotive wheel bearing type grease or 20 weight oil.
- Keep tires filled to the recommended tire pressure of 12-14 Lbs.

# REPAIR PARTS FOR UTILITY CART MODEL 45-01714-669

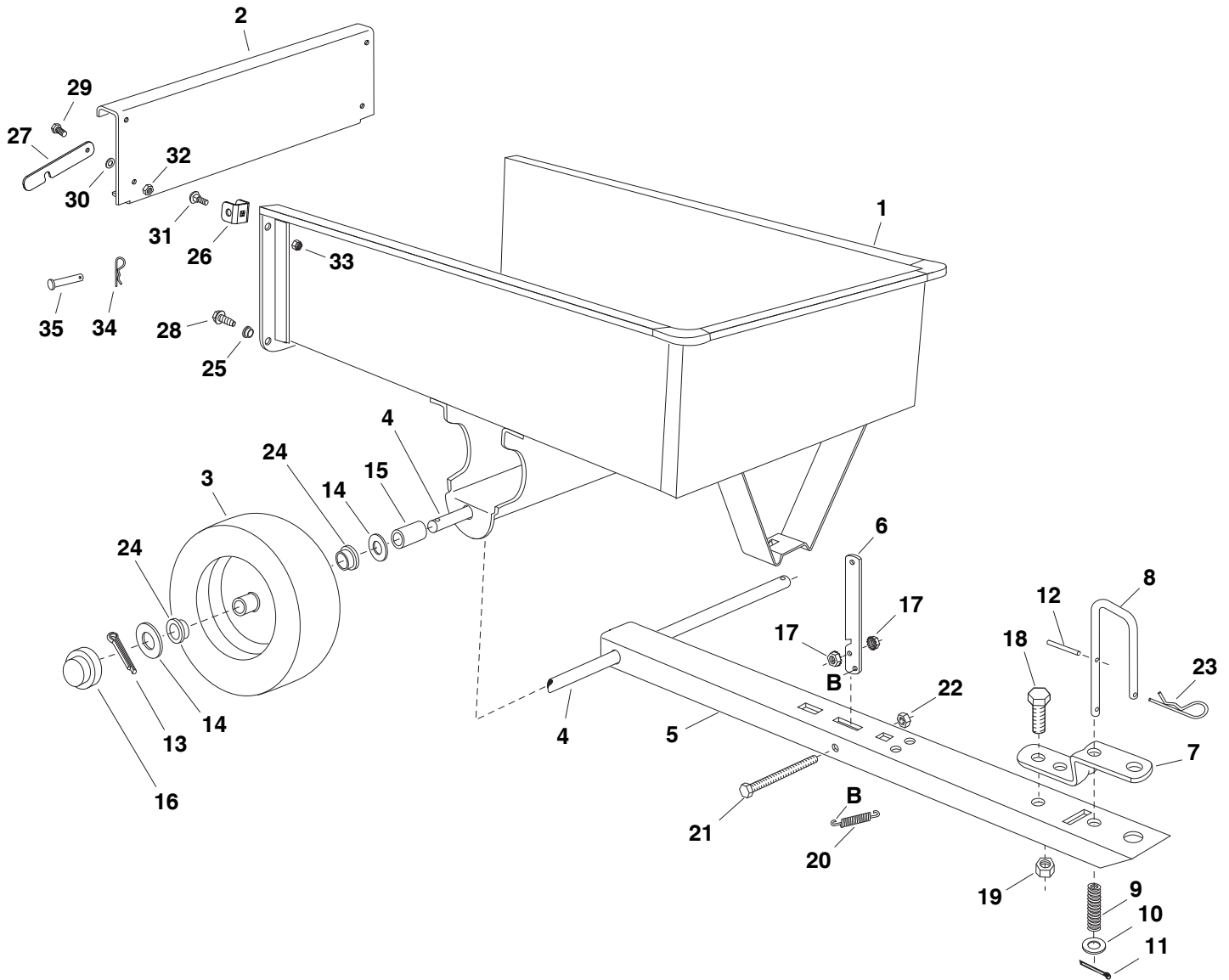

| REF. NO. | PART NO. | QTY | DESCRIPTION                | REF. NO. | PART NO. | QTY | DESCRIPTION                      |
|----------|----------|-----|----------------------------|----------|----------|-----|----------------------------------|
| 1        | 65935    | 2   | Cart Body Assembly         | 19       | HA21362  | 1   | Nylock Nut, 3/8-16               |
| 2        | 23502    | 1   | Tailgate                   | 20       | 47408    | 1   | Extension Spring                 |
| 3        | 46272    | 2   | Wheel                      | 21       | 47407    | 1   | Hex Bolt, 5/16-18 x 3-3/4"       |
| 4        | 24897    | 1   | Wheel Axle, 1" Dia.        | 22       | 47810    | 1   | Nylock Nut, 5/16-18              |
| 5        | 24750    | 1   | Draw Bar Tongue            | 23       | 43343    | 1   | Hairpin Cotter                   |
| 6        | 24498    | 1   | Latch Lock Lever           | 24       | 44488    | 4   | Wheel Bearing                    |
| 7        | 23687    | 1   | Hitch Bracket              | 25       | 1657-5   | 2   | Step Bushing                     |
| 8        | 49672    | 1   | Hitch Pin                  | 26       | 26156    | 4   | Tailgate Hinge                   |
| 9        | 48905    | 1   | Compression Spring         | 27       | 26155    | 2   | Tailgate Latch                   |
| 10       | 43070    | 1   | Washer, 3/8"               | 28       | 47630    | 2   | Self Thread Bolt, 5/16-18 x 3/4" |
| 11       | 142      | 1   | Cotter Pin, 1/8" x 3/4"    | 29       | 43182    | 2   | Hex Bolt, 5/16-18 x 3/4"         |
| 12       | 44665    | 1   | Spring Pin, 5/32" x 1-1/4" | 30       | 48015    | 2   | Nylon Washer                     |
| 13       | 43093    | 2   | Cotter Pin, 1/8" x 1-1/2"  | 31       | 44950    | 4   | Carriage Bolt, 1/4-20 x 3/4"     |
| 14       | 43061    | 4   | Washer, 1"                 | 32       | 43064    | 2   | Lock Nut, 5/16-18                |
| 15       | 44678    | 2   | Spacer Tube                | 33       | 47189    | 4   | Nylock Nut, 1/4-20               |
| 16       | 43014    | 2   | Hub Cap                    | 34       | HA3090   | 2   | Hair Cotter Pin                  |
| 17       | 46980    | 2   | Hex Nut, 5/16-18 (SEMS)    | 35       | 47623    | 2   | Clevis Pin, 3/8 x 3"             |
| 18       | 43001    | 1   | Hex Bolt, 3/8-16 x 1"      |          | 40501    | 1   | Owner's Manual                   |

# SLOPE GUIDE

(Keep this sheet in a safe place for future reference.)

Use this guide to determine if a slope is safe for the operation of your tractor and cart. Refer also to the instructions in your vehicle owners manual.

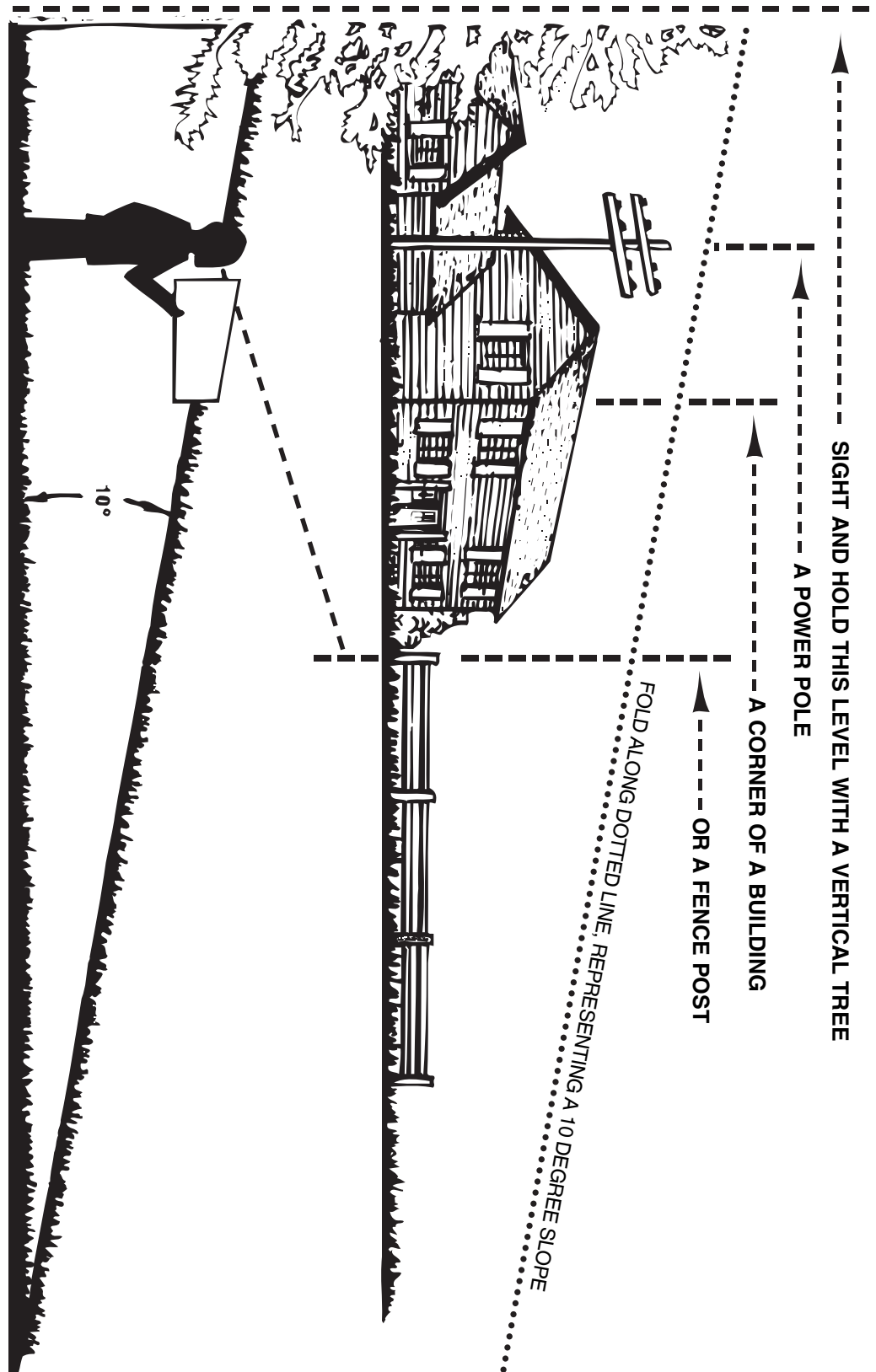

**CAUTION: DO NOT OPERATE YOUR TRACTOR AND CART ON A SLOPE IN EXCESS OF 10 DEGREES. BE SURE OF YOUR TRACTOR'S TOWING AND BRAKING CAPABILITIES BEFORE OPERATING ON A SLOPE. AVOID ANY SUDDEN TURNS OR MANEUVERS WHILE ON A SLOPE.**



***SpeedPart*** *the fastest way to purchase parts* [www.speedepart.com](http://www.speedepart.com)

**REPAIR PARTS**

Agri-Fab, Inc.  
809 South Hamilton  
Sullivan, IL. 61951  
217-728-8388  
[www.agri-fab.com](http://www.agri-fab.com)