

5 ADJUST THE MOWER TO SUIT YOUR GARDEN

See chapters 6.4 and 6.5 in the Operator's Manual.
Here you will find a few tips about important settings for your Automower.
All settings for Automower are made using the menu functions.

ADJUST THE MOWER TO SUIT THE SIZE OF YOUR LAWN

The mowing results depend on mowing time. Adjust the mowing time to suit your garden using the *Timer* function.
If the mower works too often: The lawn will appear trampled down.
If the mower works too seldom: The lawn will not be properly cut.

TIMER

You decide what times of the day and days of the week the mower is to work. Automower cuts around 90 m² / 950 ft² per hour and day. If your garden consists of 1000 m² / 0.25 acre grass, the mower should work on average 12 hours per day.

ADJUST THE MOWER FOR NARROW PASSAGES

Narrow passages in the garden make it difficult for the mower to find the charging station. Test to see if the mower finds its way home using the *Test IN* function.

1. Look for the narrowest passage in the garden (between the boundary loops).
2. Place the mower beyond the passage, with its front facing the boundary loop.
3. Activate the *Test IN* function (*Garden - Follow loop - Test IN*) and start the mower.
4. Ensure that the mower follows the boundary loop through the passage.
 - a. If the mower travels through: The test is complete.
 - a. If the mower does not travel through: Lower the value of the Corridor width, boundary by 1 unit. Restart the test from point 2.

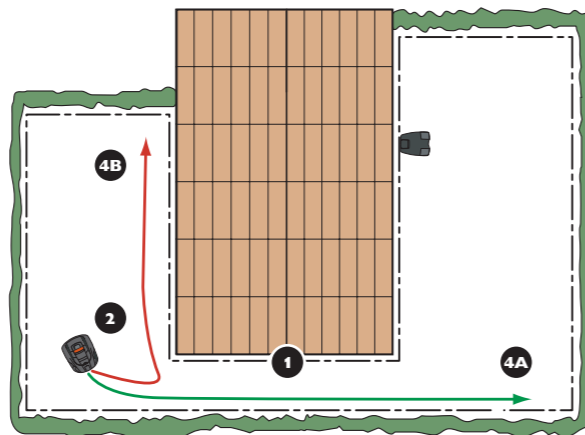

CORRIDOR WIDTH, BOUNDARY

Settings *Corridor width, boundary* (*Garden - Follow loop - Corridor width - Corridor width, bound.*) defines the distance between the mower's path to the boundary wire or the guide wire when following these to/from the charging station. The higher the stated Corridor width, the further from the loop the mower can travel. This produces less wheel tracks than if the mower were to travel close to the loop.

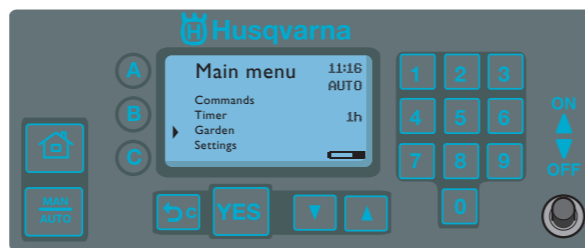

Garden - Follow loop - Test IN

GUIDE WIRE

See chapter 3.8 *Installation of the guide wire in the Operator's Manual.*

If you have a complicated garden or it has narrow passages (less than 2 m / 7 ft), we recommend installing a guide wire.

The guide wire is an extra wire that is run from the charging station, out towards a remote part of the work area or through a narrow passage. The mower can follow the guide wire to and from the charging station.

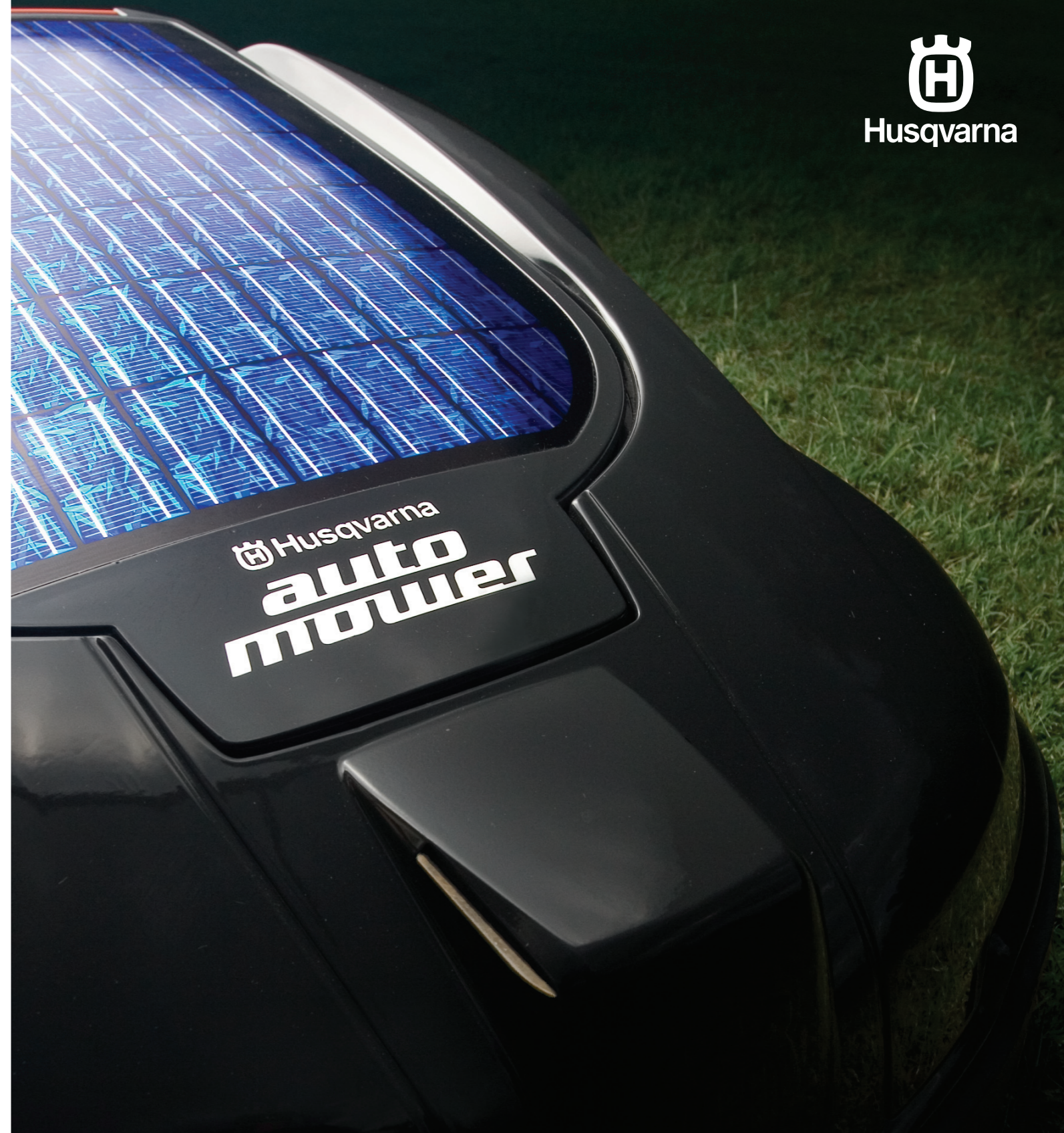

QUICK GUIDE
HUSQVARNA AUTOMOWER™
SOLAR HYBRID

GETTING STARTED WITH HUSQVARNA AUTOMOWER™

1 PLACEMENT AND CONNECTING THE CHARGING STATION

See chapter 3.2 in the Operator's Manual

1. Place the charging station centrally in the work area, leaving a lot of free space in front of the charging station and on a relatively horizontal surface.
2. Connect the low voltage cable to the charging station and transformer.
3. Connect the transformer's power cord to a mains wall socket. The 120V transformer (USA) is for indoor use only.

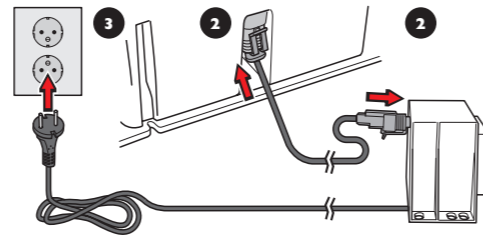

2 CHARGING THE BATTERY AND PLACING THE BOUNDARY WIRE

See chapters 3.3 and 3.4 in the Operator's Manual.

1. Place Automower in the charging station to charge the battery while you are laying the boundary wire. Set the main switch to the *OFF* position.
2. Run the boundary wire ensuring it forms a loop around the work area.

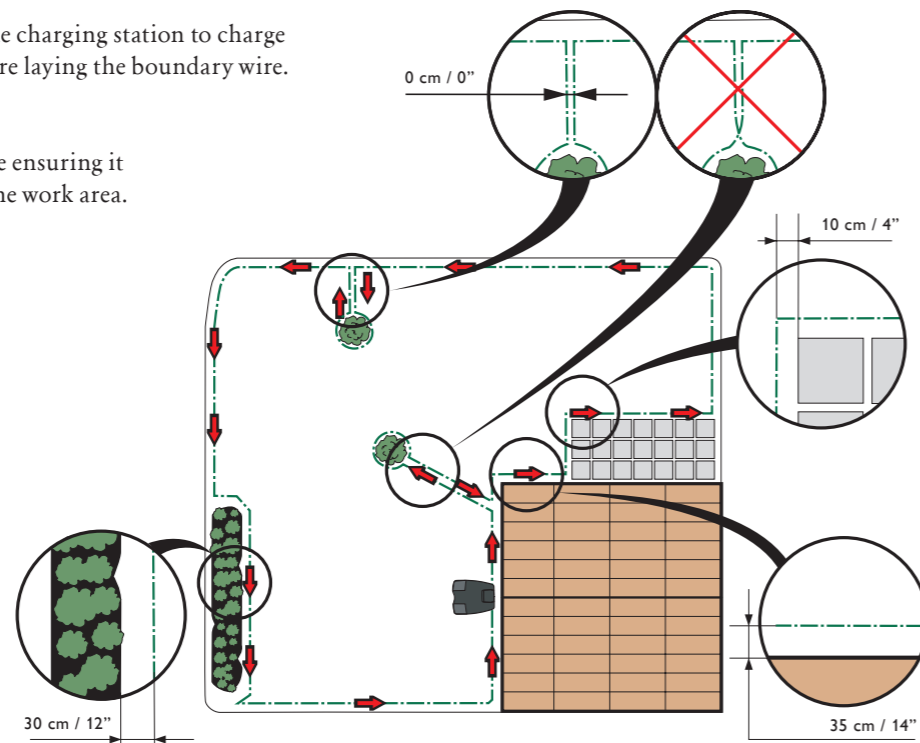

3 CONNECTING THE BOUNDARY WIRE

See chapter 3.5 in the Operator's Manual

1. Lift off the cover on the charging station and push in the ends of the boundary wire in the lower holes of the charging station and catch them in the upper holes:
 - Right wire end in right hole.
 - Left cable end in left hole.
2. Open the connector and run the wire ends in the recesses on each connector.
3. Press the connector together using a pair of pliers.
4. Cut off any surplus boundary wire. Cut 1-2 cm / 0.5" above the connector.
5. Press the connector onto the contact pin, marked A, on the charging station. Refit the cover on the charging station.

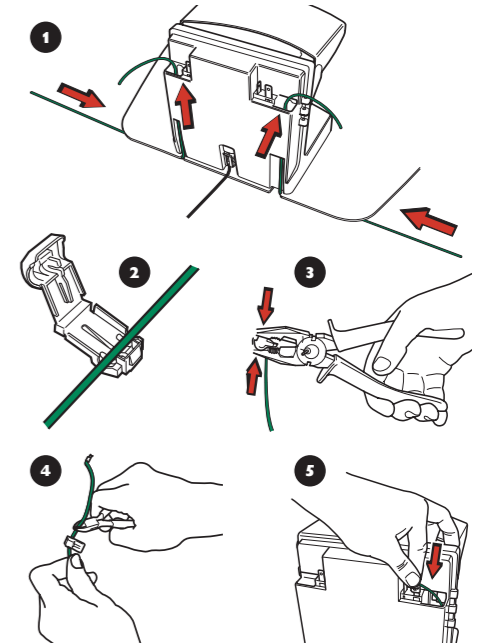

4 STARTING AND STOPPING AUTOMOWER™

See chapters 3.7, 4.3 and 4.4 in the Operator's Manual.

STARTING

1. Open the solar cell panel using the cut-out on the back edge of the panel to access the control panel.
2. Set the main switch to *ON* position. When you do this for the first time, a start up sequence starts where you select a four digit PIN code among other things. The mower must be in the charging station when you select a PIN code.
3. Close the solar cell panel and check that the *STOP* button is in the operating mode.

STOPPING

Press the *STOP* button.

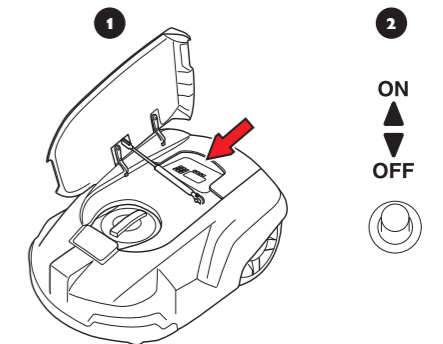

1. Charging strip
2. Solar cell panel
3. Cutting height adjustment cover
4. LED for performance inspection of boundary wire
5. Contact strips
6. Keypad
7. Display

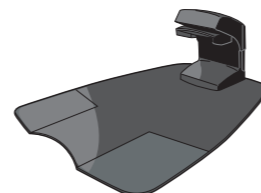
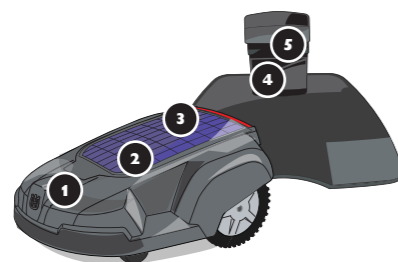

Charging station



Transformer

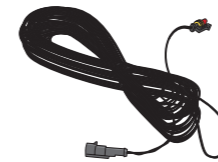

Low voltage cable

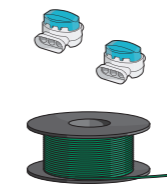

Boundary wire and coupler



Clinchers

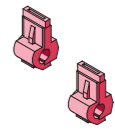

Connector



Measurement gauge