







SPARE PARTS LIST

ROBOTIC LAWN MOWERS

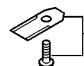
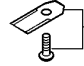
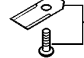
260 ACX, 2009-05

H Accessories
Zubehöre
Accessoires
Acessorios
Tillbehör

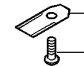
-  535 13 87-01 (9 pcs Original)
-  535 13 88-01 (30 pcs Original)
-  505 12 78-01 (500 pcs Original)

-  535 13 87-02 (9 pcs)
-  535 13 88-02 (30 pcs)
-  505 12 78-02 (500 pcs)

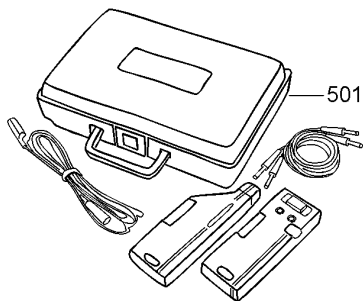

501 00 18-01 Loop wire interruption tester

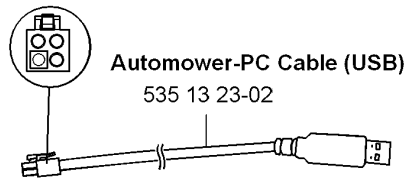

Automower-PC Cable (USB)
535 13 23-02

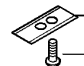
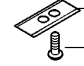
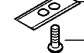
-  522 85 16-02 (9 pcs)
-  522 85 17-02 (30 pcs)
-  522 85 18-02 (300 pcs)

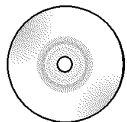

535 14 27-07 CD Autocheck 2009

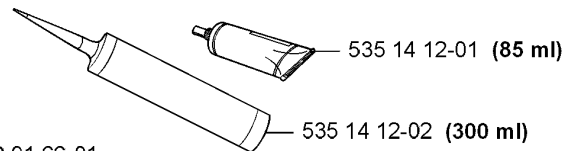

535 14 12-01 (85 ml)

535 14 12-02 (300 ml)

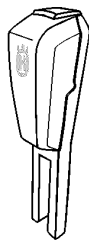

522 42 58-01
Signal booster



522 91 66-01



510 20 99-01 Heavy wheel (400g)

ACCESSORIES

260 ACX, 2009-05

Part No	Description	Remark	QTY KIT
501 00 18-01	TEST EQUIPMENT		1
505 12 78-01	BLADE		1
505 12 78-02	BLADE SET		1
510 20 99-01	WHEEL		1
522 42 58-01	BOOSTER		1
522 85 16-02	BLADE		1
522 85 17-02	BLADE		1
522 85 18-02	BLADE		1
522 91 66-01	BAG		1
535 13 23-02	WIRING		1
535 13 87-01	KIT		1
535 13 87-02	BLADE SET		1
535 13 88-01	KIT		1
535 13 88-02	BLADE SET		1
535 14 12-01	SEALING		1
535 14 12-02	SEALING		1
535 14 27-07	AUTOMOWER CD		1

D

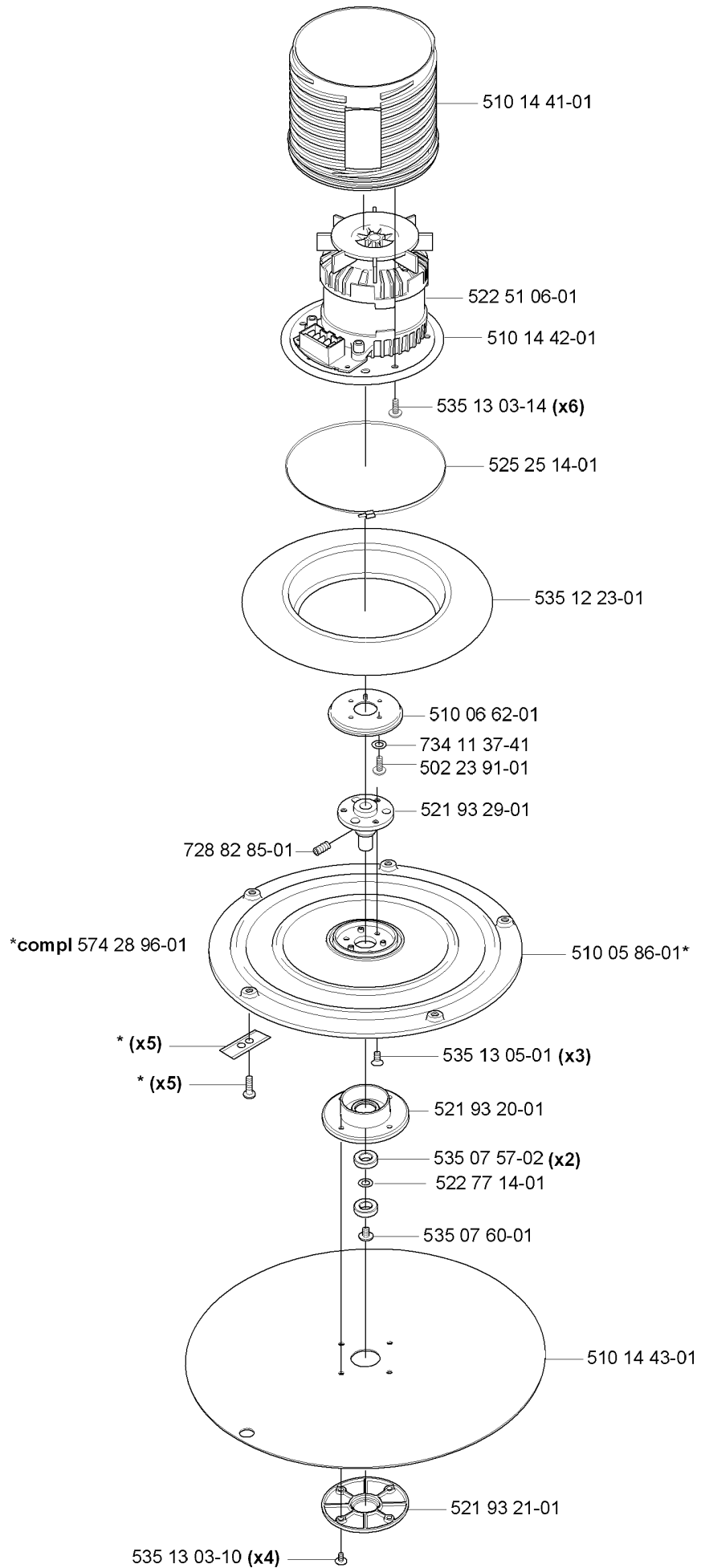

BLADE MOTOR & CUTTING EQUIPMENT

260 ACX, 2009-05

Part No	Description	Remark	QTY KIT
502 23 91-01	SCREW		1
510 05 86-01	DISC		1
510 06 62-01	COLLAR		1
510 14 41-01	MOTOR BOWL		1
510 14 42-01	DISC		1
510 14 43-01	SKID PLATE		1
521 93 20-01	BEARING		1
521 93 21-01	BEARING COVER		1
521 93 29-01	HUB		1
522 51 06-01	CUTTING ENGINE		1
522 77 14-01	SPACER		1
525 25 14-01	TIE WRAP		1
535 07 57-02	BALL BEARING		2
535 07 60-01	SCREW		1
535 12 23-01	RUBBER GAITERS		1
535 13 03-10	SCREW ITXPANT		4
535 13 03-14	SCREW ITXPANT		6
535 13 05-01	SCREW		3
574 28 96-01	KIT		1
728 82 85-01	SCREW IHSETM		1
734 11 37-41	WASHER		1

F compl 574 30 14-01 (EU)
compl 574 30 14-02 (UK/IRL)
compl 574 30 14-03 (CH)

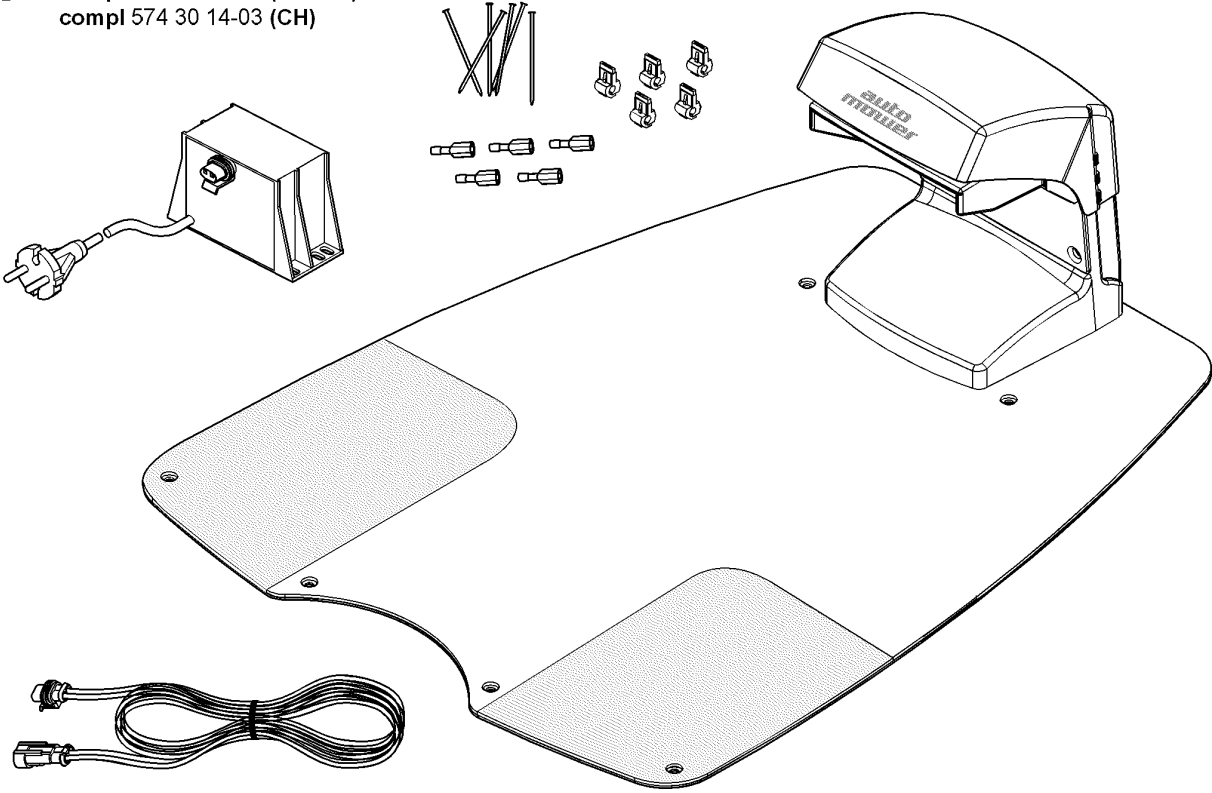

CHARGING STATION

260 ACX, 2009-05

Part No	Description	Remark	QTY KIT
574 30 14-01	CHARGING STATION		1
574 30 14-02	CHARGING STATION		1
574 30 14-03	CHARGING STATION		1

E compl 504 05 37-02

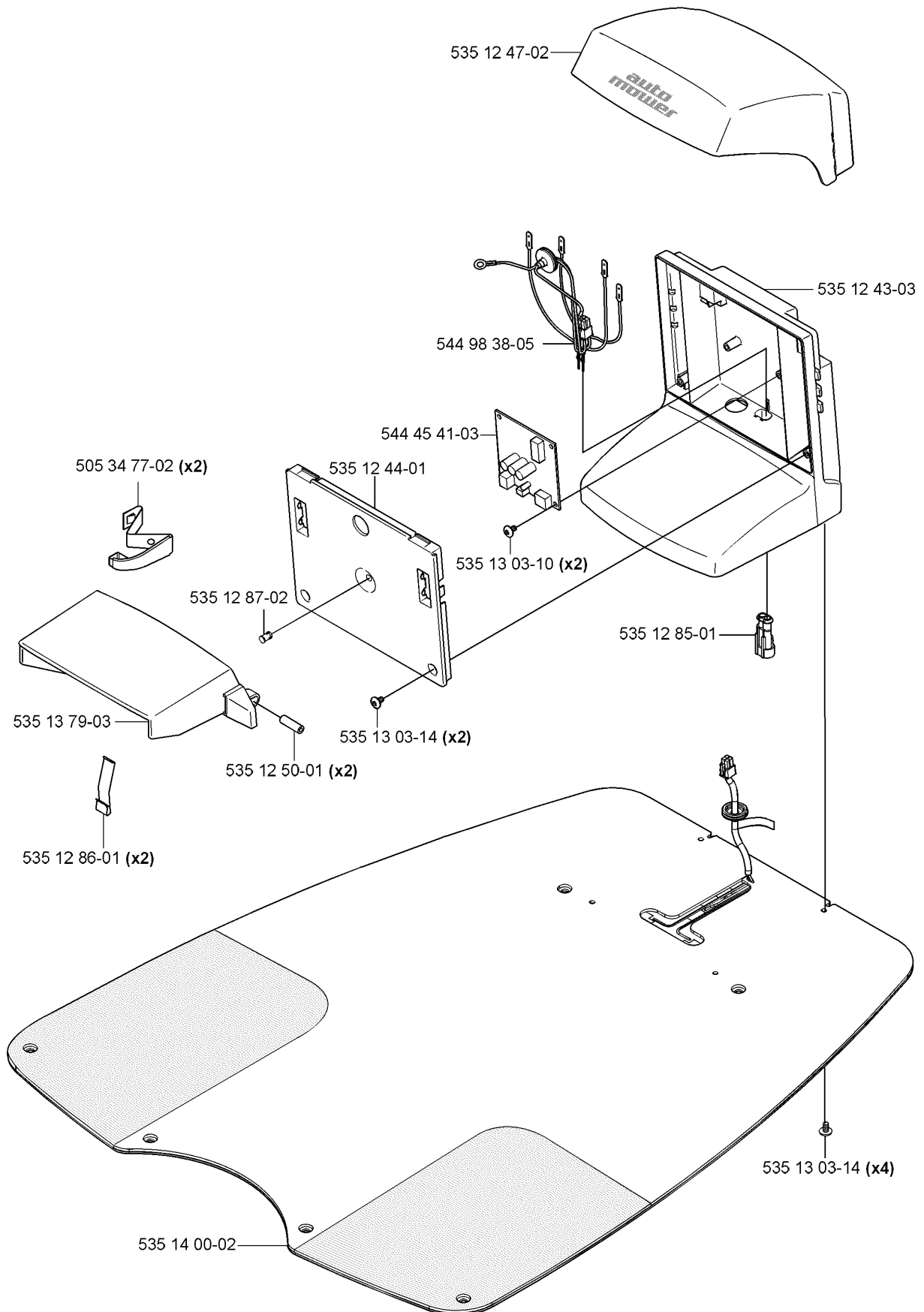

CHARGING STATION

260 ACX, 2009-05

Part No	Description	Remark	QTY KIT
504 05 37-02	CHARGING STATION		1
505 34 77-02	CHARGING PLATE		2
535 12 43-03	BODY		1
535 12 44-01	HUB CAP		1
535 12 47-02	COVER		1
535 12 50-01	PEN		2
535 12 85-01	CONTACT HOUSING		1
535 12 86-01	SPRING PLATE		2
535 12 87-02	DIODE LENS		1
535 13 03-10	SCREW ITPANT		2
535 13 03-14	SCREW ITPANT		2
535 13 03-14	SCREW ITPANT		4
535 13 79-03	RETAINER		1
535 14 00-02	FRAME PLATE		1
544 45 41-03	CIRCUIT BOARD ASSY		1
544 98 38-05	WIRING ASSY		1

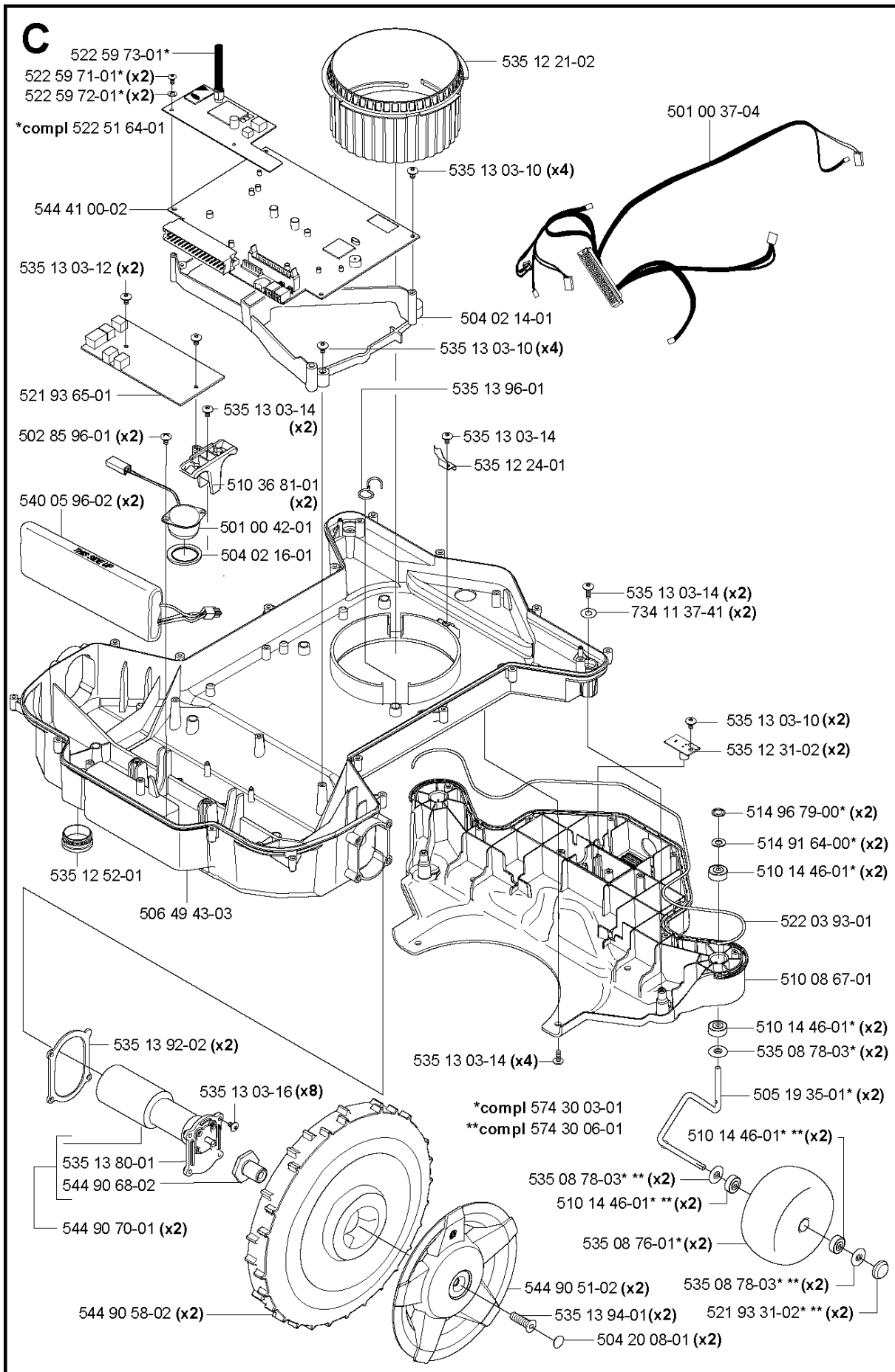

CHASSIS LOWER

260 ACX, 2009-05

Part No	Description	Remark	QTY KIT
501 00 37-04	MAIN WIRING		1
501 00 42-01	LOUD SPEAKER		1
502 85 96-01	SCREW		2
504 02 14-01	SPACER		1
504 02 16-01	SEALING		1
504 20 08-01	COVER WASHER		2
505 19 35-01	SPINDLE		2
506 49 43-03	CHASSIS		1
510 08 67-01	BRACKET		1
510 14 46-01	BALL BEARING		1
510 36 81-01	BRACKET		1
514 91 64-00	WASHER		2
514 96 79-00	STARLOCK WASHER		2
521 93 31-02	COVER WASHER		1
521 93 65-01	PRINTED CIRCUIT ASSY		1
522 03 93-01	SEALING RING		1
522 51 64-01	GSM MODULE		1
522 59 71-01	SCREW		1
522 59 72-01	WASHER		1
522 59 73-01	ANTENNA		1
535 08 76-01	WHEEL		2
535 08 78-03	WASHER		1
535 12 21-02	NUT		1
535 12 24-01	LOCKING SPRING		1
535 12 31-02	SENSOR CARD		2
535 12 52-01	PLUG		1
535 13 03-10	SCREW ITPANT		4
535 13 03-10	SCREW ITPANT		4
535 13 03-10	SCREW ITPANT		2
535 13 03-12	SCREW ITPANT		2
535 13 03-14	SCREW ITPANT		2
535 13 03-14	SCREW ITPANT		1
535 13 03-14	SCREW ITPANT		2
535 13 03-14	SCREW ITPANT		4
535 13 03-16	SCREW ITPANT		8
535 13 80-01	GABLE		1
535 13 92-02	GASKET		1
535 13 94-01	SCREW IHCSFM		2
535 13 96-01	CABLE HOLDER		1
540 05 96-02	BATTERY		2
544 41 00-02	PRINTED CIRCUIT ASSY		1
544 90 51-02	HUB CAP		2
544 90 58-02	REAR WHEEL		2
544 90 68-02	HUB		1
544 90 70-01	DRIVE MOTOR		2
574 30 03-01	KIT		1
574 30 06-01	KIT		1
734 11 37-41	WASHER		2

B

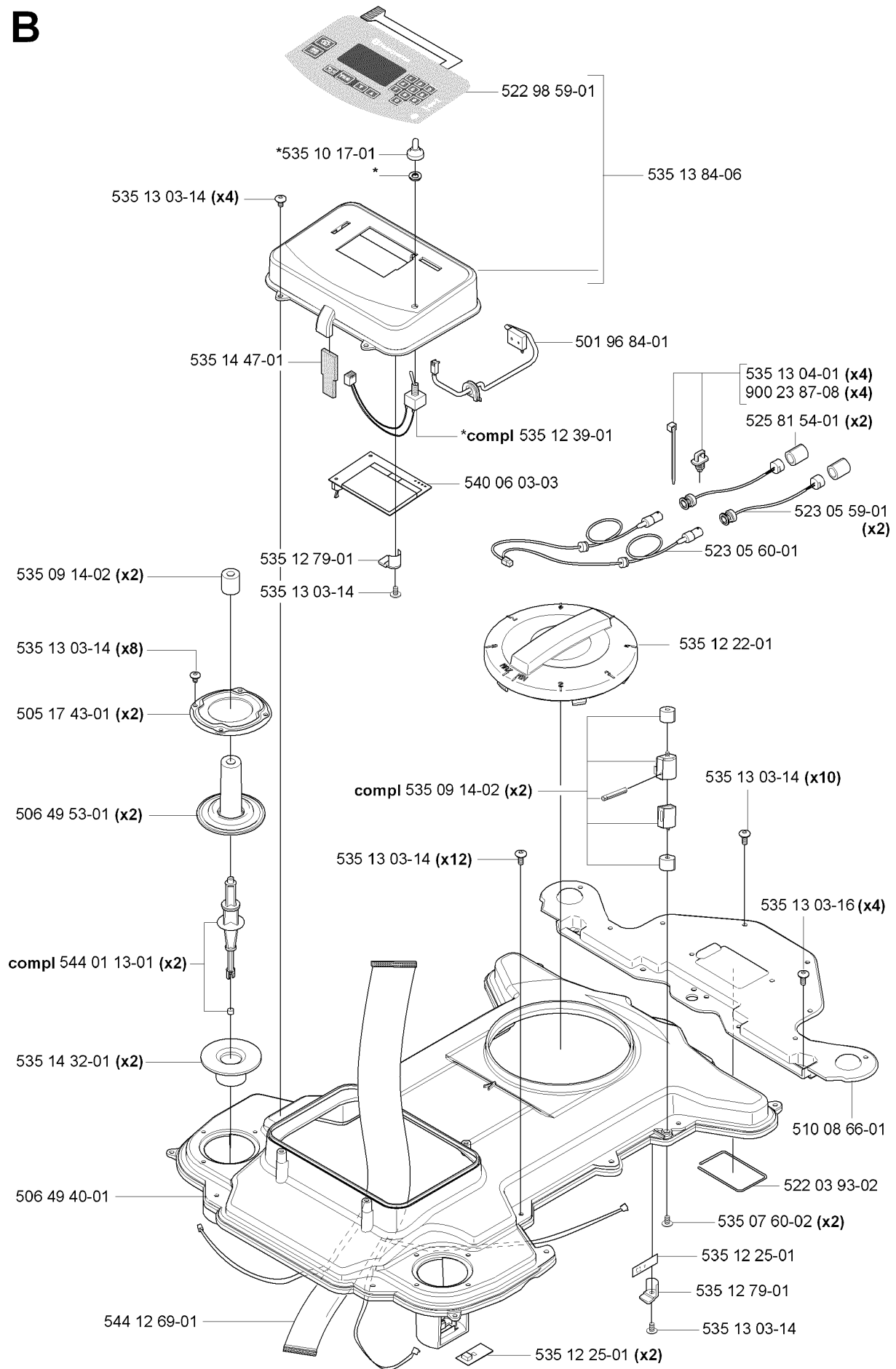

CHASSIS UPPER

260 ACX, 2009-05

Part No	Description	Remark	QTY KIT
501 96 84-01	SWITCH		1
505 17 43-01	RING FASTENER		2
506 49 40-01	CHASSIS		1
506 49 53-01	RUBBER GAITERS		2
510 08 66-01	BRACKET		1
522 03 93-02	SEALING RING		1
522 98 59-01	KEYBOARD		1
523 05 59-01	WIRING ASSY		1
523 05 60-01	WIRING ASSY		1
525 81 54-01	TUBE		1
535 07 60-02	SCREW		2
535 09 14-02	DAMPER		1
535 10 17-01	HUB CAP		1
535 12 22-01	STEERING WHEEL		1
535 12 25-01	SENSOR CARD		1
535 12 25-01	SENSOR CARD		2
535 12 39-01	MAIN SWITCH		1
535 12 79-01	BRACKET		1
535 12 79-01	BRACKET		1
535 13 03-14	SCREW ITXPANT		4
535 13 03-14	SCREW ITXPANT		1
535 13 03-14	SCREW ITXPANT		8
535 13 03-14	SCREW ITXPANT		12
535 13 03-14	SCREW ITXPANT		10
535 13 03-14	SCREW ITXPANT		1
535 13 03-16	SCREW ITXPANT		4
535 13 04-01	ANCHOR		4
535 13 84-06	KIT		1
535 14 32-01	DEFLECTION LIMITER		2
535 14 47-01	FILTER		1
540 06 03-03	DISPLAY		1
544 01 13-01	COLUMN		2
544 12 69-01	WIRING		1
900 23 87-08	TIE WRAP		4

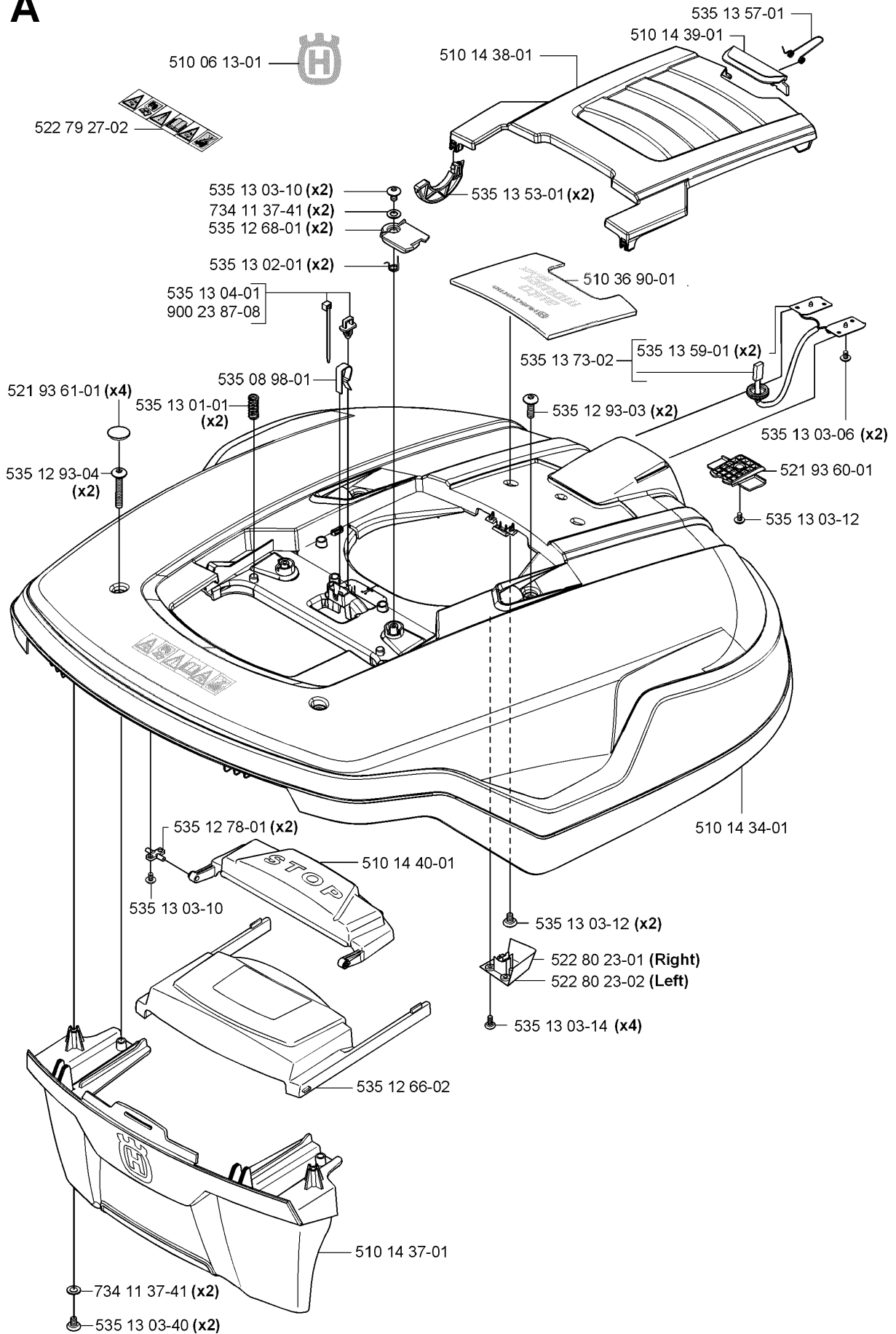
A

COVER

260 ACX, 2009-05

Part No	Description	Remark	QTY KIT
510 06 13-01	LOGOTYPE		1
510 14 34-01	MAIN BODY		1
510 14 37-01	MAIN BODY		1
510 14 38-01	LID		1
510 14 39-01	LATCH		1
510 14 40-01	BUTTON		1
510 36 90-01	PLATE		1
521 93 60-01	SPACER		1
521 93 61-01	COVER WASHER		1
522 79 27-02	LABEL		1
522 80 23-01	BRACKET		1
522 80 23-02	BRACKET		1
535 08 98-01	CLIP		1
535 12 66-02	COVER		1
535 12 68-01	CLAMP		2
535 12 78-01	SHAFT		2
535 12 93-03	SCREW IH PANM		1
535 12 93-04	SCREW IH PANM		1
535 13 01-01	SPRING		2
535 13 02-01	TORSION SPRING		2
535 13 03-06	SCREW ITPANT		2
535 13 03-10	SCREW ITPANT		2
535 13 03-10	SCREW ITPANT		1
535 13 03-12	SCREW ITPANT		1
535 13 03-12	SCREW ITPANT		2
535 13 03-14	SCREW ITPANT		4
535 13 03-40	SCREW ITPANT		2
535 13 04-01	ANCHOR		1
535 13 53-01	PIVOT		2
535 13 57-01	TORSION SPRING		1
535 13 59-01	CHARGING PLATE		2
535 13 73-02	WIRING		1
734 11 37-41	WASHER		2
734 11 37-41	WASHER		2
900 23 87-08	TIE WRAP		1

G

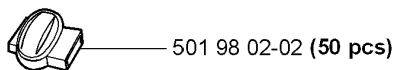
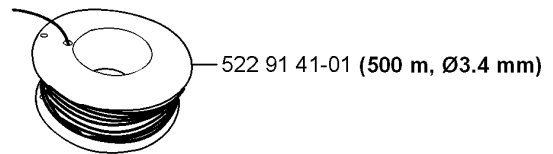
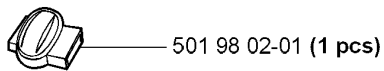
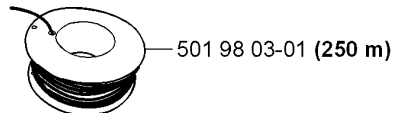
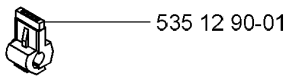
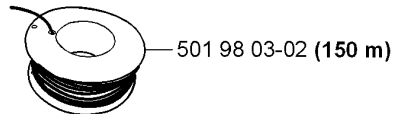
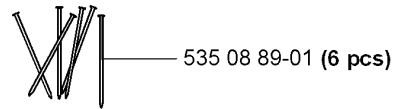
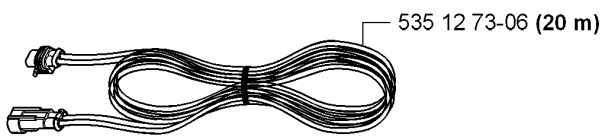
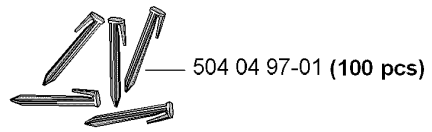
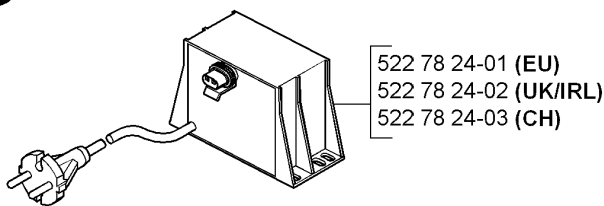

525 63 70-01

INSTALLATION ACCESSORIES

260 ACX, 2009-05

Part No	Description	Remark	QTY KIT
501 98 02-01	COUPLER		1
501 98 02-02	COUPLER		1
501 98 03-01	WIRE		1
501 98 03-02	WIRE		1
504 04 97-01	STAPLE		1
522 78 24-01	TRANSFORMER		1
522 78 24-02	TRANSFORMER		1
522 78 24-03	TRANSFORMER		1
522 91 41-01	WIRE		1
525 63 70-01	MEASURING ROD		1
529 28 08-01	CONNECTOR		1
535 08 89-01	STAPLE		1
535 12 73-06	CABLE		1
535 12 90-01	COUPLER		1
535 13 16-01	LABEL		1