



# SPARE PARTS LIST

ACCESSORIES AND TOOLS

KPL-23CLP, 2014-02

KPL-23CLP  
 Ser. No. 0000001 - Current  
 Rev. 4-15-13

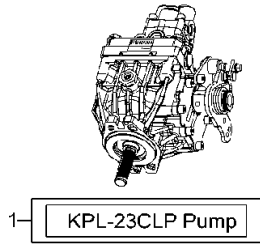

1- KPL-23CLP Pump

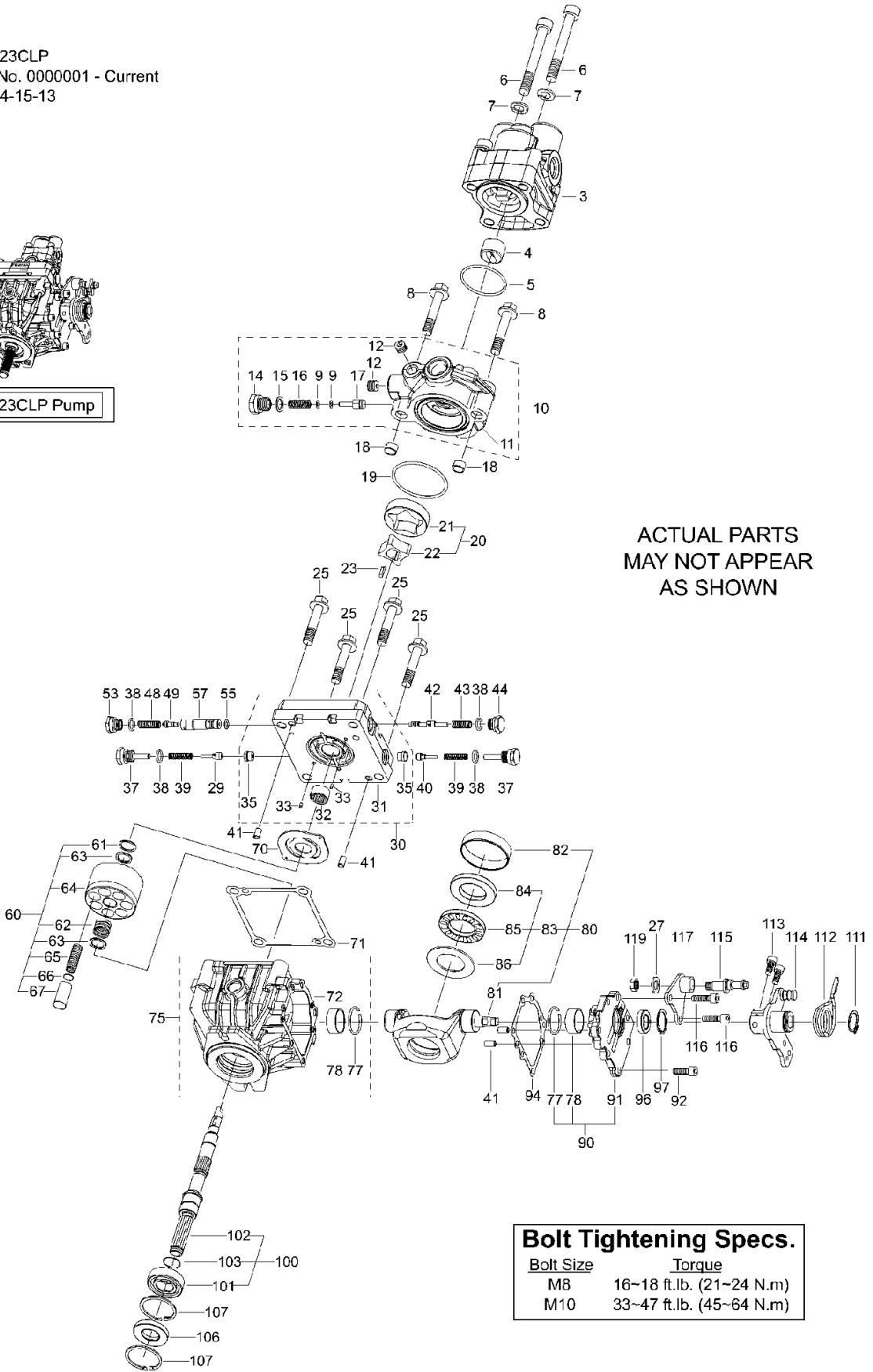

ACTUAL PARTS  
 MAY NOT APPEAR  
 AS SHOWN

Bolt Tightening Specs.	
Bolt Size	Torque
M8	16-18 ft.lb. (21-24 N.m)
M10	33-47 ft.lb. (45-64 N.m)

## TRANSMISSION

KPL-23CLP, 2014-02

Ref	Part No	Description	Remark	QTY KIT
1	575 88 69-01	HYDRAULIC PUMP		1
3	585 46 15-01	PUMP		1
4	585 45 88-01	COUPLING		1
5	585 46 95-01	O-RING		1
6	585 47 00-01	BOLT		2
7	585 46 87-01	LOCK WASHER		2
8	585 46 97-01	BOLT		2
9	586 87 62-01	SHIM		2
10	586 88 73-01	PUMP BODY		1
11	586 88 74-01	PUMP BODY		1
12	535 41 47-55	PLUG		2
14	586 87 63-01	PLUG		1
15	585 46 79-01	O-RING		1
16	586 87 64-01	SPRING		1
17	586 87 65-01	VALVE		1
18	585 46 78-01	PIN		2
19	585 46 96-01	O-RING		1
20	585 45 83-01	ROTOR		1
23	585 45 82-01	KEY		1
25	585 46 98-01	BOLT		4
27	585 46 86-01	LOCK WASHER		1
29	502 45 50-01	CHECK VALVE		1
30	586 88 75-01	CASE		1
32	585 46 82-01	NEEDLE		1
33	585 46 75-01	PIN		2
37	585 46 13-01	PLUG		2
38	585 46 94-01	O-RING		4
39	585 46 11-01	SPRING		2
40	585 46 17-01	VALVE		1
41	585 46 89-01	PIN		2
42	586 87 68-01	VALVE		1
43	586 87 67-01	SPRING		1
44	586 88 76-01	PLUG		1
48	585 45 86-01	SPRING		1
49	586 87 86-01	VALVE		1
53	586 87 87-01	PLUG		1
55	586 87 88-01	PACKING		1
57	585 45 87-01	SLEEVE		1
60	586 88 77-01	BLOCK		1
61	585 45 66-01	RING		1
62	585 45 55-01	SPRING		1
63	585 45 56-01	WASHER		2
64	586 88 78-01	BLOCK		7
65	586 88 79-01	PISTON RING		7
66	585 46 81-01	SPRING		7
67	585 46 74-01	PISTON		7
70	586 88 80-01	VALVE		1
71	585 46 16-01	PACKING		1
75	586 88 86-01	HOUSING		1
80	586 88 88-01	PLATE		1
81	585 52 87-01	PLATE		1
85	585 46 83-01	BEARING		1
90	586 88 89-01	GUIDE		1
92	586 88 90-01	BOLT		4
94	586 88 91-01	PACKING		1
96	586 88 92-01	SEAL		1
97	586 88 93-01	SNAP RING		1
100	586 88 94-01	SHAFT		1
101	585 52 96-01	BEARING		1
102	586 88 96-01	SHAFT		1
103	585 46 14-01	RING		1
106	585 46 18-01	SEAL		1
107	585 52 95-01	SNAP RING		2
111	585 45 62-01	RING		1

## TRANSMISSION

KPL-23CLP, 2014-02

Ref	Part No	Description	Remark	QTY KIT
112	586 88 97-01	SPRING		1
113	585 53 65-01	BOLT		2
114	586 88 99-01	LEVER		1
115	585 46 19-01	SEAL		1
116	586 89 00-01	BOLT		2
117	586 89 01-01	PLATE		1
119	585 53 68-01	NUT		1