

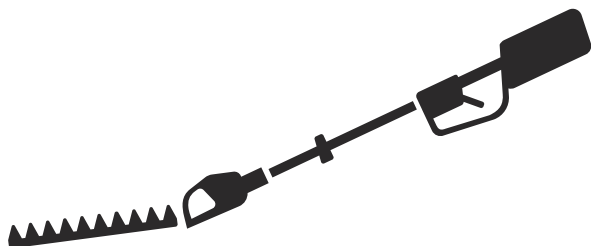

Husqvarna®



525HF3S

EN Operator's manual
ZH 操作手册

2-16
17-30

Contents

Introduction.....	2	Maintenance.....	10
Safety.....	3	Troubleshooting.....	14
Assembly.....	7	Transportation, storage and disposal.....	15
Operation.....	8	Technical data.....	16

Introduction

Product description

The product is a pole hedge trimmer with a combustion engine.

Intended use

Use the product to cut branches and twigs. Do not use the product for other tasks.

Product overview

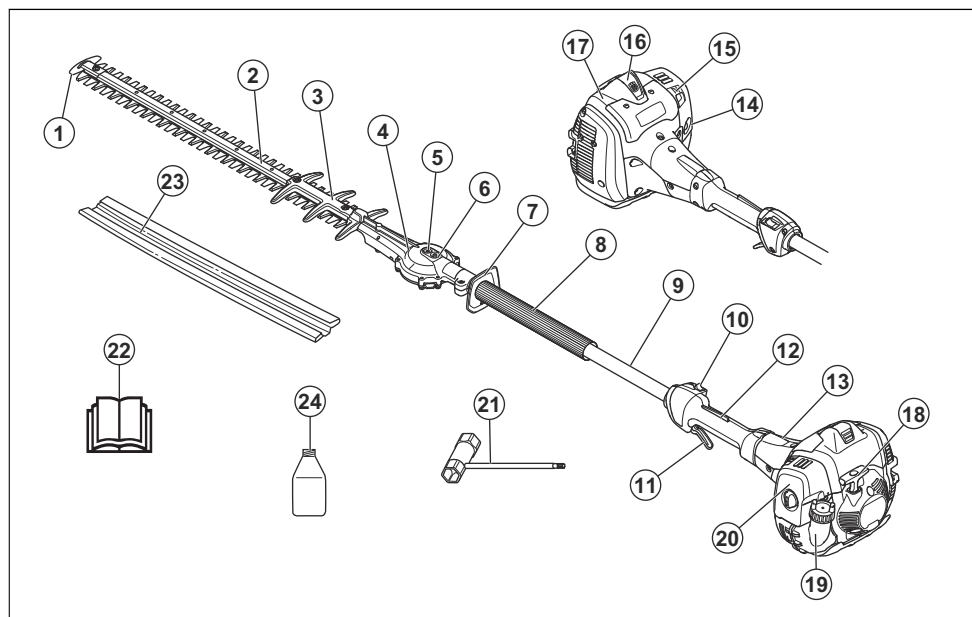

- | | |
|--|---|
| 1. Blade tip protection | 13. Clutch cover |
| 2. Cutting unit | 14. Air purge bulb |
| 3. Blade guard | 15. Choke control |
| 4. Gear | 16. Spark plug cap and spark plug |
| 5. Socket for manual release of the blades | 17. Cylinder cover |
| 6. Grease nipple | 18. Starter rope handle |
| 7. Hand guard | 19. Fuel tank |
| 8. Front handle | 20. Air filter cover |
| 9. Shaft | 21. Combination wrench |
| 10. Stop switch | 22. Operator's manual |
| 11. Throttle trigger | 23. Transport guard |
| 12. Throttle trigger lockout | 24. 2-stroke oil. Not included for all markets. |

Symbols on the product



WARNING: This product can be dangerous and cause serious injury or death to the operator or others. Be careful and use the product correctly.



Read the operator's manual carefully and make sure that you understand the instructions before you use this product.



Use a protective helmet in locations where objects can fall on you. Use approved

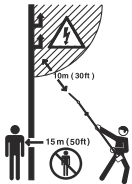

There is no electrical insulation in this product. If the product touches or comes near high voltage power lines, it can cause serious injury or death to the operator. Electricity can move between different objects by a curve. The higher the voltage, the longer the electricity can move. Electricity can also move through branches and other objects, especially if the object is wet. Always keep a distance at a minimum of 10 m/33 ft between the product and high voltage power lines and/or objects that touches the power lines. If it is necessary to do work near the power lines, make sure that the power is off before you start the work. Keep a distance at a minimum of 15 m/50 ft to other persons or animals during the operation.

yyyywwxxxx

The rating plate shows serial number. **yyyy** is the production year and **ww** is the production week.



hearing protection. Use approved eye protection.

Use approved protective gloves.



Use stable boots with non-slip soles.



Stop the product fully before you touch the cutting tool.

Note: Other symbols/decals on the product refer to special certification requirements for some markets.

Safety

Safety definitions

Warnings, cautions and notes are used to point out specially important parts of the manual.



WARNING: Used if there is a risk of injury or death for the operator or bystanders if the instructions in the manual are not obeyed.



CAUTION: Used if there is a risk of damage to the product, other materials or the adjacent area if the instructions in the manual are not obeyed.

Note: Used to give more information that is necessary in a given situation.

General safety instructions



WARNING: Read the warning instructions that follow before you use the product.

- Incorrect or careless use of the product can turn it into a dangerous tool that can cause serious or even fatal injury. It is extremely important that you read and understand the contents of this operator's manual.
- This product produces an electromagnetic field during operation. This field may under some circumstances interfere with active or passive medical implants. To reduce the risk of serious or fatal injury, we recommend persons with medical implants to consult their physician and the medical implant manufacturer before operating this product.
- Overexposure to vibration can lead to circulatory damage or nerve damage in people who have impaired circulation. Contact your doctor if you experience symptoms of overexposure to vibration. Such symptoms include numbness, loss of feeling, tingling, pricking, pain, loss of strength, changes in skin color or condition. These symptoms normally appear in the fingers, hands or wrists. The risk increases at low temperatures.
- If you encounter a situation where you are uncertain how to proceed you should ask an expert. Contact your dealer or your service workshop. Avoid all

usage which you consider to be beyond your capability.

- Keep in mind that the operator is responsible for accidents or hazards occurring to other people or their property.
- Never allow anyone else to use the product without first ensuring that they have understood the contents of the operator's manual.
- Never allow children to use or be in the vicinity of the product. As the product is equipped with a spring-loaded stop switch and can be started by low speed and force on the starter handle, even small children under some circumstances can produce the force necessary to start the product. This can mean a risk of serious personal injury. Therefore remove the spark plug cap when the product is not under close supervision.
- Store the product out of reach of children.
- Never use the product if you are tired, if you have drunk alcohol, or if you are taking medication that could affect your vision, your judgement or your coordination.
- Never use a product that is faulty. Carry out the checks, maintenance and service instructions described in this manual. Some maintenance and service measures must be carried out by trained and qualified specialists. Refer to instructions under the heading Maintenance.
- Never use a product that has been modified in any way from its original specification.

- When the engine is switched off, keep your hands and feet away from the cutting unit until it has stopped completely.
- Watch out for stumps of branches that can be thrown out during cutting.
- Listen out for warning signals or shouts when you are wearing hearing protection. Always remove your hearing protection as soon as the engine stops.
- Never work from a ladder, stool or any other raised position that is not fully secured.
- Always use both hands to hold the product. Hold the product in front of your body.
- If any foreign object is hit or if vibrations occur stop the product immediately. Disconnect the HT lead from the spark plug. Check that the product is not damaged. Repair any damage.
- Ensure that the spark plug cap and ignition lead are undamaged to avoid the risk of electric shock.
- Check that all nuts and screws are tight.
- Make sure the gear housing is lubricated correctly. Refer to *To lubricate the gear housing on page 14*.
- The gear housing gets hot when the product has been in use. To avoid burning yourself do not touch the gear housing.
- All covers and guards must be fitted before starting.
- The transport guard should always be fitted to the cutting unit when the product is not in use.

Safety instructions for operation



WARNING: Read the warning instructions that follow before you use the product.



WARNING: Read the warning instructions that follow before you use the product.

- Never use the product in extreme weather conditions such as severe cold, very hot and/or humid climates.
- Faulty blades can increase the risk of accidents.
- Ensure that no-one comes closer than 15 m / 50 ft while you are working.
- Observe your surroundings and make sure that there is no risk of people or animals coming into contact with the cutting equipment.
- Inspect the working area. Remove any objects that could be thrown out.
- Always ensure you have a safe and stable working position.
- Never leave the product unsupervised with the motor running.
- Make sure that your hands and feet do not come near the cutting unit when the engine is running.
- If anything jams in the blades while you are working, switch off the engine and wait until it has stopped completely before cleaning the blades. Disconnect the HT lead from the spark plug. Refer to *Product overview on page 2*.

- Always use approved personal protective equipment when you use the product. Personal protective equipment cannot fully prevent injury but it decreases the degree of injury if an accident does occur. Let your dealer help you select the right equipment.
- Use approved hearing protection that provides adequate noise reduction. Long-term exposure to noise can result in permanent hearing impairment.
- Use approved eye protection. If you use a visor, you must also use approved protective goggles. Approved protective goggles must comply with the ANSI Z87.1 standard in the USAs or EN 166 in EU countries.

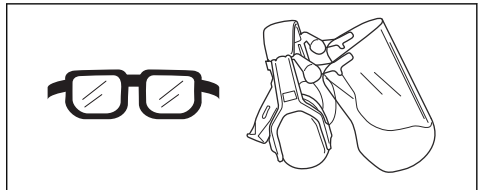

- Use gloves when necessary, for example when you attach, examine or clean the cutting equipment.

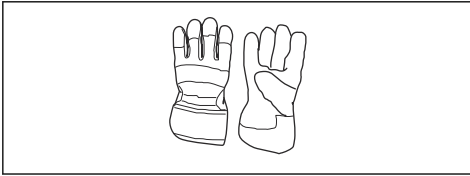

- Use sturdy non-slip boots or shoes.



- Use clothing made of a strong fabric. Always use heavy, long pants and long sleeves. Do not use loose clothing that can catch on twigs and branches. Do not wear jewelry, short pants, sandals or go with bare feet. Put your hair up safely above shoulder level.
- Keep first aid equipment close at hand.

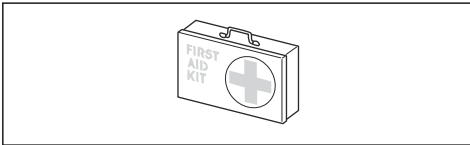

Safety devices on the product



WARNING: Read the warning instructions that follow before you use the product.

- Do not use a product with defective safety devices.
- Do a check of the safety devices regularly. If the safety devices are defective, speak to your Husqvarna service agent.

To do a check of the throttle trigger lockout

1. Make sure that the throttle trigger lockout (A) and throttle trigger (B) move freely and that the return spring operates correctly.

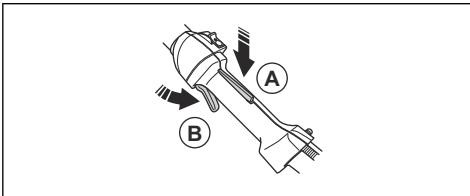

2. Make sure that the throttle trigger is locked at the idle position when the throttle trigger lockout is released.

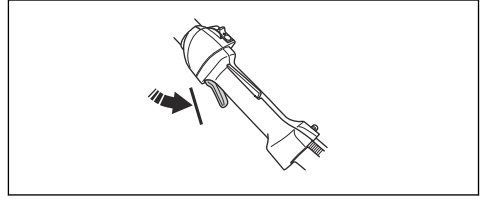

3. Push down the throttle trigger lockout and make sure that it goes back to its initial position when you release it.

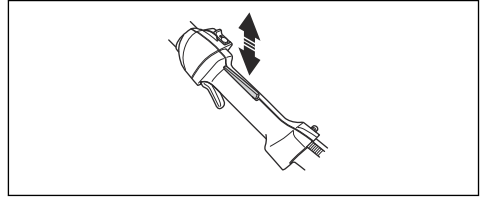

4. Start the product. Refer to *To start the engine on page 9*. Apply full throttle.

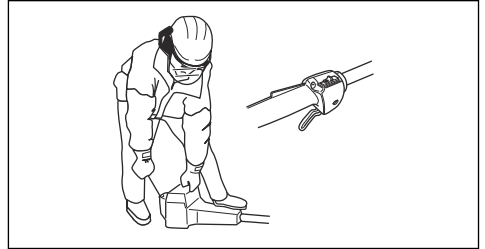

5. Release the throttle trigger and make sure that the blades stop and stay stationary.



WARNING: If the blades move when the throttle trigger is in the idle position, then the carburetor idle speed must be adjusted. Refer to *To adjust the idle speed on page 11*.

To do a check of the stop switch

1. Start the engine.
2. Move the stop switch to the stop position and make sure that the engine stops.

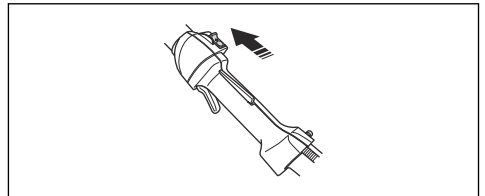

To do a check of the hand guard

The hand guard prevents injuries from the blades.

1. Stop the engine.
2. Make sure that the hand guard is attached correctly.

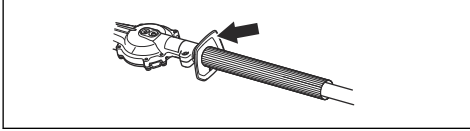

3. Examine the hand guard for damages.

To do a check of the vibration damping system



WARNING: Use of incorrectly wound cord or an incorrect cutting attachment increases the level of vibration.

The vibration damping system decreases vibration in the handles to a minimum which makes the operation easier. The vibration damping system decreases the vibrations between the engine unit and the shaft unit.

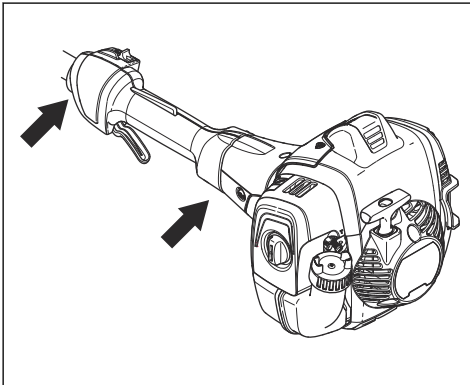

1. Stop the engine.
2. Do a visual check for deformation and damage, for example cracks.
3. Make sure that the vibration damping units are attached correctly.

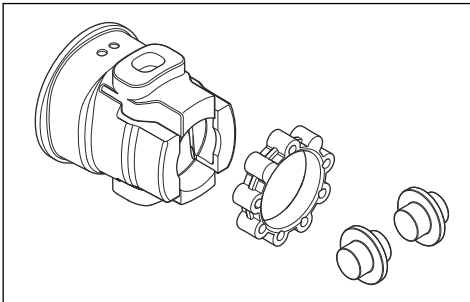

To do a check of the muffler

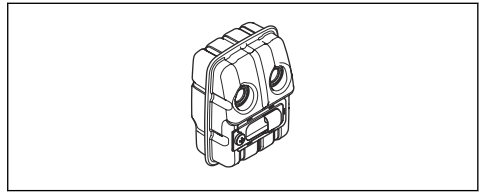

The muffler keeps noise levels to a minimum and sends exhaust fumes away from the operator.

- Do a visual check for damage and deformation.
- Make sure that the muffler is correctly attached to the product.

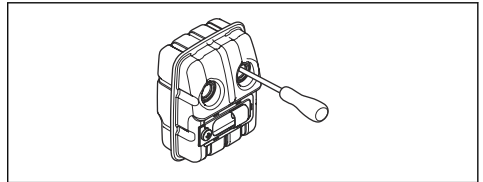

- If the muffler on your product has a spark arrester screen, do a visual check. Replace the spark arrester screen if it is damaged.
 - a) Clean the spark arrester screen if it is blocked. A blocked spark arrester screen causes the engine to become too hot which causes damage to the engine.
 - b) Make sure that the spark arrester mesh is attached correctly.

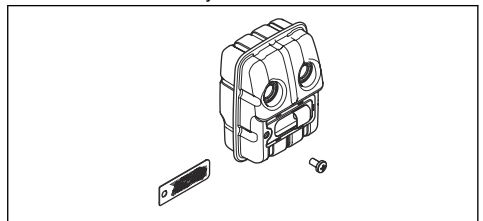

To do a check of the blades and blade guard

The outer part of the blades has the function of a blade guard. The blade guard prevents cut injuries.

1. Stop the engine and make sure that the blades stop.
2. Remove the spark plug cap from the spark plug.
3. Put on protective gloves.
4. Make sure that the blade and blade guard is not damaged or bent. Always replace a damaged or bent blade, or a damaged blade guard.
5. Make sure that the screws to the blades and blade guard are tight.

Fuel safety



WARNING: Read the warning instructions that follow before you use the product.

- Do not mix the fuel indoor or near a heat source.
- Do not start the product if there is fuel or engine oil on the product. Remove the unwanted fuel/oil and let the product dry. Remove unwanted fuel from the product.
- If you spill fuel on your clothing, change clothing immediately.
- Do not get fuel on your body, it can cause injury. If you get fuel on your body, use a soap and water to remove the fuel.
- Do not start the engine if you spill oil or fuel on the product or on your body.
- Do not start the product if the engine has a leak. Examine the engine for leaks regularly.
- Be careful with fuel. Fuel is flammable and the fumes are explosive and can cause injuries or death.
- Do not breathe in the fuel fumes, it can cause injury. Make sure that there is a sufficient airflow.
- Do not smoke near the fuel or the engine.
- Do not put warm objects near the fuel or the engine.
- Do not add the fuel when the engine is on.
- Make sure that the engine is cool before you refuel.
- Before you refuel, open the fuel tank cap slowly and release the pressure carefully.
- Do not add fuel to the engine in an indoor area. Not sufficient airflow can cause injury or death because of asphyxiation or carbon monoxide.
- Tighten the fuel tank cap carefully or a fire can occur.
- Move the product at a minimum of 3 m (10 ft) from the position where you filled the tank before a start.
- Do not put too much fuel in the fuel tank.
- Make sure that a leak cannot occur when you move the product or fuel container.
- Do not put the product or a fuel container where there is an open flame, spark or pilot light. Make

sure that the storage area does not contain an open flame.

- Only use approved containers when you move the fuel or put the fuel into storage.
- Empty the fuel tank before long-term storage. Obey the local law on where to dispose fuel.
- Clean the product before long-term storage.
- Remove the spark plug cap before you put the product into storage to make sure that the engine does not start accidentally.

Safety instructions for maintenance



WARNING: Read the warning instructions that follow before you use the product.

- Stop the engine and make sure that the cutting equipment stops. Let the product become cool before you do the maintenance.
- Disconnect the spark plug cap before you do the maintenance.
- The exhaust fumes from the engine contain carbon monoxide, an odourless, poisonous and very dangerous gas that can cause death. Do not run the product indoors or in closed spaces.
- The exhaust fumes from the engine are hot and can contain sparks. Do not run the product indoors or near flammable material.
- Accessories and changes to the product that are not approved by the manufacturer, can cause serious injury or death. Do not change the product. Always use original accessories.
- If the maintenance is not done correctly and regularly, there is an increased risk of injury and damage to the product.
- Only do the maintenance as this operator's manual recommends. Let an approved Husqvarna service agent do all other servicing.
- Let an approved Husqvarna service agent do servicing on the product regularly.
- Replace damaged, worn or broken parts.

Assembly

Introduction



WARNING: Read and understand the safety chapter before you assemble the product.

To install the cutting unit

1. Loosen the screw on the cutting unit (A).

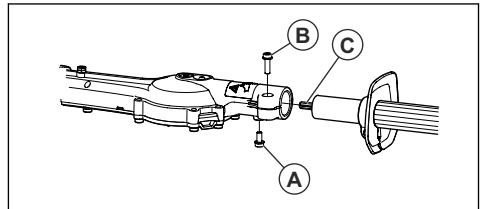

- Put the shaft in the cutting unit. Align the screw (A) with the hole in the shaft.



CAUTION: Make sure that the drive shaft (C) engages with the gear in the cutting unit.

- Tighten the screw (A) with your fingers. Make sure that screw (A) goes into the hole in the shaft.
- Tighten the screw (A) fully.
- Tighten the screw (B) fully.

Operation

Introduction



WARNING: Read and understand the safety chapter before you use the product.

To do before you operate the product

- Examine the work area and remove loose objects.
- Do a check of the cutting unit. Refer to *To do a check of the blades and blade guard on page 6*.
- Make sure that the gear housing is correctly lubricated.
- Make sure that the safety devices of the product operates correctly. Do not use the product without all safety devices installed correctly.
- Make sure that all screws and nuts are tight.
- Make sure that all covers are attached correctly and not damaged before you start the product.
- Make sure that the cutting unit stops when the engine is at idle speed.

Fuel

This product has a two-stroke engine.



CAUTION: Incorrect type of fuel can result in engine damage. Use a mixture of gasoline and two-stroke oil.

Premixed fuel

- Use Husqvarna premixed alkylate fuel of a good quality, for best performance and extension of the engine life. This fuel contains less harmful chemicals compared to regular fuel, which decreases harmful exhaust fumes. The quantity of remains after combustion is lower with this fuel, which keeps the components of the engine more clean.

To mix fuel

Gasoline

- Use good quality unleaded gasoline with a maximum of 10% ethanol contents.



CAUTION: Do not use gasoline with an octane grade less than 90 RON/87 AKI. Use of a lower octane grade can cause

engine knocking, which causes engine damages.

- We recommend that you use gasoline of a higher octane grade for work with continuously high rpm.

Two-stroke oil

- For best results and performance use Husqvarna two-stroke oil.
- If Husqvarna two-stroke oil is not available, use a two-stroke oil of good quality for air-cooled engines. Speak to your servicing dealer to select the correct oil.



CAUTION: Do not use two-stroke oil for water-cooled outboard engines, also referred to as outboard oil. Do not use oil for four-stroke engines.

To mix gasoline and two-stroke oil

Gasoline, liter	Two-stroke oil, liter
	2% (50:1)
5	0.10
10	0.20
15	0.30
20	0.40



CAUTION: Small errors can influence the ratio of the mixture drastically when you mix small quantities of fuel. Measure the quantity of oil carefully and make sure that you get the correct mixture.

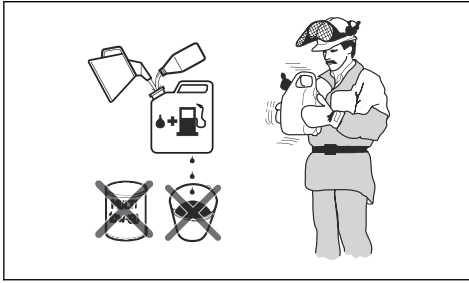

1. Fill half the quantity of gasoline in a clean container for fuel.
2. Add the full quantity of oil.
3. Shake the fuel mixture.
4. Add the remaining quantity of gasoline to the container.
5. Carefully shake the fuel mixture.



CAUTION: Do not mix fuel for more than 1 month at a time.

To fill the fuel tank

1. Clean the area around the fuel tank cap.

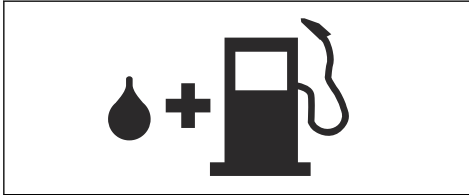

2. Shake the container and make sure that the fuel is fully mixed.
3. Remove the fuel tank cap and fill the fuel tank.
4. Tighten the fuel tank cap carefully.
5. Move the product 3 m/10 ft or more away from the refueling area and fuel source before you start the engine.

Note: To see where the fuel tank is on your product, refer to *Product overview on page 2*.

To start the engine



WARNING: Keep a minimum distance of 15 m/50 ft from persons or animals when you start the product. There is a risk that the cutting unit starts to move.

1. Set the choke control in the choke position.

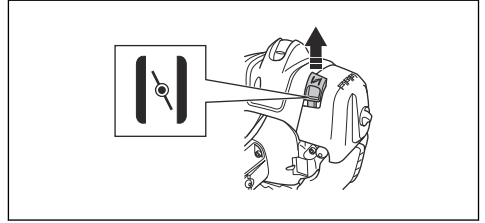

2. Push the air purge bulb until the bulb starts to fill with fuel.

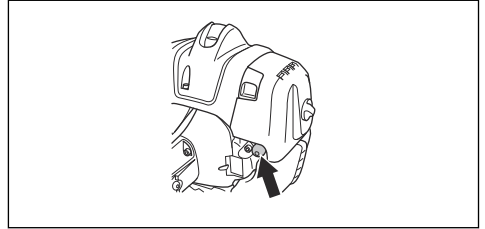

Note: It is not necessary to fill the air purge bulb fully.

3. Hold the body of the product on the ground with your left hand. Do not put your feet on the product.

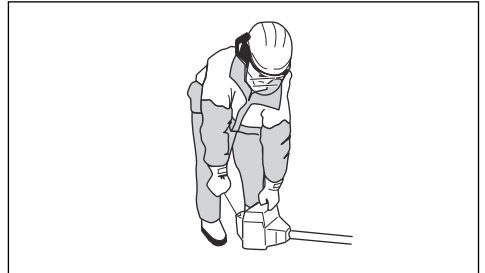

4. Pull the starter rope handle slowly until you feel some resistance, then pull the starter rope handle with force.



WARNING: Do not wind the starter rope around your hand.

5. Continue to pull the starter rope handle until the engine starts.



CAUTION: Do not pull the starter rope to full extension and do not let go of the starter rope handle. Release the starter rope slowly to prevent damage to the product.

6. When the engine starts, put the choke control in the run position and apply full throttle. The throttle trigger automatically disengages from the start position.
7. Make sure that the engine operates smoothly.



WARNING: Do not use the product with a damaged spark plug cap to prevent electrical shock.

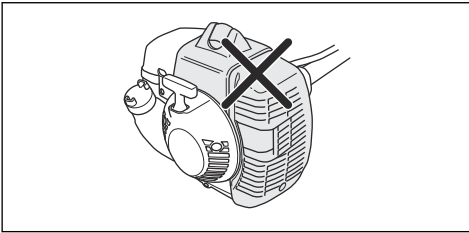

Note: To start the product when the engine is warm, it is not necessary to use the choke control.

To stop the product

- Move the stop switch to the stop position to stop the engine.



CAUTION: The stop switch automatically goes back to run position.

To operate the product

- Start near the ground and move the product up along the hedge when you cut the sides.

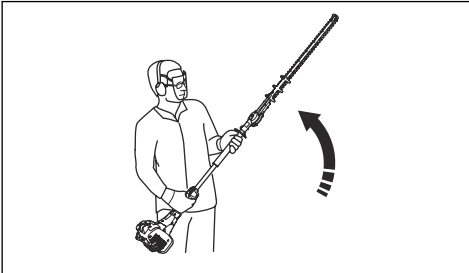

- Adjust the speed to align with the work load.
- Make sure that the engine does not touch the hedge.
- Hold the product near your body for a stable work position.

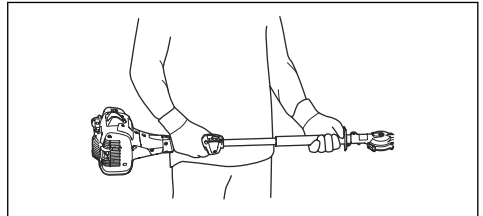

- Make sure that the tip of the cutting equipment does not touch the ground.
- Be careful and work slowly until all the branches are correctly cut.

Maintenance

Introduction



WARNING: Read and understand the safety chapter before you do maintenance on the product.

Maintenance schedule

Maintenance	Before operation	After 40 h	After 100 h
Clean the external surface.	After each operation.		

Maintenance	Before operation	After 40 h	After 100 h
Clean the muffler, exhaust pipe and engine from leaves, dirt and unwanted lubricant.	After each operation.		
Make sure that the cutting unit does not move at idle speed.	X		
Do a check of the stop switch. Refer to <i>To do a check of the stop switch on page 5</i> .	X		
Examine the cutting unit for damages and cracks. Replace if it is damaged.	X		
Examine the hand guard for damages and cracks. Replace if it is damaged.	X		
Do a check of the throttle trigger lockout and the throttle trigger. Refer to <i>To do a check of the throttle trigger lockout on page 5</i> .	X		
Examine the engine, the fuel tank and the fuel hose for leaks.	X		
Tighten nuts and screws.	X		
Examine the starter and the starter rope for damages.		X	
Do a check that the screws that hold the blades together are correctly tightened.		X	
Clean the air filter. Clean more frequently if used in areas which has dust. Replace if it is damaged.		X	
Examine the vibration damping units for damages and cracks. Replace if it is damaged.		X	
Clean the external surface of the spark plug and the area around it. Remove the spark plug and measure the electrode gap. Adjust the electrode gap or replace the spark plug. Refer to <i>To examine the spark plug on page 13</i> .		X	
Clean the cooling system.		X	
Clean the external surface of the carburetor and the area around it.		X	
Examine the fuel filter for contamination and the fuel hose for cracks and other defects. Replace if it is damaged.			X
Clean the spark arrester screen on the muffler, replace if it is damaged.			X
Clean the inner surface of the fuel tank.			X
Replace the spark plug.			X
Examine the clutch, clutch spring and the clutch drum for wear. Replace if it is damaged by an approved servicing dealer.			X
Make sure that the gear housing is filled with grease.			X
Do a check of all cables and connections.			X

To adjust the idle speed

1. Clean the air filter and attach the air filter cover.
2. Start the product. Refer to *To start the engine on page 9*.

- Turn the idle adjustment screw T clockwise until the cutting unit starts to move.

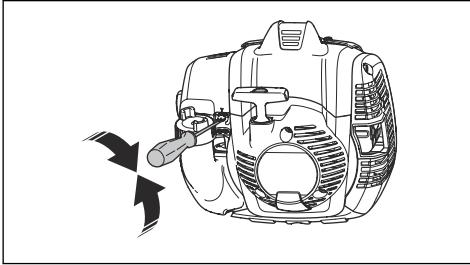

- Turn the idle adjustment screw counterclockwise until the cutting unit stops.



WARNING: If the cutting unit does not stop when you adjust the idle speed, speak to your nearest servicing dealer. Do not use the product until it is correctly adjusted or repaired

Note: The idle speed is correct when the engine operates smoothly in all positions. Refer to *Technical data on page 16* for the recommended idle speed.

To do maintenance on the muffler

The muffler decreases the noise level and directs the exhaust gases away from the operator.



WARNING: Mufflers that have catalytic converters get very hot during operation and will stay hot for some time after you stop the product. This also applies at idle speed. If you touch the product it can result in burns to the skin. Think about of the risk of fire.

- Stop the product and let it cool down.
- Remove the cover to the muffler.

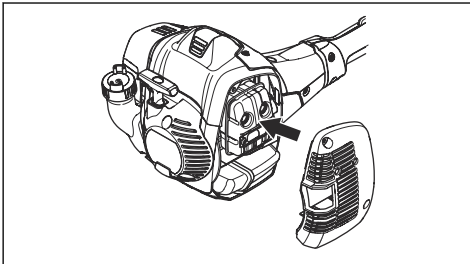

- Remove the screw holding the spark arrestor mesh.

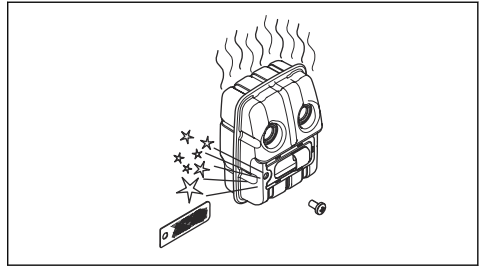

- Clean the spark arrestor mesh if it is blocked or replace it if it is damaged.



CAUTION: The spark arrestor mesh must be replaced if it is damaged. Do not use a product if the spark arrestor mesh on the muffler is missing or defective.



CAUTION: If the spark arrestor mesh is frequently blocked it can be a sign that performance of the catalytic converter is decreased. Turn to your servicing dealer to examine the muffler. A blocked spark arrestor mesh will cause overheating and result in damage to the cylinder and piston.

Cooling system

The product has a cooling system to keep the operation temperature as low as possible.

Clean the components of the cooling system with a brush weekly or more frequently in rougher conditions. A dirty or blocked cooling system makes the product too hot which causes damage to the piston and cylinder.

The cooling system has the following components:

- Air intake on the starter.
- Fins on the flywheel.
- Cooling fins on the cylinder.
- Cylinder cover.
- Muffler cover.
- Muffler plate.

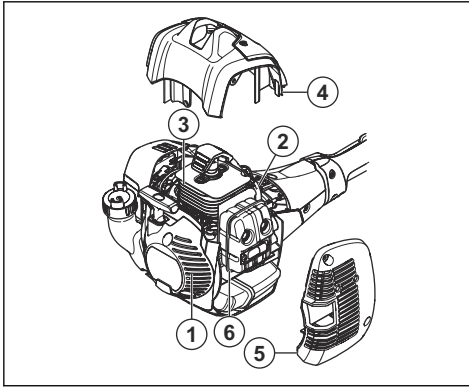

To examine the spark plug



CAUTION: Always use the recommended spark plug type. Incorrect spark plug type can cause damage to the product.

- Examine the spark plug if the engine is low on power, is not easy to start or does not operate correctly at idle speed.
- To decrease the risk of unwanted material on the spark plug electrodes, obey these instructions:
 - a) Make sure that the idle speed is correctly adjusted.
 - b) Make sure that the fuel mixture is correct.
 - c) Make sure that the air filter is clean.
- If the spark plug is dirty, clean it and make sure that the electrode gap is correct, refer to *Technical data on page 16*.

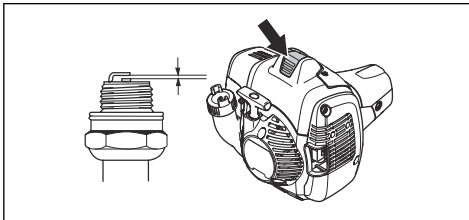

- Replace the spark plug if it is necessary.

Air filter

Remove dust and dirt from the air filter to keep it clean in order to prevent:

- Carburettor malfunctions.
- Starting problems.
- Loss of engine power.
- Unnecessary wear to engine parts.
- Too much fuel consumption.

Clean the air filter at an interval of 25 hours, or more regularly if conditions are unusually dusty.

To clean the air filter



CAUTION: A air filter that is damaged, very dirty or soaked with fuel must always be replaced.

If you use an air filter for a long time it cannot be fully cleaned. Replace the air filter with a new one at regular intervals.

1. Move the choke lever up, to close the choke valve.

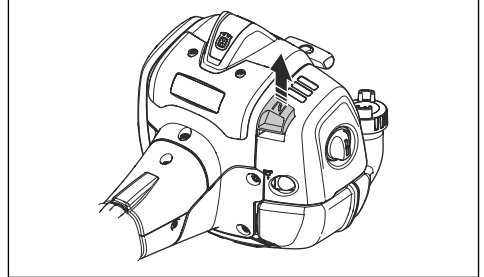

2. Remove the air filter cover and remove the air filter.

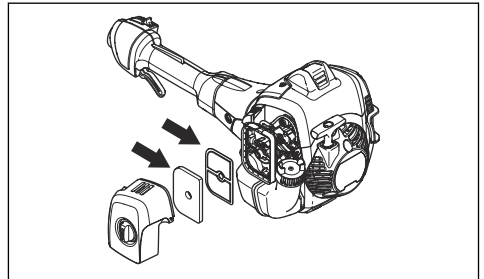

3. Clean the air filter with warm soap water.
4. Replace the air filter if it is too dirty to fully clean it. Always replace a damaged air filter.
5. Also clean the inner surface of the filter cover. Use air or a brush.
6. Do a check of the rubber sealing surface. Replace the filter on the rubber seal if it is damaged.
7. Make sure that the filter is dry before you assemble it.

To apply oil to the air filter



CAUTION: Always use Husqvarna special air-filter oil. Do not use other types of oil.



WARNING: Put on protective gloves. The air-filter oil can cause skin irritation.

1. Put the air filter in a plastic bag.
2. Put the oil in the plastic bag.

3. Rub the plastic bag to supply the oil equally across the air filter.
4. Push the unwanted oil out of the air filter while in the plastic bag.

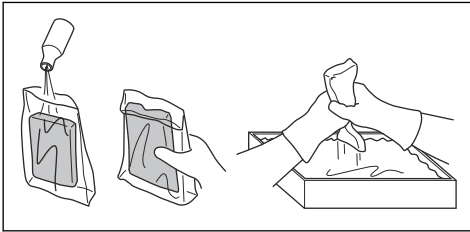

CAUTION: Do not fill the gear housing fully.

To clean and lubricate the blades

1. Clean the blades from unwanted materials before and after you use the product.
2. Lubricate the blades before long periods of storage.

Note: Speak to your servicing dealer for more information about recommended cleaning agents and lubricants.

To lubricate the gear housing



WARNING: Do not touch the gear housing immediately after operation of the product. The gear housing is hot and can cause injury.

- Use Husqvarna special grease. Speak to your servicing dealer for more information about recommended grease.
- Add the grease through the grease nipple.

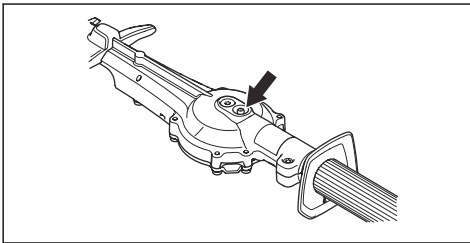

To examine the blades

1. Remove the cap on the socket of the gear housing.
2. Put the combination wrench in the socket of the gear housing and turn clockwise and counterclockwise. Make sure that the blades move freely.

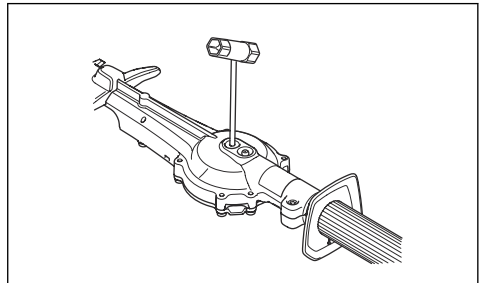

3. Examine the edges of the blades for damages and deformation.
4. Use a file to remove burrs on the blades.

Troubleshooting

The engine does not start		
Problem	Possible cause	Recommended step
Starter pawls	The starter pawls cannot move freely.	Adjust or replace the starter pawls.
		Clean around the starter pawls.
		Speak to an approved servicing dealer.
Fuel tank	Incorrect fuel type.	Drain it and use correct fuel.
Carburetor	Incorrect idle speed.	Adjust the idle speed.

The engine does not start		
Problem	Possible cause	Recommended step
No spark	The spark plug is dirty or wet.	Make sure that the spark plug is dry and clean.
	Incorrect electrode gap.	Clean the spark plug. Make sure that the electrode gap of the spark plug is correct. Make sure that the spark plug is installed with a suppressor.
		Refer to <i>Technical data on page 16</i> for correct electrode gap.
Spark plug	The spark plug is loose.	Tighten the spark plug.

The engine starts but stops again		
Problem	Possible cause	Recommended step
Fuel tank	Incorrect fuel type.	Drain it and use correct fuel.
Carburetor	Incorrect idle speed.	Adjust the idle speed. Refer to <i>To adjust the idle speed on page 11</i> . Speak to your servicing dealer if it is necessary.
Air filter	Clogged air filter.	Clean the air filter.

Blade		
Problem	Possible causes	Recommended step
The blade moves slowly or does not move.	The blade is blocked or it is damaged.	Clean the blades from unwanted materials. Refer to <i>To clean and lubricate the blades on page 14</i> . Remove burrs from the blade, refer to <i>To examine the blades on page 14</i> . Replace the blade if it is damaged.
The blade does not cut easily.	The blade is not sharp or it is damaged.	Sharpen the blade, refer to <i>To examine the blades on page 14</i> . Replace the blade if it is damaged.
The blade becomes hot.	There is friction between the blades.	Remove burrs from the blade and lubricate the blade. Refer to <i>To examine the blades on page 14</i> .

Transportation, storage and disposal

Transportation and storage

- Always allow the product to cool down before storage.
- For storage and transportation of the product and fuel, make sure that there are no leaks or fumes. Sparks or open flames, for example from electrical devices or boilers, can start a fire.
- Always use approved containers for storage and transportation of fuel.
- Empty the fuel before transportation or before long-term storage. Discard the fuel at an applicable disposal location.
- Attach the transport guard during transportation and storage.
- Remove the spark plug cap from the spark plug.
- Attach the product during transportation. Make sure that it cannot move.

- Clean and do servicing on the product before long-term storage.

Technical data

Technical data

	525HF3S
Engine	
Cylinder displacement, cu.in/cm ³	1.50/24.5
Cylinder bore, inch/mm	1.34/34
Stroke, inch/mm	1.06/27
Idle speed, rpm	3000
Recommended max speed, rpm	12000
Maximum engine power acc. to ISO 8893, kW/hp @ rpm	0.9/8500
Catalytic converter muffler	Yes
Speed-regulated ignition system	Yes
Ignition system	
Spark plug	NGK BPM8Y
Electrode gap, inch/mm	0.026/0.65
Fuel and lubrication system	
Fuel tank capacity, US Pint/l	1.06/0.5
Weight	
Without fuel, lb/kg	13.4/6.1
Sound levels¹	
Equivalent sound pressure level at the operator's ear, measured according to ISO 22868, dB(A)	92
Vibration levels²	
Equivalent vibration levels ($a_{hv,eq}$) at handles, measured according to ISO 22867, m/s ² :	
Front/Rear, mm/s ²	3.9/2.9
Blades	
Length, inch/mm	25.6/650
Blade speed, cuts/min	4339

¹ Reported data for equivalent sound pressure level has a typical statistical dispersion (standard deviation) of 1 dB (A).

² Reported data for equivalent vibration level has a typical statistical dispersion (standard deviation) of 1 m/s².

内容

简介.....	17	维护.....	24
安全性.....	18	故障排除.....	28
安装.....	22	运输、存放和废弃处理.....	29
操作.....	22	技术参数.....	29

简介

产品说明

本产品是配备内燃机的高枝绿篱剪。

预期用途

本产品用于切割树枝和枝桠。切勿将产品用于其他任务。

产品概览

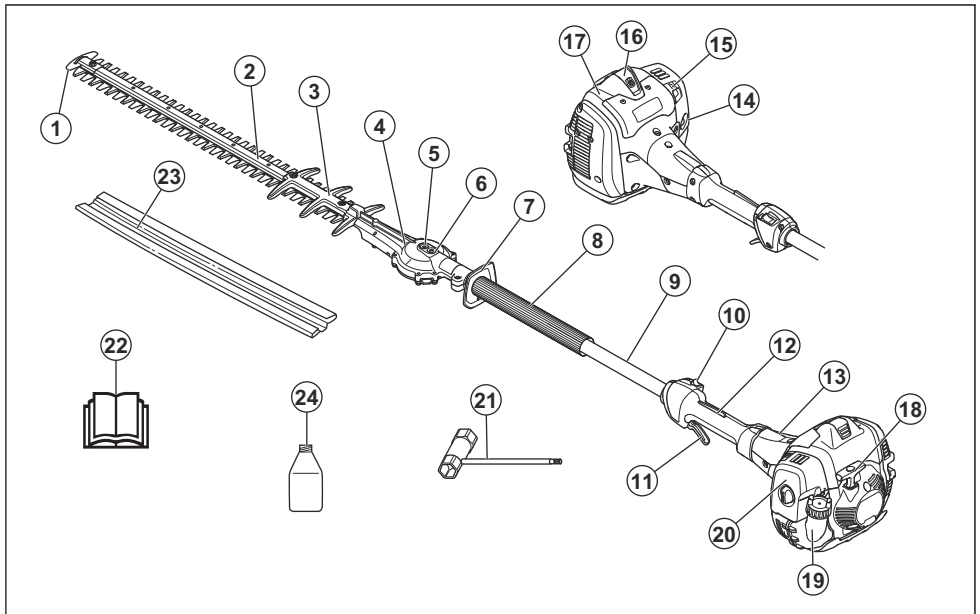

1. 锯片尖端保护装置
2. 切割单元
3. 锯片防护罩
4. 齿轮
5. 锯片手动释放插口
6. 油嘴
7. 护手板
8. 前手柄
9. 轴
10. 停止开关
11. 油门扳机
12. 油门扳机锁
13. 离合器罩

14. 注油泵球囊
15. 风门
16. 火花塞线帽和火花塞
17. 汽缸罩
18. 启动绳把手
19. 燃油箱
20. 空气滤清器外壳
21. 组合扳手
22. 操作手册
23. 运输护板
24. 二冲程机油。并非在所有市场都附带。

本产品上的符号



警告：本产品可能会带来危险，会对操作人员或其他人造成严重伤害或死亡。请多加小心，并正确使用本产品。



请认真阅读本操作手册，确保在充分理解各项说明之后再使用本产品。



在可能被落物砸中的地方请使用保护头盔。请使用获得批准的听觉保护设备。请使用获得批准的眼部保护装备。



请使用获得批准的保护手套。



穿上带有防滑鞋底的结实靴子。



在接触切割工具之前，先要完全关停产品。

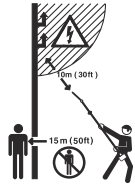

本产品不具有电绝缘。如果本产品触碰到或接近高压电线，可能会对操作人员造成严重伤害或死亡。电流可通过绕行方式在不同物体之间流动。电压越高，电流可以流动的距离就越远。电流还可以通过树枝和其它物体流动，尤其是潮湿的物体。本产品与高压电线和/或触及电线的物体之间务必至少保持 10 m/33 ft 的距离。如果需要在电线附近进行作业，请确保在开始作业之前切断电源。在作业过程中，必须与其他人员或动物至少保持 15 m/50 ft 的距离。

yyyywwxxxx

标牌上显示了序列号。yyyy 是生产年份，ww 是生产周。

注意：有关本产品上的其他符号/标识，请参阅适用于某些市场的特殊认证要求。

安全性

安全定义

本手册使用了“警告”、“小心”和“注意”来指出特别重要的内容。



警告：当不遵守手册中的说明可能会给操作员或周围人员带来伤害或死亡风险时，会使用此标志。



小心：当不遵守手册中的说明可能会对产品、其他材料或附近区域造成损坏时，会使用此标志。

注意：用于提供特定状况下所需的更多信息。

一般安全须知



警告：请在使用本产品前阅读下面的警告说明。

- 在使用本产品时，疏忽或使用不当均有可能造成严重或致命伤害。阅读并且理解本《操作手册》的内容极其重要。
- 本产品在生产期间会产生电磁场。电磁场在某些情况下会干扰有源或无源医疗植入体。为了减少严重或致命性伤害风险，我们建议使用医疗植入体的人员在操作本产品之前事先咨询其医生及医疗植入体制造商。

- 血液循环不佳的人受到过度振动时，可能会导致循环系统或神经伤害。如果您因过度振动而引起以下症状，请立即就医。例如：麻痹、感觉麻木、发痒、刺痛、痛楚、体力缺乏、肤色或身体状况发生变化。这些症状通常出现在手指、双手或手腕上。低温情况下，这种危险会增加。
- 当您遇到任何情况，不知如何继续时，请咨询专家。与您的经销商或保养厂联系。避免任何超出您能力范围的使用。
- 切记，操作人员有责任避免其他人及其财产遭受意外或危险。
- 在事先未确保其他人了解说明书的内容前，禁止其使用本产品。
- 切勿允许儿童使用或靠近本产品。由于产品配备加载弹簧的停止开关，慢速在启动器把手上施力即可启动，有时甚至连儿童也有足够大的力气启动产品。这就有可能造成严重的人员伤亡。因此，产品在无严密监督的情况下要拔掉火花塞线帽。
- 将本产品存放在儿童触不到的位置。
- 感到疲劳时，或者在饮酒或曾服用可能会影响视力、判断力或协调能力的药物后，请勿操作本产品。
- 禁止使用有故障的产品。按照本说明书中的说明进行检查、维护和保养。部分维护和保养措施必须由受过培训并有相应资质的专家进行。请参阅《维护》篇的说明。
- 切勿使用曾对原规格进行任何改动的本产品。

操作安全须知



警告： 请在使用本产品前阅读下面的警告说明。

- 切勿在极端天气条件下使用本产品，如严寒、酷热和/或潮湿气候条件下。
- 有缺陷的锯片会增加发生事故的风险。
- 在作业时，请确保 15 米 / 50 英尺范围之内无人靠近。
- 观察您的周围，确保不存在人或动物接触切割设备的风险。
- 检查作业区。清除所有可能飞出的物体。
- 确保您的工作位置安全、稳定。
- 禁止在马达运行时使本产品处于无人看管状态。
- 确保在发动机运转期间，手脚不要靠近切割装置。
- 如果在作业时有任何东西卡在锯片上，请关闭引擎，待其完全停止后再清理锯片。断开 HT 导线与火花塞的连接。请参阅 *产品概览* 在第 17 页上。
- 在发动机关闭之后，在切割装置完全停止之前，手脚不要靠近切割装置。
- 在切割时，请注意树枝条可能飞出。
- 戴有听觉保护设备时，请留意警告信号或呼喊声。一旦引擎停机，便取下听觉保护设备。
- 切勿在梯子、凳子或其他没有完全固定的高处位置进行作业。
- 务必用双手握住本产品。将本产品握在身体的前方。
- 如果碰撞到任何异物或者发生振动，请立即关闭本产品。断开 HT 导线与火花塞的连接。检查并确保本产品未受损。维修所有受损部分。
- 确保火花塞线帽和点火器导线未受损，以免出现电击风险。
- 检查并确保所有螺母和螺丝都已上紧。
- 确保正确润滑齿轮箱。请参阅 *润滑齿轮箱* 在第 27 页上。
- 在使用本产品过程中，齿轮箱的温度会非常高。切勿触摸齿轮箱，以防烫伤。
- 启动前必须安装好所有的盖子和防护罩。
- 不使用本产品时，必须将运输保护装置始终安装到切割装置上。

个人防护装备



警告： 请在使用本产品前阅读下面的警告说明。

- 操作产品时务必使用获得批准的个人防护装备。个人防护装备不能完全避免受伤，但当意外发生时，可降低伤害程度。请经销商协助您选择正确的防护装备。
- 使用获得批准的听觉保护设备，尽量降低噪音。长期接触噪音可能会导致永久性听力损伤。
- 请使用获得批准的眼部保护装备。如果佩戴面罩，必须同时佩戴获得批准的护目镜。在美国，经批准的护

目镜必须符合 ANSI Z87.1 标准；在欧盟国家/地区，必须符合 EN 166 标准。

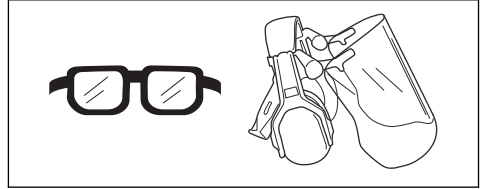

- 必要时戴上手套，例如在安装、检查或清洁切割设备时。

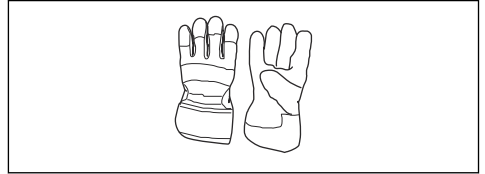

- 穿上坚固的防滑靴或防滑鞋。



- 穿着高强度纤维制成的衣物。务必穿着结实长裤和长袖衣服。切勿穿着容易钩住小树枝和分枝的衣物。切勿佩戴珠宝、穿着短裤、凉鞋或光脚。确保头发安全地挽在肩部以上。
- 确保急救箱触手可及。

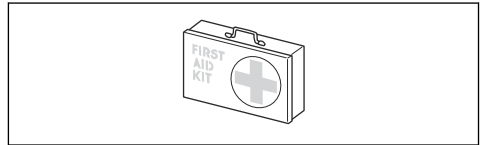

产品上的安全装置



警告： 请在使用本产品前阅读下面的警告说明。

- 切勿在安全装置有故障的情况下使用产品。
- 定期检查安全装置。如果安全装置有故障，请联系您的 Husqvarna 保养厂。

检查油门扳机锁

1. 确保油门扳机锁 (A) 和油门扳机 (B) 活动自如, 且复位弹簧工作正常。

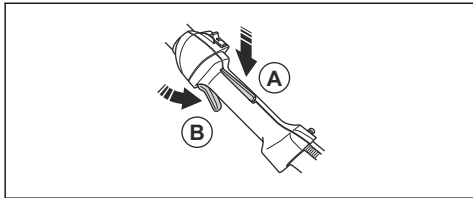

2. 确保在松开油门扳机锁后油门扳机锁止在怠速位置。

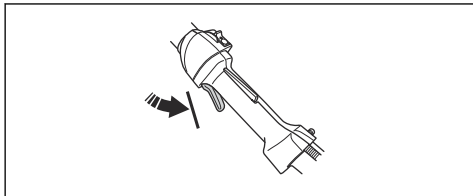

3. 按下油门扳机锁, 并确保松开手后它会返回至初始位置。

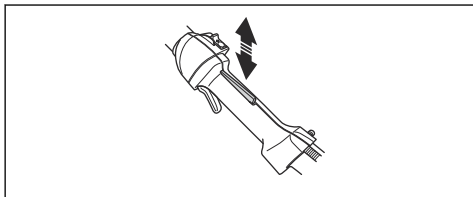

4. 启动产品。请参阅 *启动发动机* 在第 23 页上。全开油门。

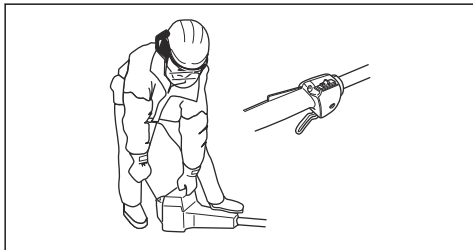

5. 松开油门扳机, 确保锯片停止转动并保持静止。



警告： 如果油门扳机处于怠速位置而锯片仍然运转, 则必须调整化油器的怠速。请参阅 *调整怠速* 在第 25 页上。

检查停止开关

1. 启动引擎。

2. 将停止开关移至停止位置, 确保引擎停止。

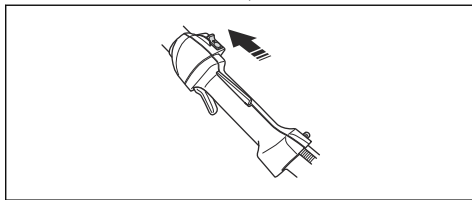

检查护手板

护手板用于防止锯片造成人身伤害。

1. 停止引擎。
2. 确保护手板正确安装。

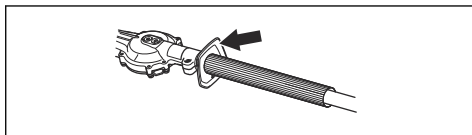

3. 检查护手板是否损坏。

检查防振系统



警告： 使用未正确缠绕的打草绳或使用不正确的切割刀片会增加振级。

防振系统用于最大程度减少手柄上的振动, 使操作更简单。防振系统可减少引擎装置与驱动轴装置之间的振动。

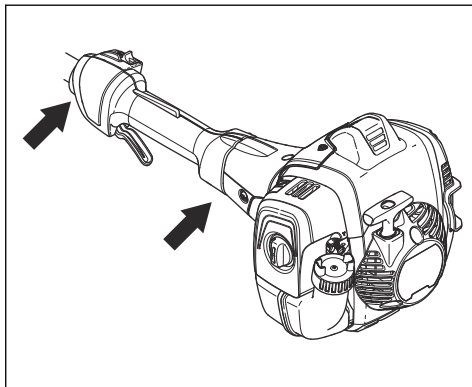

1. 停止引擎。
2. 目视检查是否存在变形和损坏, 如裂纹。

3. 确保防振装置已正确固定。

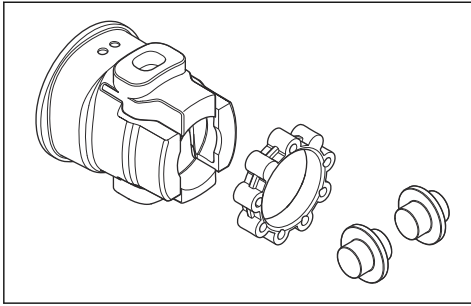

检查消音器

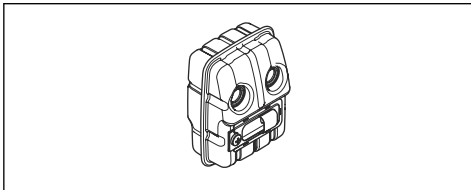

消音器用于最大程度降低噪音级并将引擎的废气浓烟导离操作人员。

- 目视检查是否存在损坏和变形。
- 确保消音器已正确安装在本产品上。

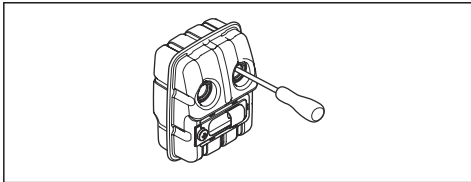

- 如果产品上的消音器有火花消除丝网，则请进行目检。更换损坏的火花消除丝网。
 - a) 火花消除丝网如堵塞，应予以清洁。火花消除丝网堵塞会导致引擎过热，从而导致损坏引擎。
 - b) 确保火花消除网已正确固定。

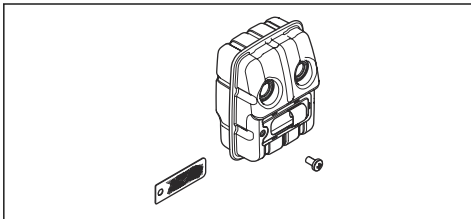

检查锯片和锯片防护罩

锯片外部结构具有与锯片防护罩相同的功能。锯片防护罩用于防止割伤。

1. 关闭引擎，确保锯片停止转动。
2. 拆下火花塞上的火花塞线帽。

3. 戴上保护手套。

4. 确保锯片和锯片防护罩未损坏或弯曲。如果锯片损坏或弯曲，或锯片防护罩已损坏，请务必进行更换。
5. 请确保用于固定锯片和锯片防护罩的螺丝已拧紧。

燃油安全须知



警告： 请在使用本产品前阅读下面的警告说明。

- 切勿在室内或热源附近混合燃油。
- 如果产品上沾染燃油或引擎机油，切勿启动产品。去除多余的燃油/机油，使产品保持干燥。去除产品上多余的燃油。
- 如果燃油溅到衣物上，请立即更换衣物。
- 切勿使身体沾染上燃油，否则可能会导致伤害。如果身体沾染上燃油，应使用肥皂和水去除燃油。
- 如果产品或身体溅上机油或燃油，切勿启动引擎。
- 如果引擎发生泄漏，切勿启动产品。定期检查引擎是否有泄漏。
- 请小心处理燃油。燃油易燃，油烟具有爆炸性，并且可能导致伤害或死亡。
- 切勿吸入油烟，它可能导致伤害。确保充分通风。
- 切勿在燃油或引擎附近吸烟。
- 切勿在燃油或引擎附近放置高温物体。
- 切勿在引擎运转期间添加燃油。
- 确保重新加注燃油之前，引擎处于冷却状态。
- 重新加注燃油之前，缓缓打开燃油箱盖，并小心释放压力。
- 切勿在室内为引擎添加燃油。通风不充分情况下，可能由于窒息性气体或一氧化碳的原因而导致伤害或死亡。
- 小心拧紧燃油箱盖，否则可能会发生火灾。
- 启动之前，将产品从加油位置移开至少 3 m (10 ft)。
- 切勿往燃油箱中加入过多的燃油。
- 确保移动产品或油罐时不会发生泄漏。
- 切勿将产品或油罐置于明火、火花或常明火位置。确保存放区域不存在明火。
- 运输燃油或者存放燃油时，仅使用获得批准的油罐。
- 长期存放之前，请先排空燃油箱。请遵守当地法律关于何处处置燃油的规定。
- 长期存放之前，请先清洁产品。
- 存放产品之前请拆下火花塞线帽，以确保引擎不会意外启动。

维护安全须知



警告： 请在使用本产品前阅读下面的警告说明。

- 停止引擎，确保切割设备停止运行。在进行维护之前，让产品冷却下来。
- 在进行维护之前，断开火花塞线帽。

- 发动机排出的废气含有一氧化碳，这是一种极危险的无味有毒气体，可能导致死亡。切勿在室内或密闭空间中运行本产品。
- 引擎排出的废气温度很高，并可能带有火花。切勿在室内或易燃材料附近运行本产品。
- 未经制造商批准加装附件或改动产品可能导致严重的伤害或死亡。切勿改动本产品。必须使用原厂零件。

- 如未正确和定期地进行维护，会增加伤害风险和产品损坏风险。
- 只能进行本说明书所建议的维护工作。由经过批准的 Husqvarna 保养厂执行所有其他保养工作。
- 由经过批准的 Husqvarna 保养厂定期对产品进行保养。
- 更换已经损坏、磨损或破损的零件。

安装

引言



警告： 请先仔细阅读和充分理解安全须知章节，再安装产品。

安装切割单元

1. 拧松切割单元 (A) 上的螺丝。

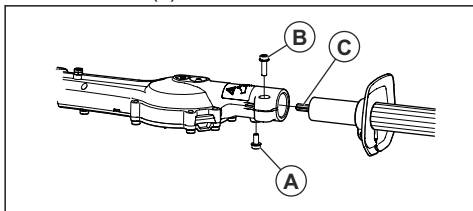

2. 将驱动轴装入切割单元。将螺丝 (A) 与驱动轴上的孔对准。



小心： 确保驱动轴 (C) 与切割单元上的齿轮啮合。

3. 用手指上紧螺丝 (A)。确保将螺丝 (A) 拧入驱动轴上的孔中。
4. 完全上紧螺丝 (A)。
5. 完全上紧螺丝 (B)。

操作

引言



警告： 请先仔细阅读和充分理解安全须知章节，再使用产品。

操作本产品前需要采取的措施

- 检查工作区域并清除松散的物体。
- 检查切割单元。请参阅 *检查锯片和锯片防护罩在第 21 页上*。
- 确保齿轮箱得到正确润滑。
- 确保本产品上的安全装置工作正常。如果有任何安全装置未正确安装，切勿使用本产品。
- 确保所有螺丝和螺母均已上紧。
- 在启动本产品之前，确保所有盖板都已正确安装且没有损坏。
- 当引擎怠速运行时，确保切割单元停止工作。

预混合燃油

- 使用优质 Husqvarna 预混合烷基化燃油，以获得最佳性能和延长引擎寿命。与普通燃油相比，这种燃油中所含的有害化学物质更少，可以减少有害废气的排放。这种燃料燃烧后残留物质量更低，可保持引擎部件更加清洁。

混合燃油

汽油

- 使用乙醇含量最大为 10% 的优质无铅汽油。



小心： 切勿使用辛烷值低于 90 RON/87 AKI 的汽油。使用辛烷值更低的燃油会导致引擎出现爆震现象，这会导致引擎损坏。

- 建议使用辛烷值更高的汽油，以实现连续高转速作业，

二冲程机油

- 为获得最佳结果和性能，请使用 Husqvarna 二冲程机油。
- 如果无法获得 Husqvarna 二冲程机油，请使用风冷式引擎专用的优质二冲程机油。请联系保养代理商以选择正确的机油。

燃油

本产品配备一个二冲程引擎。



小心： 燃油类型不正确会导致引擎损坏。使用汽油和二冲程引擎机油组成的混合燃油。



小心：切勿使用水冷式舷外引擎专用的二冲程机油，即所谓的舷外机油。切勿使用四冲程引擎专用的机油。

混合汽油和二冲程机油

汽油，升	二冲程机油，升
	2% (50:1)
5	0.10
10	0.20
15	0.30
20	0.40



小心：混合少量燃油时，微小误差也会显著影响混合物的比例。小心测量机油量，确保获得正确的混合燃油。

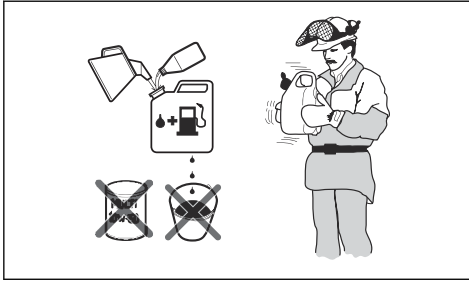

1. 向干净的燃油容器中加入一半的汽油。
2. 加入全部机油。
3. 摇匀混合燃油。
4. 接着向容器中加入另一半汽油。
5. 小心摇匀混合燃油。



小心：切勿一次混合超过一个月的燃油。

加注燃油箱

1. 将燃油箱盖四周清理干净。

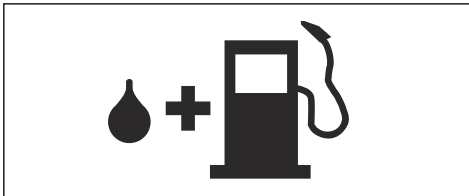

2. 摇晃容器，确保燃油充分混合。

3. 拆下燃油箱盖，加注燃油箱。
4. 正确地拧紧燃油箱盖。
5. 将产品移离加油区和加油站至少 3 m/10 ft 之后才可启动引擎。

注意：要查看燃油箱在产品上的位置，请参阅产品概览在第 17 页上。

启动发动机



警告：启动本产品时，务必与人员和动物至少保持 15 m/50 ft 的距离。存在切割单元开始移动的风险。

1. 将风门设在阻塞位置。

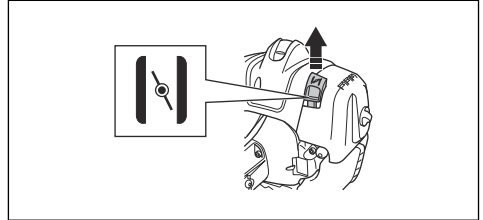

2. 按动注油泵球囊，直至燃油开始注入球囊中。

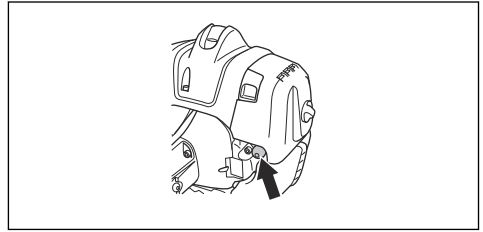

注意：不必注满注油泵球囊。

3. 用左手将产品机体按在地上。切勿用脚踩住本产品。

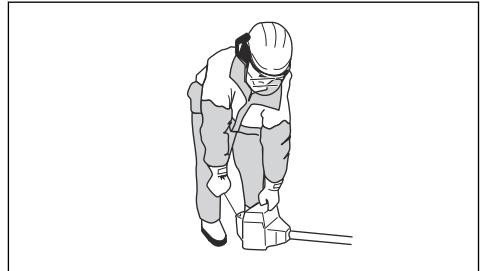

4. 缓缓拉动启动绳把手，直至感觉到一些阻力，然后用力拉动启动绳把手。



警告：切勿将启动绳绕在手上。

5. 继续拉动启动绳把手，直到引擎启动。



小心：切勿完全拉出启动绳，切勿放开启动绳把手。缓缓释放启动绳，以防损坏本产品。

- 当引擎启动后，将风门置于运行位置，并且全开油门。油门扳机会自动脱离启动设置。
- 确保引擎平稳运行。



警告：切勿使用火花塞线帽损坏的产品，以防遭受电击。

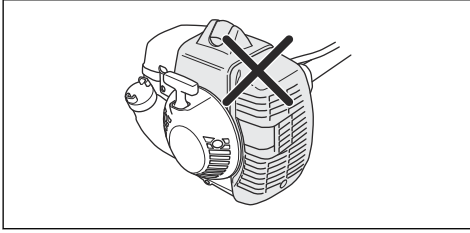

注意：在引擎暖机的情况下启动本产品时，不需要使用风门。

关停产品

- 将停止开关移至停止位置以停止引擎。



小心：停止开关将自动返回至运行位置。

操作本产品

- 当您切割绿篱侧边时，从靠近地面的位置开始，沿绿篱向上移动产品。



- 调整速度以便与工作负载相符。
- 确保引擎不接触绿篱。
- 靠近身体握住产品，以保持稳定的工作姿势。

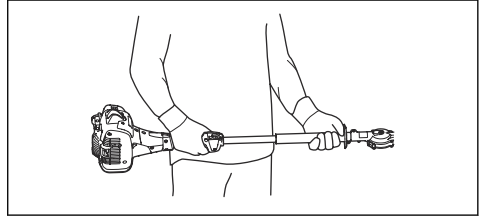

- 确保切割设备的端部不接触地面。
- 小心缓慢地作业，直到所有树枝均已正确切下。

维护

引言



警告：请仔细阅读和充分理解安全须知章节的内容，再对产品执行维护作业。

维护时间表

维护	操作前	40 小时后	100 小时后
清洁外部表面。		每次操作后。	
清除消音器、排气管和引擎上的树叶、污垢和多余的润滑剂。		每次操作后。	
确保在怠速时切割单元不发生移动。	X		
检查停止开关。请参阅 <i>检查停止开关在第 20 页上</i> 。	X		
检查切割单元是否损坏，是否有裂纹。如有损坏，请予以更换。	X		
检查护手板是否有损坏和裂纹。如有损坏，请予以更换。	X		
检查油门扳机锁和油门扳机。请参阅 <i>检查油门扳机锁在第 20 页上</i> 。	X		

维护	操作前	40 小时后	100 小时后
检查引擎、燃油箱和油管是否泄漏。	X		
拧紧螺母和螺丝。	X		
检查启动器和启动绳是否损坏。		X	
确认用于将锯片紧固在一起的螺钉已正确拧紧。		X	
清洁空气滤清器。如果在多尘的区域内使用，需要更加频繁地进行清洁。如有损坏，请予以更换。		X	
检查减震装置是否存在损坏和裂纹。如有损坏，请予以更换。		X	
清洁火花塞外表面及其周围区域。拆下火花塞，并测量电极间隙。调整电极间隙或更换火花塞。请参阅 <i>检查火花塞在第 26 页上</i> 。		X	
清洗冷却系统。		X	
清洁化油器外表面及其周围区域。		X	
检查燃油滤清器上是否有污物，油管是否有裂痕和其它破损现象。如有损坏，请予以更换。			X
清洁消音器上的火花消除丝网，如有损坏，请予以更换。			X
清洁燃油箱的内表面。			X
更换火花塞。			X
检查离合器、离合器弹簧及离合器滚筒的磨损情况。如果损坏，请获得授权的保养代理商进行更换。			X
确保齿轮箱已加满润滑油。			X
检查所有的电缆及接头。			X

调整怠速

1. 清洁空气滤清器，并装上空气滤清器外壳。
2. 启动产品。请参阅 *启动发动机在第 23 页上*。
3. 顺时针转动怠速调整螺钉 T，直至切割单元开始移动。

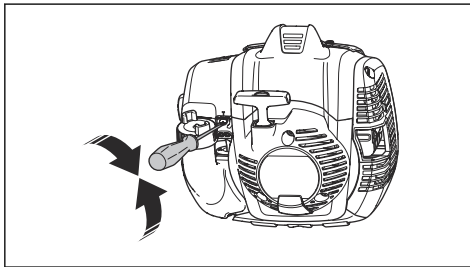

4. 逆时针转动怠速调整螺钉，直至切割单元停止移动。



警告： 如果调整怠速时切割单元不停止移动，请与距离您最近的保养代理商联系。在本产品未得到正确调整或修理之前，请勿使用。

注意： 当引擎在所有位置都能平稳运行时，表明怠速正常。请参阅 *技术资料在第 29 页上* 以了解推荐的怠速。

对消音器进行维护

消音器可降低噪音程度，同时将引擎的废气浓烟导离操作者。



警告： 具有尾气净化器的消音器在运行期间会变得非常热，并且停止产品后有一段时间会保持高温状态。怠速时同样如此。如果您触摸产品，则可能会到导致皮肤灼伤。当心失火危险。

1. 停止产品，让其冷却下来。

2. 取下消音器的盖子。

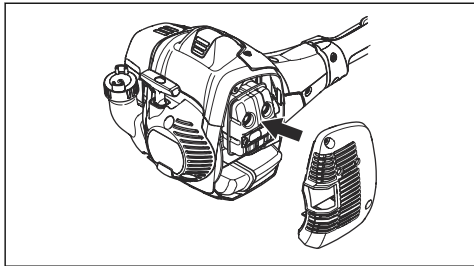

3. 拆下固定火花消除网的螺丝。

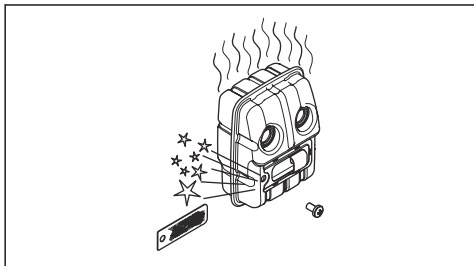

4. 如果火花消除网堵塞，则对其进行清洁，如果损坏，则将其更换。



小心：如果火花消除网损坏，必须进行更换。如果消音器上的火花消除网缺失或者有缺陷，请不要使用本产品。



小心：如果火花消除网经常堵塞，这表明尾气净化器的性能已降低。请咨询您的保养经销商以检查消音器。火花消除网堵塞会导致产品过热，从而损坏汽缸和活塞。

冷却系统

为了尽量保持较低的操作温度，本产品配备了冷却系统。

用刷子每周清洁一次冷却系统的部件，在更加严苛的状况下请更频繁地进行清洁。冷却系统脏污或堵塞会使产品过热，从而导致活塞和汽缸损坏。

冷却系统具有以下部件：

1. 启动器上的进气口。
2. 飞轮上的散热片。
3. 汽缸上的散热片。
4. 汽缸罩。
5. 消音器盖。
6. 消音器护板。

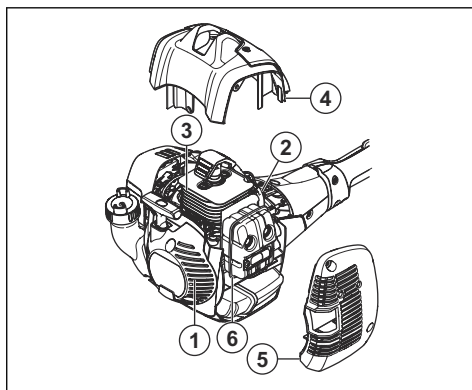

检查火花塞



小心：务必使用建议的火花塞类型。火花塞类型不正确可能导致产品损坏。

- 如果引擎动力不足，请检查火花塞是否不容易启动或者怠速时是否运行不正确。
- 为降低在火花塞电极上出现多余物质的风险，请遵循这些说明：
 - a) 确保已正确调节怠速。
 - b) 确保混合燃油正确。
 - c) 确保空气滤清器清洁。
- 如果火花塞脏污，请进行清洁并确保电极间隙正确，请参阅 *技术参数* 在第 29 页上。

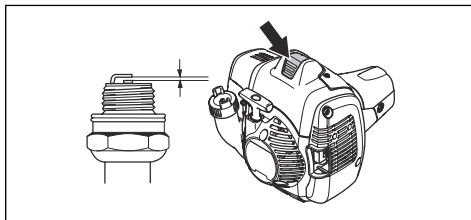

- 必要时请更换火花塞。

空气滤清器

清除空气滤清器中的灰尘和污垢，使其保持清洁，避免发生下列情况：

- 化油器故障。
- 启动问题。
- 引擎功率损耗。
- 引擎零件发生不必要磨损。
- 燃油消耗过大。

每 25 小时清洁一次空气滤清器，或者如果在灰尘异常多的环境下，则要增加清洁次数。

清洁空气滤清器



小心：务必更换损坏、极脏或浸有燃油的空气滤清器。

如果空气滤清器的使用时间较长，则可能无法对其进行彻底清洁。请定期将空气滤清器更换为新的。

1. 向上移动阻气门杆，关闭风门。

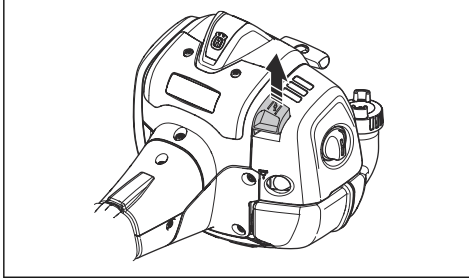

2. 拆下空气滤清器外壳，然后取出空气滤清器。

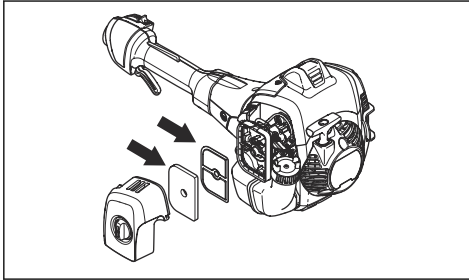

3. 用温肥皂水清洁空气滤清器。
4. 如果空气滤清器过于脏污而无法完全清洁，应予以更换。务必更换损坏的空气滤清器。
5. 此外，请清洁滤清器罩的内表面。使用压缩空气或刷子。
6. 检查橡胶密封表面。更换橡胶密封件上损坏的滤清器。
7. 确保滤清器在安装前保持干燥。

向空气滤清器涂抹机油



小心：务必使用 Husqvarna 专用空气滤清器油。切勿使用其他类型的机油。



警告：戴上保护手套。空气滤清器对皮肤有刺激性。

1. 将空气滤清器放入塑料袋中。
2. 将机油加入塑料袋中。
3. 搓揉塑料袋，确保机油均匀渗入空气滤清器中。

4. 将空气滤清器中多余的机油倒入塑料袋中。

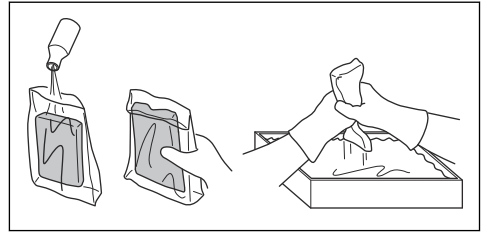

润滑齿轮箱



警告：在使用本产品后，请勿立即接触齿轮箱。齿轮箱温度很高，会导致伤害。

- 请使用 Husqvarna 提供的专用润滑脂。有关推荐润滑脂的更多信息，请与您的保养代理商联系。
- 通过油嘴添加润滑脂。

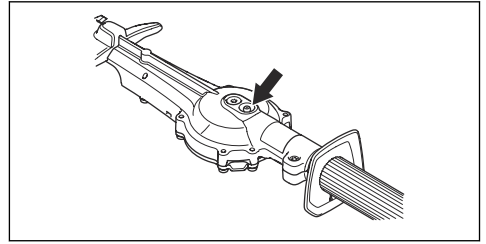

小心：切勿向齿轮箱加注满润滑脂。

清洁和润滑锯片

1. 在使用本产品前后，清除锯片上的多余物质。
2. 长时间存放之前，对锯片进行润滑。

注意：有关推荐清洁剂和润滑剂的更多信息，请与您的保养代理商联系。

检查刀片

1. 拆下齿轮箱插口上的盖子。

2. 将组合扳手插入齿轮箱的插口中，然后顺时针和逆时针转动。确保锯片转动自如。

3. 检查锯片的边缘是否存在损坏和变形情况。
4. 使用锉刀去除锯片上的毛刺。

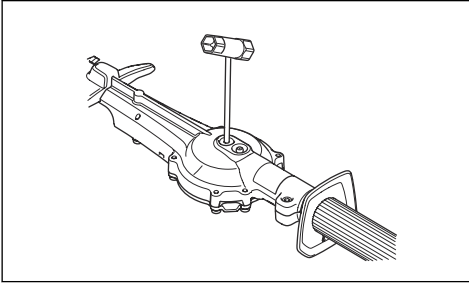

故障排除

引擎不启动		
问题	可能原因	建议步骤
启动器棘爪	启动器棘爪不能自由移动。	调整或更换启动器棘爪。
		清洁启动器棘爪四周。
		请联系获得批准的保养代理商。
燃油箱	燃油类型不正确。	排空并使用正确的燃油。
化油器	怠速不正确。	调节怠速。
无火花	火花塞脏污或受潮。	确保火花塞干燥清洁。
	电极间隙不正确。	清洁火花塞。确保火花塞的电极间隙正确。确保火花塞安装有抑制器。
		有关正确的电极间隙，请参阅 <i>技术参数</i> 在第 29 页上。
火花塞	火花塞较松。	拧紧火花塞。

引擎启动但是再次停止		
问题	可能原因	建议步骤
燃油箱	燃油类型不正确。	排空并使用正确的燃油。
化油器	怠速不正确。	调节怠速。请参阅 <i>调整怠速</i> 在第 25 页上。必要时请联系您的保养代理商。
空气滤清器	空气滤清器堵塞。	清洁空气滤清器。

锯片		
问题	可能的原因	建议步骤
锯片移动缓慢或不移动。	锯片卡住或损坏。	清除锯片上的多余材料。请参阅 <i>清洁和润滑锯片</i> 在第 27 页上。清除锯片上的毛刺，请参阅 <i>检查刀片</i> 在第 27 页上。更换损坏的锯片。
锯片切割不顺畅。	锯片不锋利或损坏。	磨利锯片，请参阅 <i>检查刀片</i> 在第 27 页上。更换损坏的锯片。
锯片变热。	锯片之间存在摩擦。	清除锯片上的毛刺并润滑锯片。请参阅 <i>检查刀片</i> 在第 27 页上。

运输、存放和废弃处理

运输及存放

- 在每次存放之前，先要使本产品冷却。
- 存放和运输产品和燃油时，确保不存在泄漏或烟雾。火花或明火（例如来自电气设备或锅炉等）可能引发火灾。
- 务必使用获得批准的容器存放和运输燃油。
- 运输或长期存放之前，请先排空燃油箱。在适当的处置地点处理燃油。
- 运输和存放期间，请安装好运输护板。
- 拆下火花塞上的火花塞线帽。
- 运输期间请固定好产品。确保产品不会移动。
- 长期存放之前，请先清洁产品并做好保养。

技术参数

技术资料

		525HF3S
引擎		
汽缸排量 (cu.in/cm ³)		1.50/24.5
缸径 (inch/mm)		1.34/34
冲程 (inch/mm)		1.06/27
空转速度 (rpm)		3000
建议的最大转速, rpm		12000
最大引擎功率 (按照 ISO 8893, 单位为 kW/hp @ rpm)		0.9/8500
催化转换器消音器		是
调速点火系统		是
点火系统		
火花塞		NGK BPM8Y
电极间隙, in/mm		0.026/0.65
燃油和润滑系统		
燃油箱容量, 美制品脱/升		1.06/0.5
重量		

	525HF3S
不含燃油, lb/kg	13.4/6.1
声压级³	
操作员耳旁的等效声压级根据 ISO 22868 测量得出, 单位为 dB (A)	92
振级⁴	
手柄等效振动水平 ($a_{hv,eq}$), 根据 ISO 22867 测量得出 (m/s^2):	
前/后, mm/s^2	3.9/2.9
锯片	
长度, inch/mm	25.6/650
锯片速度 (切割次数/分钟)	4339

³ 等效声压级的报告数据中具有 1 dB (A) 的典型统计离差 (标准偏差)。

⁴ 等效振动级的报告数据中具有一个 1 米/秒² 的典型统计离差 (标准偏差)。



www.husqvarna.com

Original instructions
原始说明

1141454-73



2019-09-12