



Husqvarna[®]



BLi550X/BLi950X

1

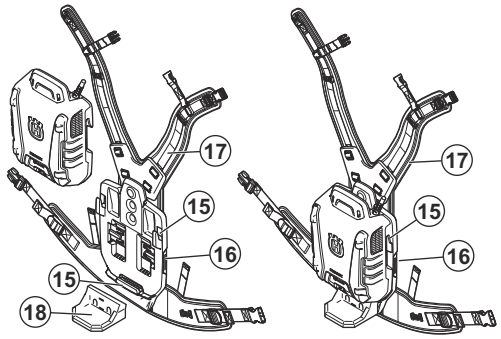
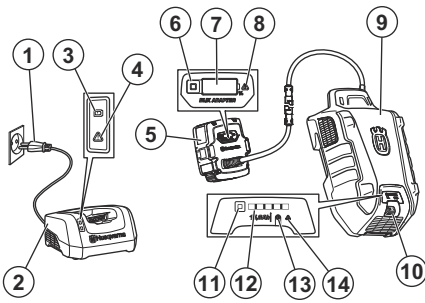

2

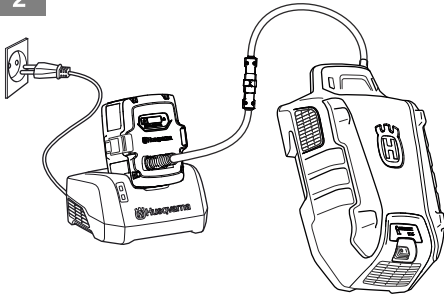

3

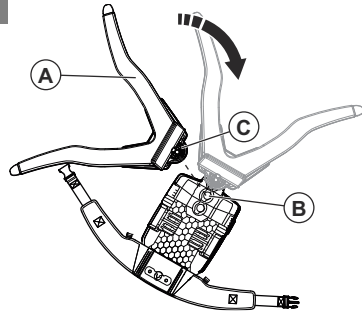

4

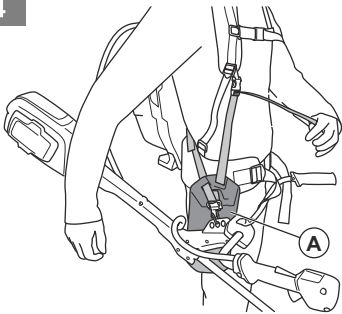

5

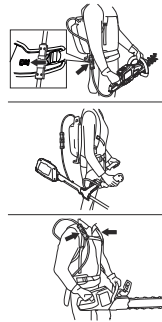

6

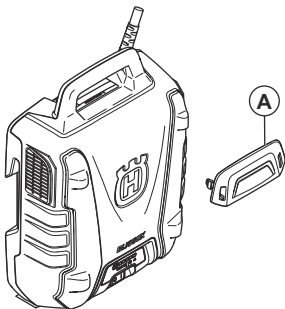

7

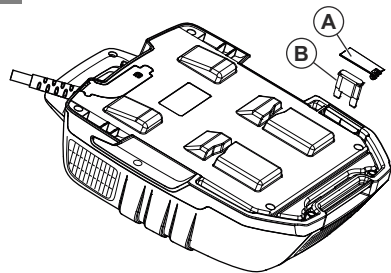

Contents

Introduction.....	3	Troubleshooting.....	5
Safety.....	3	Transportation, storage and disposal.....	6
Operation.....	4	Technical data.....	6

Introduction

Product description

The Husqvarna BLi550X/BLi950X are Li-ion batteries.

Intended use

This product is used as power source for applicable Husqvarna electrical products, for example grass

trimmers, hedge trimmers and blowers. All other use is incorrect.

Product overview

(Fig. 1)

1. Power plug
2. Battery charger
3. Charging LED on the charger
4. Error LED on the charger
5. Adapter
6. Battery indicator button
7. Display on the adapter
8. Error LED on the adapter
9. Battery
10. Power switch
11. Battery indicator button
12. LED indicator for the state of charge
13. Charging LED on the battery
14. Error LED on the battery
15. Hooks for the battery
16. Lock handles for the battery
17. Shoulder strap
18. Foot support



The product agrees with the applicable EC directives.



This product conforms to applicable UK regulations.



Recycle the product at an applicable disposal location for electrical and electronic equipment.



The product or package of the product is not domestic waste.



Do not submerge the battery in water.

Symbols on the product



Be careful and use the product correctly. This product can cause serious injury or death to the operator or others.



Read the operator's manual carefully and make sure that you understand the instructions before use.

yyyywwxxxx

The rating plate shows serial number. **yyyy** is the production year, **ww** is the production week.

Note: Other symbols/decals on the product refer to certification requirements for some commercial areas.

Safety

Safety definitions

Warnings, cautions and notes are used to point out specially important parts of the manual.



WARNING: Used if there is a risk of injury or death for the operator or bystanders if the instructions in the manual are not obeyed.



CAUTION: Used if there is a risk of damage to the product, other materials or the adjacent area if the instructions in the manual are not obeyed.

Note: Used to give more information that is necessary in a given situation.

Important safety instructions



WARNING: Read all safety warnings and all instructions. Failure to obey the warnings and instructions may result in electrical shock, fire and/or serious injury.

Note: Save all warnings and instructions.

- Only use the battery chargers, QC330 or QC500 to charge Husqvarna original batteries. The batteries are software encrypted.
- When an adapter is required, only use Type BLiX Adapter from Husqvarna.
- Use the BLi550X/BLi950X batteries that are rechargeable as a power supply for the related Husqvarna products only. To prevent injury, do not use the battery as a power supply for other devices.
- Do not lift the battery or adapter by the cable. To disconnect the battery charger from a power outlet, pull out the plug. Do not pull the power cord.
- Do not try to disassemble or repair the battery. All repairs is to be done by an approved dealer only.

- Keep the battery away from sunlight, heat or open flame. The battery can cause burns and/or chemical burns.
- Keep the battery away from environments that can cause corrosion to the battery.
- Do not use a defective or damaged battery or battery charger.
- Do not cause mechanical shock to the battery.
- Do not remove the battery from its package until you are to use it.
- If the battery leaks, do not let the liquid touch your body or eyes. If you touch the liquid, clean the area with a large quantity of water and soap, and get medical aid. If you get liquid in your eyes, do not rub but flush with water for a minimum of 15 minutes and get medical aid.
- Keep the battery away from children.
- Keep the battery clean and dry.
- Clean the battery terminals with a clean dry cloth if they become dirty.
- Keep the battery cables away from water, oil and sharp edges. Make sure that the battery cables are not twisted or caught between doors, fences or equivalent.
- Do not keep the battery connected to the battery charger when it is fully charged.
- Remove the battery from the product when you do not use it and during transportation.
- Keep batteries in storage away from metal objects such as nails, screws or jewelry.
- Do not use the harness for climbing. The harness is not approved for climbing. Incorrect use of the harness can cause injury.

Operation

Operation

- The battery must be charged before you use it for the first time. Always use Husqvarna QC330 or QC500 battery charger.
- Use the battery only when the ambient temperature is between -10°C (14°F) and 40°C (104°F).
- Use the battery charger only when the ambient temperature is between 5°C (41°F) and 40°C (104°F).
- The battery will not charge if the battery temperature is more than 50°C (122°F).
- Push the battery indicator button to get information of the state of charge of the battery.

To charge the battery

Note: Charge the battery if it is the first time that you use it. A new battery is only 30% charged.



CAUTION: Only charge the battery when the ambient temperature is between 5°C (41°F) and 40°C (114°F).

1. Make sure that the battery is dry.
2. Connect the battery to the adapter. (Fig. 2)
3. Put the adapter in the battery charger.
4. Make sure that the green charging LED on the battery charger comes on. That means that the adapter and battery are connected correctly.
5. When all LEDs on the battery come on and the adapter shows 100%, the battery is fully charged.

The adapter shows the state of charge in steps of 1%. Small deviations are possible at the start of the charge.

6. To disconnect the battery charger from the mains socket, pull the plug. Do not pull the cable.
7. Remove the adapter from the battery charger.
8. Remove the battery from the adapter.

To start the battery

- Push the power switch of the battery to ON. Refer to *Product overview on page 3*. Wait until the green LED comes on.

Note: The battery stops automatically when the battery is not used.

Battery LED indicator

The display shows the state of charge and if there are problems with the battery.

LED indicator	Battery status
All LED lights are on	The battery is 80% - 100% charged.
4 LED lights are on	The battery is 60% - 80% charged.
3 LED lights are on	The battery is 40% - 60% charged.
2 LED lights are on	The battery is 20% - 40% charged.
1 LED light is on	The battery is 0% - 20% charged.

To adjust the shoulder strap

1. Push the button (C) and turn the shoulder strap (A) to release the shoulder strap. (Fig. 3)

2. Attach the shoulder strap in 1 of 3 positions (B).
3. Turn the shoulder strap to lock it.

To attach the battery to the harness



WARNING: Only use Husqvarna original batteries.

1. Make sure that the battery is fully charged.
2. Pull out the lock handles. Refer to *Product overview on page 3*.
3. Attach the battery on the hooks of the harness.
4. Push the lock handles to lock the battery.

To connect the battery to the Husqvarna handheld product

Note: If you use the accessory (A) for grass trimmers, attach the accessory to the harness before you connect the battery. (Fig. 4)

1. Connect the battery to the Husqvarna handheld product. (Fig. 5)
2. Attach the cable to the harness.

To install the branch protection

The branch protection prevents accidents that can occur if branches get caught in the handle of the battery.

- Put the branch protection (A) in the handle. (Fig. 6)

Troubleshooting

Troubleshooting

Symptoms	Cause	Solution
The battery error LED flashes.	Temperature deviation, the battery is too cold or too hot to use.	Let the battery cool down or move it indoors to warm it up. When the battery has the correct temperature, it can be used again. Use the battery in ambient temperatures between -10°C (14°F) and 40°C (104°F).
	The battery is empty.	Charge the battery.
The battery error LED comes on.	The battery cell difference is too much (1V).	Speak to your dealer.
The battery does not start.	The battery fuse is blown.	Replace the fuse. Refer to <i>To replace the fuse on page 6</i> .

To replace the fuse

1. Examine the fuse. A blown fuse is identified by a burned connector.
2. Set the power switch to OFF.
3. Remove the fuse cover (A). (Fig. 7)
4. Replace the fuse (B).
5. Install the fuse cover.

Transportation, storage and disposal

Transportation and storage

- The supplied Li-ion batteries obey the Dangerous Goods Legislation requirements.
- Obey the special requirement on package and labels for commercial transportations, also those from third parties and forwarding agents.
- Speak to a person with special training in dangerous material before you send the product. Obey all applicable national regulations.
- Use tape on the contacts when you put the battery in a package. Put the battery in the package tightly to prevent damage and accidents.
- Do not keep the battery in an area where static electricity can occur. Do not keep the battery in a metal box.
- Put the battery in a dry, frost free and clean space with correct temperature.

- Put the battery in storage where the temperature is between 5 °C (41 °F) and 25 °C (77 °F). Keep the battery away from sunlight.
- Charge the battery 30% to 50% before you put it in storage for long periods.
- Clean the battery before you put it in storage.

Disposal

Husqvarna products are not domestic waste and must only be discarded as given in this manual.

- Obey the local disposal requirements and applicable regulations.
- Recycle the product and package at an applicable disposal location.
- Speak to your local Husqvarna dealer for more information on how to recycle and discard the product.

Technical data

For technical data, refer to the rating plate of the battery.



www.husqvarna.com

Original instructions



1143397-26



2023-01-18