

Transmission K66M

Spare parts
Ersatzteile
Pièces détachées
Reserve onderdelen
Repuestos
Reservdelar

K66M
 Ser. No. 0000001-Current
 Rev. 1-16-07

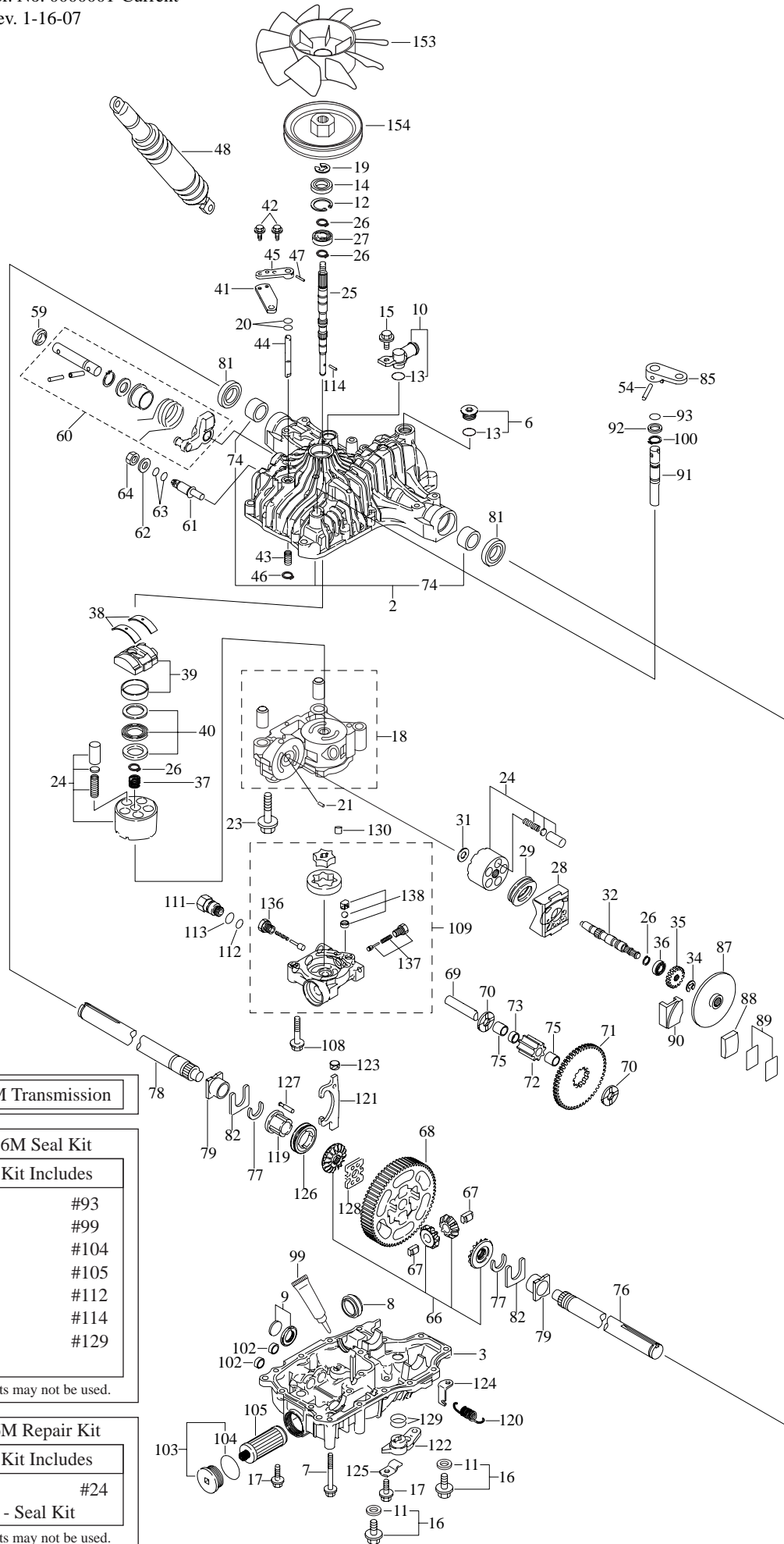

- 1 — **K66M Transmission**

- 200 — **K66M Seal Kit**
 Kit Includes

#8	#93
#11	#99
#13	#104
#14	#105
#20	#112
#59	#114
#63	#129
#81	

 All parts may not be used.

- 201 — **K66M Repair Kit**
 Kit Includes

#18	#24
#200 - Seal Kit	

 All parts may not be used.

ID Number	TTC Part No.	Husq-no	Part Description
1	7A632084570	535417701	K66M TRANSAXLE
2	1A632024101	502449101	UPPER CASE KIT
3	1A632084160	535414664	LOWER CASE
6	1A632024290	535402821	OIL CAP M20 STEEL
7	19215424310	535414683	CAP SCREW 8 * 75
8	1A632024320	535414623	FILTER
9	19216324350	535414694	MAGNET
10	1A632084750	502450201	FITTING
11	22190100000	535402825	SEAL WASHER 10
12	22252000350	535402850	SNAP RING C 35
13	24311000180	535402822	O-RING P18
14	24421153507	506957201	SEAL TC 153507
15	26106080352	502462801	BOLT 8 * 35
16	26106100122	535402824	BOLT 10 * 12
17	26476080302	535402828	TAPPING SCREW 8 * 30
18	1A632024860	535414625	CENTER CASE AB
19	19215485310	535402807	E-RING 15
20	24311240100	535402815	O-RING 1A P10A
21	19216824760	535402858	PIN 3 * 9.8
23	26106100652	502462901	BOLT 10 * 65
24	19216825210	535402874	CYLINDER BLOCK KIT
25	1A632085261	535414666	PUMP SHAFT
26	19215425310	535402881	SNAP RING S15
27	24101062020	535402871	BEARING 6202C3
28	1A632024210	535414622	MOTOR HOUSING
29	19215424240	535414682	THRUST BEARING
31	19216825230	535402879	WASHER 12 * 24 * 1
32	1A632025270	535414628	MOTOR SHAFT
34	1A632025350	535414629	E-RING (MOTOR
35	1A632085400	535414667	MOTOR GEAR 14T
36	24102063020	535414704	BEARING 6302DUC3
37	19215425200	535414685	PUMP SPRING
38	19215427051	535414686	THRUST METAL
39	1A632027100	535414633	SWASH PLATE ASSEMBLY
40	19215427190	535414687	THRUST BEARING K81106
41	1A632089521	535402826	BYPASS ARM
42	26013060142	535402827	BOLT 6 * 14
43	19215427281	502460101	SPRING 25
44	1A632029510	535414634	BYPASS SHAFT
45	1A632029520	535402817	BYPASS LEVER
46	19216829570	535402849	SNAP RING 10
47	22351030020	535402816	SPRING PIN 3.0A * 20
48	19215489150	502460301	SHOCK ABSORBER K65
54	22351060040	535402809	ROLL PIN 6 * 40
59	19406527270	535402811	SEAL TC 162606
60	1A632089800	502451101	CONTROL SHAFT COMPLETE
61	1A632029700	535402892	FULCRUM
62	22137120000	535402813	WASHER 12
63	24311000140	535402814	O-RING 1A P14
64	26776120002	506956601	NUT 12

66	1A632081510	502449701	DIFFERENTIAL GEAR KIT
67	1A632081810	535414656	DIFFERENTIAL PINION PIN
68	1A632083540	535414661	FINAL GEAR
69	1A632033410	535414639	FINAL PINION SHAFT
70	1A632033420	535414640	WASHER 15 * 35 * 3.2
71	1A632083470	535414659	REDUCTION GEAR 51T
72	1A632083550	535414662	FINAL PINION GEAR 11T
73	1A632083430	535414658	COLLAR (FPS
74	19215434240	535414690	BUSHING 25.4
75	1A632083420	535414657	NEEDLE BEARING 151814
76	1A632089130	535414674	AXLE SHAFT, LEFT
77	19216734160	535414696	RETAINING RING 23
78	1A632089230	535414675	AXLE SHAFT RIGHT
79	19216734240	535414697	BUSHING
81	19215434270	535402810	SEAL S25.4 * 42 * 8
82	1A632034290	535414645	THRUST WASHER
85	1A632089870	535402808	BRAKE LEVER
87	1A632036110	535414646	BRAKE DISC
88	1A632036120	535414647	BRAKE SHOE
89	1A632036170	502449501	SHIM KIT
90	1A632036200	502449601	BRAKE ACTUATOR
91	1A632036160	535414650	BRAKE SHAFT
92	1A632036190	535414651	WASHER 16 * 23 * 1.6
93	24311000120	535414619	O-RING 1A P12
99	Part of Seal Kit	#N/A	SEALANT
100	22242000160	535414702	SNAP RING
103	1A637024380	535402818	CAP 40
104	24351020400	535402820	O-RING 1A2040
105	1A632026450	535402819	FILTER
108	26106080452	535414706	BOLT 8 * 45
109	1A632096150	535466501	PUMP CASE KIT
111	1A637026420	535466502	CONNECTOR
112	19485049290	535466503	O-RING 6-1
113	24311000160	502462001	O-RING P16
114	19215488330	535414692	PIN 3 * 13.8
119	1A632084271	502449901	DIFF-LOCK COLLAR 25.4
120	19215333130	535402801	RETURN SPRING
121	1A632087120	535414669	DIFF-LOCK FORK
122	1A632087151	535402802	DIFF-LOCK LEVER
123	1A632087160	535414670	LEVER PIVOT
124	1A632087170	535402803	SPRING HOOK
125	1A632087180	535402804	LEVER CLIP
126	1A632087260	502450601	DIFF-LOCK SLIDER
127	1A632087220	535414672	DIFF-LOCK PIN
128	1A632087230	535414673	DIFF-LOCK PLATE
129	24321000250	535402805	O-RING 1AG25
130	19452141570	535414699	ALIGNMENT SLEEVE 11 * 7
136	19216726300	502460601	CHARGE RELIEF VALVE
137	1A632026390	502449301	IMPLEMENT RELIEF VALVE
138	1A637026350	502451501	3RD CHECK VALVE
153	1A632085100	502450301	FAN 7" Dia
154	1A632085120	502450501	INPUT PULLEY 3.5" Dia

200	1A632099250	502451301	K66B,D,I,K,M SEAL KIT
201	66004	502463701	REPAIR KIT