

K574RA

Spare parts

Ersatzteile

Pièces détachées

Reserve onderdelen

Repuestos

Reservdelar

K574RA
 Ser. No. 0000001-Current
 Rev. 12-29-09

ACTUAL PARTS
 MAY NOT APPEAR
 AS SHOWN

Bolt Tightening Specs.

Bolt Size	Torque
M8	16~18 ft.lb. (21~24 N.m)
M10	33~47 ft.lb. (45~64 N.m)

NOTE:
 RESERVOIR TANK
 IS SUPPLIED BY
 VEHICLE MFG.

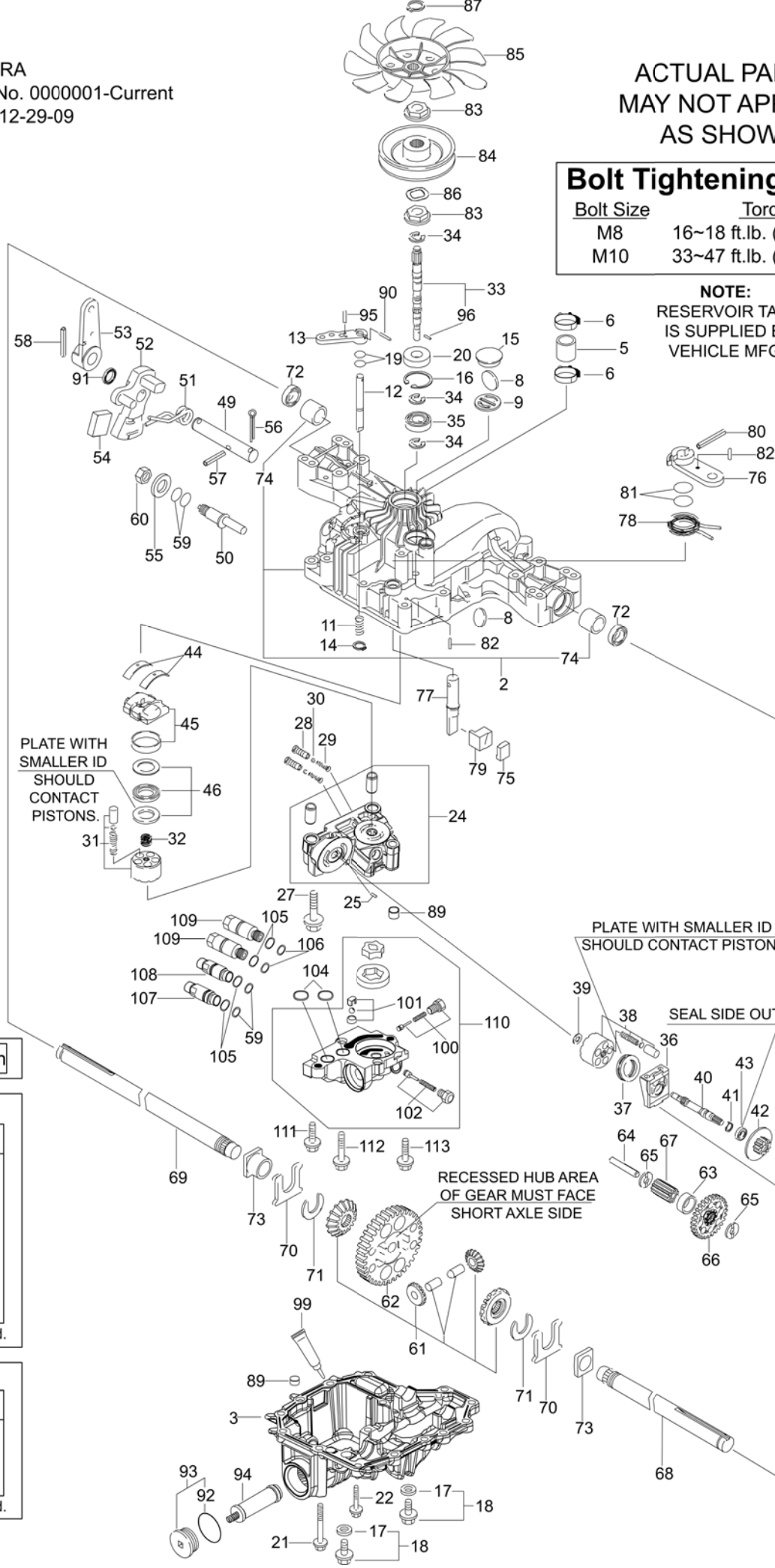

1- K574RA Transmission

K574RA Seal Kit
 Kit Includes

#17	#91
#19	#92
#20	#94
#30	#99
#59	#104
#72	#105
#81	#106

All parts may not be used.

K574RA Repair Kit
 Kit Includes

#24	#38
#31	
#200-Seal Kit	

All parts may not be used.

200-

201-

NOTE ORIENTATION
 WHEN INSTALLING

**(K574RA-HUSQVARNA / 787Q0324210)
HUSQVARNA AB (52333)**

TTC Part No.	Part Description	Service Part
1111	TRANSMISSION STAND	
1115	5W-50 SYNTHETIC OIL	
1116	TUFF TORQ CAP (BLUE)	
1117	TUFF TORQ CAP (RED)	
1118	POCKET MAGNET	
1119	OIL ABSORBENT PADS	
787Q0324210	K574RA TRANSAXLE	
1A646084001	UPPER CASE KIT	502 45 29-01
187Q0324160	LOWER CASE (4 PORT)	577 32 57-01
1A646024280	TUBE	502 45 16-01
1A646024120	COBRA CLAMP	506 98 70-01
19216324360	MAGNET 28 * 3.5	535 40 28-29
1A646029000	MAGNET HOLDER	502 45 20-01
19215427281	SPRING 25	502 46 01-01
1A646089510	BYPASS SHAFT B	502 85 21-01;535 40 28-48
1A632029520	BYPASS LEVER	535 40 28-17
19216829570	SNAP RING 10	535 40 28-49
1C655036300	SEALING CAP 30	535 40 28-32
22252000350	SNAP RING C 35	535 40 28-50
22190080000	SEAL WASHER 8	506 95 75-01
187Q0399940	DRAIN BOLT KIT	577 32 59-01
24311240100	O-RING 1A P10A	535 40 28-15
24421153507	SEAL TC 153507	506 95 72-01
26106080552	BOLT	502 85 22-01
26476080302	TAPPING SCREW 8 * 30	535 40 28-28
187Q0334501	CENTER CASE J CMP	502 85 23-01
19216824760	PIN 3 * 9.8	535 40 28-58
26106100752	BOLT 10 * 75	535 40 28-63
1A646024752	IDS VALVE	535 40 28-60
1A646024761	IDS SPRING	535 40 28-61
1A646024790	IDS FILTER 300	535 40 28-62
19216825111	CYLINDER BLOCK (PUMP) KIT	535 40 28-64
1A646025200	SPRING	535 40 28-69
187Q0399980	PUMP SHAFT L KIT	577 32 59-01
19215485310	E-RING 15	535 40 28-07
24101062020	BEARING 6202C3	535 40 28-71
187Q0324810	MOTOR HOUSING	502 85 26-01
187K0099750	THRUST (BALL) BEARING	502 46 00-01
187Q0025140	CYLINDER BLOCK (MOTOR) KIT	502 85 27-01
19216825230	WASHER 12 * 24 * 1	535 40 28-79
1A646025271	MOTOR SHAFT	502 45 17-01
19215425310	SNAP RING S15	535 40 28-81
1A646085400	BRAKE DISC/MOTOR GEAR (12T)	535 40 28-82
168T2025280	BEARING 6202 RSR C3	535 40 28-83
19216327051	THRUST METAL	535 40 28-84
168T2084530	SWASH PLATE CMP	523 05 88-01
19216399000	THRUST BEARING (PUMP) KIT	523 05 89-01
1A646029911	CONTROL SHAFT	502 45 22-01
168T2029920	FULCRUM	502 85 30-01
1A646029810	TORSION SPRING, HEAVY	502 45 21-01
168T2029740	CONTROL ARM A	535 41 49-51
1A646089831	CONTROL LEVER	502 45 32-01
168T2029360	JERKY PLATE	577 32 60-01

TTC Part No.	Part Description	Service Part
22137120000	WASHER 12	535 40 28-13
1A646029940	COTTER PIN 1/8" * 3/4"	502 45 24-01
22351060036	SPRING PIN 6 * 36	502 46 18-01
22351060040	ROLL PIN 6 * 40	535 40 28-09;535 41 49-22
24311000140	O-RING 1A P14	535 40 28-14
26776120002	NUT 12	506 95 66-01
1A646031570	DIFF GEAR KIT	577 32 61-01
1A646033520	FINAL GEAR (54T)	535 41 46-04
1A646033250	FINAL PINION COLLAR	535 41 46-05
1A646033531	REDUCTION SHAFT	502 45 27-01
19216833420	WASHER 12 * 32 * 3.2	502 46 07-01
1A646083450	REDUCTION GEAR (31T)	535 41 46-08
168T2033540	FINAL PINION	577 33 49-01
1A646034111	AXLE SHAFT, LEFT	535 41 46-10
1A646034121	AXLE SHAFT, RIGHT	535 41 46-11
19216334261	THRUST WASHER	535 41 46-12
19216834270	RING 17	535 41 46-13
19216334280	SEAL 19 * 32 * 8	535 40 28-37
19216834350	BUSHING 19 * 25	535 41 46-14
168T2034240	BUSHING 19.05	502 85 33-01
1A646036121	BRAKE SHOE	535 41 46-16
1A646036160	BRAKE LEVER	535 40 28-38
1A646036171	BRAKE SHAFT	535 41 46-17
168T2036180	BRAKE RETURN SPRING	535 40 28-39;535 40 28-91
1A646036200	BRAKE ACTUATOR	535 41 46-18
22351050032	SPRING PIN 5 * 32	535 40 28-40
24311000120	O-RING 1A P12	535 41 46-19
22351040016	SPRING PIN 4 * 16	535 40 28-41
1A646025300	SPLINE COLLAR	506 98 66-01
1A646025760	PULLEY B	502 45 19-01;506 98 67-01
1A646083070	FAN, BLACK	506 98 68-01
1A646083060	WAVE WASHER	506 98 65-01
19215489090	SNAP RING	735 31 15-00
19452141570	ALIGNMENT SLEEVE 11 * 7	535 41 46-99;535 41 49-05
22351030020	SPRING PIN 3.0A * 20	535 40 28-16
1A646024440	OIL SEAL 16 * 22 * .03	535 40 28-46;535 41 49-04
24351240400	O-RING 1A 2040	574 51 52-01
1A637094450	CAP KIT	574 51 51-01
1A632026450	FILTER	535 40 28-19
22351030016	SPRING PIN 3.0A * 16	535 40 28-33
168P3B29690	PIN A	502 85 34-01
1A646099500	SEALANT	502 45 34-01;505 34 87-01
187Q0326250	IMPLEMENT VALVE COMPLETE	577 32 62-01
1A637026350	3RD CHECK VALVE	502 45 15-01
187Q0326300	CHARGE VALVE ASSEMBLY	502 85 37-01
19215424670	O-RING 1015	535 41 47-50
24311000160	O-RING 1A P16	502 46 20-01
19485049290	O-RING 6.1	535 46 65-03
187Q0324930	PIPING 3/8 A	502 85 16-01
187Q0324940	PIPING 3/8 B	502 85 17-01
187Q0326430	CONNECTOR G1/4	577 33 51-01
187Q0399050	PUMP CASE KIT	577 32 64-01
26106080252	BOLT 8 * 25	502 85 40-01
187Q0308090	TAPPING SCREW 8 * 90	502 85 41-01
26016080322	BOLT & WASHER 8*32	502 85 42-01
187Q0399110	SEAL KIT (K574 A,B,C,E,F,J)	502 85 18-01
187Q0399130	REPAIR KIT (K574A, B, C, E, F, J)	