



SPARE PARTS LIST

ACCESSORIES AND TOOLS

KPS-23CLP, 2014-02

KPS-23CLP
 Ser. No. 0000001 - Current
 Rev. 10-30-13

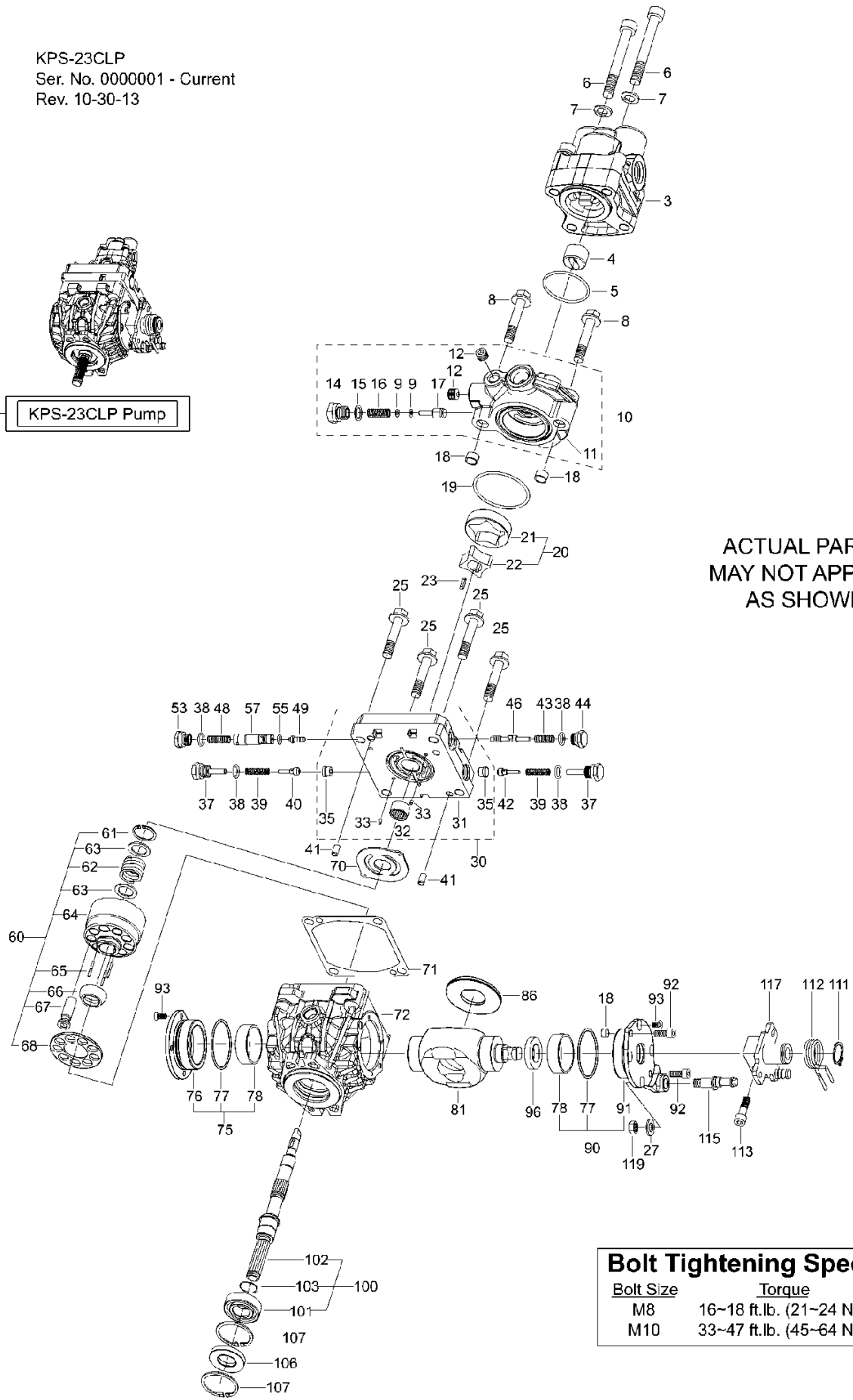
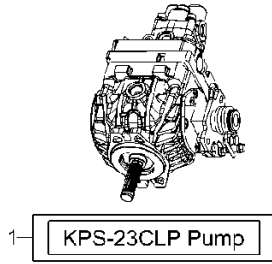

ACTUAL PARTS
 MAY NOT APPEAR
 AS SHOWN

Bolt Tightening Specs.	
Bolt Size	Torque
M8	16~18 ft.lb. (21~24 N.m)
M10	33~47 ft.lb. (45~64 N.m)

TRANSMISSION

KPS-23CLP, 2014-02

Ref	Part No	Description	Remark	QTY KIT
1	579 40 88-01	HYDRAULIC PUMP		1
3	585 46 15-01	PUMP		1
4	585 45 88-01	COUPLING		1
5	585 46 95-01	O-RING		1
6	585 47 00-01	BOLT		2
7	585 46 87-01	LOCK WASHER		2
8	585 46 97-01	BOLT		2
9	586 87 62-01	SHIM		2
10	585 46 21-01	PUMP		1
11	585 46 22-01	PUMP		1
12	535 41 47-55	PLUG		2
14	586 87 63-01	PLUG		1
15	535 46 65-03	O-RING		1
16	586 87 64-01	SPRING		1
17	586 87 65-01	VALVE		1
18	535 41 46-99	PIN RETAINING SCREW		2
19	585 46 96-01	O-RING		1
20	585 45 83-01	ROTOR		1
23	585 45 82-01	KEY		1
25	585 46 98-01	BOLT		4
27	585 46 86-01	LOCK WASHER		1
30	585 46 25-01	CASE		1
32	585 45 93-01	NEEDLE		1
33	585 46 75-01	PIN		2
37	585 46 13-01	PLUG		2
38	585 46 94-01	O-RING		4
39	585 46 11-01	SPRING		2
40	585 46 05-01	CHECK VALVE		1
41	585 46 89-01	PIN		2
42	585 46 17-01	VALVE		1
43	586 87 67-01	SPRING		1
46	586 87 68-01	VALVE		1
48	585 45 86-01	SPRING		1
49	586 87 86-01	VALVE		1
53	586 87 87-01	PLUG		1
55	586 87 88-01	PACKING		1
57	585 45 87-01	SLEEVE		1
60	585 45 94-01	CYLINDER		1
61	585 52 94-01	SNAP RING		1
70	585 46 27-01	PLATE		1
71	585 46 16-01	PACKING		1
72	585 52 92-01	HOUSING		1
75	585 46 28-01	PLATE		1
77	585 53 64-01	O-RING		2
81	585 46 02-01	PLATE		1
86	585 52 87-01	PLATE		1
90	585 46 52-01	COVER		1
92	585 53 65-01	BOLT		2
93	585 53 67-01	SCREW		4
96	585 52 86-01	SEAL		1
100	586 87 90-01	SHAFT		1
101	585 52 96-01	BEARING		1
102	586 87 93-01	SHAFT		1
103	585 46 14-01	RING		1
106	585 46 18-01	SEAL		1
107	585 52 95-01	SNAP RING		2
111	585 52 93-01	SNAP RING		1
112	585 52 91-01	SPRING		1
113	585 53 66-01	BOLT		1
115	585 46 19-01	SEAL		1
117	585 52 90-01	LEVER		1
119	585 53 68-01	NUT		1