

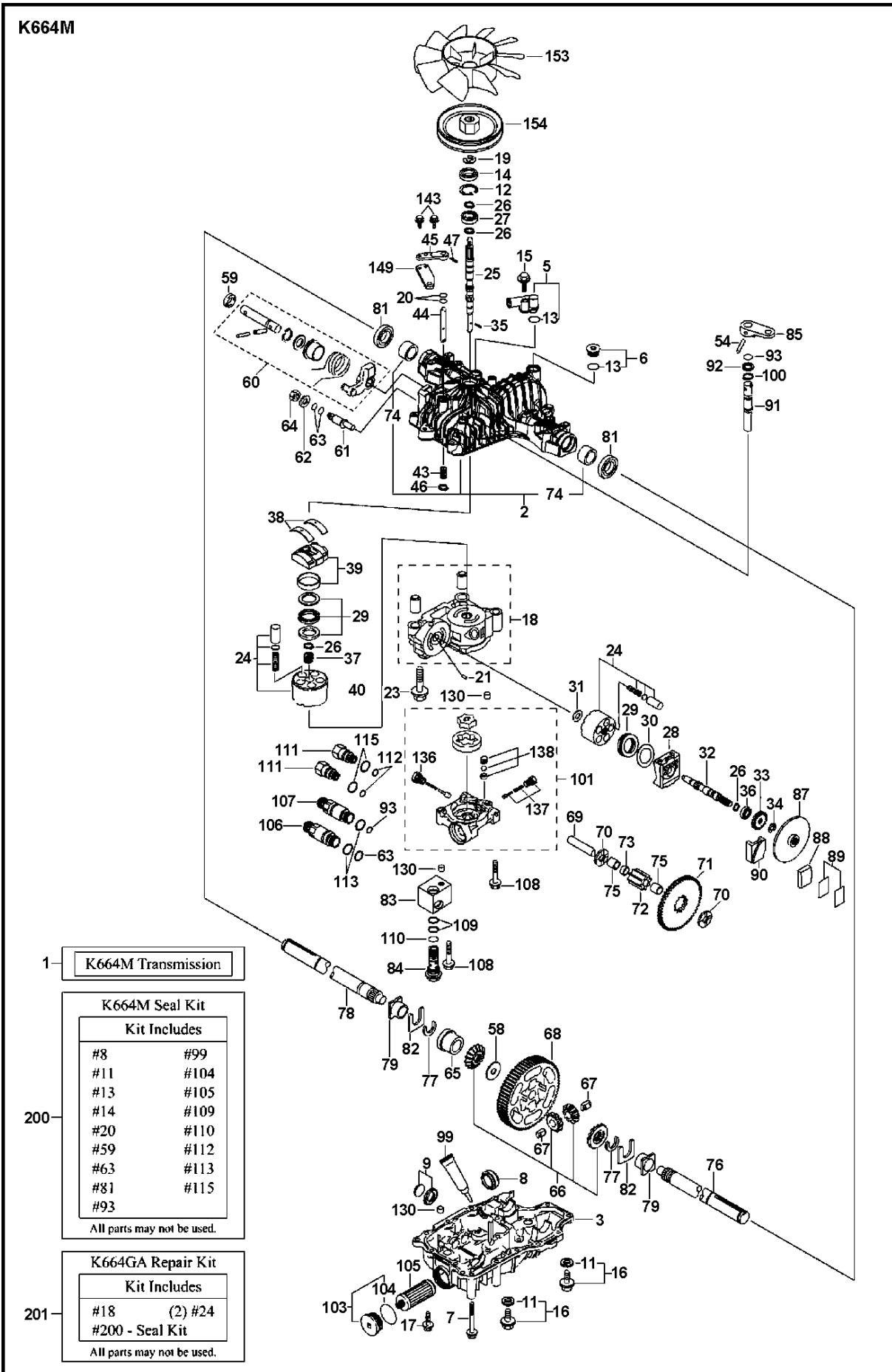

SPARE PARTS LIST

ENGINES & TRANSMISSIONS

K664M, 501114001, 2017-01



TRANSMISSION

K664M, 501114001, 2017-01

Ref	Part No	Description	Remark	QTY KIT
1	501 11 40-01	TRANSMISSION		1
2	523 07 44-01	HOUSING		1
3	577 34 18-01	CASE		1
5	574 51 46-01	CLUTCH		1
6	574 51 47-01	KIT		1
7	535 41 46-83	BOLT		2
8	535 41 46-23	FILTER		1
9	535 41 46-94	MAGNET		1
11	535 40 28-25	WASHER		14
12	586 88 93-01	SNAP RING		1
13	586 90 36-01	SEALING		2
14	506 95 72-01	SEALING		1
15	502 46 28-01	BOLT		1
16	523 07 47-01	BOLT		14
17	535 40 28-28	SCREW		1
18	577 34 20-01	CASE		1
19	535 40 28-07	CLIP		1
20	535 40 28-15	O-RING		1
21	535 40 28-58	PIN RETAINING SCREW		1
23	502 46 29-01	BOLT		1
24	578 97 55-01	KIT		1
25	523 07 49-01	SHAFT		1
26	535 40 28-81	RETAINING RING		3
27	582 16 30-01	BEARING		1
28	590 62 12-01	HOUSING		1
29	590 62 13-01	PLATE		1
30	590 62 14-01	WASHER		1
31	535 40 28-79	WASHER		1
32	523 07 59-01	SHAFT		1
33	535 41 46-67	GEAR		1
34	535 41 46-29	O-RING		1
35	535 41 46-92	PIN RETAINING SCREW		1
36	535 41 47-04	BEARING		1
37	535 41 46-85	SPRING		1
38	574 51 58-01	METALL PALLETE LE15 - EP 2 - KNORR		1
40	574 51 60-01	BEARING		1
41	574 51 62-01	PLATE		1
42	535 41 46-89	PLATE		2
43	502 46 01-01	SPRING		1
44	535 41 46-34	SHAFT		1
45	535 40 28-17	LEVER		1
46	535 40 28-49	RETAINING RING		1
47	586 90 45-01	SPRING PIN		1
54	586 90 46-01	PEN		1
58	502 45 12-01	WASHER		1
59	535 40 28-11	SEALING		1
60	502 45 11-01	CONTROL SHAFT		1
61	535 40 28-92	ECCENTRIC		1
62	585 46 86-01	LOCKWASHER		1
63	585 46 94-01	O-RING		2
64	585 53 68-01	NUT		1
65	535 41 46-44	SLEEVE		1
66	502 44 98-01	DIFFERENTIAL GEAR KIT		1
67	535 41 46-56	PIN RETAINING SCREW		1
68	523 07 68-01	GEAR		1
69	574 51 63-01	SHAFT		1
70	535 41 46-40	WASHER		1
71	535 41 46-59	GEAR		1
72	535 41 46-62	PINION		1
73	535 41 46-58	SLEEVE		1
74	535 41 46-90	BUSHING		1
75	535 41 46-57	NEEDLE BEARING		1
76	590 62 06-01	SHAFT		1
77	535 41 46-96	RETAINING RING		1

TRANSMISSION

K664M, 501114001, 2017-01

Ref	Part No	Description	Remark	QTY KIT
78	590 62 07-01	SHAFT		1
79	535 41 46-97	BUSHING		1
81	590 62 15-01	SEAL		2
82	535 41 46-45	WASHER		1
83	577 34 40-01	BLOCK		1
84	577 34 41-01	CONNECTOR		1
85	586 90 43-01	BRAKE LEVER		1
87	535 41 46-46	BRAKE DISC		1
88	586 90 49-01	BRAKE SHOE		1
89	502 44 95-01	SHIM KIT		1
90	586 90 48-01	BRAKE		1
91	535 41 46-50	SHAFT		1
92	586 90 47-01	WASHER		1
93	586 90 44-01	SEALING		1
99	578 97 49-01	SEAL		1
100	535 41 47-02	RETAINING RING		2
101	590 62 16-01	CASE		1
103	574 51 51-01	KIT		1
104	574 51 52-01	O-RING		1
105	586 66 68-01	FILTER		1
106	574 51 53-01	PIPE FITTING		1
107	574 51 54-01	PIPE FITTING		1
108	535 41 47-06	BOLT		1
109	574 51 55-01	O-RING		1
110	574 51 56-01	O-RING		1
111	577 34 43-01	CONNECTOR		1
112	585 46 79-01	O-RING		1
113	502 46 20-01	O-RING		1
115	535 46 65-04	O-RING		1
130	585 46 78-01	PEN		1
136	502 46 06-01	CHARGE RELIEF VALVE		1
137	535 46 65-05	VALVE		1
138	502 45 15-01	3RD CHECK VALVE		1
143	535 40 28-27	BOLT		1
149	535 40 28-26	LEVER		1
153	506 94 81-01	FAN		1
154	506 99 14-01	PULLEY		1
200	590 62 17-01	SEAL KIT		1
201	N/A	TBD		1