

Illustrated Parts List - IPL Update



Product Name(s)

572XP/XPG

Description of change

New Starter housing with four steel sleeves added. Increased screw torque to 6Nm (was 4Nm).

Reason: Better fastening of starter housing in crank case.

Comments

New article 575 52 76-04 Starter housing assy is fully interchangeable.

New article 575 52 58-02 Starter housing is fully interchangeable.

Introduced from

Serial number / Date	Remark
20194700001	STARTER HOUSING ASSY 575 52 76-04
20194700001	STARTER HOUSING 575 52 58-02

IPL updates

Page Title	Ref.No	New part no	Name	Excl. part no.	Remark
STARTER	1	575 52 76-04	STARTER HOUSING ASSY	575 52 76-02	
STARTER	9	575 52 58-02	STARTER HOUSING	575 52 58-01	

STARTER

New

Old

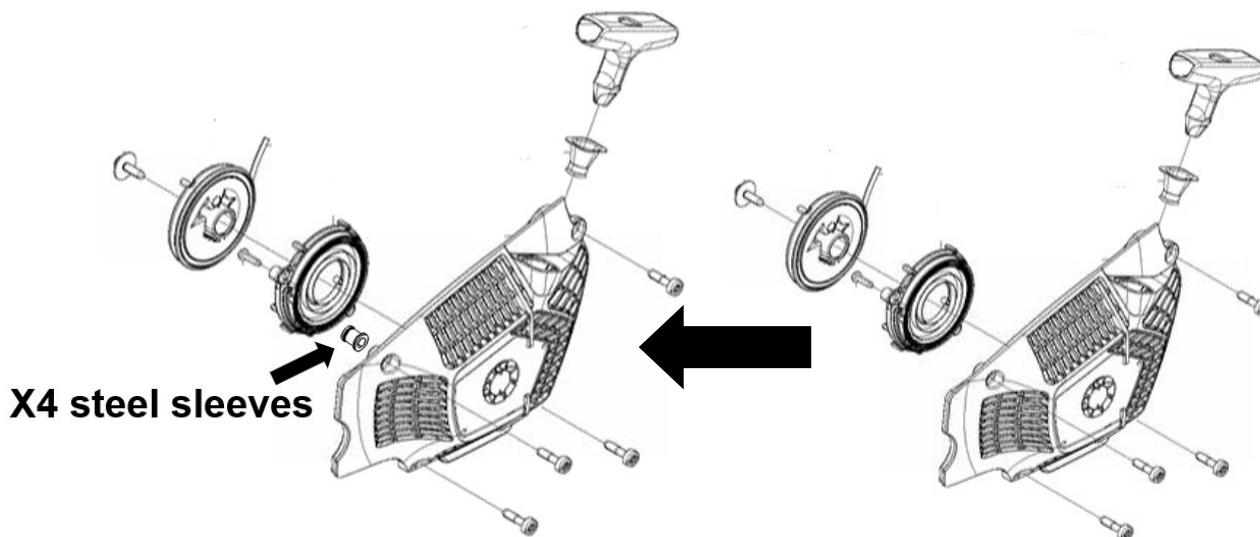

575 52 76-04

575 52 76-02